

- LEGEND**
- 0.79 ha AREA IN HECTARES
  - 2754/2755 MANHOLE TO MANHOLE
  - 16 434 POPULATION EQUIVALENT
  - 1 NUMBER OF UNITS
  - SANITARY DRAINAGE AREA BOUNDARY
  - DIRECTION OF FLOW
  - EXISTING SANITARY SEWER AND MANHOLE

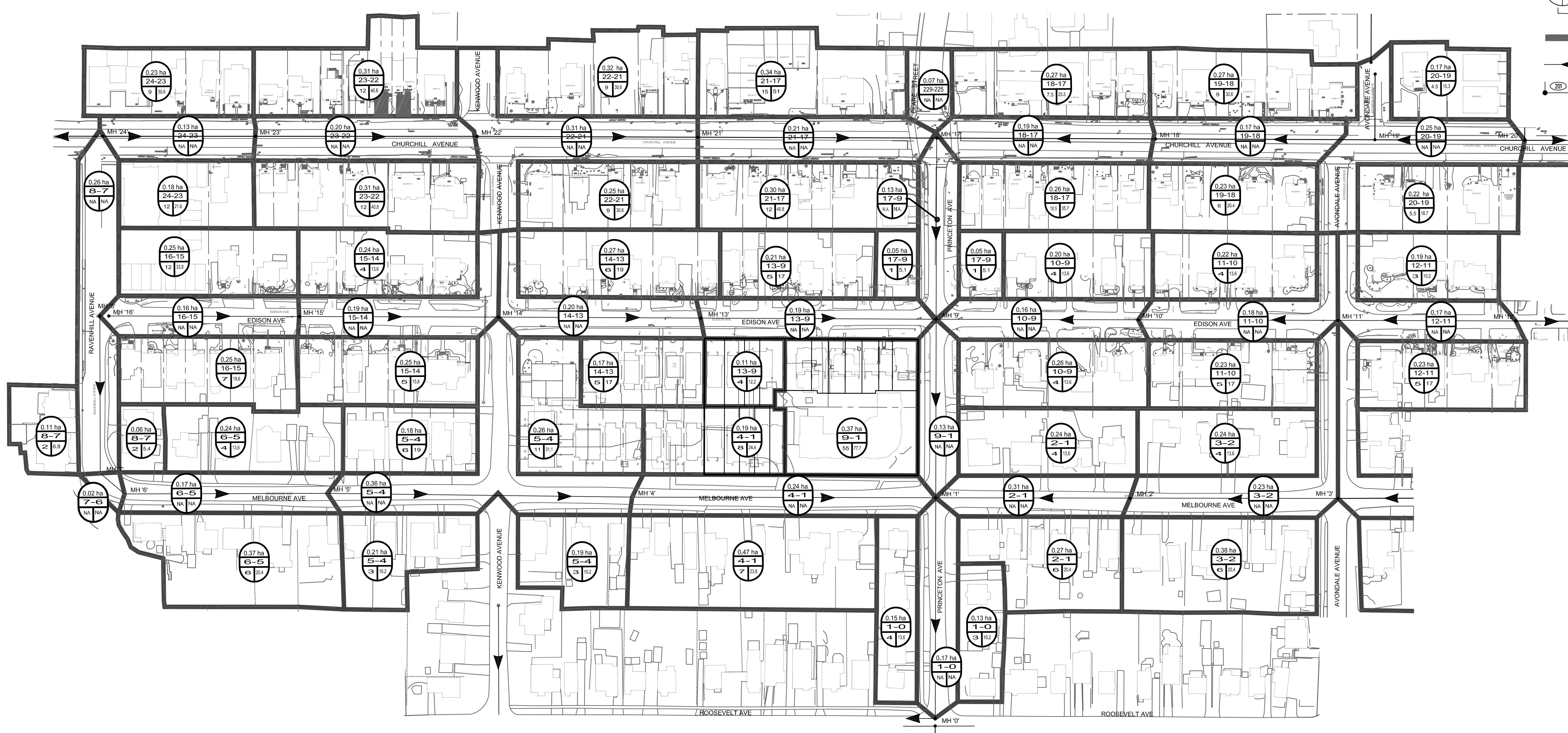

**FOR INFORMATION  
PURPOSES ONLY**

**NOTE:**  
THE POSITION OF ALL POLE LINES, CONDUITS, WATERMANS, SEWERS AND OTHER UNDERGROUND AND OVERGROUND UTILITIES AND STRUCTURES IS NOT NECESSARILY SHOWN ON THE CONTRACT DRAWINGS, AND WHERE SHOWN, THE ACCURACY OF THE POSITION OF SUCH UTILITIES AND STRUCTURES IS NOT GUARANTEED. BEFORE STARTING WORK, DETERMINE THE EXACT LOCATION OF ALL SUCH UTILITIES AND STRUCTURES AND ASSUME ALL LIABILITY FOR DAMAGE TO THEM.

No.	REVISION	DATE	BY
1.	ISSUED FOR INFORMATION	MAY 8/17	BHB

SCALE	N.T.S.
DESIGN	BCS
CHECKED	BHB
DRAWN	BCS
CHECKED	BHB
APPROVED	BHB

<b>FOR REVIEW ONLY</b>	

**NOVATECH**  
Engineers, Planners & Landscape Architects  
Suite 200, 240 Michael Cowpland Drive  
Ottawa, Ontario, Canada K2M 1P6  
Telephone (613) 254-9643  
Facsimile (613) 254-5867  
Website www.novatech-eng.com

LOCATION CITY OF OTTAWA 373 PRINCETON		PROJECT No.	116126-00
DRAWING NAME <b>SANITARY DRAINAGE AREA PLAN (EXISTING SEWERS)</b>		REV	REV # 1
		DRAWING No.	116126-SAN

M:\2016\116126\CAD\Drawings\Engineering\SAN\116126-SAN\_COVERDALL.dwg SAN\_Apr 04, 2017 - 10:22am, bawant