

## Appendix 7

### Aquatic Environment Photo Sets

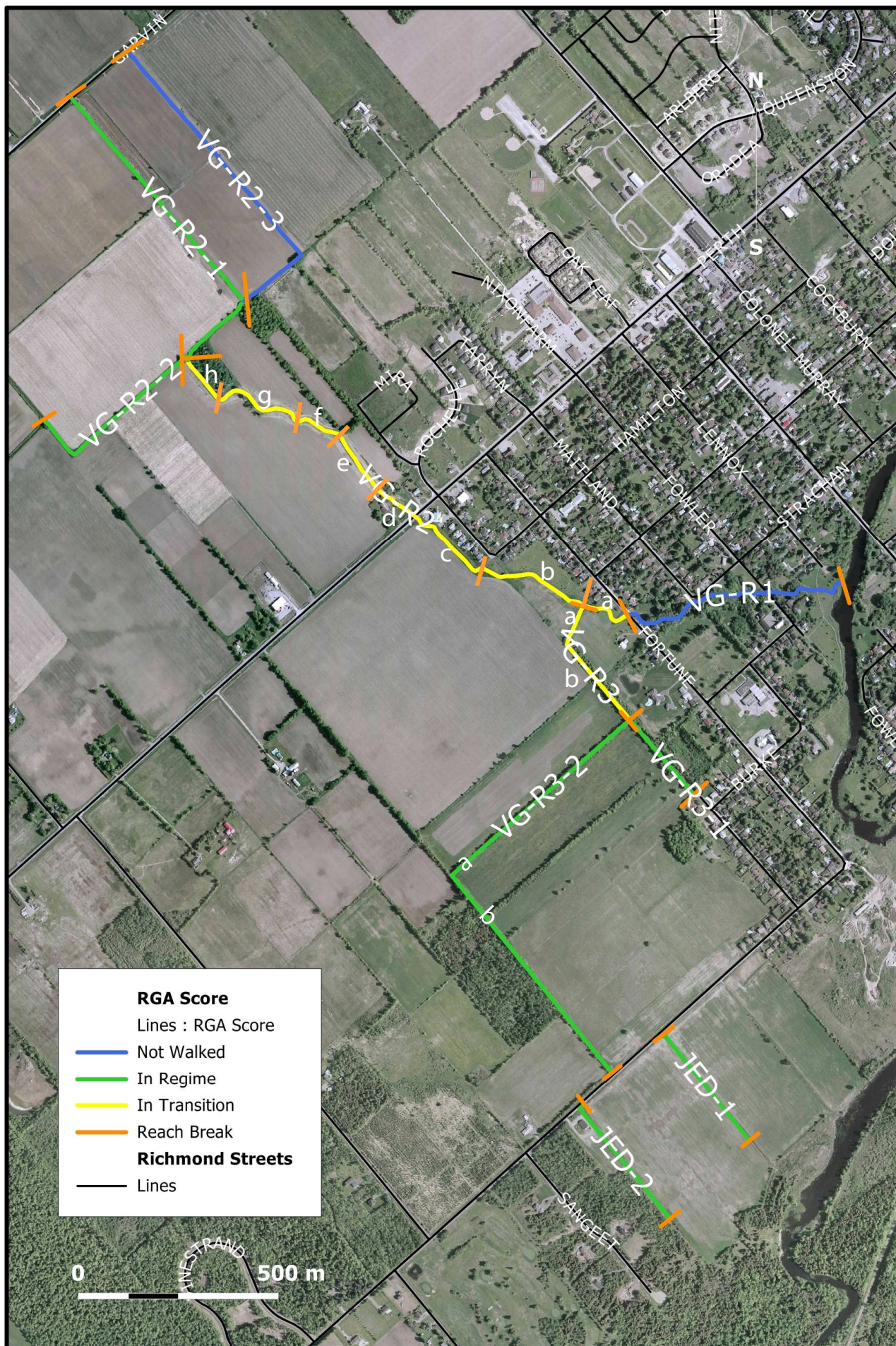





VG-R2a

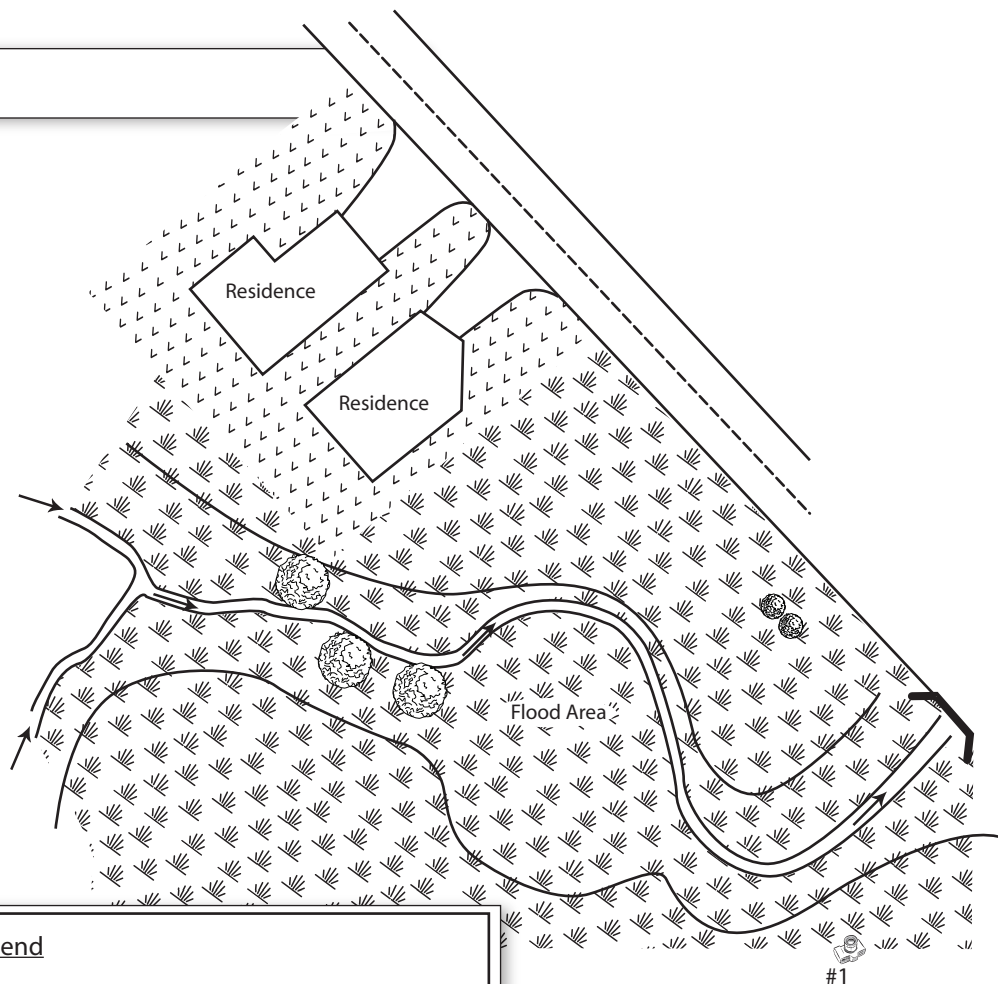

### Map Legend

- |  |                                    |  |                            |
|--|------------------------------------|--|----------------------------|
|  | Stream outline                     |  | Point & direction of photo |
|  | Vegated banks                      |  | Waypoint                   |
|  | Flow direction                     |  | Road or tractor path       |
|  | Ploughed field                     |  | Row of trees               |
|  | Rocky outcrop/<br>Reinforced banks |  | Culvert                    |
|  | Wild grass/ sedges/<br>shrubs      |  |                            |
|  | Manicured lawn                     |  |                            |



Photo#1 (April 10, 2008)



Taken looking upstream.  
Shows the extensive spring flood area.



## VG-R2b

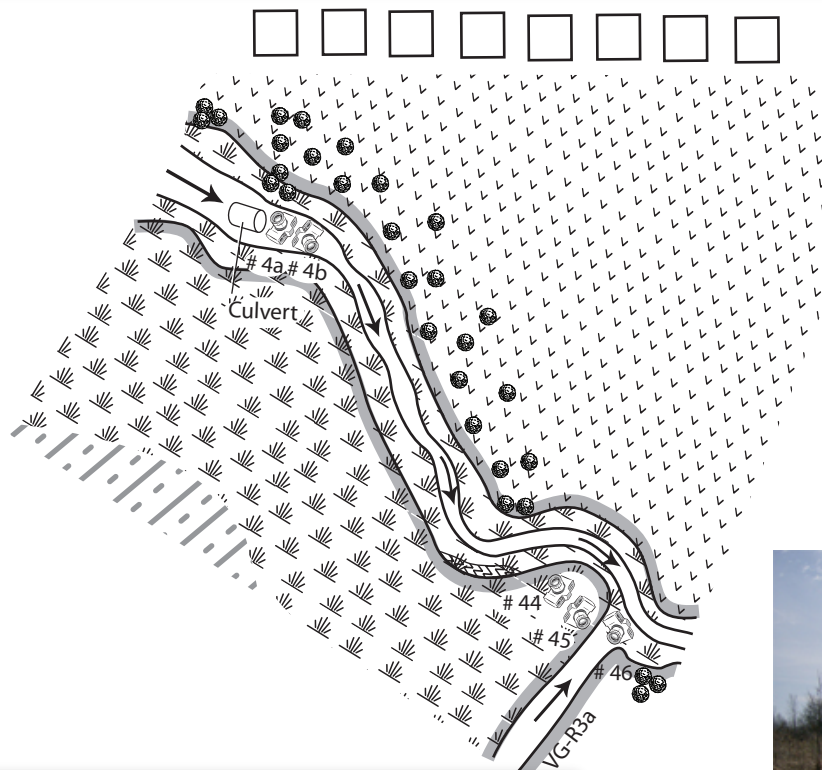

### Map Legend

- |  |                                    |  |                            |
|--|------------------------------------|--|----------------------------|
|  | Stream outline                     |  | Point & direction of photo |
|  | Vegated banks                      |  | Waypoint                   |
|  | Flow direction                     |  | Road or tractor path       |
|  | Ploughed field                     |  | Row of trees               |
|  | Rocky outcrop/<br>Reinforced banks |  | Culvert                    |
|  | Wild grass/ sedges/<br>shrubs      |  |                            |
|  | Manicured lawn                     |  |                            |



\* Map NTS \*

Photo #44 (April 16,2008)



Taken looking upstream.  
Right - showing spruce trees;  
Left - showing farmers field.  
Both left and right banks have  
tree clusters.

Photo #45 (April 16,2008)



Taken looking downstream.  
Right - showing cedar  
hedges and residences;  
Left - open grass field with  
cluster of trees in center  
of picture.



Taken looking upstream.  
Right - showing wild grass  
field and tree clusters and  
also, start of Reach #12;  
Left - open wild grass field  
with one single tree in  
center of picture.  
Start of Reach VG-R3a.

Photos #4a, b (August 3-9,2008)



◀ 4a upstream

▲ 4b downstream



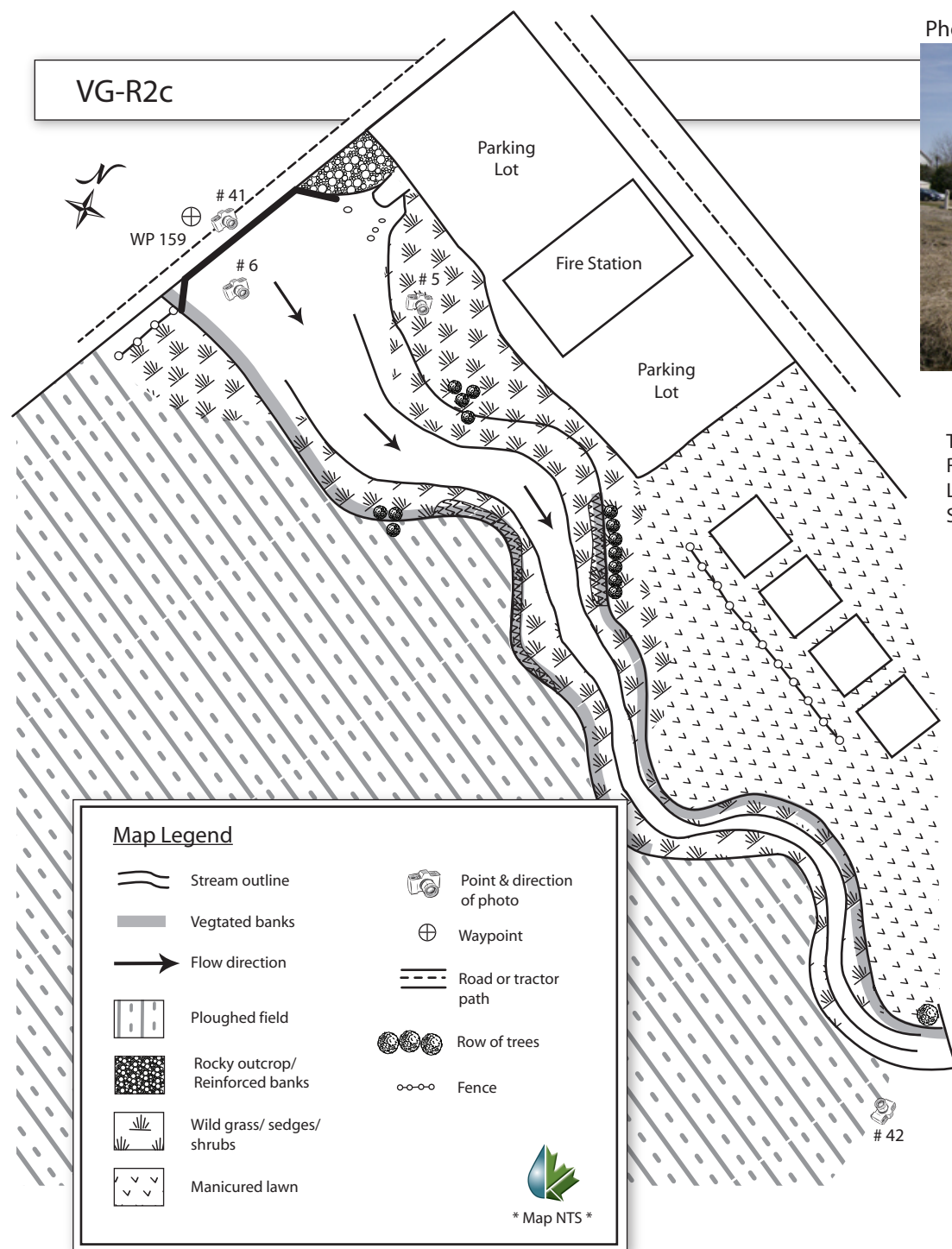

Photo #41 (April 16, 2008)



Taken looking downstream.  
Right - showing farmers field;  
Left - showing residences and cars.

Photo #42 (April 16, 2008)



Taken looking upstream.  
Right - showing residence;  
Left - showing farmers field.  
Start of Reach VG-R2c.

Photo #5 (April 10, 2008)



Photo #6 (August 28, 2008)



Taken looking downstream.  
End of Reach VG-R2c.



VG-R2d

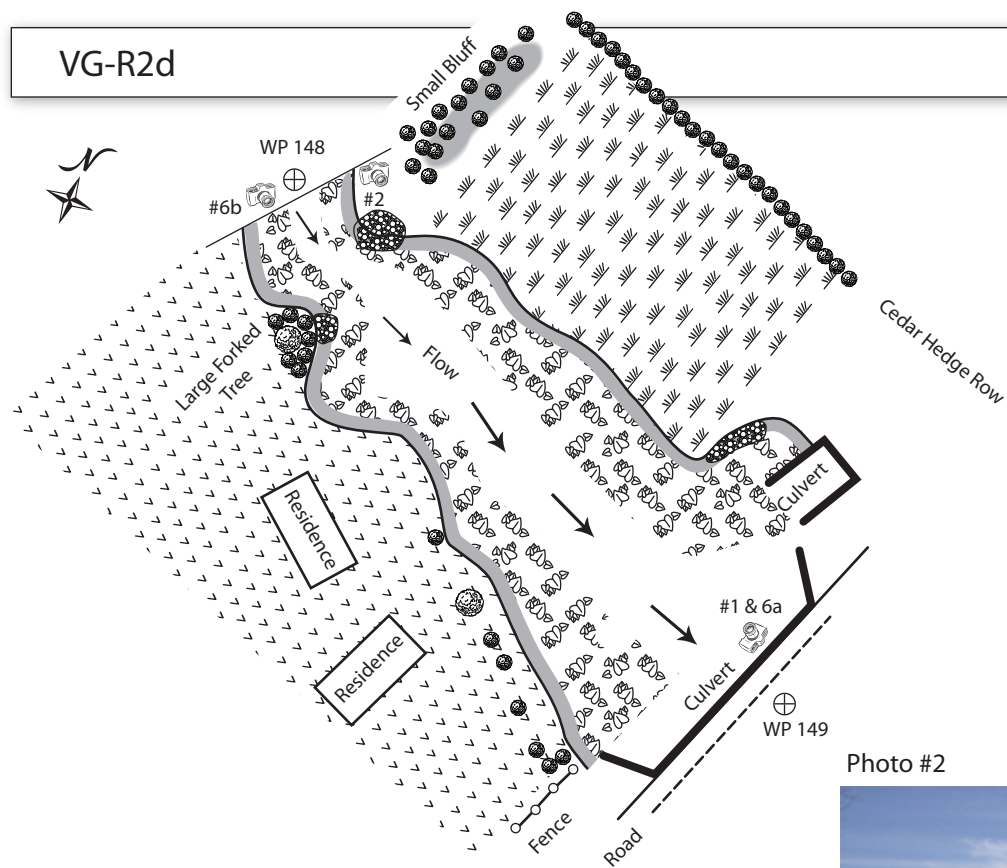

### Map Legend











- |   |                                |   |                            |
|---|--------------------------------|---|----------------------------|
|  | Stream outline                 |  | Point & direction of photo |
|  | Vegated banks                  |  | Waypoint                   |
|  | Flow direction                 |  | Road or tractor path       |
|  | Macrophytes                    |  | Row of trees               |
|  | Rocky outcrop/Reinforced banks |   |                            |
|  | Cut Wild grass/sedges/shrubs   |   |                            |
|  | Manicured lawn                 |   |                            |

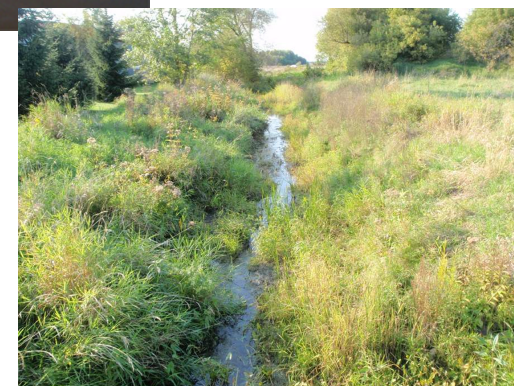

Photo #1



Taken looking upstream.  
Right - showing residence and maintained lawn with spruce and white pine;  
Left - showing open field and cluster of trees.

Photo #6a (Sept. 23, 2008)



Same view in fall.

Photo #2



Looking downstream.  
Right showing large willow tree and residence property.  
Left - showing vegetated bank and fire station in background.  
Center - showing culvert crossing at Richmond Rd.  
End of Reach VG-R2d.

Photo #6b (Aug. 3-9, 2008) downstream





VG-R2e

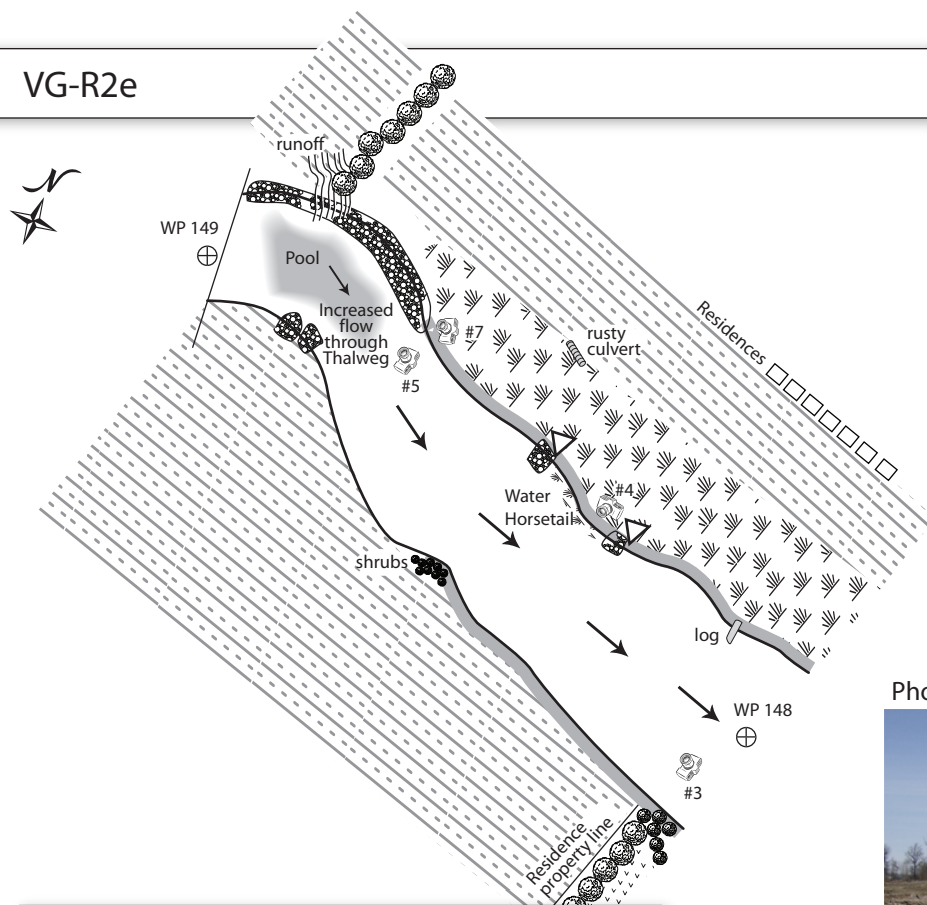

### Map Legend

- |  |                                |  |                            |
|--|--------------------------------|--|----------------------------|
|  | Stream outline                 |  | Point & direction of photo |
|  | Vegated banks                  |  | Waypoint                   |
|  | Flow direction                 |  | Road or tractor path       |
|  | Ploughed field                 |  | Row of trees               |
|  | Rocky outcrop/Reinforced banks |  | Waterpipes                 |
|  | Wild grass/sedges/shrubs       |  |                            |
|  | Manicured lawn                 |  |                            |



\* Map NTS \*

Photo #3 (April 16, 2008)



Looking upstream.  
Right – vegetated banks.  
Left – farmers field.  
Start of Reach VG-R2e.

Photo #4 (April 16, 2008)

Showing high water pipe.



Photo #5 (April 16, 2008)



Taken looking upstream.  
Right – showing forested area and bank stabilization.  
Left – showing farmers field and a small patch of bank stabilization.

Photo #7 (April 10, 2008)



Taken looking upstream,  
on top of the bank stabilization.  
Standing water is visible to  
the right of the channel.



VG-R2f

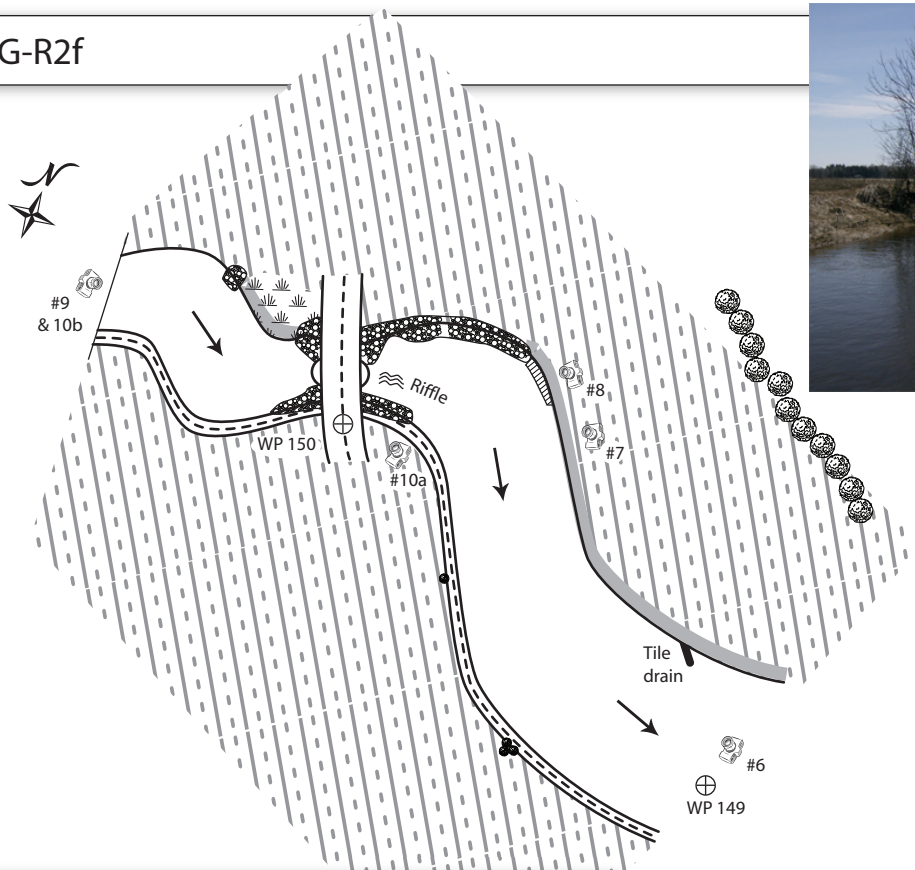

### Map Legend

- |  |                          |  |                                |
|--|--------------------------|--|--------------------------------|
|  | Stream outline           |  | Point & direction of photo     |
|  | Vegetated banks          |  | Waypoint                       |
|  | Flow direction           |  | Bank Erosion                   |
|  | Road or tractor path     |  | Rocky outcrop/Reinforced banks |
|  | Ploughed field           |  | Fence                          |
|  | Wild grass/sedges/shrubs |  |                                |
|  | Row of trees             |  |                                |



\* Map NTS \*

Photo #6 (April 16, 2008)



Taken looking upstream.  
Right – showing farmers field and tile drain in center of photo.  
Left showing small patch of trees and farmers field.  
End of Reach VG-R2e.

Photo #7 (April 16, 2008)



Showing downstream side of large culvert and tractor crossing with bank stabilization on left.

Photo #10a (Aug. 2008)



Photo #8 (April 10, 2008)



Taken looking downstream.  
Showing large culvert with backpack.

Photo #9 (April 16, 2008)



Photo #10b (Aug. 2008)



Taken looking downstream.  
Right – showing some bank stabilization.  
Left – showing farmers field and bank stabilization in center of photo.  
End of Reach VG-R2f.



VG-R2g

Photo #10 (April 16, 2008)



Taken looking upstream.  
Right – showing farmers field and forested area in background.  
Left – showing large tree and stream meanders to left.  
Start of Reach VG-R2g.

Photo #11 (April 16, 2008)



Taken looking downstream.  
Right – showing large tree and farmers field.  
Left – showing large tree and bank stabilization.  
Start of Reach VG-R2h.

### Map Legend

- |  |                              |  |                                    |
|--|------------------------------|--|------------------------------------|
|  | Stream outline               |  | Point & direction of photo         |
|  | Vegated banks                |  | Waypoint                           |
|  | Flow direction               |  | Bank Erosion                       |
|  | Road or tractor path         |  | Rocky outcrop/<br>Reinforced banks |
|  | Ploughed field               |  | Fence                              |
|  | Wild grass/sedges/<br>shrubs |  | Undercut bank                      |
|  | Forested Area                |  |                                    |



\* Map NTS \*

## VG-R2h

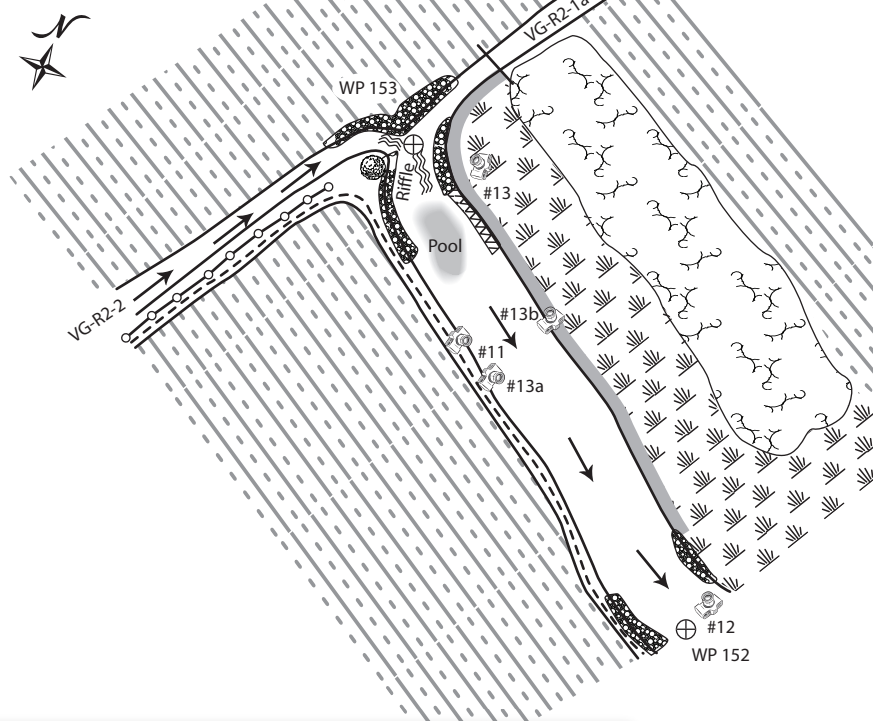

Photo #12 (April 16, 2008)



Taken looking upstream.  
Right – showing forested area.  
Left – showing farmers field  
and bank stabilization.  
Start of Reach VG-R2h.

Photo #13a (Aug. 3-9, 2008)



Photo #13 (April 16, 2008)



Taken looking upstream  
showing junction of Reach VG-R2h  
and VG-R2-2  
Right – showing farmers field and  
Reach VG-R2-1a.  
Left – showing bank stabilization  
and farmers field.

### Map Legend

	Stream outline		Point & direction of photo
	Vegated banks		Waypoint
	Flow direction		Bank Erosion
	Road or tractor path		Rocky outcrop/ Reinforced banks
	Ploughed field		Fence
	Wild grass/ sedges/ shrubs		Undercut bank
	Forested Area		

\* Map NTS \*

Photo #11 (April 10, 2008)



Photo #13b (Aug. 3-9, 2008)

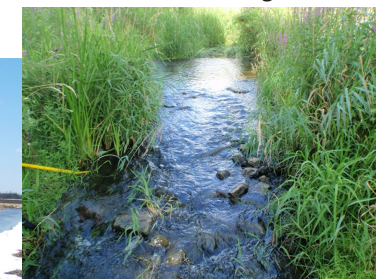

Taken looking downstream.



VG-R2-1a

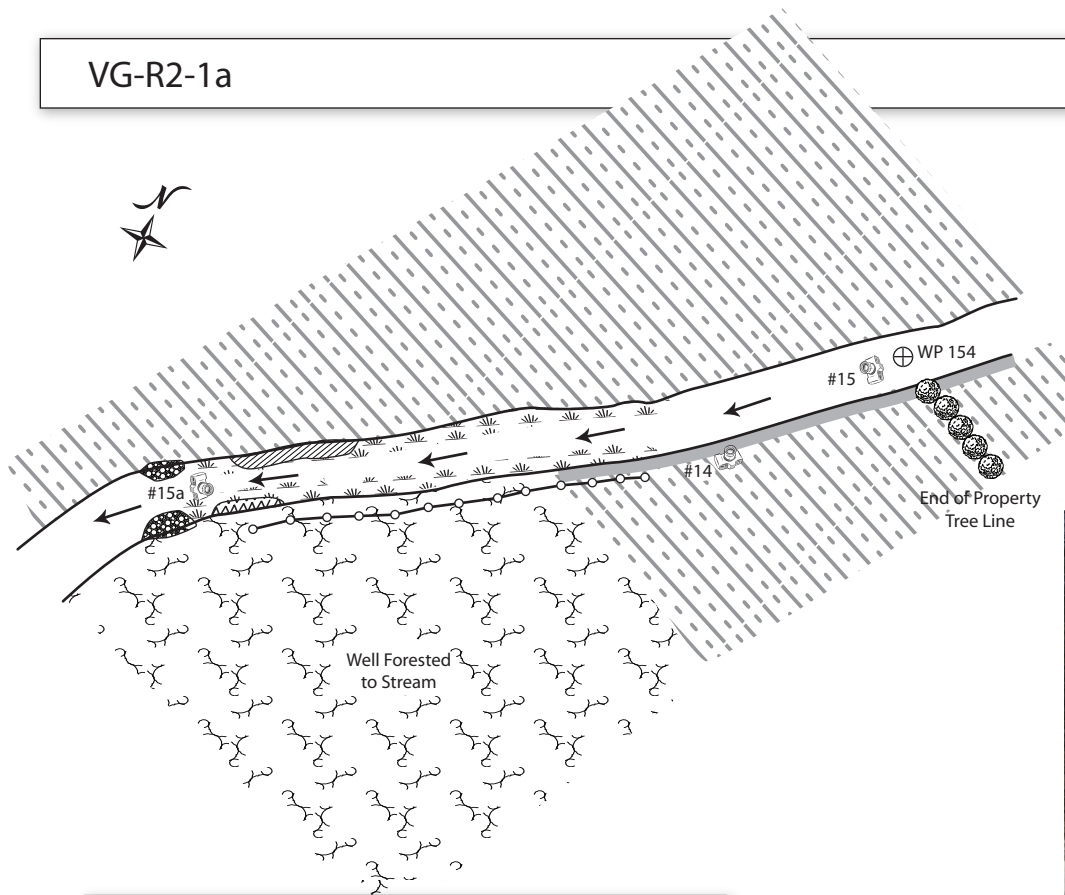

### Map Legend

- |  |                          |  |                                |
|--|--------------------------|--|--------------------------------|
|  | Stream outline           |  | Point & direction of photo     |
|  | Vegated banks            |  | Waypoint                       |
|  | Flow direction           |  | Bank Erosion                   |
|  | Row of trees             |  | Rocky outcrop/Reinforced banks |
|  | Ploughed field           |  | Fence                          |
|  | Wild grass/sedges/shrubs |  | Undercut bank                  |
|  | Forested Area            |  |                                |



Photo #14 (April 16, 2008)



Taken showing in stream vegetation.

Photo #15 (April 16, 2008)



Taken looking downstream.  
Left – showing forested area and fence line.  
Right showing farmers field.

Photo #15a (August 3-9, 2008)





VG-R2-2

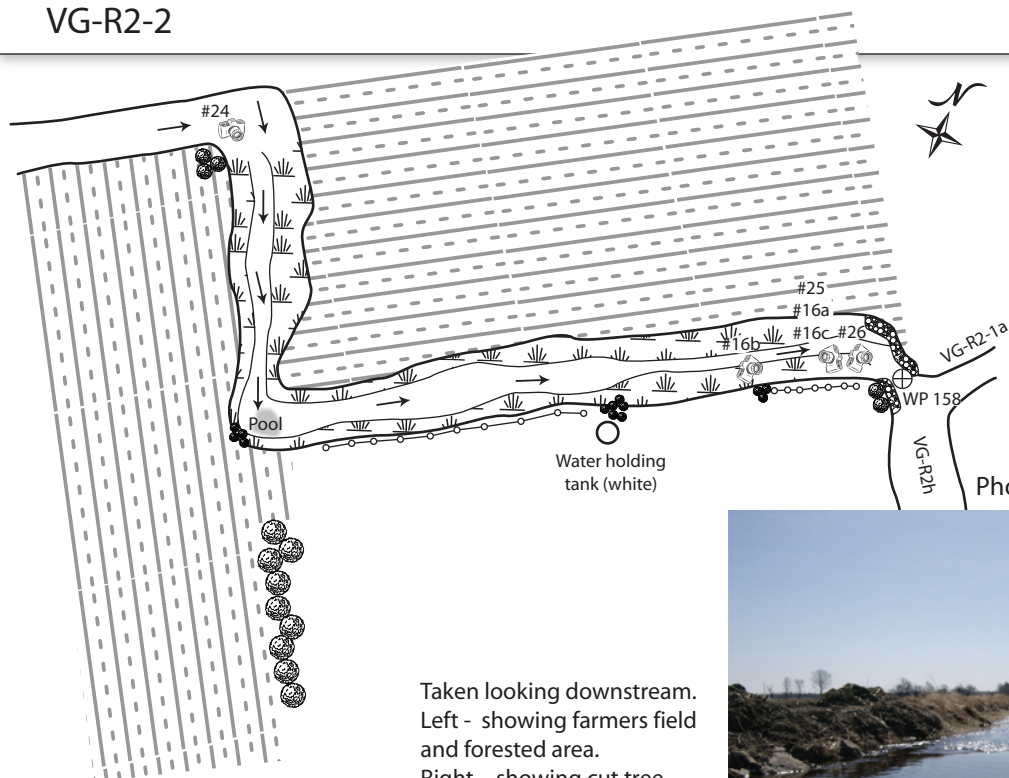

Taken looking downstream.  
Left - showing farmers field and forested area.  
Right - showing cut tree.

Photo #25 (April 16, 2008)



Taken looking upstream.  
Right - showing farmers field.  
Left - showing fence line.  
End of Reach VG-R2-2.

Photo #16a (April 10, 2008)



Photo #24 (April 16, 2008)



Photo #16c (Aug, 2008) ▶

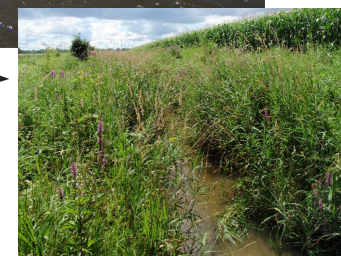

Photo #16b (Aug 3-9, 2008)



Photo #26 (April 16, 2008)



Taken looking downstream.  
Right - showing willow tree. Left - showing re-enforced bank.  
Also, showing Reach VG-R2-1a in center of photo.  
End of Reach VG-R2-2.

### Map Legend

- |  |                          |  |                                |
|--|--------------------------|--|--------------------------------|
|  | Stream outline           |  | Point & direction of photo     |
|  | Vegated banks            |  | Waypoint                       |
|  | Flow direction           |  | Road or tractor path           |
|  | Row of trees             |  | Rocky outcrop/Reinforced banks |
|  | Ploughed field           |  | Fence                          |
|  | Wild grass/sedges/shrubs |  |                                |
|  | Beaver dam               |  |                                |



\* Map NTS \*



VG-R3a,b

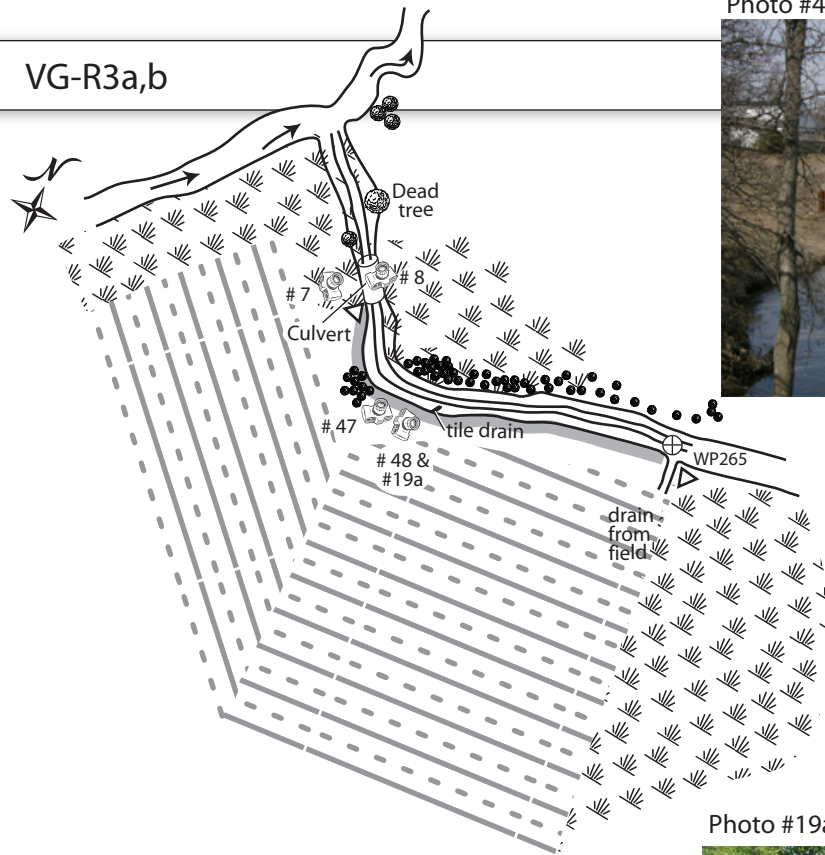

Photo #47 (April 16, 2008)



Taken looking downstream.  
Right – showing tree;  
Left – showing open wild grass filed;  
Center – showing damaged culvert  
that could be a fish barrier durring  
low water levels.  
Photo taken at elbow between  
VG-R3a and VG-R3b.

Photo #48 (April 16, 2008)



Taken looking upstream.  
Right – showing cluster  
of trees;  
Left – showing farmers field.  
Photo taken at elbow  
between  
VG-R3a and VG-R3b.

Photo #19a (August 3-9, 2008)



Taken looking upstream.  
Photo taken at elbow  
between VG-R3a and  
VG-R3b.

Photo #7 (October 22, 2008)



Culvert in middle of VG-R3a  
mostly crushed.

Photo #8 (October 22, 2008)  
Looking NE from top  
of culvert.



### Map Legend

- |  |                                    |  |                               |
|--|------------------------------------|--|-------------------------------|
|  | Stream outline                     |  | Point & direction<br>of photo |
|  | Vegated banks                      |  | Waypoint                      |
|  | Flow direction                     |  | Road or tractor<br>path       |
|  | Ploughed field                     |  | Row of trees                  |
|  | Rocky outcrop/<br>Reinforced banks |  | Waterpipes                    |
|  | Wild grass/ sedges/<br>shrubs      |  |                               |
|  | Saplings                           |  |                               |



\* Map NTS \*



VG-R3a,b

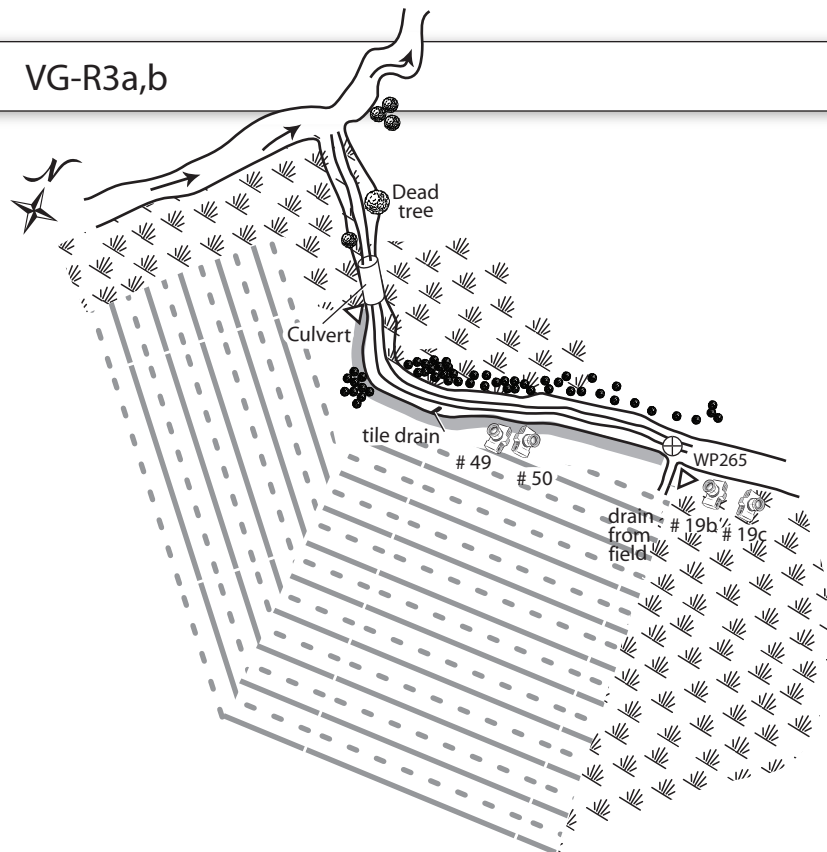

Photo #49 (April 16, 2008)



Taken looking upstream.  
Right – showing cluster of trees;  
Left – showing farmers field and a few tree clusters.

Photo #50 (April 16, 2008)



Taken looking downstream.  
Right – showing fence line and small tree clusters;  
Left – showing cluster of trees with stream.  
End of VG-R3b.

Photo #19b (August 3-9, 2008)



Taken looking downstream.  
Middle of VG-R3b.

Photo #19c (August 3-9, 2008)



Taken looking upstream.  
Middle of VG-R3b.

### Map Legend

- |  |                                    |  |                            |
|--|------------------------------------|--|----------------------------|
|  | Stream outline                     |  | Point & direction of photo |
|  | Vegated banks                      |  | Waypoint                   |
|  | Flow direction                     |  | Road or tractor path       |
|  | Ploughed field                     |  | Row of trees               |
|  | Rocky outcrop/<br>Reinforced banks |  | Waterpipes                 |
|  | Wild grass/sedges/<br>shrubs       |  |                            |
|  | Saplings                           |  |                            |



\* Map NTS \*



VG-R3-1

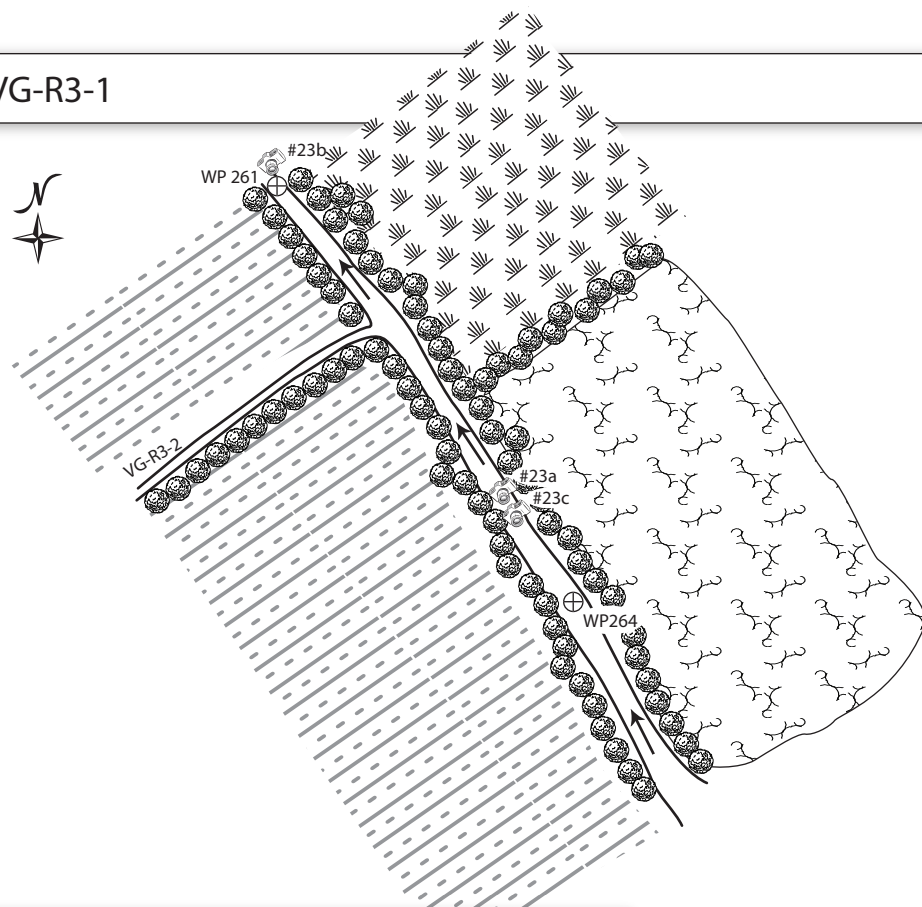

Photo #23a (August 3-9, 2008)



Taken looking upstream,  
midway up reach

Photo #23b (August 3-9, 2008)

Taken looking East from  
the tile drain at WP 261.



Photo #23c (August 3-9, 2008)



### Map Legend

- |  |                                  |  |                                    |
|--|----------------------------------|--|------------------------------------|
|  | Stream outline                   |  | Point & direction of photo         |
|  | Vegated banks                    |  | Waypoint                           |
|  | Flow direction                   |  | Bank Erosion                       |
|  | Road or tractor path             |  | Rocky outcrop/<br>Reinforced banks |
|  | Ploughed field                   |  | Fence                              |
|  | Wild grass/<br>sedges/<br>shrubs |  | Undercut bank                      |
|  | Forested Area                    |  |                                    |



\* Map NTS \*



VG-R3-2a

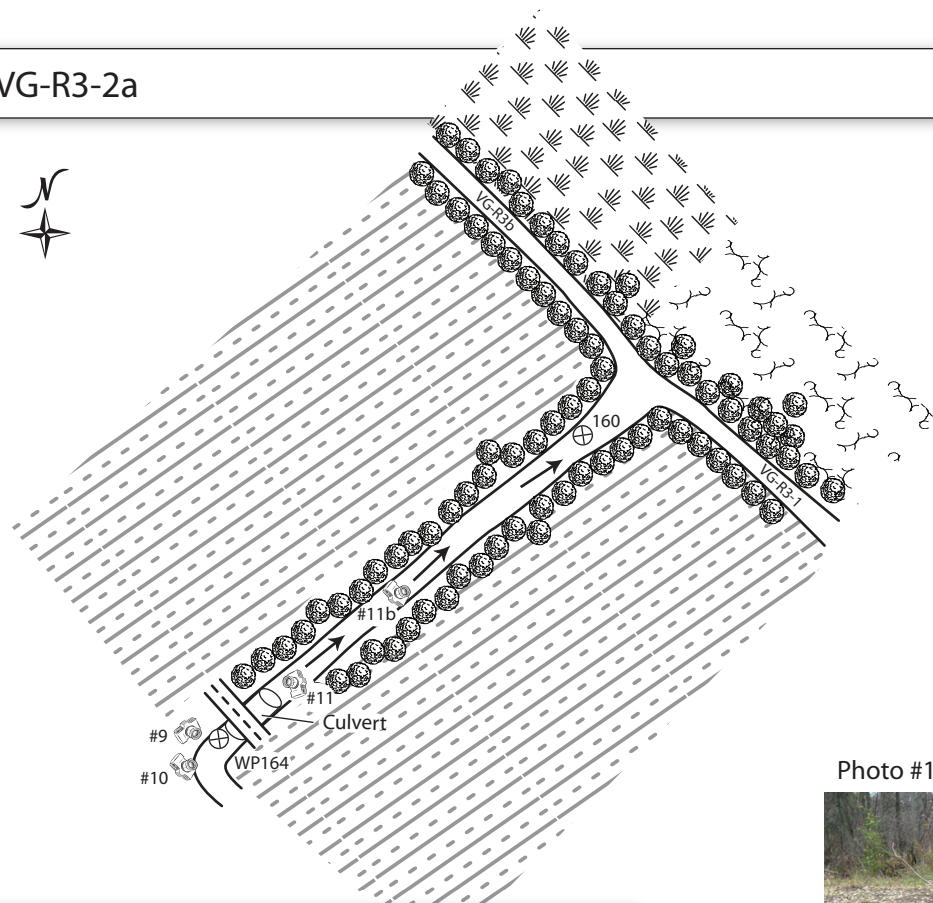

### Map Legend

- |  |                              |  |                                    |
|--|------------------------------|--|------------------------------------|
|  | Stream outline               |  | Point & direction of photo         |
|  | Vegated banks                |  | Waypoint                           |
|  | Flow direction               |  | Bank Erosion                       |
|  | Road or tractor path         |  | Rocky outcrop/<br>Reinforced banks |
|  | Ploughed field               |  | Fence                              |
|  | Wild grass/sedges/<br>shrubs |  | Undercut bank                      |
|  | Forested Area                |  |                                    |



\* Map NTS \*

Photo #9 (Oct. 22, 2008)



The eastern end of this channel drops just a few cm into VG-R3. The trees are well spaced without too much ground cover. Photo taken looking east from WP 164.

Photo #10 (Oct. 22, 2008)



The culvert is open at the western end and mostly blocked by fallen trees on the eastern end.

Photo #11 (Oct. 22, 2008)



Photo #11b (Aug. 9, 2008)





## VG-R3-2b

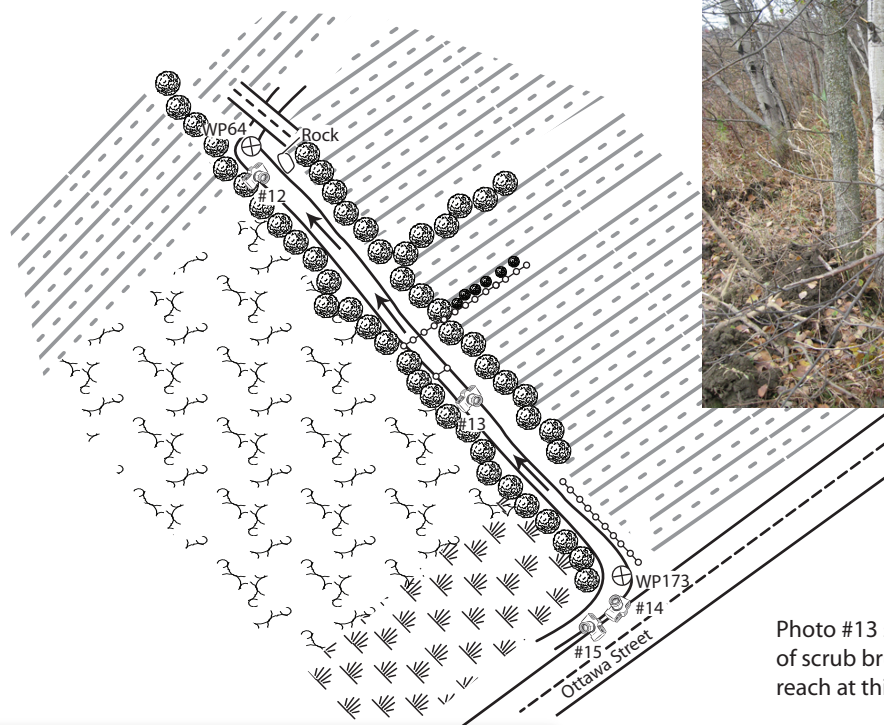

Photo #12 (Oct. 22, 2008)



VG-R3b is a shallow, straight run with ploughed fields on the North East side and forest for much of the south western border.  
This photo shows the line of trees down the Southwest side.

Photo #13 (Oct. 22, 2008)



Photo #13 shows the increase of scrub brush covering the reach at this point.

### Map Legend

	Stream outline		Point & direction of photo
	Vegetated banks		Waypoint
	Flow direction		Bank Erosion
	Road or tractor path		Rocky outcrop/Reinforced banks
	Ploughed field		Fence
	Wild grass/sedges/shrubs		Undercut bank
	Forested Area		



\* Map NTS \*

Photo #14 (Aug. 3, 2008)



Photo #15 (Aug. 3, 2008)





JED-1

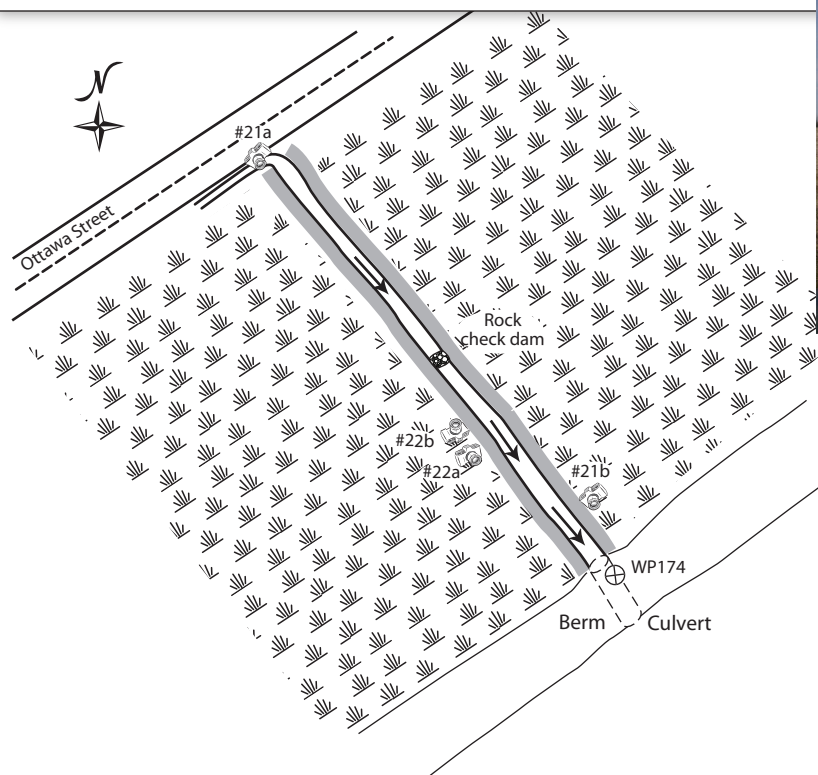

Photo #21a (April 16, 2008)



Photo #21b (April 16, 2008)



Photo #22a (Aug. 3, 2008)



Photo #22b (Aug. 3, 2008)



### Map Legend

- Stream outline
- Vegetated banks
- Flow direction
- Road or tractor path
- Ploughed field
- Wild grass/ sedges/ shrubs
- Point & direction of photo
- Waypoint
- Bank Erosion
- Rocky outcrop/ Reinforced banks



\* Map NTS \*