

| PIPE CROSSINGS  |                  |                 |                 |  |
|-----------------|------------------|-----------------|-----------------|--|
| PIPE CROSSING # | GROUND ELEVATION | PIPE INVERT     | PIPE OBVERT     | SEPARATION (m)                                 |
| 1               | 97.77            | STM INV = 96.58 | WTR OBV = 95.37 | 1.21   |
| 2               | 97.81            | STM INV = 96.58 | SAN OBV = 94.95 | 1.63   |
| 3               | 98.18            | WTR INV = 95.73 | SAN OBV = 95.18 | WM CROSSING SAN PER STD W25.2, 0.30m CLEARANCE |
| 4               | 98.12            | STM INV = 96.77 | WTR OBV = 95.72 | 1.05   |
| 5               | 98.23            | STM INV = 96.81 | WTR OBV = 95.88 | 0.93   |
| 6               | 98.260           | STM INV = 96.82 | SAN OBV 95.20   | 1.62   |

| PROPOSED WATERMAIN 'A' |                 |               |                    |                                |
|------------------------|-----------------|---------------|--------------------|--------------------------------|
| STATION                | FINISHED GROUND | TOP WATERMAIN | COVER PROVIDED (m) | DESCRIPTION                    |
| 0+000.00               | 97.46           | 95.06         | 2.40               | TEE CONNECTION TO EX. 150mm WM |
| 0+001.14               | 97.49           | 95.09         | 2.40               | 200x150 REDUCER                |
| 0+005.94               | 97.63           | 95.23         | 2.40               | WATER METER CHAMBER PER W3.3   |
| 0+020.00               | 97.95           | 95.54         | 2.40               |                                |
| 0+022.44               | 97.98           | 95.57         | 2.40               | FIRE HYDRANT                   |
| 0+023.58               | 97.99           | 95.59         | 2.40               | 200x50 REDUCER                 |
| 0+040.00               | 98.07           | 95.67         | 2.40               |                                |
| 0+057.97               | 98.16           | 95.76         | 2.40               | V&B                            |
| 0+059.64               | 98.17           | 95.77         | 2.40               | TEE CONNECTION TO WM 'B'       |
| 0+060.00               | 98.17           | 95.77         | 2.40               |                                |
| 0+080.00               | 98.27           | 95.87         | 2.40               |                                |
| 0+083.20               | 98.29           | 95.89         | 2.40               | CAP WM                         |

| PROPOSED 50mmØ WATERMAIN 'B' |                 |               |                    |                          |
|------------------------------|-----------------|---------------|--------------------|--------------------------|
| STATION                      | FINISHED GROUND | TOP WATERMAIN | COVER PROVIDED (m) | DESCRIPTION              |
| 1+000.00                     | 98.17           | 95.77         | 2.40               | TEE CONNECTION TO WM 'A' |
| 0+001.50                     | 98.18           | 95.78         | 2.40               | V&B                      |
| 0+020.00                     | 98.28           | 95.88         | 2.40               |                          |
| 0+037.20                     | 98.36           | 95.96         | 2.40               | CAP WM                   |

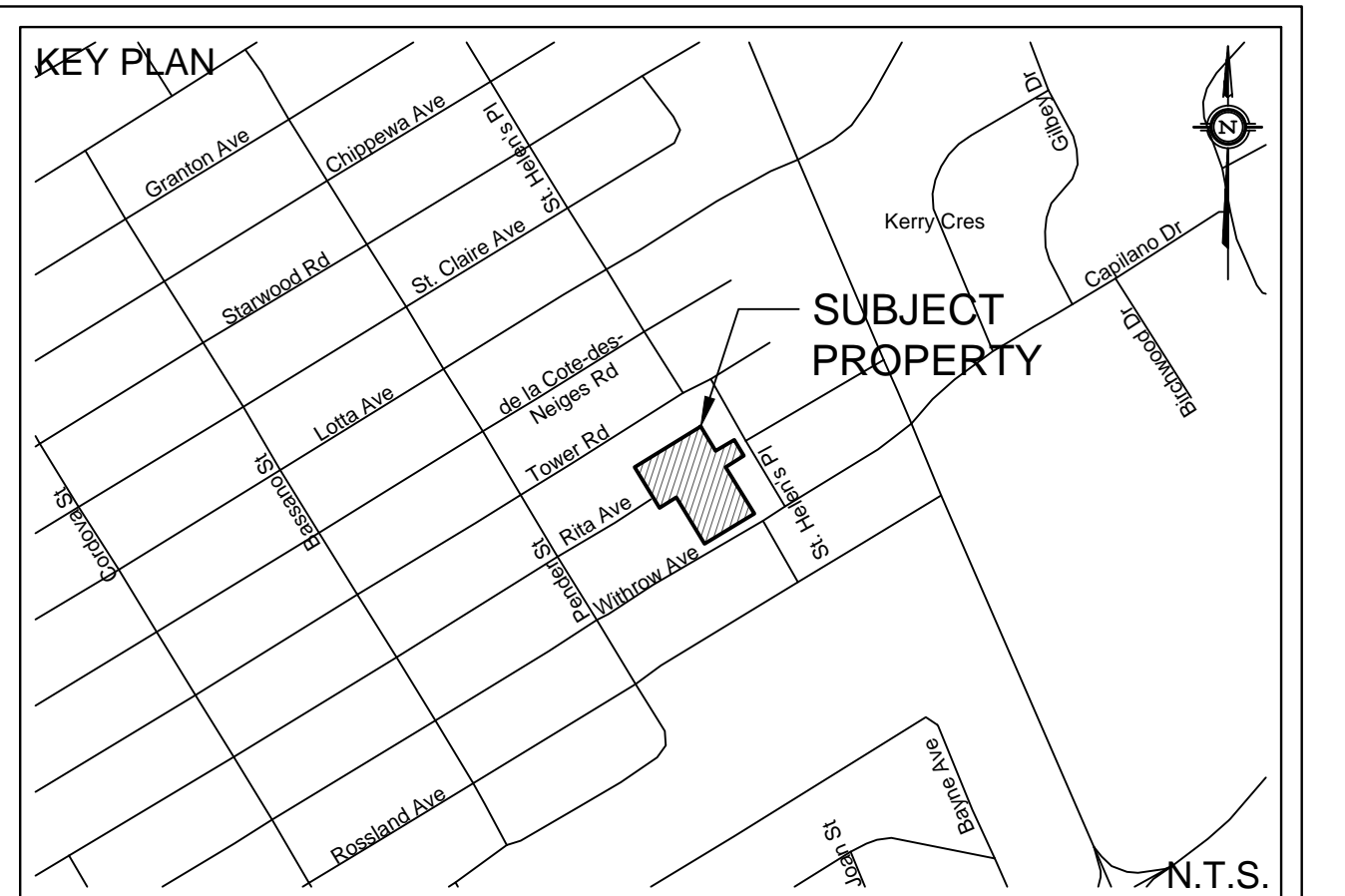

| LEGEND |                                     |
|--------|-------------------------------------|
|        | PROPOSED WATERMAIN                  |
|        | PROPOSED SANITARY SEWER             |
|        | PROPOSED STORM SEWER                |
|        | PROPOSED PERFORATED SUBDRAIN        |
|        | PROPOSED VALVE BOX                  |
|        | PROPOSED CURB STOP                  |
|        | PROPOSED FIRE HYDRANT               |
|        | PROPOSED SIAMESE CONNECTION         |
|        | PROPOSED REMOTE WATER METER         |
|        | PROPOSED WATER METER                |
|        | PROPOSED STORM MANHOLE              |
|        | PROPOSED SANITARY MANHOLE           |
|        | PROPOSED CATCH BASIN                |
|        | FOUNDATION DRAINAGE OUTLET LOCATION |
|        | UNDERGROUND STORAGE CHAMBER         |
|        | FINISHED FLOOR ELEVATION            |
|        | UNDERSIDE OF FOOTING                |
|        | LOT TO BE EQUIPPED WITH SUMP PUMP   |

EXISTING UNDERGROUND SERVICES AND UTILITY LOCATIONS DERIVED FROM THE BEST AVAILABLE DATA, AS-CONSTRUCTED DRAWINGS, UTILITY DRAWINGS AND INFRASTRUCTURE MAPPING PROVIDED BY THE CITY OF OTTAWA.

CONTRACTOR TO CONFIRM ELEVATIONS AND LOCATIONS OF EXISTING UNDERGROUND SERVICES AND UTILITIES WITHIN THE RIGHT OF WAY PRIOR TO INSTALLATION OF SITE SERVICING INFRASTRUCTURE.

THE CONTRACTOR SHALL IMPLEMENT BEST MANAGEMENT PRACTICES, TO PROVIDE FOR PROTECTION OF THE AREA DRAINAGE SYSTEM AND THE RECEIVING WATERCOURSE, DURING CONSTRUCTION ACTIVITIES. THE CONTRACTOR ACKNOWLEDGES THAT THE FAILURE TO IMPLEMENT APPROPRIATE EROSION AND SEDIMENT CONTROL MEASURES MAY BE SUBJECT TO PENALTIES IMPOSED BY ANY APPLICABLE REGULATORY AGENCY.

## NOT FOR CONSTRUCTION

**TOPOGRAPHIC INFORMATION**  
TOPOGRAPHIC INFORMATION PROVIDED BY FARLEY, SMITH & DENIS SURVEYING LTD., 2015  
PROJ. NO. 432-15  
DATED NOVEMBER 11, 2015

**SITE PLAN INFORMATION**  
SITE PLAN PROVIDED BY URBANDIVA DESIGN INC.  
PROJ. NO. 1702  
DATED MARCH 1, 2018

**GEOTECHNICAL STUDY**  
GEOTECHNICAL RECOMMENDATIONS PROVIDED BY PATERSON GROUP INC.  
PROJ. NO. PG4194-1  
DATED AUGUST 8, 2017

**SITE SERVICING AND STORMWATER MANAGEMENT STUDY**  
SERVICING AND STORMWATER MANAGEMENT RECOMMENDATIONS PROVIDED BY DSEL  
PROJ. NO. 17-931  
DATED JUNE 2018

**BENCH MARK**  
2 NAILS IN POLE LOCATED AT SOUTH-WEST CORNER OF SUBJECT PROPERTY  
ELEV=99.48

| No. | BY     | YY.MM.DD | DESCRIPTION                 |
|-----|--------|----------|-----------------------------|
| 4   | G.G.M. | 19.01.07 | ISSUED FOR MUNICIPAL REVIEW |
| 3   | G.G.M. | 18.06.07 | ISSUED FOR MUNICIPAL REVIEW |
| 2   | B.N.C. | 18.03.29 | ISSUED FOR MUNICIPAL REVIEW |
| 1   | B.N.C. | 17.11.02 | ISSUED FOR MUNICIPAL REVIEW |

PROJECT No. 17-931

REVIEWED BY

**SITE SERVICING PLAN**  
21 WITHROW AVENUE

© DSEL

**THEBERGE HOMES**

904 Lady Ellen Place  
Ottawa, Ontario, K1Z 5L5  
Tel. (613) 421-1515

**DSEL**  
david schaeffer engineering ltd  
SMART SURVEYING

120 Iber Road Unit 103  
Stittsville, Ontario, K2S 1E9  
Tel. (613) 836-0856  
Fax. (613) 836-7183  
www.DSEL.ca

**DRAWN BY:** A.W.T. **CHECKED BY:** S.L.M. **DRAWING NO.** **SHEET NO.**

**DESIGNED BY:** B.N.C. **CHECKED BY:** A.D.F.

**SCALE:** 1:300 **DATE:** MARCH 2018 **SSP-1** **3 of 5**