

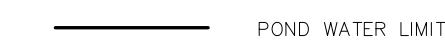
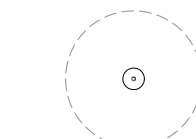

**Responsibility / Copyright Reserved**

The location of under/overground utilities and structures are not necessarily shown on the contract drawings, and/or where shown. The accuracy of the position of such utilities and structures is not guaranteed. The Contractor shall verify and be responsible to determine the exact location of all such utilities and structures and assumes all liability for any damage to them.

The Copyrights to all designs and drawings are the property of ARK Engineering and Development. Reproduction or use for any purpose other than that authorized by ARK Engineering and Development is forbidden.

**Legend**

-  POND WATER LIMIT
-  PROPOSED WELL LOCATION  
C/W 40m MINIMUM OF STEEL CASING AS PER  
GEMTEC'S HYDROGEOLOGICAL INVESTIGATION  
RECOMMENDATIONS, DATED XXX, 2025
-  15.0m MINIMUM RADIUS SEPARATION DISTANCE  
FROM DRAINAGE EASEMENTS
-  AREA OF THE SEPTIC ENVELOPE (800m² MIN.)  
AS PER SECTION 4.2.7 - POLICY 9

**General Notes**

- 1) ALL SEPTIC SYSTEMS MUST BE LOCATED IN THE FRONT OF PROPERTY

**Key Plan**

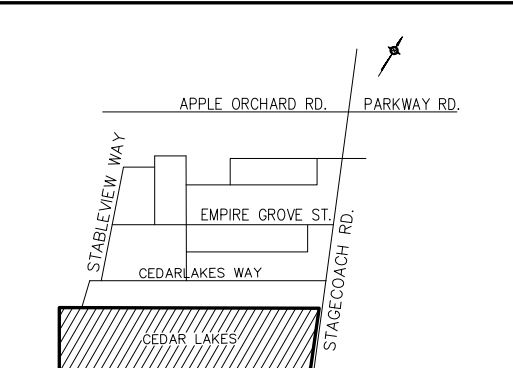

**Revision**

Revision	Description	Date
0.	SUBMITTED FOR APPROVAL	MAR 13/25

**Seal**

**Client / Project**

6980848 CANADA CORPORATION  
CEDAR LAKES SUBDIVISION

**Drawing Name**

LOT DEVELOPMENT PLAN

**Scale**



Revision	Sheet	Drawing No.
REV-0	1 of 1	LD-1

