

- LEGEND**
- CONCRETE SIDEWALK
 - STONEDUST PATH
 - SIGN AND POST LOCATION
 - TACTILE WALKING SURFACE INDICATOR IN CONCRETE (AS PER CITY OF OTTAWA DETAIL SCT.3)
 - DEPRESSED CURB
 - VALVE LOCATION
 - HYDRANT
 - SANITARY SYSTEM ACCESS POINT
 - STORM MANHOLE
 - ROAD CATCHBASIN
 - REARYARD CATCHBASIN
 - LANDSCAPE CATCHBASIN ELBOW
 - STREETLIGHT

102085-GRD06-CADD-102085-GRD06.dwg, GRD06, Feb 15, 2024, 1:58pm, 102085

NOTE:
 THE POSITION OF ALL POLE LINES, CONDUITS, WATERMANS, SEWERS AND OTHER UNDERGROUND AND OVERGROUND UTILITIES AND STRUCTURES IS NOT NECESSARILY SHOWN ON THE CONTRACT DRAWINGS, AND WHERE SHOWN, THE ACCURACY OF THE POSITION OF SUCH UTILITIES AND STRUCTURES IS NOT GUARANTEED. BEFORE STARTING WORK, DETERMINE THE EXACT LOCATION OF ALL SUCH UTILITIES AND STRUCTURES AND ASSUME ALL LIABILITY FOR DAMAGE TO THEM.

No.	REVISION	DATE	BY
1.	ISSUED FOR REVIEW	FEB 2024	ARM

SCALE	
1:750	
0	10 20 30

FOR REVIEW ONLY	
DESIGN	AAR
CHECKED	ARM
DRAWN	AAR
CHECKED	ARM
APPROVED	SMG



LOCATION WEST CAPITAL AIRPARK PHASE 1B-2 RESIDENTIAL		PROJECT No. 102085
DRAWING NAME PHASE 1B-2 RESIDENTIAL GEOMETRIC ROAD DESIGN DRAWING		REV # 1
		DRAWING No. 102085-GRD06

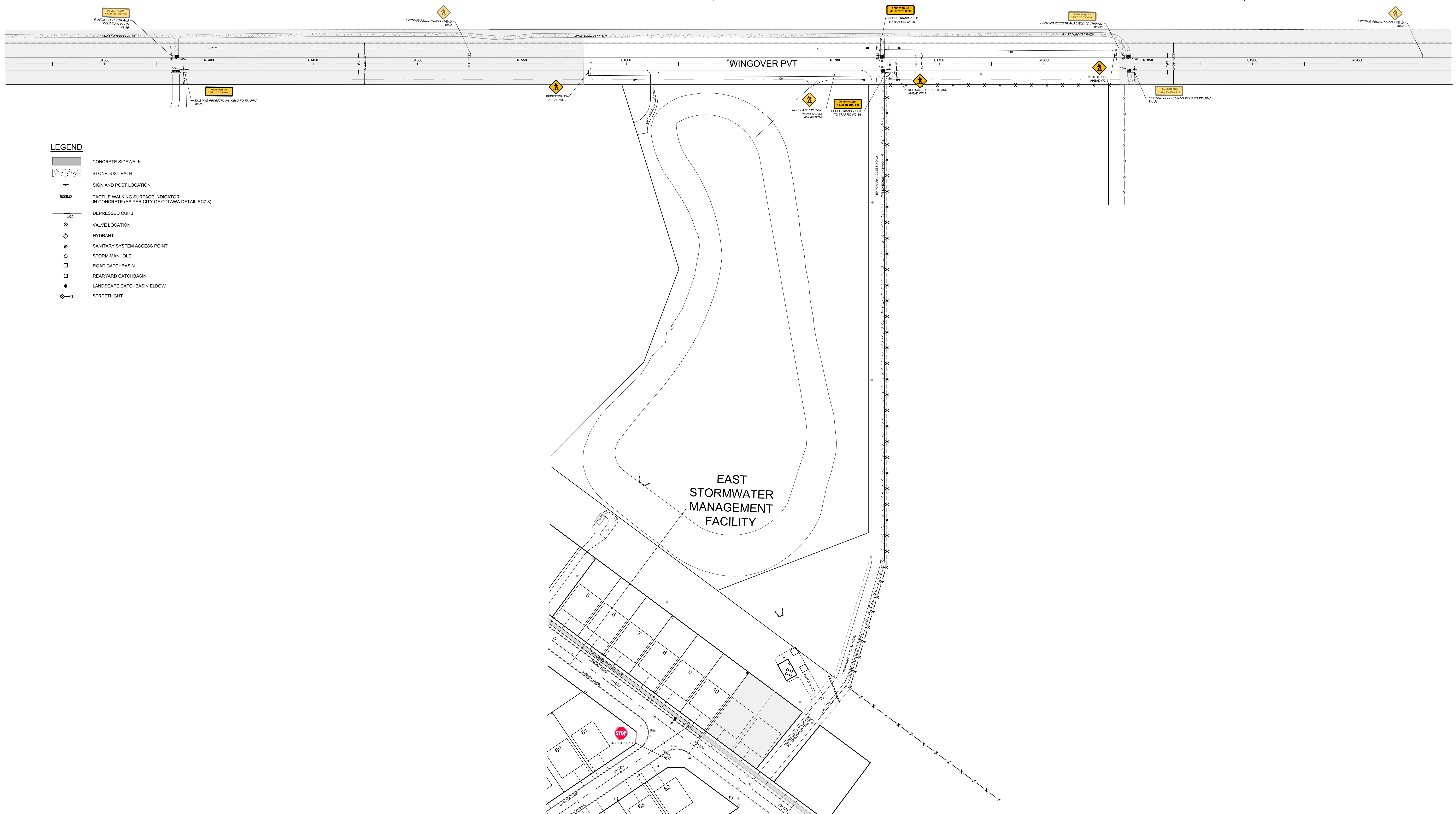
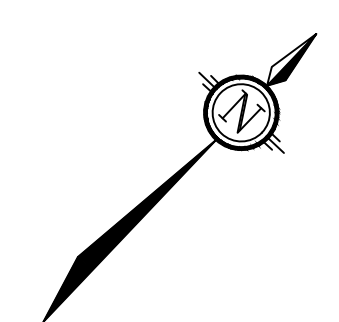
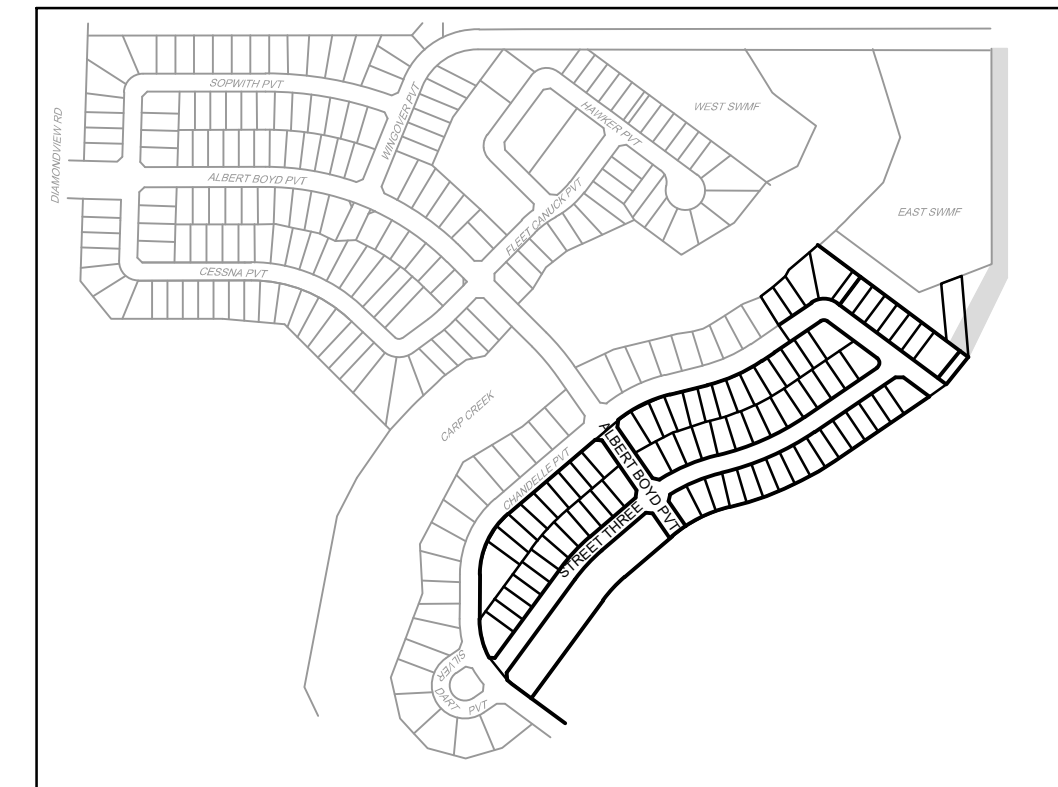

LEGEND

- CONCRETE SIDEWALK
- STONEDUST PATH
- SIGN AND POST LOCATION
- TACTILE WALKING SURFACE INDICATOR IN CONCRETE (AS PER CITY OF OTTAWA DETAIL SC7.3)
- DEPRESSED CURB
- VALVE LOCATION
- HYDRANT
- SANITARY SYSTEM ACCESS POINT
- STORM MANHOLE
- ROAD CATCHBASIN
- REARYARD CATCHBASIN
- LANDSCAPE CATCHBASIN ELBOW
- STREETLIGHT

C:\0205-GRDD\102055-2B5-GRDD.dwg GRDD7 Feb 15, 2024 1:58pm 1/20

NOTE:
 THE POSITION OF ALL POLE LINES, CONDUITS,
 WATERMANS, SEWERS AND OTHER
 UNDERGROUND AND OVERGROUND UTILITIES AND
 STRUCTURES IS NOT NECESSARILY SHOWN ON
 THE CONTRACT DRAWINGS, AND WHERE SHOWN,
 THE ACCURACY OF THE POSITION OF SUCH
 UTILITIES AND STRUCTURES IS NOT GUARANTEED.
 BEFORE STARTING WORK, DETERMINE THE EXACT
 LOCATION OF ALL SUCH UTILITIES AND
 STRUCTURES AND ASSUME ALL LIABILITY FOR
 DAMAGE TO THEM.

No.	REVISION	DATE	BY
1.	ISSUED FOR REVIEW	FEB 2024	ARM

SCALE	1:750
	0 10 20 30

FOR REVIEW ONLY	
DESIGN	AAR
CHECKED	ARM
DRAWN	AAR
CHECKED	ARM
APPROVED	SMG

NOVATECH
 Engineers, Planners & Landscape Architects
 Suite 200, 240 Michael Cowpland Drive
 Ottawa, Ontario, Canada K2M 1P6
 Telephone: (613) 254-9643
 Facsimile: (613) 254-5867
 Website: www.novatech-eng.com

LOCATION WEST CAPITAL AIRPARK PHASE 1B-2 RESIDENTIAL	DRAWING NAME PHASE 1B-2 RESIDENTIAL GEOMETRIC ROAD DESIGN DRAWING	PROJECT No. 102085
		REV # 1
		DRAWING No. 102085-GRDD7