

EXISTING OPEN SPACE

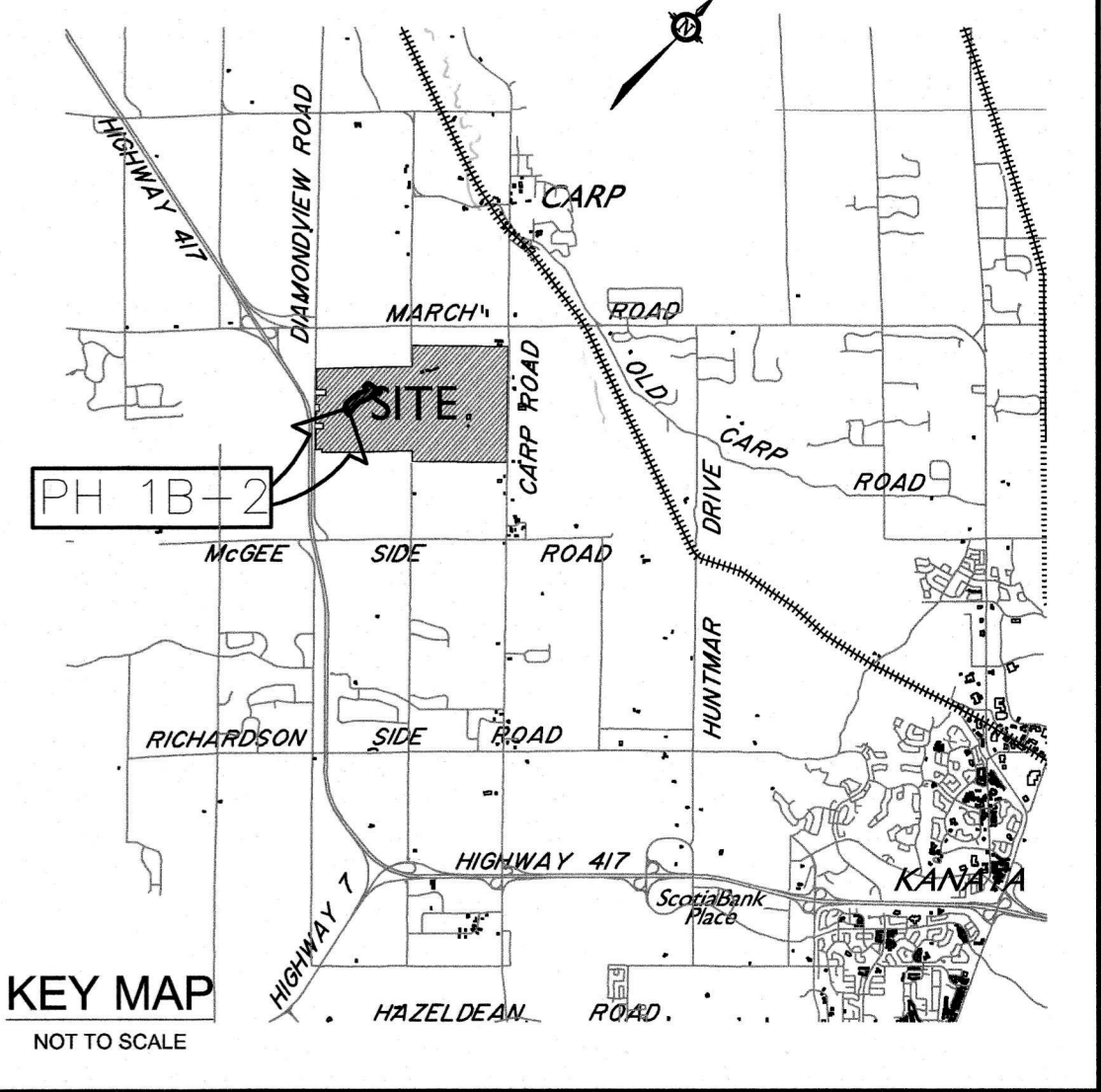
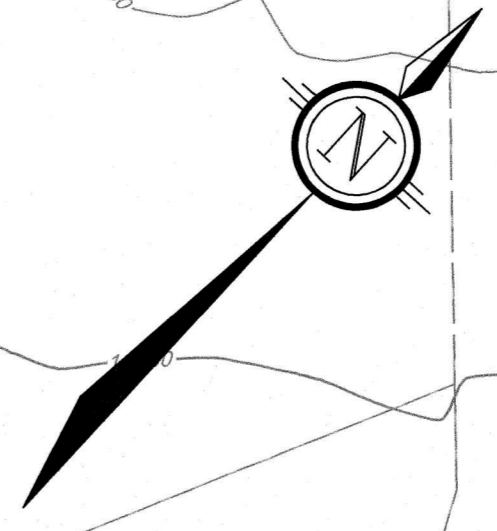

METRIC : MEASUREMENTS SHOWN ON THIS PLAN ARE IN METRES AND CAN BE CONVERTED TO FEET BY DIVIDING BY 0.3048.

DRAFT PLAN OF CONDOMINIUM OF PART OF LOTS 97, 98, 104, 105 120 TO 136 (INCLUSIVE) & 150 PART OF BLOCKS 160, 162, 163, 176 & 177 REGISTERED PLAN 4M-1593 CITY OF OTTAWA

CITY OF OTTAWA SCALE 1 : 1000

DATE: OCTOBER, 2022

SURVEYOR'S CERTIFICATE
 I HEREBY CERTIFY THAT THE BOUNDARIES OF THE LANDS TO BE SUBDIVIDED AND THEIR RELATIONSHIP TO ADJOINING LANDS ARE CORRECTLY SHOWN.
 DATED 2022/10/21
 JOHN H. GUTRI
 ONTARIO LAND SURVEYOR
 FAIRHALL MOFFATT & WOODLAND LIMITED
 ONTARIO LAND SURVEYORS
 JOB No. AB25601

OWNER'S CERTIFICATE
 I/WE, 1514947 ONTARIO INC., BEING THE REGISTERED OWNER(S), HEREBY AUTHORIZE NOVATECH TO PREPARE AND SUBMIT THIS DRAFT PLAN OF SUBDIVISION TO THE CITY OF OTTAWA FOR REVIEW AND APPROVAL.
 DATED _____
 ANDREW WILDBERGER
 (I have the authority to bind the company)

PROPOSED CONDOMINIUM BLOCKS FOR COMMON ELEMENTS.
 BLOCKS 85, 86, 87, & 88 -PRIVATE ROADS
 BLOCK 80 -OPEN SPACE
 BLOCKS 81 & 83 -SERVICING

WEST CAPITAL AIRPARK - PHASE 1B-2

NOVATECH
 Engineers, Planners & Landscape Architects
 Suite 200, 240 Michael Cowpland Drive
 Ottawa, Ontario, Canada K2M 1P6
 Telephone (613) 254-9643
 Facsimile (613) 254-5867
 Website www.novatech-eng.com

PROJECT No. 102085-1

M:\2022\102085\CAD\PHASE1B-2\Planning\Draft Plans\102085-DP-1B-2.dwg, DP-1B-2, 2022 - 10:58am, wsb

PLAN1.DWG - 9/11/2022