

6171 HAZELDEAN ROAD
OTTAWA, ONTARIO.

LIST OF DRAWINGS		
DWG NO.	DWG TITLE	REVISION NO.
	COVER SHEET	1
C001	LEGENDS AND NOTES	2
C002	TABLES	2
C100	SERVICING PLAN - PLAN 1	6
C101	SERVICING PLAN - PLAN 2	6
C200	GRADING PLAN - PLAN 1	5
C201	GRADING PLAN - PLAN 1	5
C300	PLAN AND PROFILE, STREET 1, STA.1+000 TO STA.1+125	3
C301	PLAN AND PROFILE, STREET 2, STA.0+000 TO STA.0+150	3
C302	PLAN AND PROFILE, STREET 2, STA.0+150 TO STA.0+300	3
C303	PLAN AND PROFILE, STREET 2, STA.0+300 TO STA.0+550	3
C304	PLAN AND PROFILE, STREET 2, STA.0+550 TO STA.0+700	3
C305	PLAN AND PROFILE, STREET 2, STA.0+700 TO STA.0+810	3
C306	PLAN AND PROFILE, STREET 4, STA.4+000 TO STA.4+150	3
C307	PLAN AND PROFILE, STREET 5, STA.5+000 TO STA.5+00	3
C308	PLAN AND PROFILE, SAMANTHA EASTOP, STA.7+000 TO STA.7+075	3
C309	PLAN AND PROFILE, SANITARY CONN. TO EXIST., STA.0+000 TO STA.0+125	3
C310	PLAN AND PROFILE, STORM CONN. TO EXIST., STA.0+000 TO STA.0+125	3
C400	POST DEVELOPMENT STORM DRAINAGE PLAN	5
C401	POST DEVELOPMENT PONDING PLAN	2
C500	SANITARY DRAINAGE PLAN	5
C600	EROSION AND SEDIMENT CONTROL PLAN	4
C700	DETAIL SHEET 1 - ROADWAY SECTIONS	2
C701	DETAIL SHEET 2 - TYPICAL SECTIONS	2
C702	DETAIL SHEET 4 - STORMWATER MANAGEMENT FACILITY	2
C703	DETAIL SHEET 5 - STORMWATER MANAGEMENT FACILITY DETAILS 1	2
C704	DETAIL SHEET 6 - STORMWATER MANAGEMENT FACILITY DETAILS 2	2
C800	PAVEMENT MARKINGS, SIGNAGE, AND GEOMETRY PLAN 1	1
C801	PAVEMENT MARKINGS, SIGNAGE, AND GEOMETRY PLAN 2	1

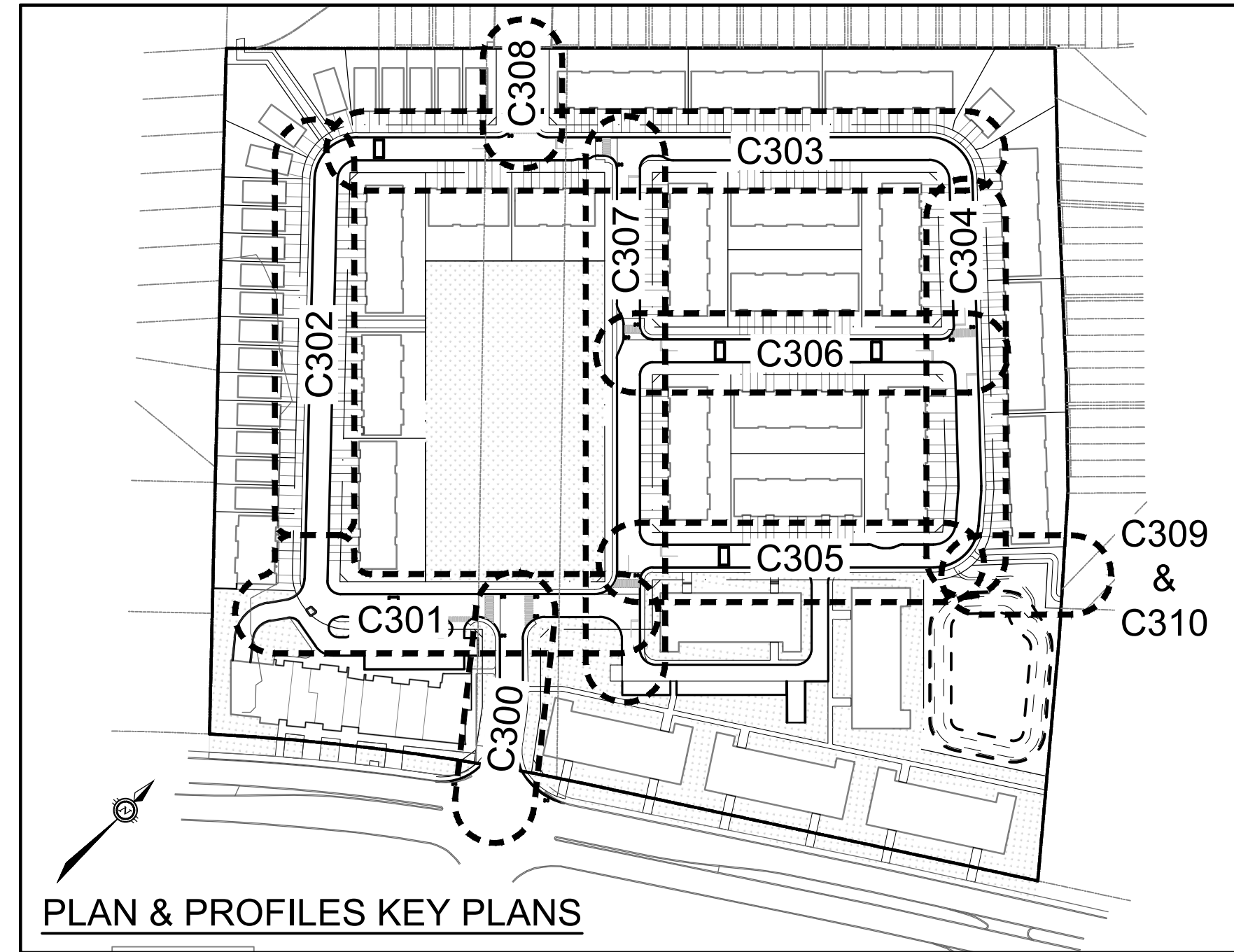
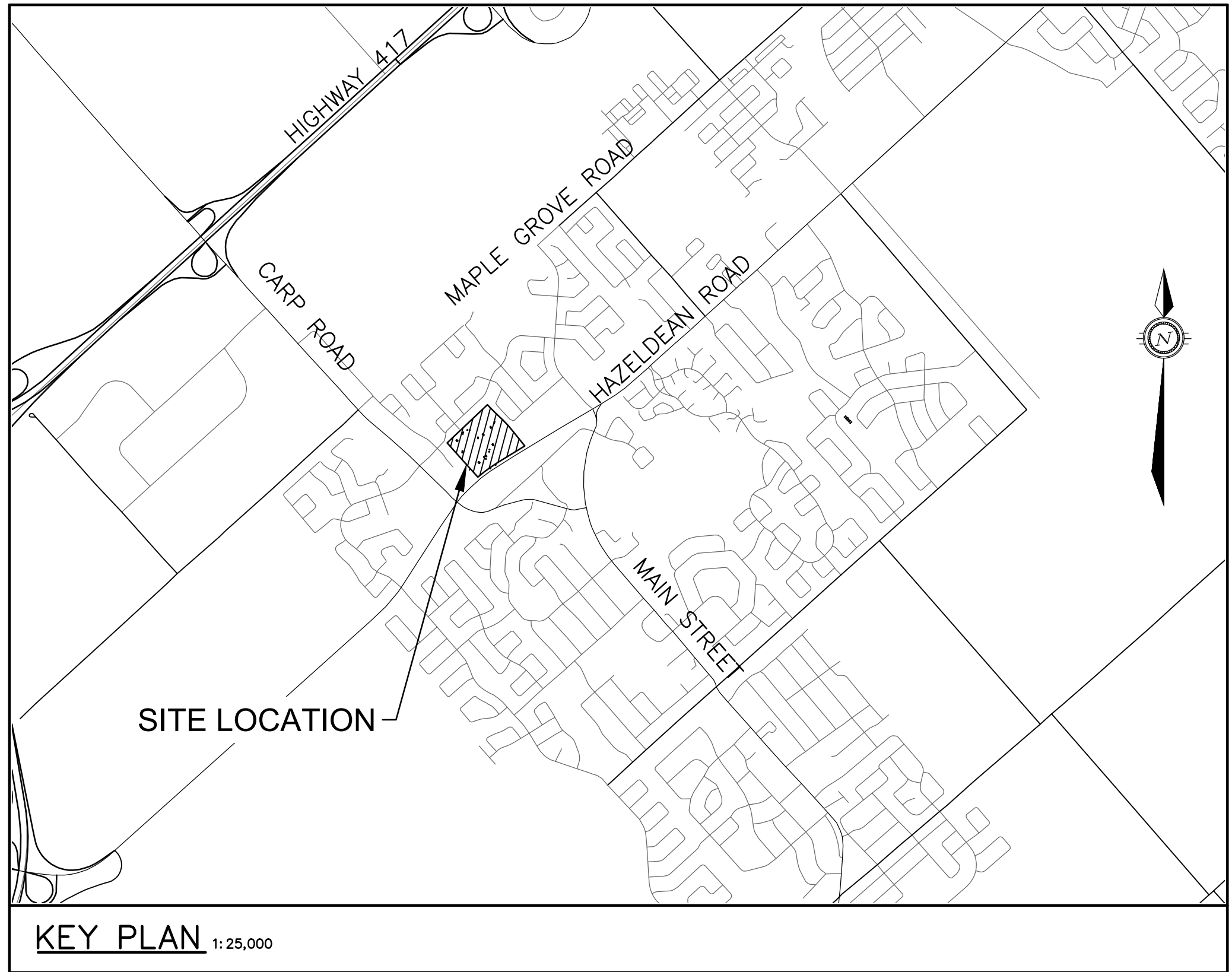
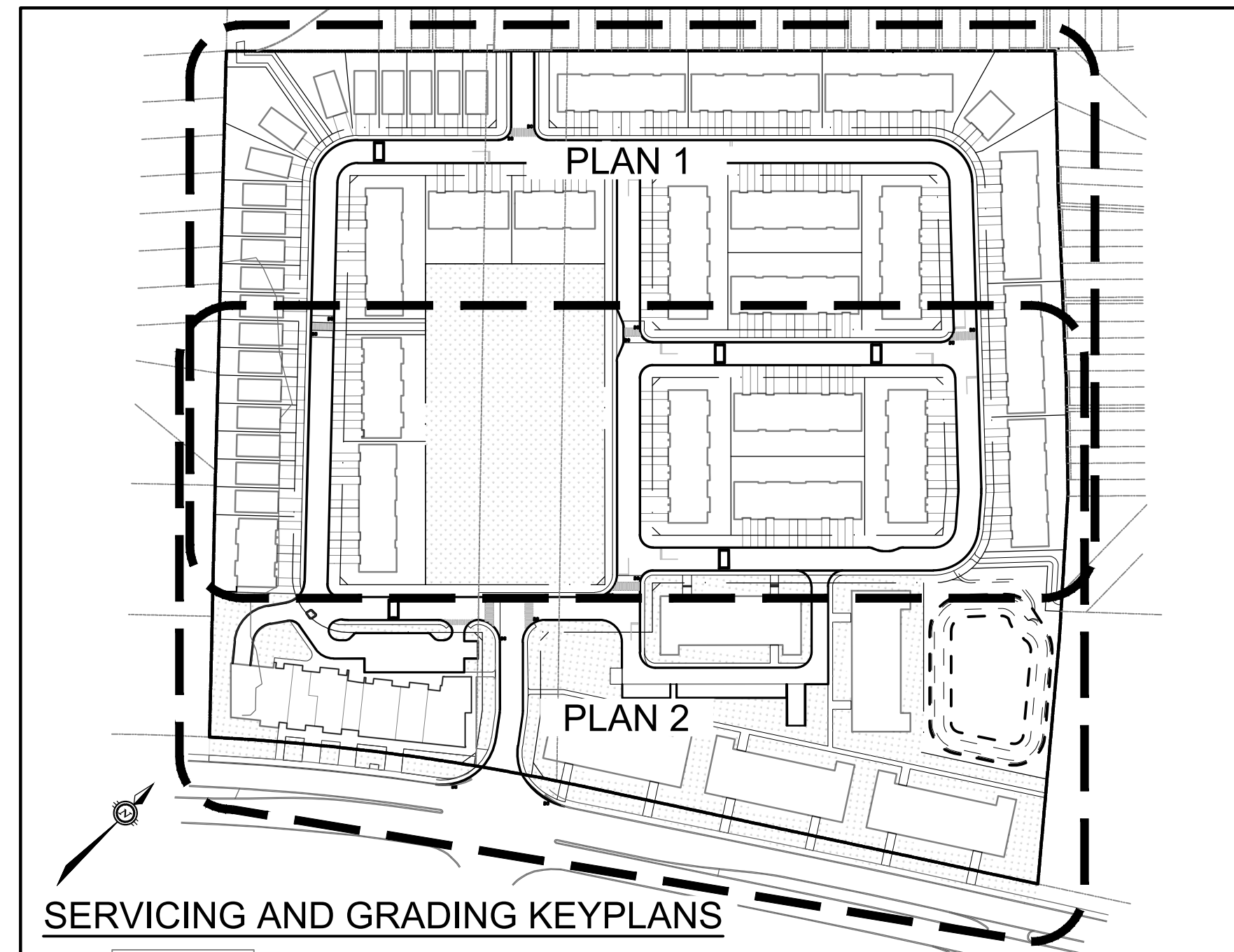

ISSUED FOR APPROVAL - MAY 12, 2022

exp Services Inc.
 T: +1.613.688.1899 | F: +1.613.225.7330
 2650 Queensview Drive, Unit 100
 Ottawa, ON K2B 8H6
 Canada
 www.exp.com

• BUILDINGS • EARTH & ENVIRONMENT • ENERGY •
 • INDUSTRIAL • INFRASTRUCTURE • SUSTAINABILITY •

PROJECT No.OTT-00258780-A0
OCTOBER 2022

1202 CARP ROAD
STITTSVILLE, ON. K2S 1B9

File Name: \\exp\proj\18\18-00258780-00\100\revision\05 drawings\05 covering\c000 covering.dwg
 User: jacob.k...
 Last Printed: 10/19/2022 12:13:32 PM
 Reference: _ref-FRM_Topo.dwg; _ref-FRM_Top.dwg