

Any reproduction or distribution for any purpose other than authorized by 110 Architects Inc. is forbidden. Written dimensions shall have precedence over scaled dimensions. Contractors shall verify and be responsible for all dimensions and conditions on the job. 110 Architects Inc. shall be informed of any variations from the dimensions and conditions shown on the drawing. Shop drawings shall be submitted to 110 Architects Inc. for approval before proceeding with fabrication.

KEY PLAN:

110 ARCHITECTS INC.
ARCHITECTURE + URBAN DESIGN

110 ARTHUR STREET, OTTAWA, ONTARIO, CANADA, K1R 7C2
TEL. 613-799-9117 E-mail: info@110architects.com

SEAL AND SIGNATURE:

CLIENT:
FORMASIAN DEVELOPMENT CORP.

1919 MAPLE GROVE ROAD
STITTSVILLE, ONTARIO K2S 1B9

TEL. (613) 836-9453
E-MAIL: vinceli@formasian.ca

PROJECT:
**1919 MAPLE GROVE
MASTER PLAN**

1919 Maple Grove Road

DATE ISSUED	REV.	DESCRIPTION	FOR SUBMISSION	BY
2021-04-06	5	DRAFT		
2021-02-11	4	COORDINATION		
2020-03-02	3	COORDINATION		
2020-02-26	2	CLIENT CHANGES		
2020-02-05	1	COORDINATION		

TITLE:
Site Plan

SCALE: AS NOTED

PROJECT No.: 010

DATE: DEC 31, 2019

APPROVED BY: JG

DRAWN BY: JG

A-001

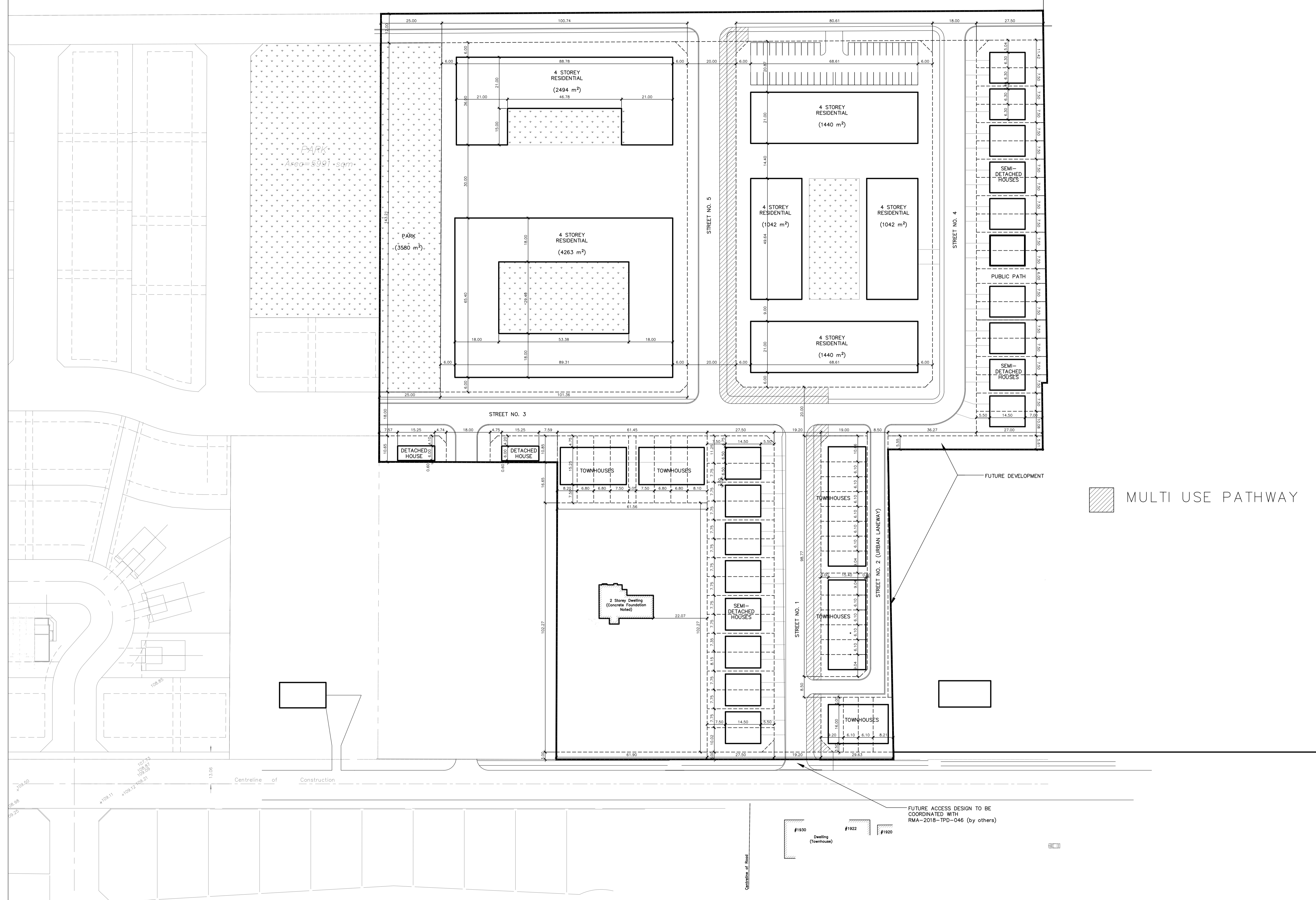

1919 MAPLE GROVE ROAD

**DEVELOPMENT
CONCEPT PLAN**

0 10 20 30 40 50 100 metres
SCALE : 1 : 750
DATE : 2016-02-20