

**KEY PLAN**  
N.T.S.

**LEGEND**

- PROPERTY LINE
- PROPOSED NOISE BARRIER
- RECEIVER - OUTDOOR LIVING AREA (OLA) / PLANE OF WINDOW (POW)
- PROPOSED ELEVATION
- UNIT TO BE DESIGNED WITH A PROVISION FOR THE INSTALLATION OF AIR CONDITIONING AND A WARNING CLAUSE ON TITLE

**NOTES:**

- NOISE CONTROL PLAN TO BE READ IN CONJUNCTION WITH NOISE IMPACT FEASIBILITY REPORT (R-2018-080) PREPARED BY NOVATECH. REFER TO REPORT FOR THE TYPICAL WARNING CLAUSES TO BE REGISTERED ON TITLE AND PROPOSED NOISE MITIGATION MEASURES.
- ROADWAY CLASSIFICATION AS PER CITY OF OTTAWA OFFICIAL PLAN, SCHEDULE F, CENTRAL AREA INNER CITY NETWORK.
- REFER TO GRADING PLANS (116132-GR1 to 116132-GR4) FOR ALL DETAILED GRADING INFORMATION.
- NOISE BARRIER REFERS TO ANY COMBINATION OF NOISE WALL, BERM AND/OR RETAINING WALL.

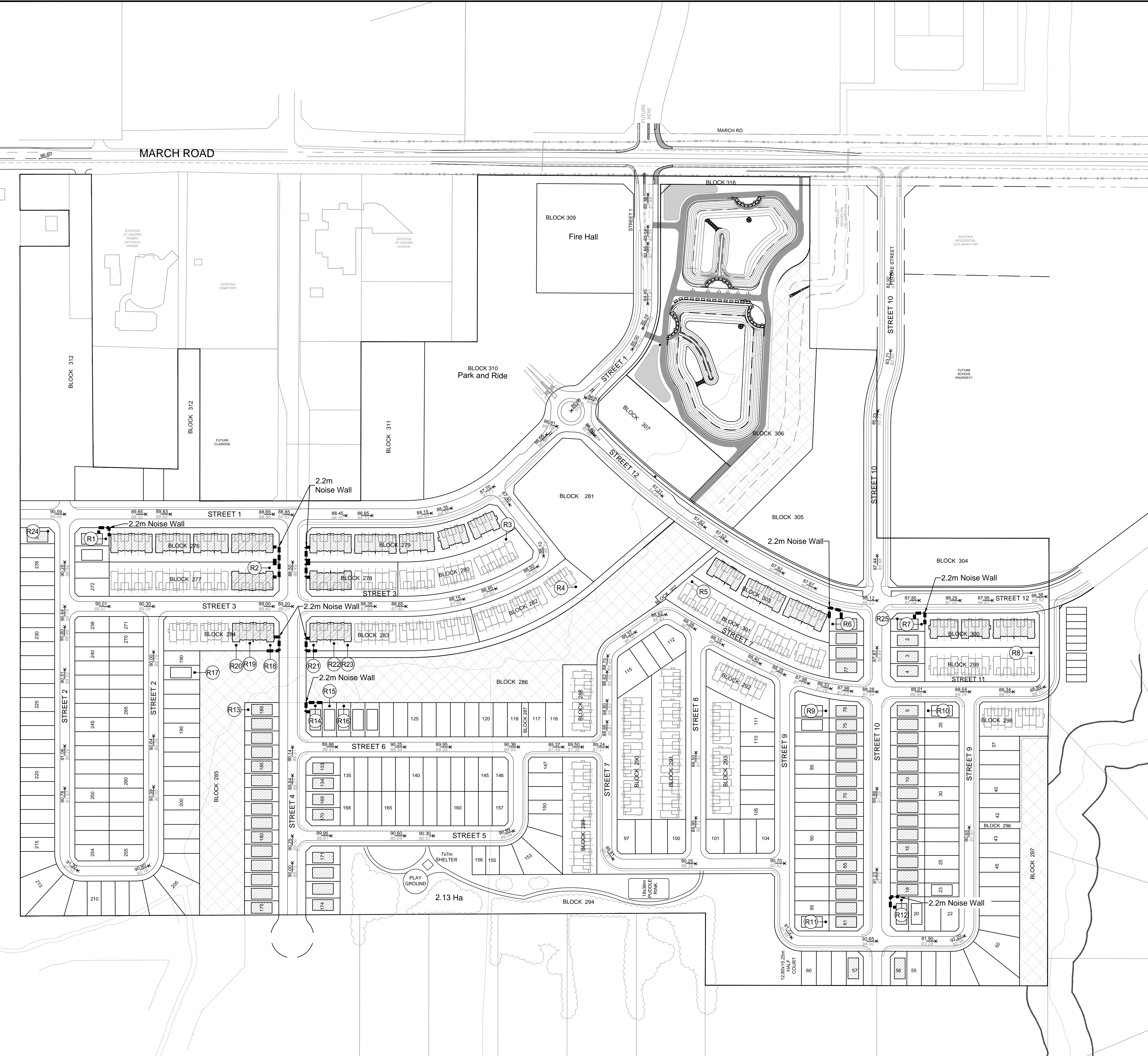

**RECEIVER DATA TABLE**

RECEIVER	HEIGHT (m)	RECEIVER INFORMATION			DISTANCES TO NOISE SOURCE (m)	
		RECEIVER GROUND ELEVATION (m)	ROAD ELEVATION STREET 1 (m)	ROAD ELEVATION STREET 4 (m)	STREET 1 (CENTERLINE)	STREET 4 (CENTERLINE)
R1	1.5	90.32	90.10	-	21.9	-
R2	1.5	89.27	88.68	88.64	47.7	20.6
R3	1.5	88.27	88.68	86.86	46.5	120.9
R4	1.5	88.38	-	87.26	-	111.0
R5	1.5	87.54	87.09	87.81	-	46.8
R6	1.5	88.36	87.99	87.25	39.5	24.7
R7	1.5	88.24	87.99	87.84	39.5	21.2
R8	1.5	88.72	-	88.23	-	47.2
R9	1.5	88.87	88.59	-	45.5	-
R10	1.5	88.96	88.59	-	45.5	-
R11	1.5	92.20	92.27	-	45.5	-
R12	1.5	92.48	91.84	-	21.9	-
R13	1.5	89.15	89.89	-	39.5	-
R14	1.5	89.18	89.86	-	20.2	-
R15	1.5	89.18	89.86	-	32.9	-
R16	1.5	89.18	89.86	-	45.5	-
R17	1.5	89.35	89.68	-	87.05	-
R18	1.5	89.32	89.46	-	19.9	-
R19	1.5	89.41	89.46	-	38.1	-
R20	1.5	89.47	89.46	-	50.2	-
R21	1.5	89.17	89.46	-	18.6	-
R22	1.5	88.87	89.46	-	36.8	-
R23	1.5	88.87	89.46	-	48.9	-

NOTE: THE POSITION OF ALL POLE LINES, CONDUITS, WATERMANS, SEWERS AND OTHER UNDERGROUND AND OVERGROUND UTILITIES AND STRUCTURES IS NOT NECESSARILY SHOWN ON THE CONTRACT DRAWINGS, AND WHERE SHOWN, THE ACCURACY OF THE POSITION OF SUCH UTILITIES AND STRUCTURES IS NOT GUARANTEED. BEFORE STARTING WORK, DETERMINE THE EXACT LOCATION OF ALL SUCH UTILITIES AND STRUCTURES AND ASSUME ALL LIABILITY FOR DAMAGE TO THEM.

No.	REVISION	DATE	BY
2	REVISED AS PER CITY OF OTTAWA COMMENTS	MAY 13/19	MSP
1	ISSUED FOR DRAFT PLAN OF SUBDIVISION APPLICATION	JULY 23/18	MSP

SCALE	DESIGN	CHECKED	DRAWN	APPROVED
1:1500	SAZ	SAZ	DDB	DDB
1:1500			TJM	DDB
0 15 45 60				MSP

**FOR REVIEW ONLY**

SCALE: 1:1500

DESIGN: SAZ

CHECKED: SAZ

DRAWN: DDB

SAZ

TJM

DDB

MSP

**NOVATECH**  
Engineers, Planners & Landscape Architects  
Suite 200, 240 Michael Copeland Drive  
Ottawa, Ontario, Canada K2M 1P6  
Telephone: (613) 254-9643  
Facsimile: (613) 254-5867  
Website: www.novatech-emp.com

**CITY OF OTTAWA**  
CU DEVELOPMENTS INC.  
1053, 1075 AND 1145 MARCH ROAD

DRAWING NAME: NOISE CONTROL PLAN

PROJECT NO.: 116132-NC  
REV: 116132-NC  
DRAWING NO.: 116132-NC

C:\Users\116132-NC\Desktop\116132-NC.dwg 1:16132-NC May 15, 2019 8:40am gprgmn

D07-16-18-0023

#17801