

EXISTING ELEVATION	85.64	86.05	86.77	86.49	85.41	85.36	85.50	85.27	84.54	84.19	84.01	EXISTING ELEVATION
PROPOSED ELEVATION	86.63	86.58	86.54	86.50	86.45	86.41	86.37	86.32	86.18	84.61	84.06	PROPOSED ELEVATION
CHAINAGE	50+600	50+625	50+660	50+675	50+700	50+725	50+750	50+775	50+800	50+825	50+850	CHAINAGE

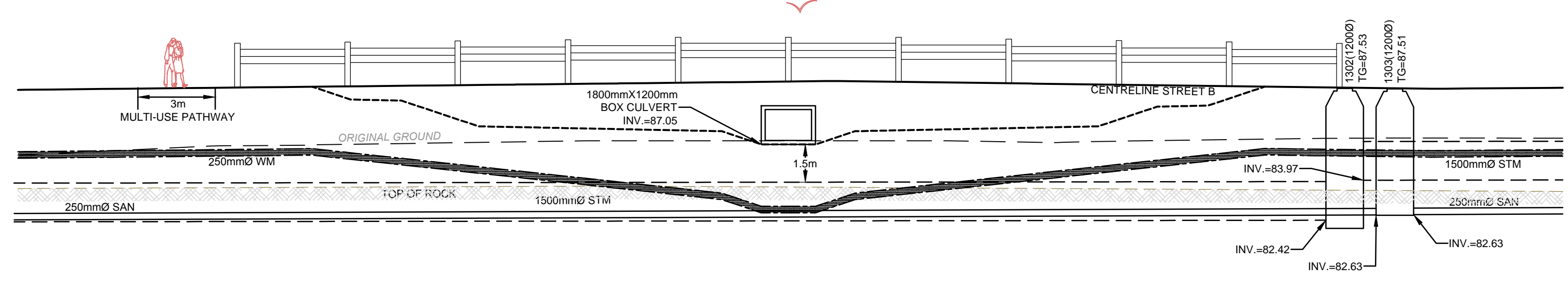

CREEK (40m CORRIDOR)
CROSS-SECTION G-G
SCALE 1:10

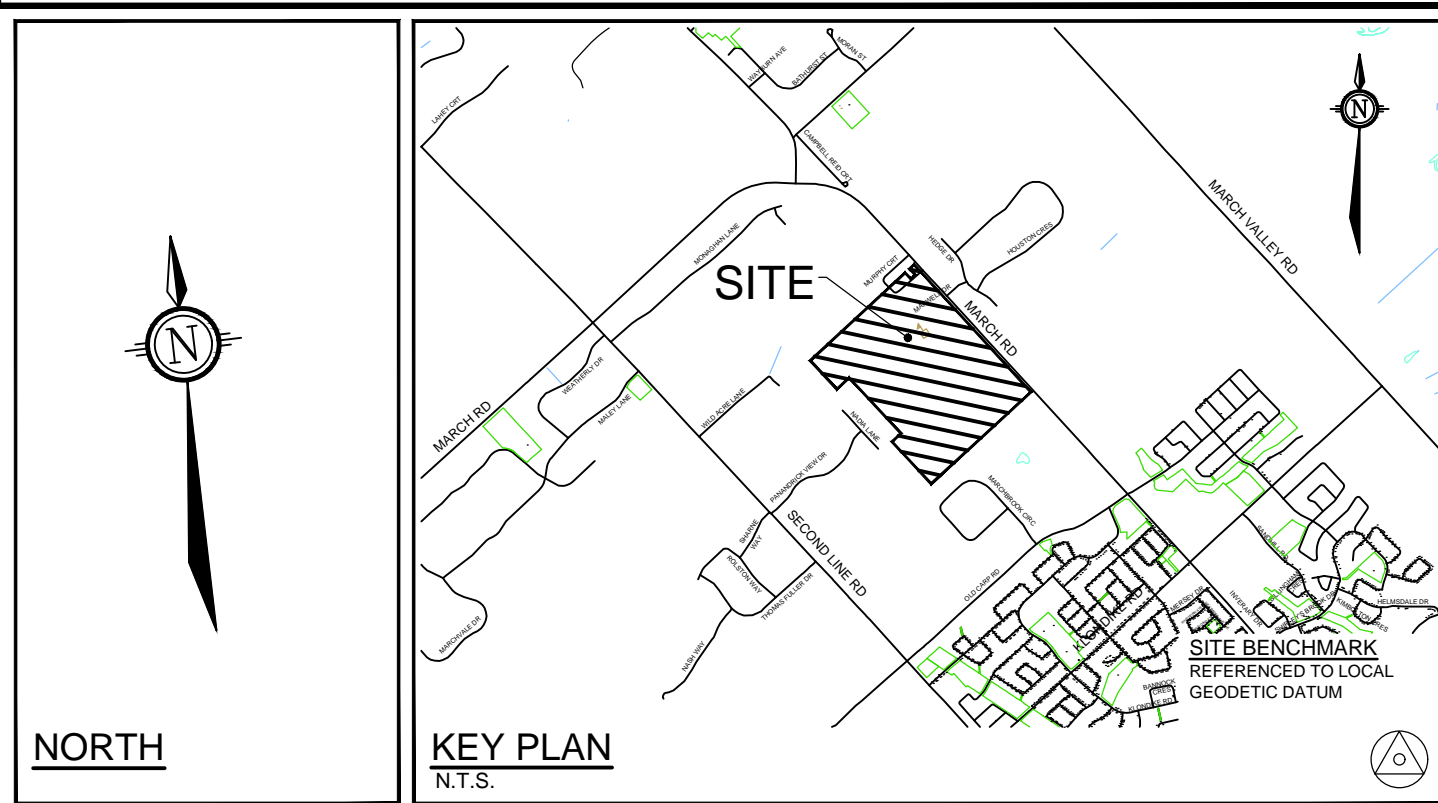

- LEGEND**
- PROPERTY LINE
 - RIGHT OF WAY LIMITS
 - PROPOSED DEPRESSED CURB
 - PROPOSED BARRIER CURB OR MOUNTABLE CURB
 - PROPOSED BARRIER CURB & SIDEWALK
 - 507 200mmØ PROPOSED SANITARY MANHOLE & SEWER
 - 300mmØ PROPOSED SANITARY FORCE MAIN
 - 675mmØ PROPOSED STORM MANHOLE & SEWER
 - CB 204 250mmØ PROPOSED CATCHBASIN/MANHOLE & LEAD
 - CB 34 PROPOSED CATCHBASIN & LEAD
 - RYCB 6 250mmØ PROPOSED REAR YARD CATCHBASIN & SUB-DRAIN
 - 200mmØ PROPOSED SWALE
 - PROPOSED WATERMAIN
 - V&VB PROPOSED VALVE & VALVE BOX LOCATION
 - HYD PROPOSED FIRE HYDRANT CW LEAD
 - 45° PROPOSED WATERMAIN BEND
 - DIRECTION OF FLOW
 - PROPOSED SERVICES LOCATION
 - PROPOSED HEAD WALL
 - PROPOSED RETAINING WALL
 - PROPOSED PEDESTRIAN CROSSOVER
 - PROPOSED PHASING LIMITS
 - EXISTING DITCH
 - 74 450mmØ EXISTING SANITARY MANHOLE & SEWER
 - 300mmØ EXISTING WATERMAIN
 - HYD EXISTING FIRE HYDRANT CW LEAD
 - V&VB EXISTING VALVE & VALVE BOX LOCATION
 - V&VC EXISTING VALVE & VALVE CHAMBER LOCATION
 - UP EXISTING UTILITY POLE
 - OHW EXISTING OVER HEAD WIRE
 - EXISTING SIDEWALK

C:\Users\116132\OneDrive\116132-CRK3-DRAFT.dwg, 116132-CRK3-DRAFT, Jul 25, 2018, 3:15pm, azogel

NOTE:
THE POSITION OF ALL POLE LINES, CONDUITS, WATERMANS, SEWERS AND OTHER UNDERGROUND AND OVERGROUND UTILITIES AND STRUCTURES IS NOT NECESSARILY SHOWN ON THE CONTRACT DRAWINGS, AND WHERE SHOWN, THE ACCURACY OF THE POSITION OF SUCH UTILITIES AND STRUCTURES IS NOT GUARANTEED. BEFORE STARTING WORK, DETERMINE THE EXACT LOCATION OF ALL SUCH UTILITIES AND STRUCTURES AND ASSUME ALL LIABILITY FOR DAMAGE TO THEM.

**PRELIMINARY
NOT FOR
CONSTRUCTION**

No.	REVISION	DATE	BY
1.	ISSUED FOR DRAFT PLAN OF SUBDIVISION APPLICATION	JULY 23/18	SAZ

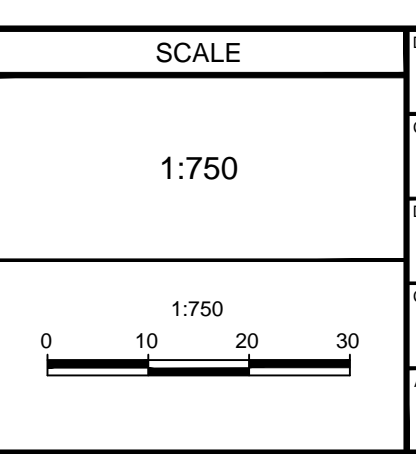

DESIGN: SAZ
CHECKED: DDB
DRAWN: RBG
CHECKED: SAZ
APPROVED: DDB

FOR REVIEW ONLY

NOVATECH
Engineers, Planners & Landscape Architects
Suite 200, 240 Michael Copeland Drive
Ottawa, Ontario, Canada K2M 1P6
Telephone: (613) 254-9643
Facsimile: (613) 254-5867
Website: www.novatech-eng.com

REFER TO _____ FOR ADDITIONAL NOTES

LOCATION
CITY OF OTTAWA
CLARIDGE / UNIFORM DEVELOPMENTS INC. (KNUEA)

DRAWING NAME
**CREEK PLAN AND PROFILE
STATION 50+600 TO 50+850**

PROJECT No.: 116132
REV # 1
DRAWING No.: 116132
CRK3-DRAFT