

PLAN OF SURVEY OF

**BLOCK 1
REGISTERED PLAN 4M-1303
CITY OF OTTAWA**

Surveyed by Annis, O'Sullivan, Vollebakk Ltd.

Scale 1 : 250
10 7.5 5.0 2.5 0 5 10 Metres

Metric
DISTANCES SHOWN ON THIS PLAN ARE IN METRES AND
CAN BE CONVERTED TO FEET BY DIVIDING BY 0.3048

Surveyor's Certificate

- I CERTIFY THAT:
- This survey and plan are correct and in accordance with the Surveys Act, the Surveyors Act and the Land Titles Act and the regulations made under them.
 - The survey was completed on the 27th day of September, 2017.

October 19, 2017
Date
Andrew J. Broxham
Ontario Land Surveyor

Notes & Legend

- | Denotes | |
|---------|-----------------------------------|
| — | Survey Monument Planted |
| — | Survey Monument Found |
| SSB | Standard Iron Bar |
| SSIB | Short Standard Iron Bar |
| IB | Iron Bar |
| CP | Concrete Pin |
| (WIT) | Witness |
| Meas. | Measured |
| (AOG) | Annis, O'Sullivan, Vollebakk Ltd. |
| (PI) | Registered Plan 4M-1303 |
| (P2) | (867) Plan March 3, 2017 |
| (P3) | Plan 4R-23360 |
| CB | Catch Basin |
| CB | Catch Basin Inlet |
| — | Overhead Wires |
| — | Utility Pole |
| + AN | Anchor |
| — | Deciduous Tree |
| — | Coniferous Tree |
| — | Fire Hydrant |
| — | Maintenance Hole (Storm Sewer) |
| — | Maintenance Hole (Sanitary) |
| — | Water Valve |
| — | Sign |
| — | Diameter |
| + 65.00 | Location of Elevations |
| + 65.00 | Top of Concrete Curb Elevation |
| T/G | Top of Grate |
| — | Property Line |
| — | Wood Pole |

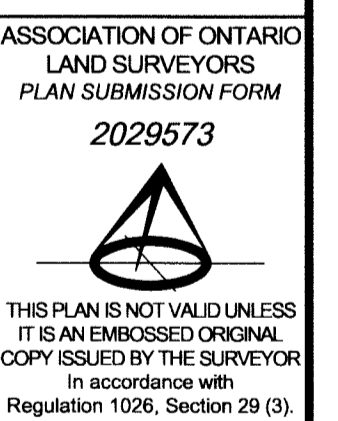

Bearings are grid, derived from the westerly limit of Block 1 Registered Plan 4M-1303 shown to be N29°34'50"W thereon and are referred to the Central Meridian of MTM Zone 9 (76°30' West Longitude) NAD-83 (original).

SITE AREA = 6027 m²

ELEVATION NOTES

- Elevations shown are geodetic and are referred to the CGVD28 geodetic datum.
- It is the responsibility of the user of this information to verify that the job benchmark has not been altered or disturbed and that its relative elevation and description agrees with the information shown on this drawing.

UTILITY NOTES

- This drawing cannot be accepted as acknowledging all of the utilities and it will be the responsibility of the user to contact the respective utility authorities for confirmation.
- Only visible surface utilities were located.
- A field location of underground plant by the pertinent utility authority is mandatory before any work involving breaking ground, probing, excavating etc.

© Annis, O'Sullivan, Vollebakk Ltd. 2017. THIS PLAN IS PROTECTED BY COPYRIGHT!
ANNIS, O'SULLIVAN, VOLLEBAKK LTD.
14 Concourse Gate, Suite 500
Nepean, Ont. K2E 7S6
Phone: (613) 727-9850 / Fax: (613) 727-1079
Email: info@aosvl.com
888 No. 18402-17, Dymco Bldg. | 4M-1303 T F

