

LEGEND

- PROPOSED HYDRANT
- PROPOSED VALVE AND VALVE BOX
- PROPOSED 600mm x 600mm CATCH BASIN
- CW 150mm Ø PERFORATED SUBDRAIN
- PROPOSED 1200mmØ CATCH BASIN MANHOLE
- CW 150mm Ø PERFORATED SUBDRAIN
- PROPOSED STORM MANHOLE (1200mmØ UNLESS OTHERWISE NOTED)
- PROPOSED SANITARY MANHOLE (1200mmØ UNLESS OTHERWISE NOTED)
- PROPOSED SITE LIGHTING
- PROPERTY LINE
- PROPOSED HEAVY DUTY ASPHALT
- EMERGENCY OVERLAND FLOW ROUTE
- PROPOSED BUILDING ENTRANCE
- PROPOSED GRADE
- EXISTING ELEVATION
- PROPOSED SLOPE AND DRAINAGE DIRECTION
- PROPOSED TOP OF GRATE ELEVATION
- PROPOSED RETAINING WALL
- PROPOSED BARRIER CURB
- EXISTING BUILDING ENTRANCE
- EXISTING SITE LIGHTING
- EXISTING HEAVY DUTY ASPHALT
- EXISTING MANHOLE
- EXISTING CATCHBASIN
- EXISTING TOP OF GRATE ELEVATION
- EXISTING HYDRANT
- EXISTING VALVE AND VALVE BOX
- EXISTING LIGHT POLE TO BE RELOCATED
- PROPOSED SILT FENCE
- PROPOSED SWALE
- 100 YEAR PONDING LEVEL
- 5 YEAR PONDING LEVEL
- PROPOSED ROBUST VEGETATED BUFFER
- PROPOSED BERM
- EXISTING BERM

NOTES: EROSION & SEDIMENT CONTROL

1. ALL EROSION PROTECTION MEASURES SHALL BE INSPECTED DAILY AND AFTER EVERY RAINFALL THEY SHALL BE MAINTAINED, CLEANED OUT AND REPLACED AS SOON AS SEDIMENT BUILD UP OR INCORRECT INSTALLATION IS OBSERVED BY THE CONTRACTOR OR AS REQUIRED BY THE ENGINEER, CITY OR CONSERVATION AUTHORITY. CLEAN OUT AND REPAIRS SHALL BE MAINTAINED UNTIL CONSTRUCTION IS COMPLETE AND THE SOIL HAS TAKEN AND SLOPES ARE STABLE.
2. ANY FUEL SPILLS SHALL BE CONTAINED & CLEANED UP IMMEDIATELY. THE MINISTRY OF THE ENVIRONMENT MUST BE NOTIFIED IMMEDIATELY IF A SPILL OCCURS. CONTACT THE MOE SPILLS ACTION CENTRE: 1-800-268-0000, IF OUTSIDE THE BUSINESS HOURS OF THE LOCAL MOE OFFICE. CONTAINMENT, CLEAN UP AND REMOVAL OF CONTAMINATED SOILS MUST COMPLY WITH PART X OF THE ENVIRONMENTAL PROTECTION ACT (EPA).
3. THE CONTRACTOR SHALL IMPLEMENT BEST MANAGEMENT PRACTICES, TO PROVIDE FOR PROTECTION OF THE AREA DRAINAGE SYSTEM AND THE RECEIVING WATERCOURSE, DURING CONSTRUCTION ACTIVITIES. THIS INCLUDES LIMITING THE AMOUNT OF EXPOSED SOIL, USING FILTER CLOTH UNDER THE GRATES OF CATCHBASINS AND MANHOLES AND INSTALLING SILT FENCES AND OTHER EFFECTIVE SEDIMENT TRAPS. THE CONTRACTOR ACKNOWLEDGES THAT FAILURE TO IMPLEMENT APPROPRIATE EROSION AND SEDIMENT CONTROL MEASURES MAY SUBJECT TO PENALTIES IMPOSED BY ANY APPLICABLE REGULATORY AGENCY.
4. THE CONTRACTOR SHALL PROTECT ALL TREES NOT DESIGNATED FOR REMOVAL AS PER CITY SPEC. F-5651. TREES SHALL BE PROTECTED FROM CONSTRUCTION EQUIPMENT MOVEMENTS, STOCKPILING OF ANY MATERIALS WITHIN DRIP LINES AND FROM UNNECESSARY EXCAVATION STOCKPILING OF ANY MATERIALS WITHIN DRIP LINES AND FROM UNNECESSARY EXCAVATION ENCROACHING TREE PROTECTION BARRIERS AS PER OPSD-220.01. INSPECT, MAINTAIN, REPAIR AND REPLACE AS NECESSARY UNTIL ALL CONSTRUCTION IS COMPLETE.

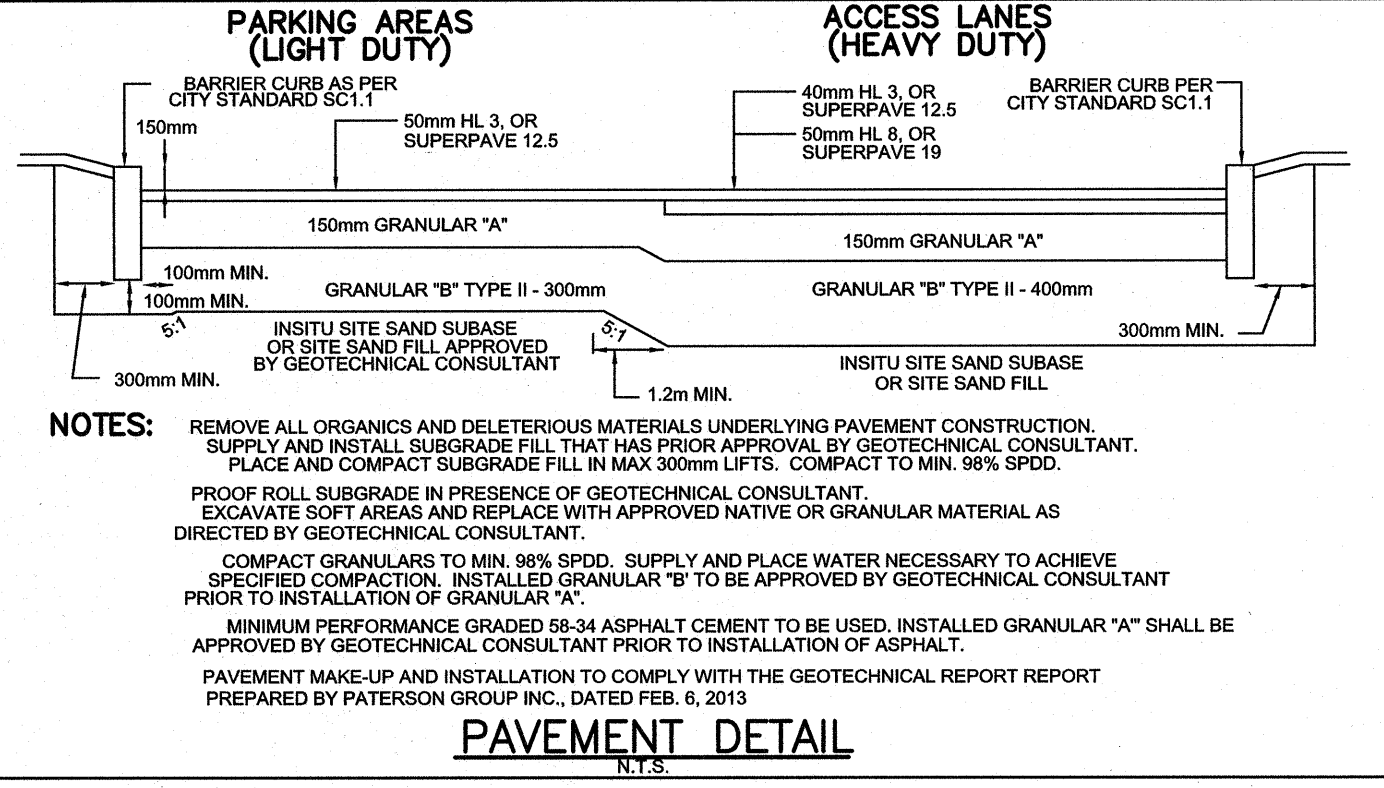
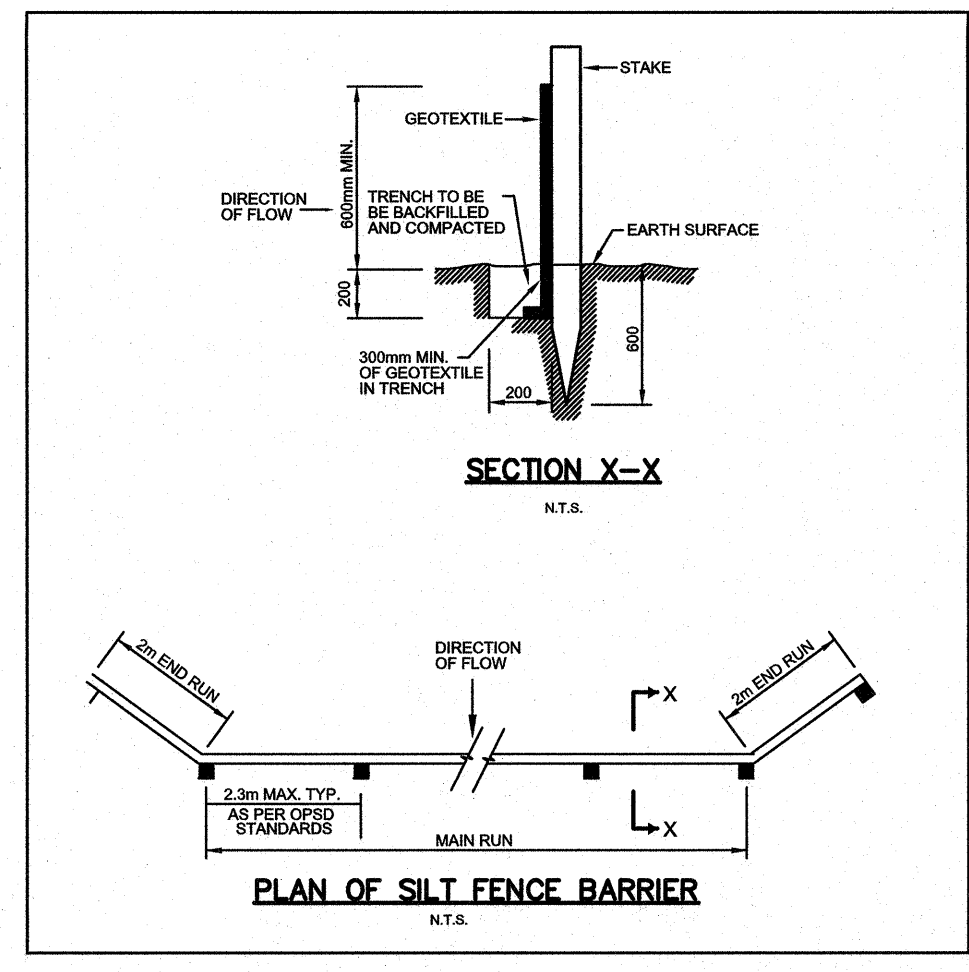

NOTES:

- REMOVE ALL ORGANICS AND DELETERIOUS MATERIALS UNDERLYING PAVEMENT CONSTRUCTION. SUPPLY AND INSTALL SUBGRADE FILL THAT HAS PRIOR APPROVAL BY GEOTECHNICAL CONSULTANT. PLACE AND COMPACT SUBGRADE FILL IN MAX 300mm LIFTS. COMPACT TO MIN. 98% SPDD.
- PROOF ROLL SUBGRADE IN PRESENCE OF GEOTECHNICAL CONSULTANT.
- EXCAVATE SOFT AREAS AND REPLACE WITH APPROVED NATIVE OR GRANULAR MATERIAL AS DIRECTED BY GEOTECHNICAL CONSULTANT.
- COMPACT GRANULARS TO MIN. 98% SPDD. SUPPLY AND PLACE WATER NECESSARY TO ACHIEVE SPECIFIED COMPACTION. INSTALLED GRANULARS TO BE APPROVED BY GEOTECHNICAL CONSULTANT PRIOR TO INSTALLATION OF GRANULARS "A".
- MINIMUM PERFORMANCE GRADED SS-04 ASPHALT CEMENT TO BE USED. INSTALLED GRANULARS "A" SHALL BE APPROVED BY GEOTECHNICAL CONSULTANT PRIOR TO INSTALLATION OF ASPHALT.
- PAVEMENT MAKEUP AND INSTALLATION TO COMPLY WITH THE GEOTECHNICAL REPORT REPORT PREPARED BY PATERSON GROUP INC., DATED FEB. 6, 2015.

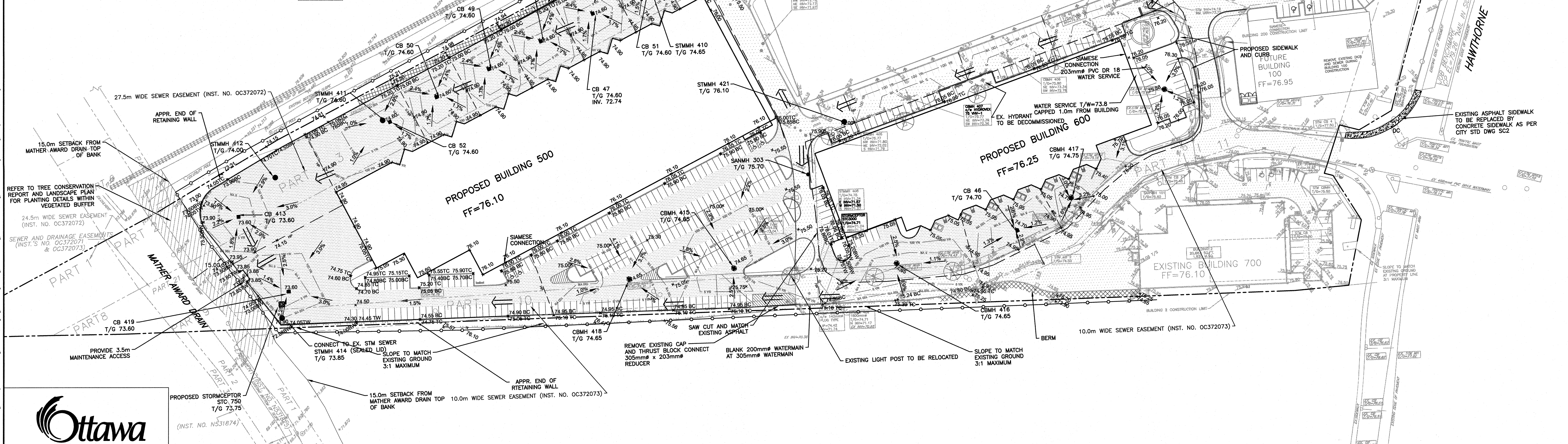

NOTES

THE POSITION OF ALL POLE LINES, CONDUITS, WATERMANS, SEWERS AND OTHER UNDERGROUND AND OVERGROUND UTILITIES AND STRUCTURES IS NOT NECESSARILY SHOWN ON THE CONTRACT DRAWINGS, AND WHERE SHOWN, THE ACCURACY OF THE POSITION OF SUCH UTILITIES AND STRUCTURES IS NOT GUARANTEED. BEFORE STARTING WORK, DETERMINE THE EXACT LOCATION OF ALL SUCH UTILITIES AND STRUCTURES AND ASSUME ALL LIABILITY FOR DAMAGE TO THEM.

NO.	REVISION DESCRIPTION	DATE	BY	APPD
6	REVISED ISSUE FOR SITE PLAN APPROVAL BUILDING 500 & 600	13/10/16	ML	AA
5	ADDED EXTERNAL DRAINAGE STM SEWER	27/05/16	ML	AA
4	REVISED PER CITY COMMENTS	12/05/16	ML	AA
3	REVISED PER CITY COMMENTS	18/04/16	ML	AA
2	REVISED ISSUE FOR SITE PLAN APPROVAL BUILDING 500 & 600	11/12/15	ML	AA
1	ISSUED FOR SITE PLAN APPROVAL BUILDING 500 & 600	09/11/15	ML	AA

1172321 ONTARIO INCORPORATED
223 COLONNADE RD. S., OTTAWA
K2E 7K3

exp.

3020 HAWTHORNE ROAD
BUILDING 500, 600
CITY OF OTTAWA

EROSION & SEDIMENT CONTROL PLAN

SCALE: 1:750

exp. M.A. ANSARI

exp.

224388

OCTOBER 2015

ESC1