

1 FRONT ENTRANCE PLAZA

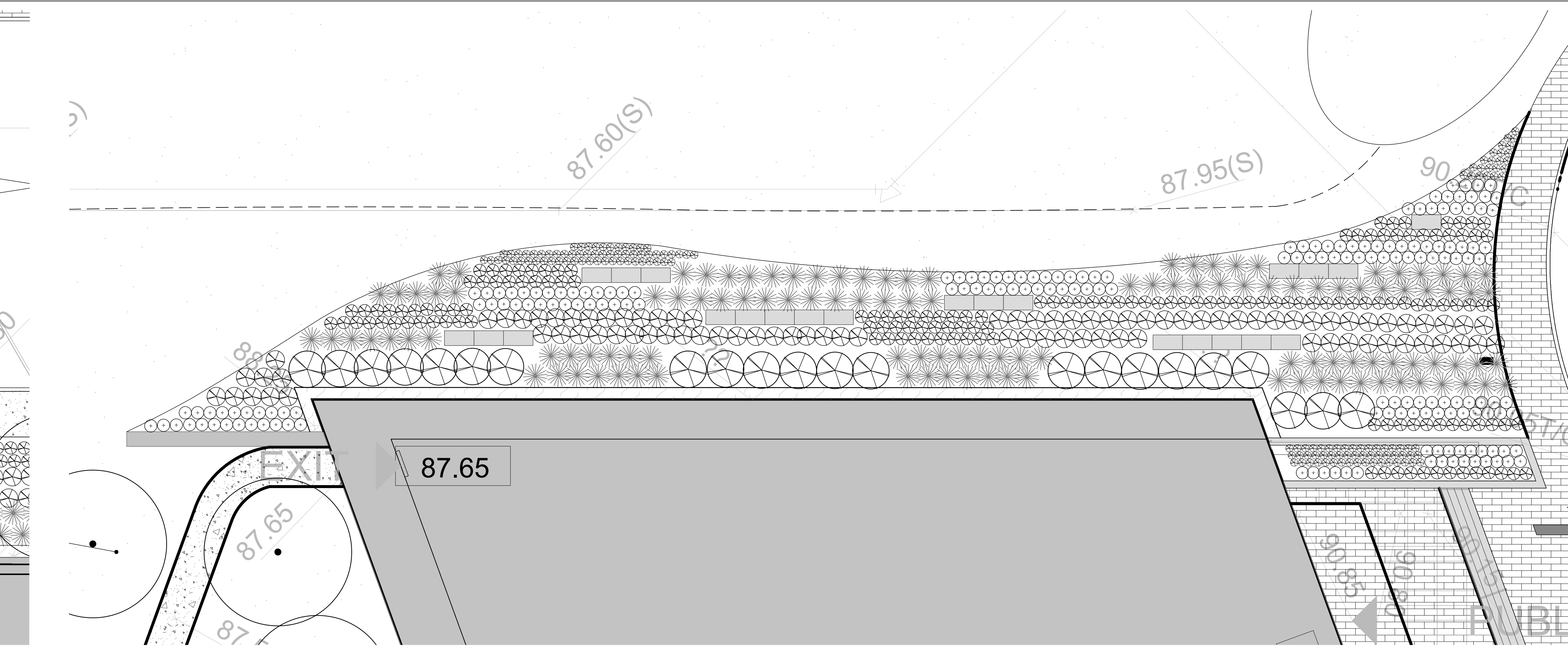

2 WEST FACADE PLANTING

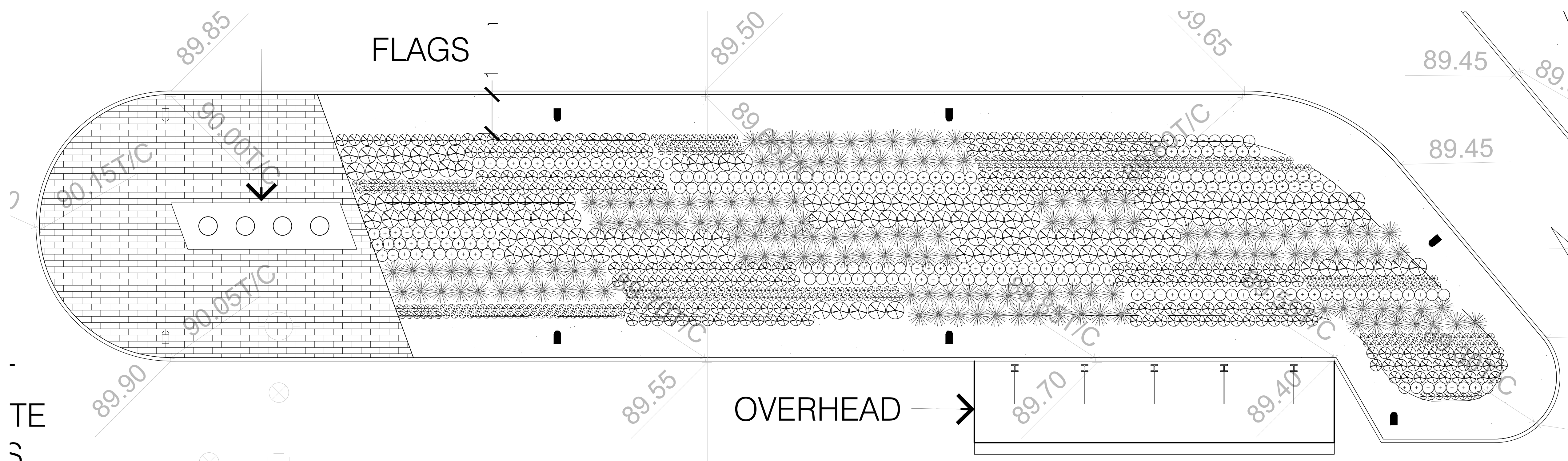

3 TURNING CIRCLE ISLAND PLANTING

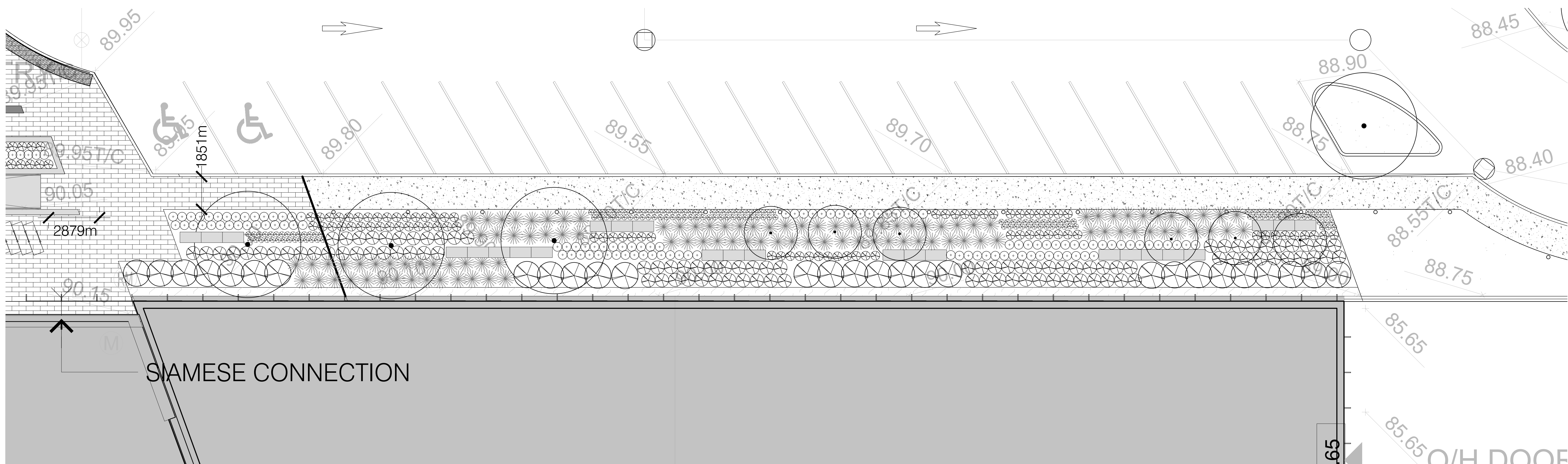

3 SHELL SPACE BORDER PLANTING

TURNING CIRCLE ISLAND PLANT LIST				
DECIDUOUS TREES				
KEY	QTY	BOTANICAL NAME	COMMON NAME	SIZE
Cc	3	Crataegus crataegus var. pinnatifida	Thornless Cockspur Hawthorn	25cm H
DECIDUOUS SHRUBS				
Nv	4	Ilex verticillata	Winterberry	2 Gal. Potted
Ph	0	Physocarpus opulifolius	Ninebark	2 Gal. Potted
Rsp	0	Rhus aromatica 'Gro-Low'	Fragrant Sumac	3 Gal. Potted
CONIFEROUS SHRUBS				
Jh	0	Juniperus horizontalis 'Hughes'	Hughes Juniper	3 Gal. Potted
Jw	0	Juniperus horizontalis 'Wilton'	Blue Rug Juniper	3 Gal. Potted
Js	0	Juniperus sabina	Savin Juniper	3 Gal. Potted
GRASSES				
Dc	0	Deschampsia cespitosa	Tufted Hair Grass	1 Gal. Potted
Ec	0	Elymus canadensis	Canada Wild Rye	1 Gal. Potted
Fg	0	Festuca glauca	Blue Fescue	1 Gal. Potted
PERENNIALS				
Ls	0	Leistis spicata	Dense Blazing Star	1 Gal. Potted
Rh	0	Rudbeckia hirta	Glorious Daisy	1 Gal. Potted
Sr	0	Sedum reflexum 'Angelina'	Angelina Sedum	1 Gal. Potted

FRONT ENTRANCE PLAZA PLANT LIST				
DECIDUOUS SHRUBS				
Ac	4	Anemone canadensis	Serviceberry	17cm H W.B.
Ph	0	Physocarpus opulifolius	Ninebark	2 Gal. Potted
CONIFEROUS SHRUBS				
Jh	0	Juniperus horizontalis 'Hughes'	Hughes Juniper	3 Gal. Potted
Jw	0	Juniperus horizontalis 'Wilton'	Blue Rug Juniper	3 Gal. Potted
Js	0	Juniperus sabina	Savin Juniper	3 Gal. Potted
GRASSES				
Dc	0	Deschampsia cespitosa	Tufted Hair Grass	1 Gal. Potted
Ec	0	Elymus canadensis	Canada Wild Rye	1 Gal. Potted
Fg	0	Festuca glauca	Blue Fescue	1 Gal. Potted
PERENNIALS				
Ls	0	Leistis spicata	Dense Blazing Star	1 Gal. Potted
Rh	0	Rudbeckia hirta	Glorious Daisy	1 Gal. Potted
Sr	0	Sedum reflexum 'Angelina'	Angelina Sedum	1 Gal. Potted

WEST FACADE PLANT LIST				
DECIDUOUS SHRUBS				
Ac	4	Anemone canadensis	Serviceberry	17cm H W.B.
Ph	0	Physocarpus opulifolius	Ninebark	2 Gal. Potted
CONIFEROUS SHRUBS				
Jh	0	Juniperus horizontalis 'Hughes'	Hughes Juniper	3 Gal. Potted
Jw	0	Juniperus horizontalis 'Wilton'	Blue Rug Juniper	3 Gal. Potted
Js	0	Juniperus sabina	Savin Juniper	3 Gal. Potted
GRASSES				
Dc	0	Deschampsia cespitosa	Tufted Hair Grass	1 Gal. Potted
Ec	0	Elymus canadensis	Canada Wild Rye	1 Gal. Potted
Fg	0	Festuca glauca	Blue Fescue	1 Gal. Potted
PERENNIALS				
Ls	0	Leistis spicata	Dense Blazing Star	1 Gal. Potted
Rh	0	Rudbeckia hirta	Glorious Daisy	1 Gal. Potted
Sr	0	Sedum reflexum 'Angelina'	Angelina Sedum	1 Gal. Potted

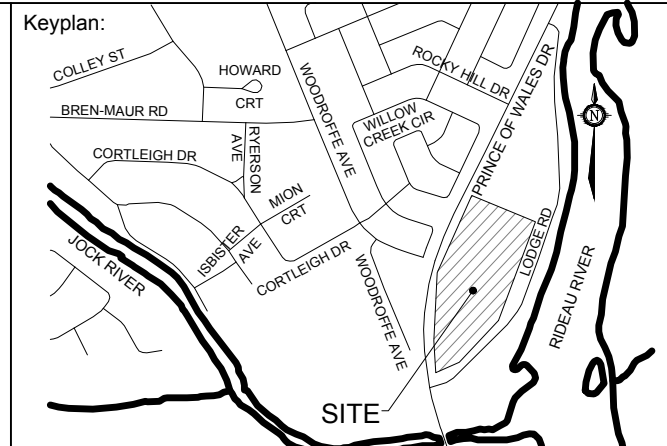

- L-101 GENERAL NOTES**
- All general site information and conditions compiled from architect's and engineer's plans and surveys.
 - Do not scale this drawing.
 - Report any discrepancies prior to commencing work. No responsibility is born by the Landscape Architect for unknown subsurface conditions.
 - Reinstate all areas and items damaged as a result of construction activities to the satisfaction of the Landscape Architect.
 - Drawing may not be used for construction until signed by Landscape Architect as issued for construction.
 - The accuracy of the position of utilities is not guaranteed.
 - Individual utility co. must be contacted for confirmation of utility existence and location prior to digging.
 - This drawing is an instrument of service and requires the permission of the Landscape Architect for use. Copyright is reserved by the Landscape Architect, David M. Lashley.

- L-101 LANDSCAPE NOTES**
- Plant material shall be No. 1 Grade and shall comply with the Metric Guide Specifications for Nursery stock (latest edition), published by Canadian Nursery Trades Association.
 - Plant substitutions shall not be permitted unless approved by the Landscape Architect.
 - Obtain approval of planting prior to digging.
 - Topsoil shall be garden soil mixture sandy loam with min. 5% organic matter and peat moss added at ratio of 1:10, to be approved by Landscape Architect.

COPYRIGHT NOTICE - Copyright in this electronic document belongs to Moriama & Teshima Architects. This electronic document may not be reproduced, stored, transmitted, downloaded or reproduced in any form or by any means, without the express, written permission of the copyright owner.

DISCLAIMER - Use of this electronic document is at the User's own risk. The User shall indemnify and save harmless the Architect and his/her employees, agents and consultants from and against all claims, losses, demands, costs and expenses (including legal fees), damages or recoveries (including amounts paid in settlement or arising by reason of caused, or alleged to be caused, by the User's reliance on this electronic document.

#	DATE	REVISION NOTE
1	2019-05-26	ISSUED FOR SPA

MORIYAMA & TESHIMA ARCHITECTS
march.com

117 George Street, Toronto, Ontario Canada M5A 2N4 416-925-4484
168 Murray Street, Suite 3, Ottawa, Ontario Canada K1N 6M5 613-662-2068

CS&P Architects
csandp.com

2345 Yonge Street, Suite 200, Toronto, Ontario M4P 2E5 416-462-9302

LASHLEY ASSOCIATES
LANDSCAPE ARCHITECTURE AND SITE ENGINEERING
600 DE QUINCENNE AVENUE, SUITE 100, OTTAWA, ONTARIO K1N 6M5

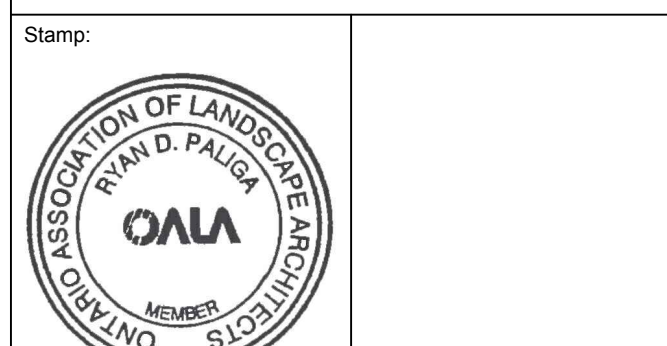
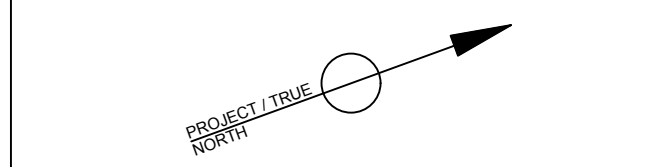

Do not scale drawings. The contractor shall check and verify all dimensions and report any errors or omissions to the architect before proceeding with any work. All drawings remain the property of the architect.

Copyright (C) 2019

Client:

CITY OF OTTAWA
10 LAURIER AVENUE WEST
OTTAWA ON K1P 1J1

Applicant:

COLLIERS PROJECT LEADERS INC.
150 ISABELLA STREET, SUITE 700,
OTTAWA ON, K1S 1V7

Project:

SOUTH CAMPUS PHASE A
3505 PRINCE OF WALES DR. OTTAWA ONTARIO

Title:

LANDSCAPE PLAN DETAILS

Scale: AS SHOWN
Date: 06/17/19
Job No.: 18001
Drawn By: RP
Checked By: RP
Approved By: RP

Sheet No.:
L-101

FOR REFERENCE ONLY - NOT FOR CONSTRUCTION

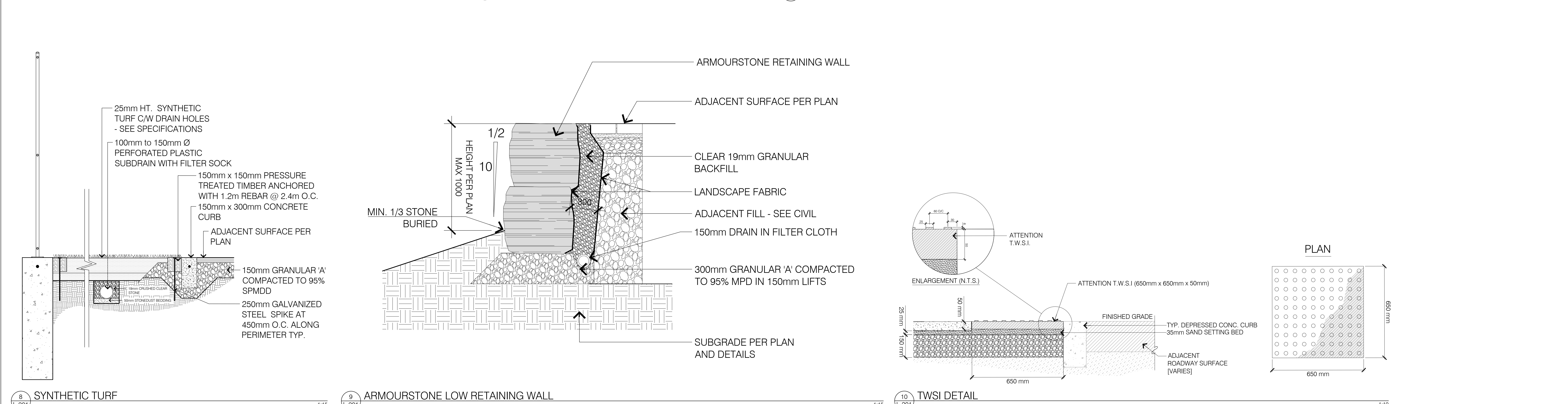
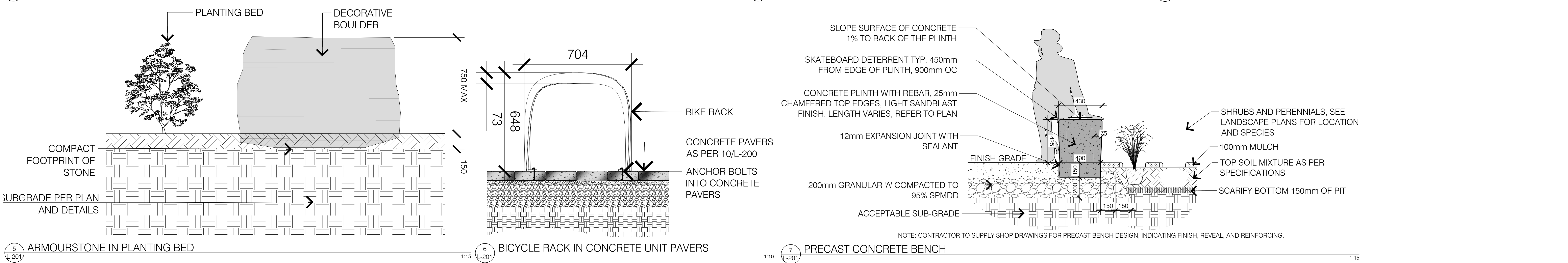
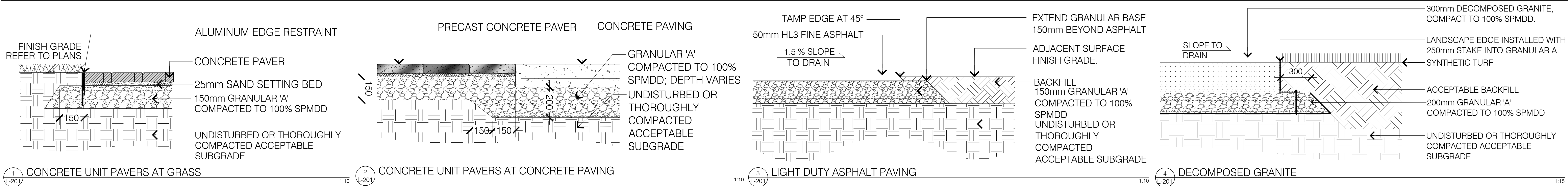

Copyright Notice: Copyright in this electronic document belongs to MoriYama & Teshima Architects. This electronic document may not be downloaded, stored, transmitted, disseminated or reproduced in any form or by any means, without the express, written permission of the copyright owner.

Disclaimer: Use of this electronic document is at the User's own risk. The User shall indemnify and save harmless the Architect and his/her employees, agents and consultants from and against all claims, losses, demands, costs and expenses (including legal fees), damages or recoveries (including amounts paid in settlement) arising by reason of, caused, or alleged to be caused, by the User's reliance on this electronic document.

#	DATE	REVISION NOTE
1	2019-05-26	ISSUED FOR SPA

MORIYAMA & TESHIMA ARCHITECTS
march.com
117 George Street, Toronto, Ontario Canada M5A 2N4 416-922-4484
168 Murray Street, Suite 3, Ottawa, Ontario Canada K1N 6M5 613-662-2068

CS&P Architects
csparch.com
2345 Forage Street, Suite 200, Toronto, Ontario M9P 2E5 416-482-8302

LASHLEY+ASSOCIATES
LANDSCAPE ARCHITECTURE AND SITE ENGINEERING
416-482-8302

Stamp: ASSOCIATION OF LANDSCAPE ARCHITECTS OF ALTA

Do not scale drawings. The contractor shall check and verify all dimensions and report any errors or omissions to the architect before commencing or proceeding with any work. All drawings remain the property of the architect.

Copyright (C) 2019

Client: CITY OF OTTAWA
110 LAURIER AVENUE WEST
OTTAWA ON K1P 1J1

Applicant: COLLIER'S PROJECT LEADERS INC.
150 ISABELLA STREET, SUITE 700
OTTAWA ON, K1S 1V7

Project: SOUTH CAMPUS PHASE A
3505 PRINCE OF WALES DR. OTTAWA ONTARIO

Title: DETAILS

Scale:	AS SHOWN	Sheet No.:
Date:	04/17/19	L-201
Job No.:	18001	
Drawn By:	RP	
Checked By:	RP	
Approved By:	RP	

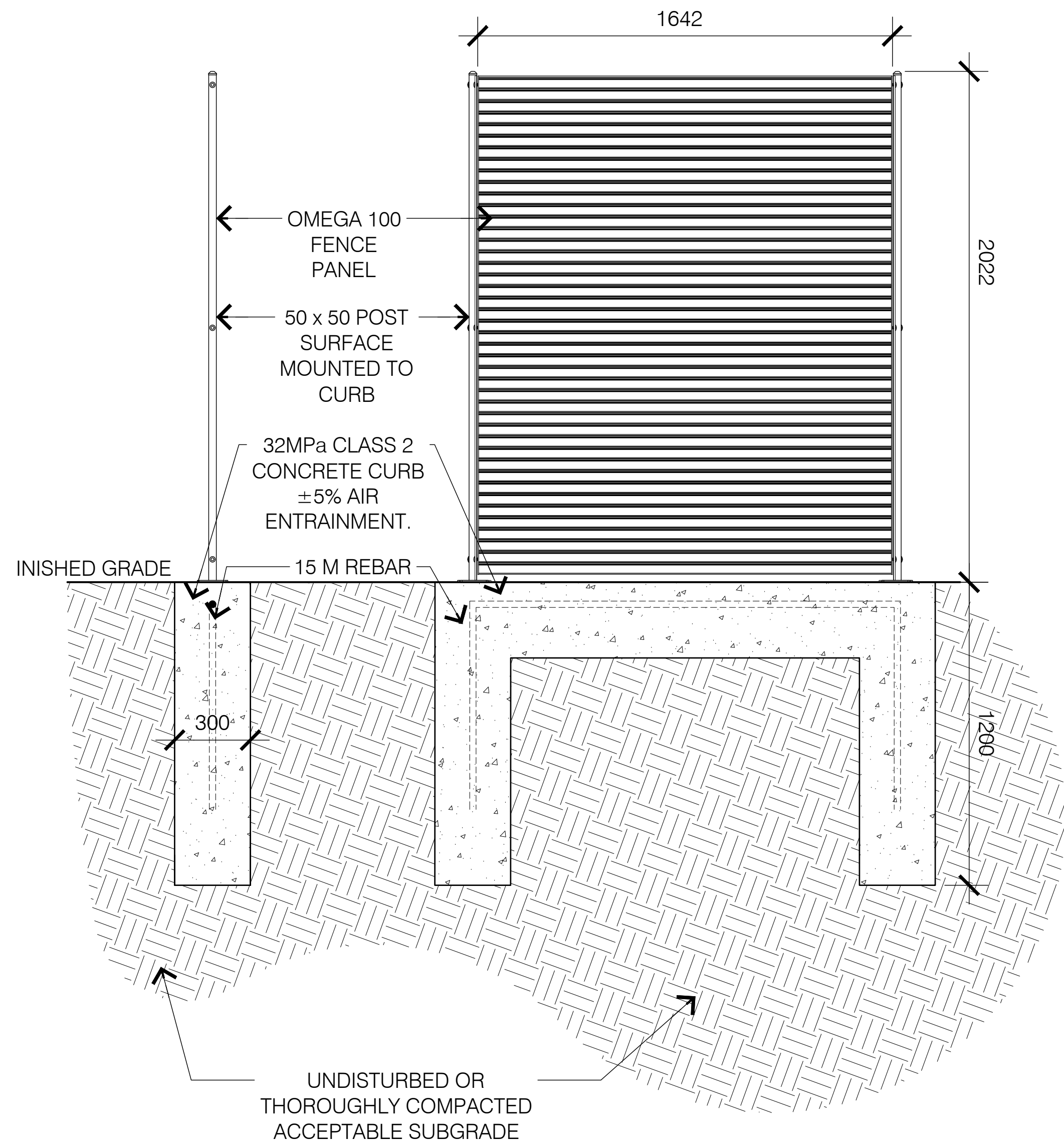

- NOTES:
1. CONTRACTOR TO PROVIDE ENGINEERED SHOP DRAWINGS BEFORE INSTALLATION
 2. CONTRACTOR TO CONFIRM SOIL BEARING CAPACITY BEFORE

1 K9 FENCE PANEL
L-202

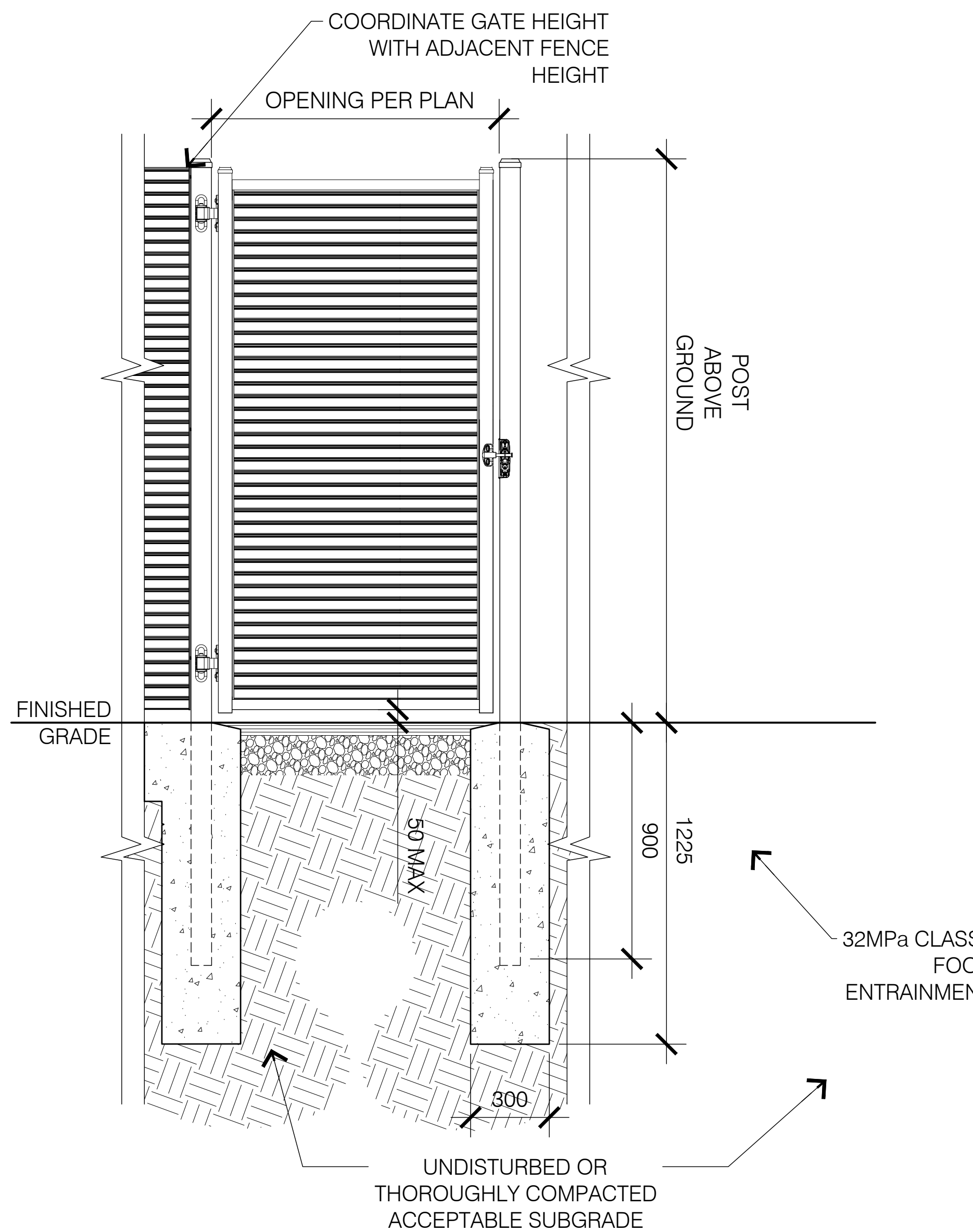

- NOTES:
1. CONTRACTOR TO PROVIDE ENGINEERED SHOP DRAWINGS BEFORE INSTALLATION

2 K9 FENCE GATE
L-202

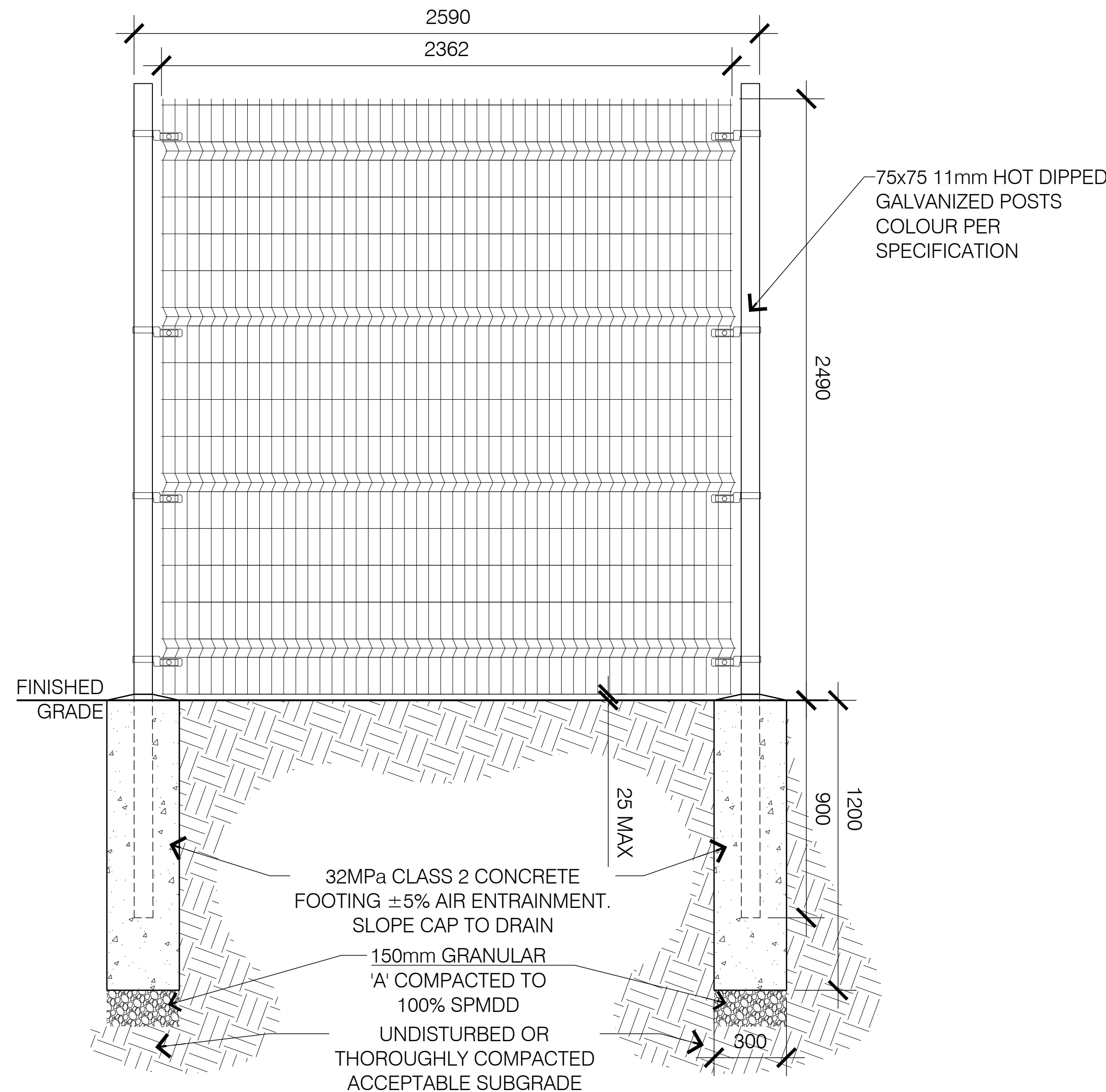

- NOTES:
1. CONTRACTOR TO PROVIDE ENGINEERED SHOP DRAWINGS BEFORE INSTALLATION
 2. CONTRACTOR TO CONFIRM SOIL BEARING CAPACITY BEFORE FOOTING INSTALLATION

3 OMEGA ARCHITECTURAL FENCE
L-202

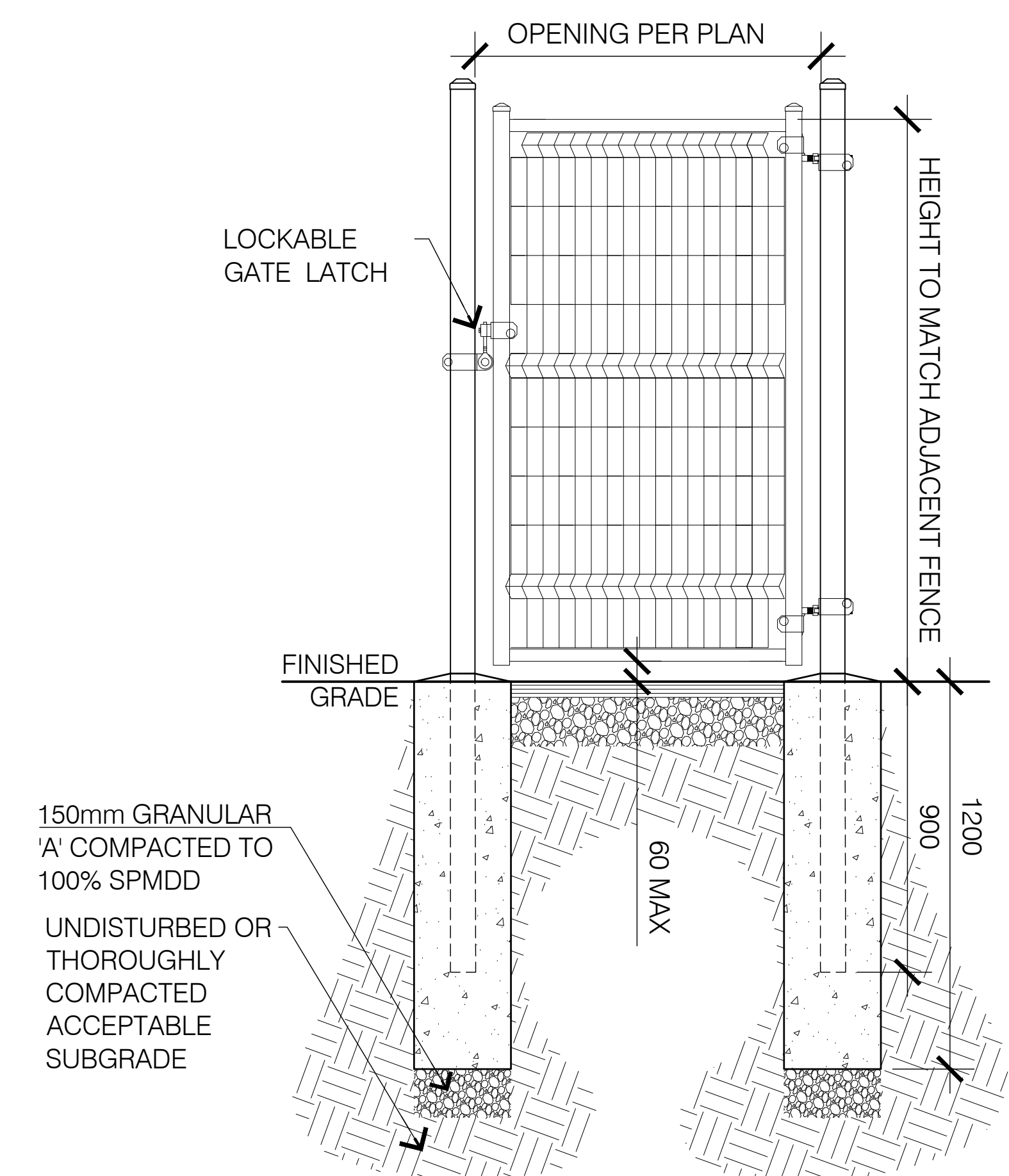
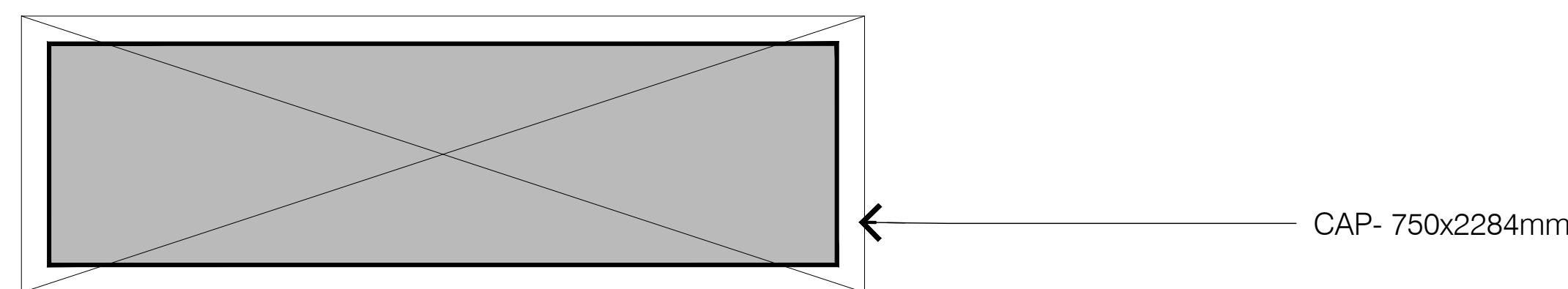

- NOTES:
1. CONTRACTOR TO PROVIDE ENGINEERED SHOP DRAWINGS BEFORE INSTALLATION
 2. CONTRACTOR TO CONFIRM SOIL BEARING CAPACITY BEFORE FOOTING INSTALLATION

4 OMEGA ARCHITECTURAL FENCE GATE
L-202

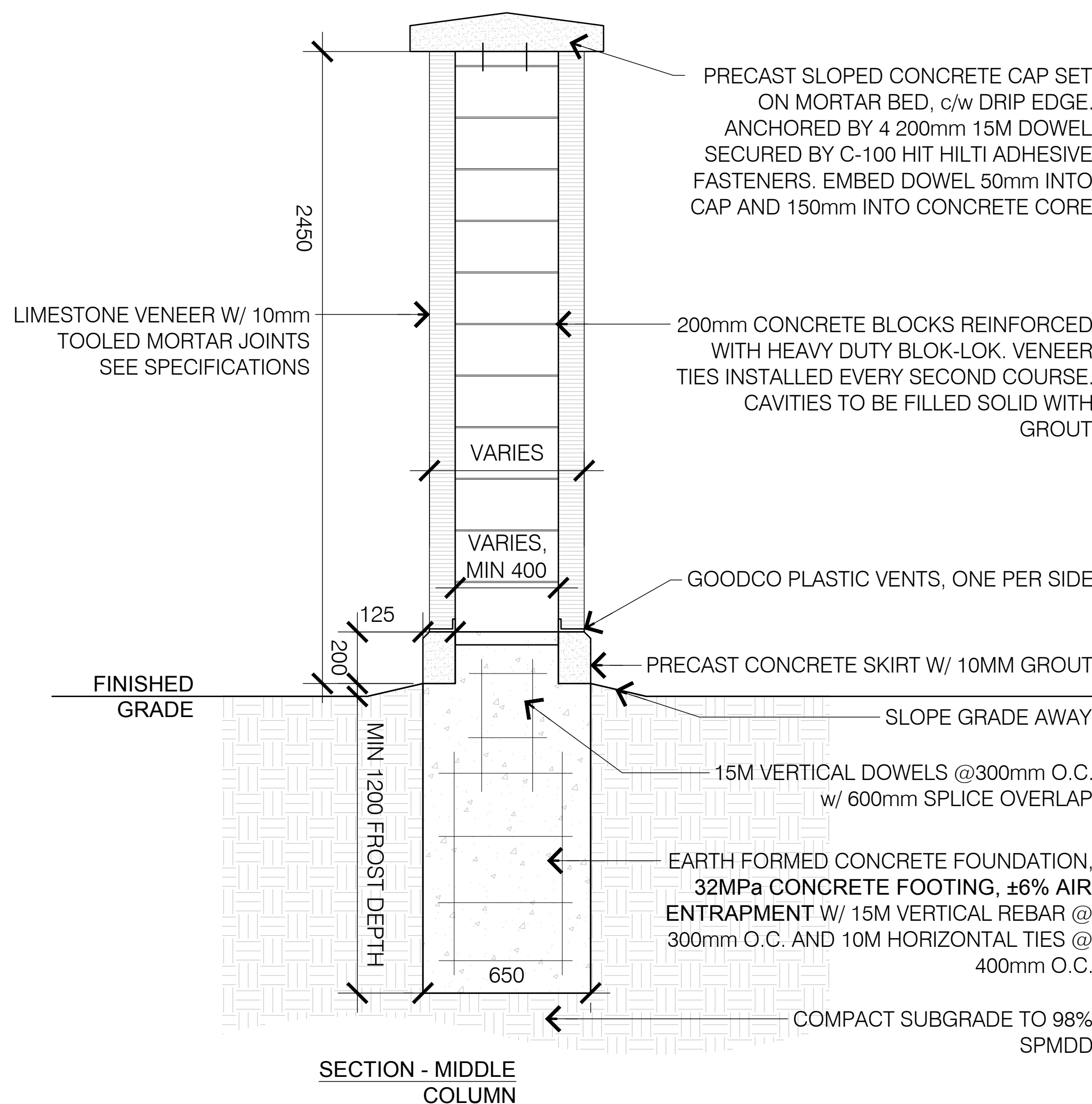
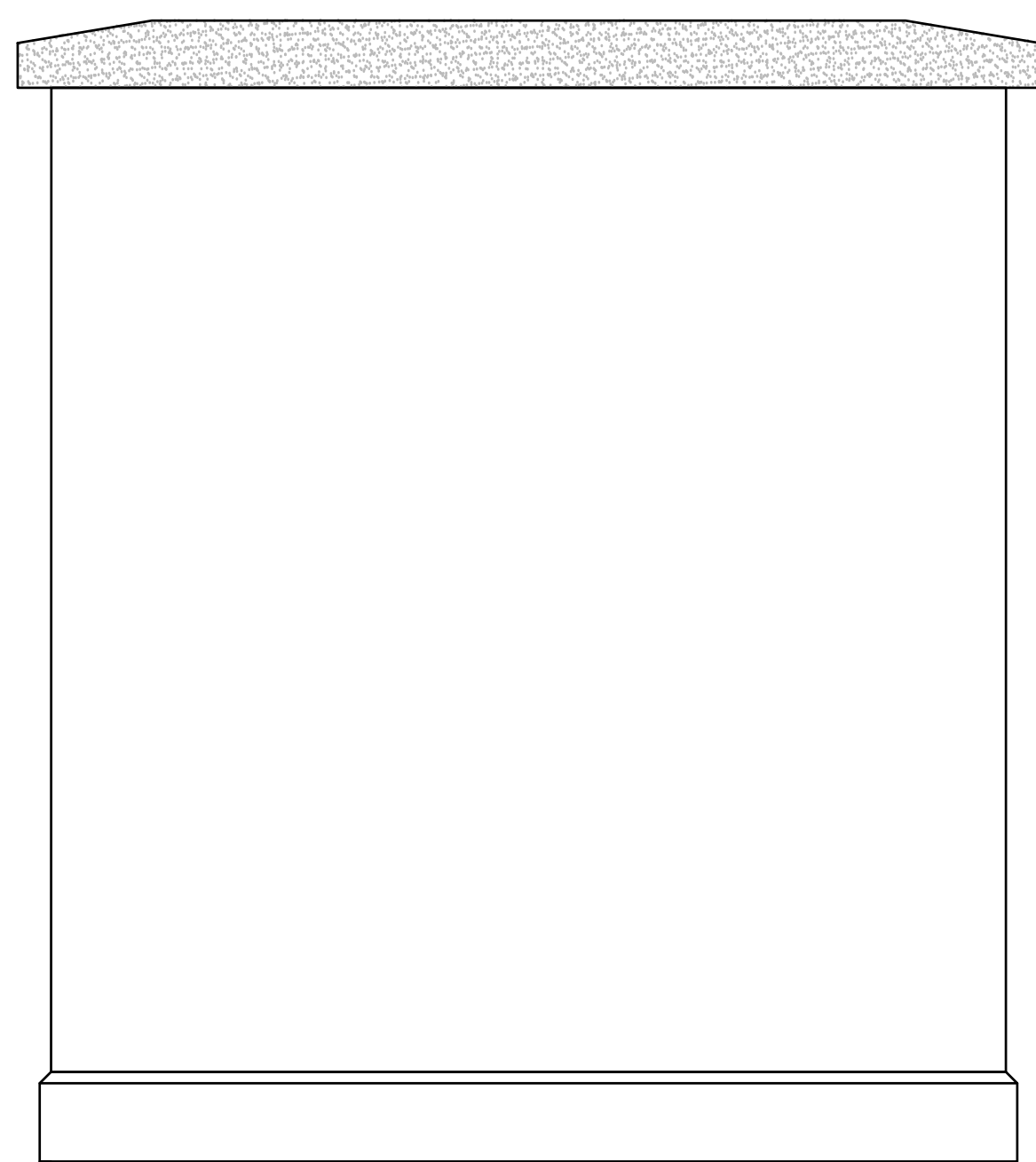

- NOTES:
1. CONTRACTOR TO PROVIDE ENGINEERED SHOP DRAWINGS BEFORE INSTALLATION
 2. CONTRACTOR TO CONFIRM SOIL BEARING CAPACITY BEFORE FOOTING INSTALLATION

5 2.6m MASONRY COLUMN
L-202

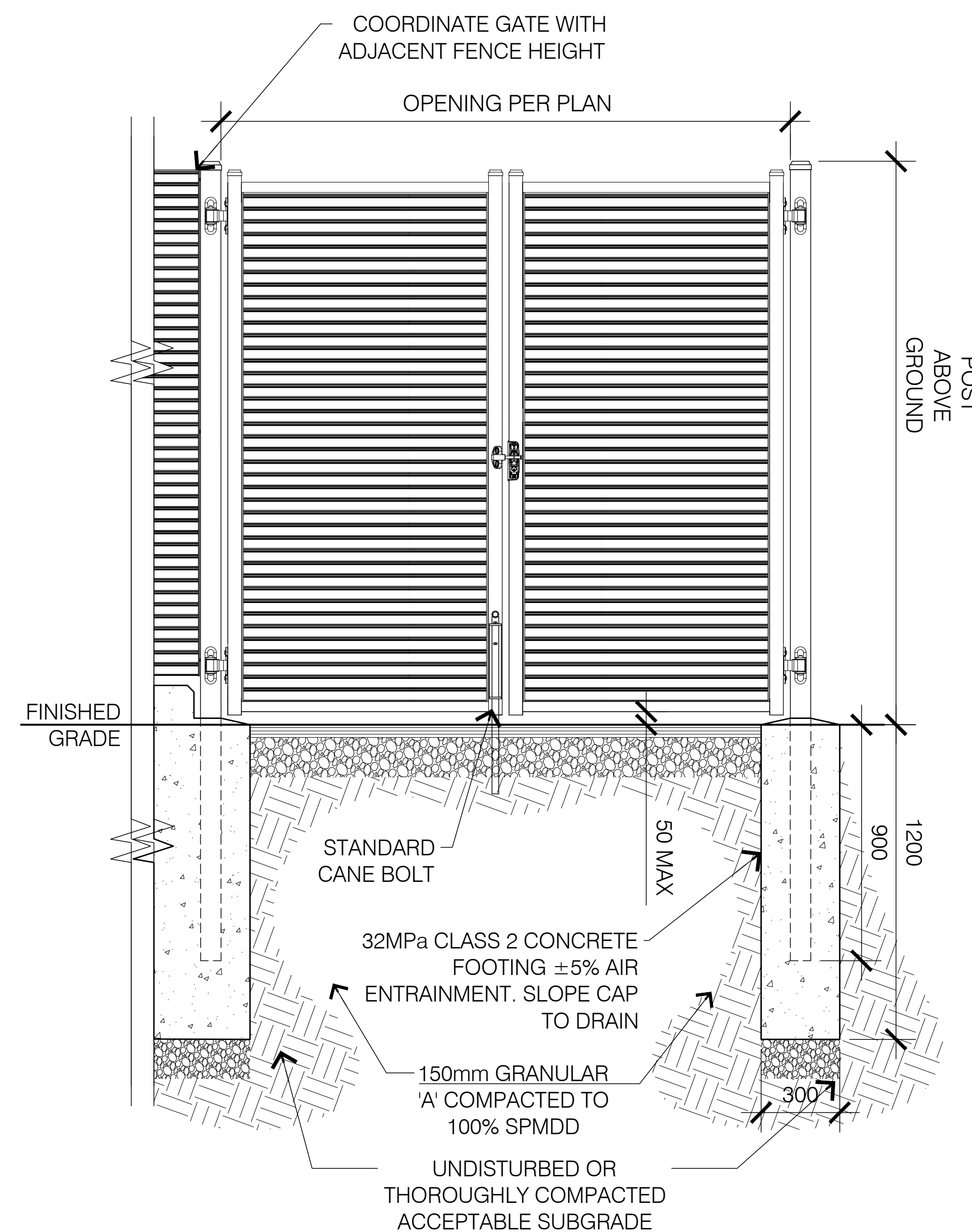

- NOTES:
1. CONTRACTOR TO PROVIDE ENGINEERED SHOP DRAWINGS BEFORE INSTALLATION
 2. CONTRACTOR TO CONFIRM SOIL BEARING CAPACITY BEFORE FOOTING INSTALLATION

6 GARBAGE FENCE GATE
L-202

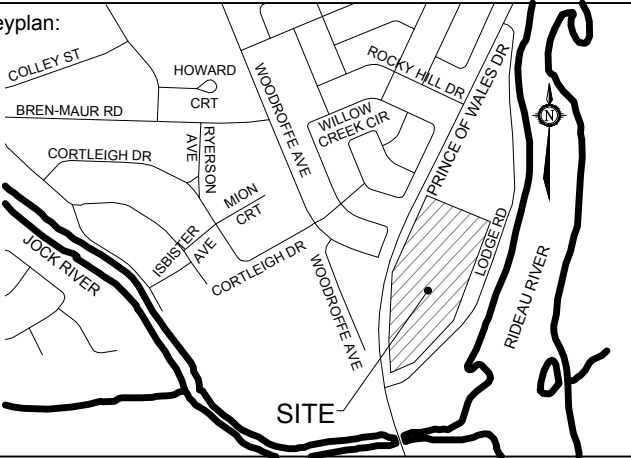

COPYRIGHT NOTICE: Copyright in this electronic document belongs to MoriYama & Teshima Architects. This electronic document may not be forwarded to others, transmitted, downloaded or reproduced whether print or electronic, without the express, written permission of the copyright owner.

DISCLAIMER: Use of this electronic document is at the User's own risk. The User shall indemnify and save harmless the Architect and his/her employees, agents and consultants from and against all claims, losses, demands, costs and expenses (including legal fees), damages or recoveries (including amounts paid in settlement) arising by reason of, caused, or alleged to be caused, by the User's reliance on this electronic document.

1	2019-05-26	ISSUED FOR SPA
#	DATE	REVISION NOTE

MORIYAMA & TESHIMA ARCHITECTS
march.com
117 George Street, Toronto, Ontario Canada M5A 2N4 416-922-4484
168 Murray Street, Suite 3, Ottawa, Ontario Canada K1N 6M5 613-662-2068

CS&P Architects
csandp.com
2345 Yonge Street, Suite 200, Toronto, Ontario M4P 2E5 416-482-5002

LASHLEY ASSOCIATES
LANDSCAPE ARCHITECTURE AND SITE ENGINEERING
100 St. Clair Avenue East, Suite 200, Toronto, Ontario M5E 1A3 416-593-8800

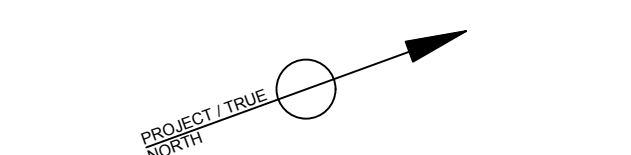

Do not scale drawings. The contractor shall check and verify all dimensions and report any errors or omissions to the architect before proceeding with any work. All drawings remain the property of the architect.

Copyright (C) 2019

Client:

CITY OF OTTAWA
110 LAURIER AVENUE WEST
OTTAWA ON K1P 1J1

Applicant:

COLLIERS PROJECT LEADERS INC.
150 ISABELLA STREET, SUITE 700
OTTAWA ON K1S 1V7

Project:

SOUTH CAMPUS PHASE A
3505 PRINCE OF WALES DR. OTTAWA ONTARIO

Title:

DETAILS

Scale:	AS SHOWN	Sheet No.:
Date:	06/17/19	
Job No.:	18001	
Drawn By:	RP	
Checked By:	RP	
Approved By:	RP	

L-202

FOR REFERENCE ONLY - NOT FOR CONSTRUCTION