

**NOT FOR CONSTRUCTION**

**SITE PLAN INFORMATION**  
SITE PLAN PROVIDED BY KORSIAK URBAN PLANNING  
DATED JANUARY 31, 2019

**GEOTECHNICAL STUDY**  
GEOTECHNICAL RECOMMENDATIONS PROVIDED BY PATRISON GROUP INC.  
PROJ. NO. PG4064-1  
DATED AUGUST 8, 2017

**BENCH MARK**  
ELEVATIONS ARE GEODETIC, REFERRED TO CITY OF OTTAWA VERTICAL BENCHMARK NO. 396  
ELEV= 95.06 METERS

**SITE SERVICING AND STORMWATER MANAGEMENT STUDY**  
SERVICING AND STORMWATER MANAGEMENT RECOMMENDATIONS PROVIDED BY DSEL  
PROJ. NO. 17-946  
DATED FEBRUARY 2019

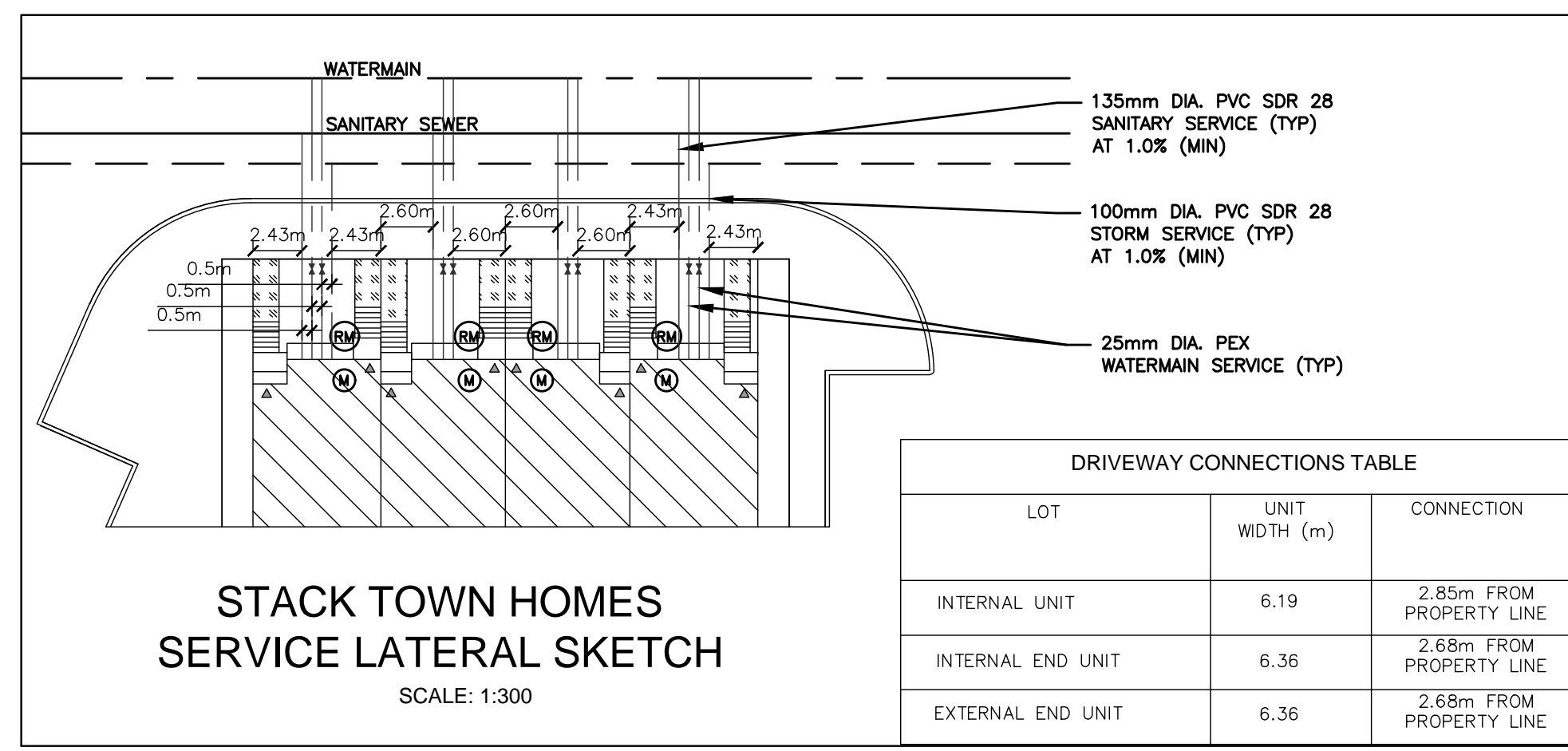
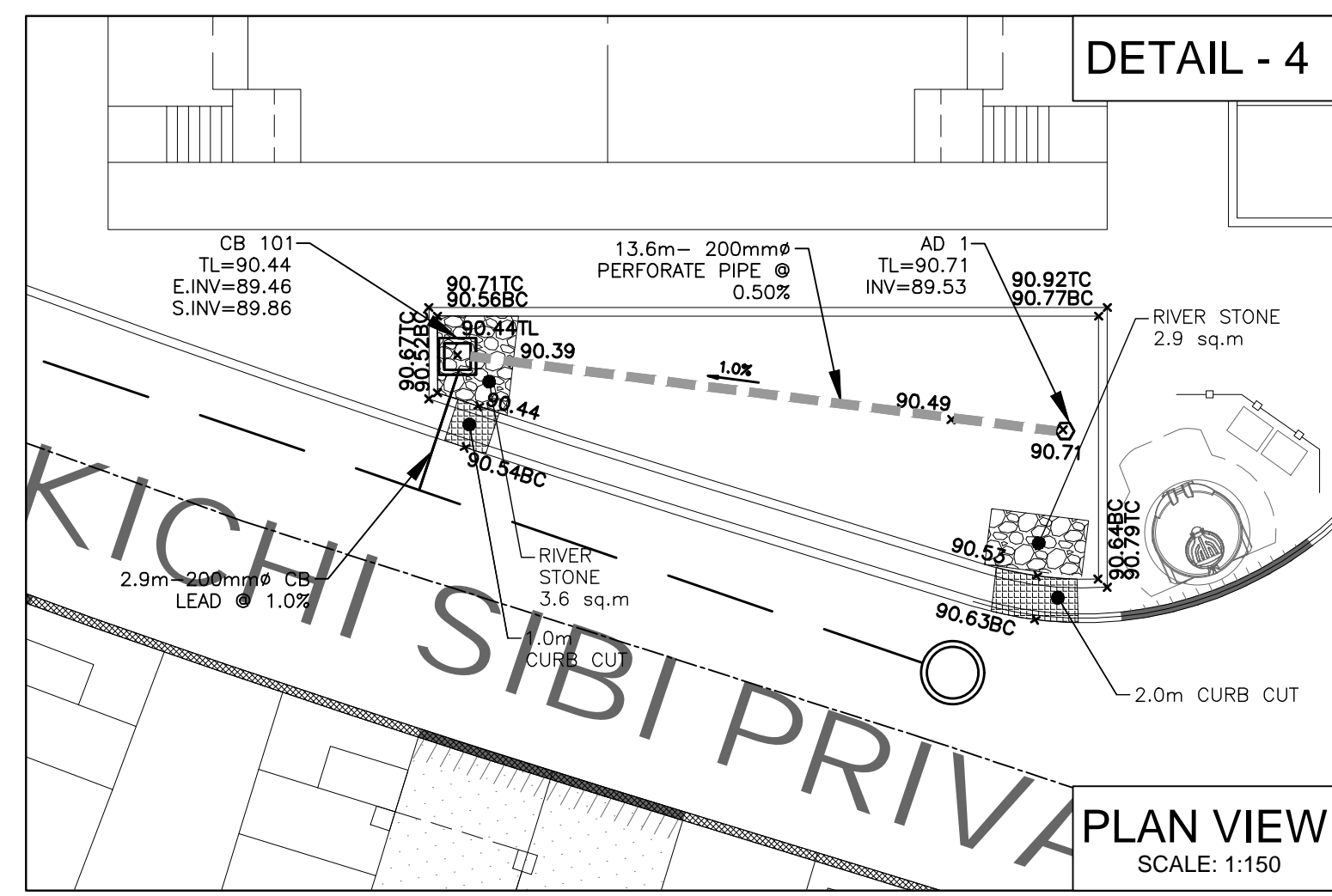
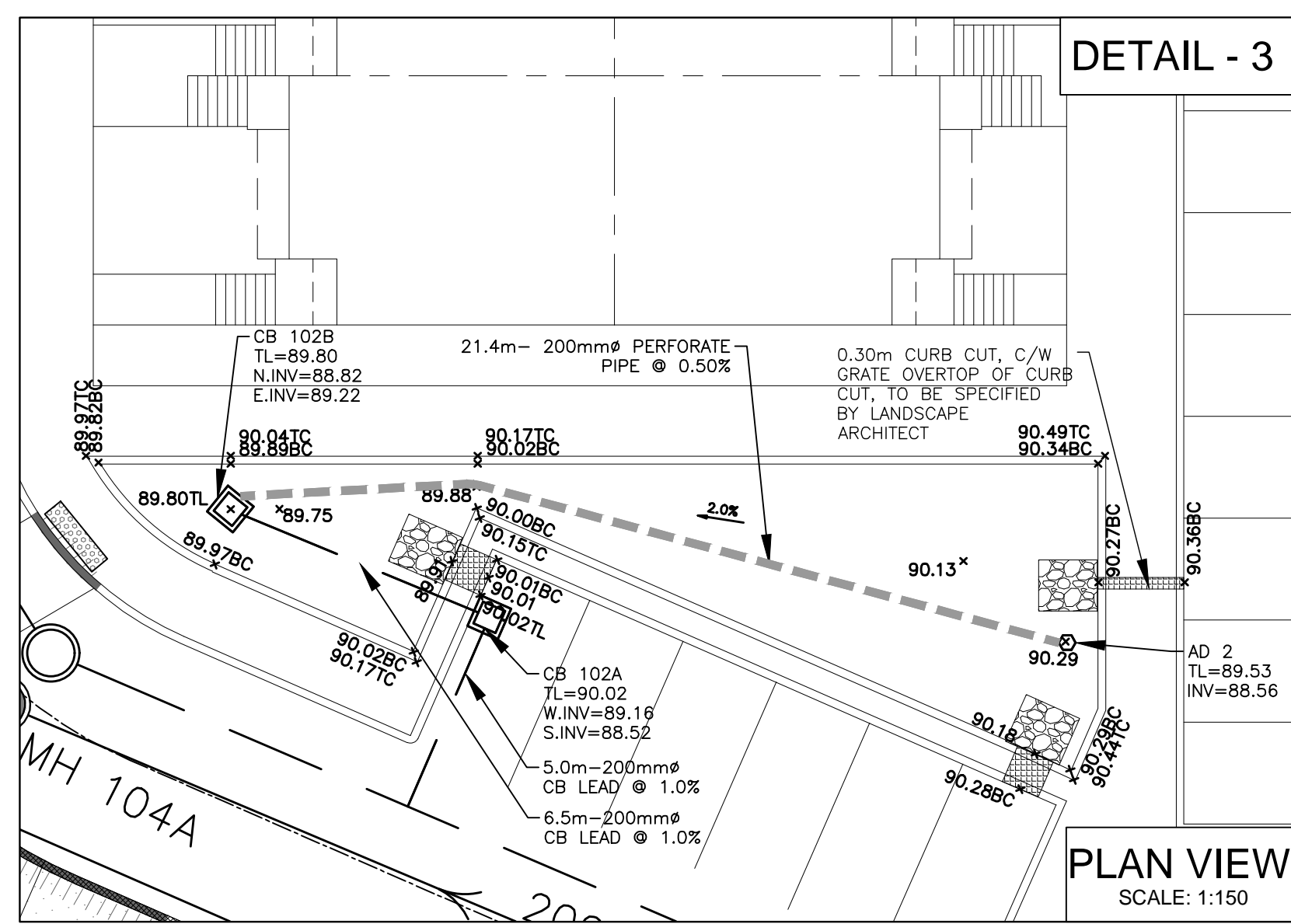

**LEGEND**

RIVERSTONE 1.5mx1.3m (100mm DIA 200mm DEEP UNLESS OTHERWISE NOTED)

1.0m CURB CUT (UNLESS OTHERWISE NOTED)

**DETAILS & NOTES**  
**WATERIDGE - BLOCK 15**

PROJECT No. 17-946

**DSEL**  
David Schaeffer Engineering Ltd  
SMART SUBDIVISIONS

50 Hines Road, Suite 100  
Ottawa, Ontario, K2K 2M5  
Tel. (613) 831-5144

120 Iher Road Unit 103  
Stittsville, Ontario, K2S 1E9  
Tel. (613) 836-0856  
Fax. (613) 836-7183  
www.DSEL.ca

DESIGNED BY: B.N.C. CHECKED BY: S.L.M. DRAWING NO. SHEET NO.  
SCALE: AS SHOWN DATE: FEBRUARY 2019 DS-2 12 of 12