

# GREENBANK ROAD.

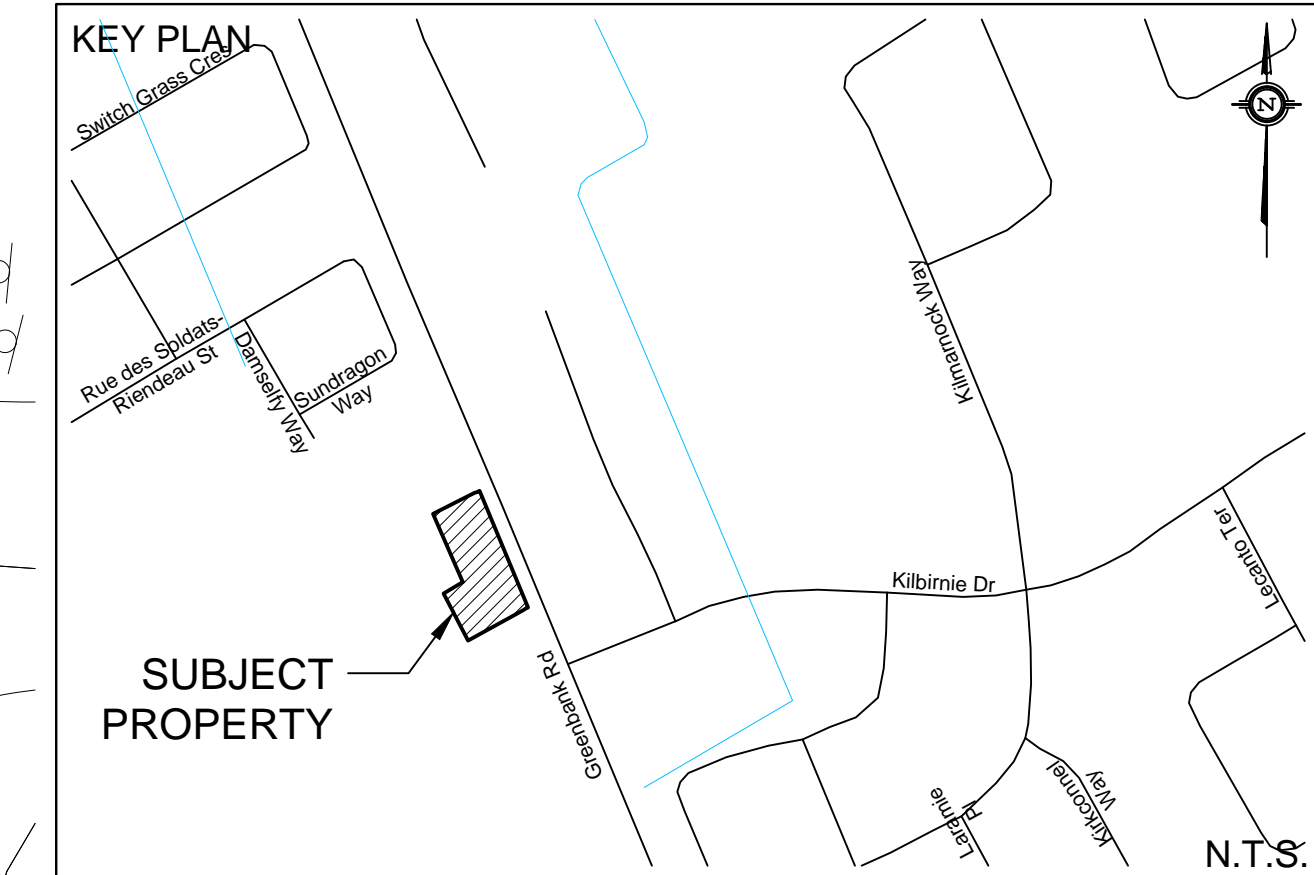

**LEGEND**

<b>EX6</b>	DRAINAGE AREA ID	PROPERTY LINE
<b>4.010</b>	AREA IN Ha	PROPOSED STORM SEWER
<b>0.19</b>	RATIONAL METHOD RUNOFF COEFFICIENT	DRAINAGE DIVIDE
<b>101</b>	DRAINAGE AREA ID	PROPOSED SWALE
<b>1.000</b>	AREA IN Ha	PROPOSED PERFORATED SUBDRAIN
<b>0.500</b>   <b>0.500</b>	PERVIOUS AREA IN Ha   IMPERVIOUS AREA IN Ha	PROPOSED STORM MANHOLE
<b>0.55</b>	RATIONAL METHOD RUNOFF COEFFICIENT	PROPOSED CATCH BASIN
		PROPOSED CB 'T'
		EMERGENCY FLOW ROUTE
		SURFACE PONDING AREA
		MAX PONDING INTERMEDIATE PONDING

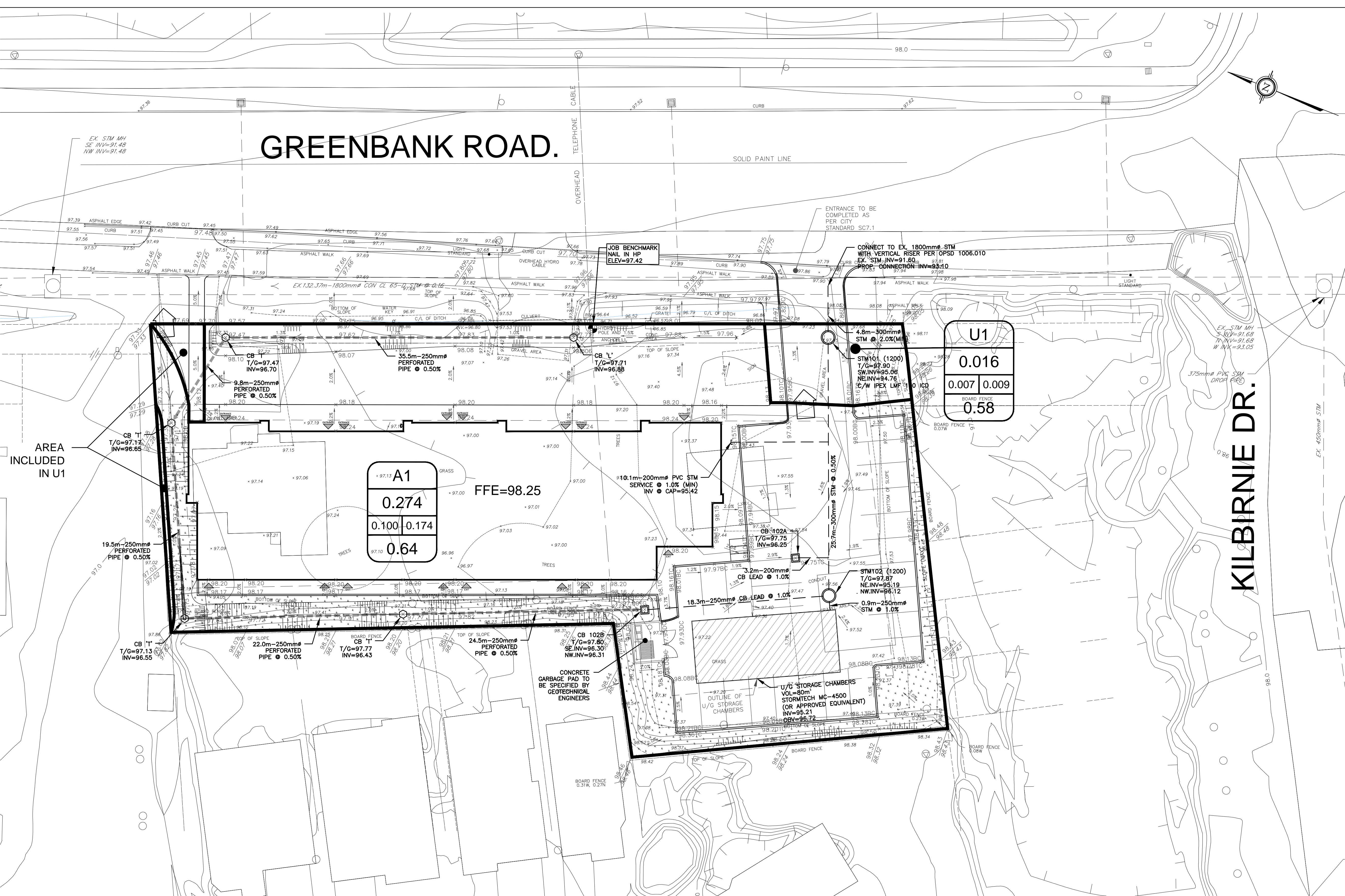

**NOT FOR CONSTRUCTION**

**TOPOGRAPHIC INFORMATION**  
TOPOGRAPHIC INFORMATION PROVIDED BY J.D.BARNES  
PROJ. NO. 18-10-057-020PO  
DATED OCTOBER 09, 2018

**SITE PLAN INFORMATION**  
SITE PLAN PROVIDED BY S.J.LAWRENCE ARCHITECT INCORPORATED  
PROJ. NO. SL-921-18  
DATED DECEMBER 13, 2018

**GEOTECHNICAL RECOMMENDATION**  
GEOTECHNICAL RECOMMENDATIONS PROVIDED BY PATERSON GROUP  
DATED DECEMBER 11, 2018

**SITE SERVICING AND STORMWATER MANAGEMENT STUDY**  
SERVICING AND STORMWATER MANAGEMENT RECOMMENDATIONS PROVIDED BY DSEL  
PROJ. NO. 18-1060  
DATED DECEMBER 2018

**BENCH MARK**  
NAIL ON HP LOCATED ON WEST SIDE OF GREENBANK ROAD ADJACENT TO SUBJECT PROPERTY  
ELEV=97.42

1	G.G.G.	18.12.14.	ISSUED FOR MUNICIPAL REVIEW - 1ST SUBMISSION
No.	BY	YY.MM.DD	DESCRIPTION

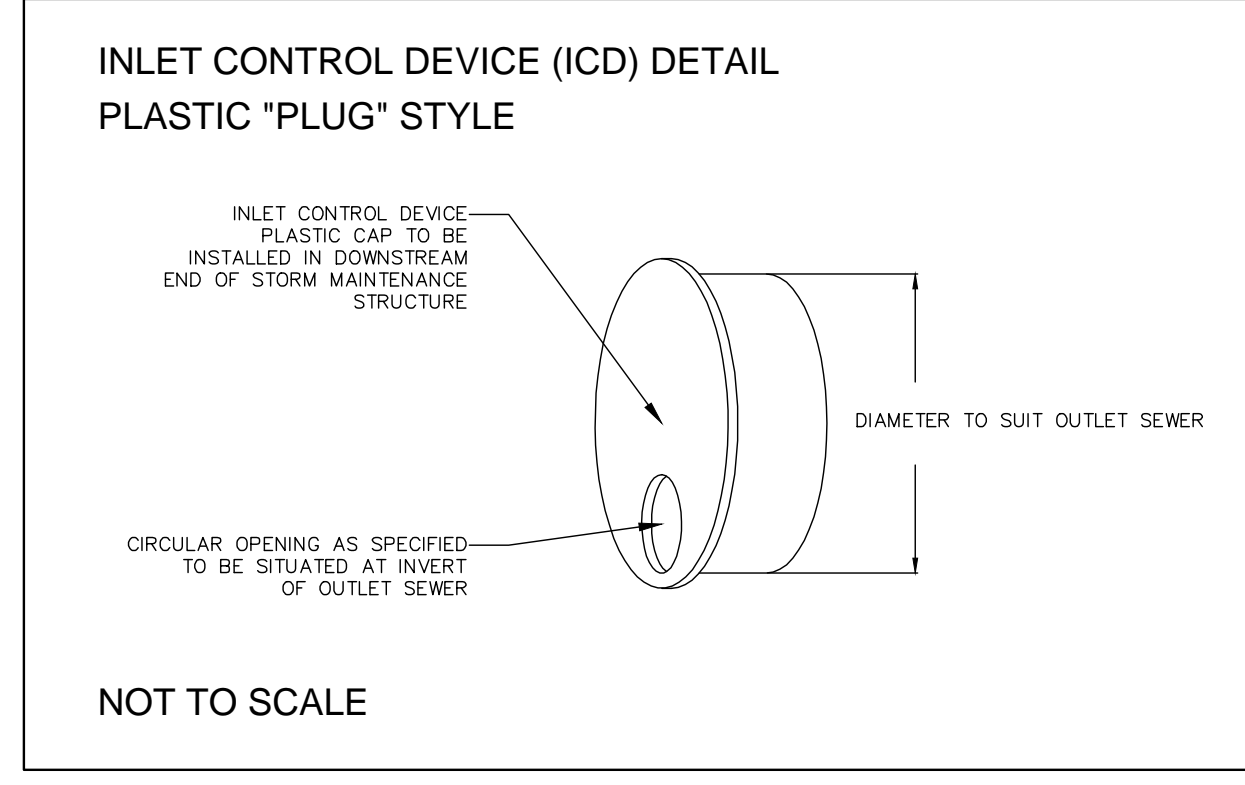

PROJECT No18-1060

**STORMWATER MANAGEMENT PLAN**  
3802/3812 GREENBANK ROAD © DSEL

JACK UPPAL Greenbank Place Unit 4-3101 Strandherd Drive  
Ottawa, ON K2S 4R9  
Tel. (613) 220-6006

**DSEL**  
david schaeffer engineering ltd  
SMART SUBDIVISIONS™

120 Iler Road Unit 103  
Stittsville, Ontario, K2S 1E9  
Tel. (613) 836-0856  
Fax. (613) 836-7183  
www.DSEL.ca

DRAWN BY: A.W.T.	CHECKED BY: S.L.M.	DRAWING NO. SWM-1	SHEET NO. 1 of 1
DESIGNED BY: B.N.C.	CHECKED BY: A.D.F.		
SCALE: 1:200	DATE: DECEMBER 2018		