

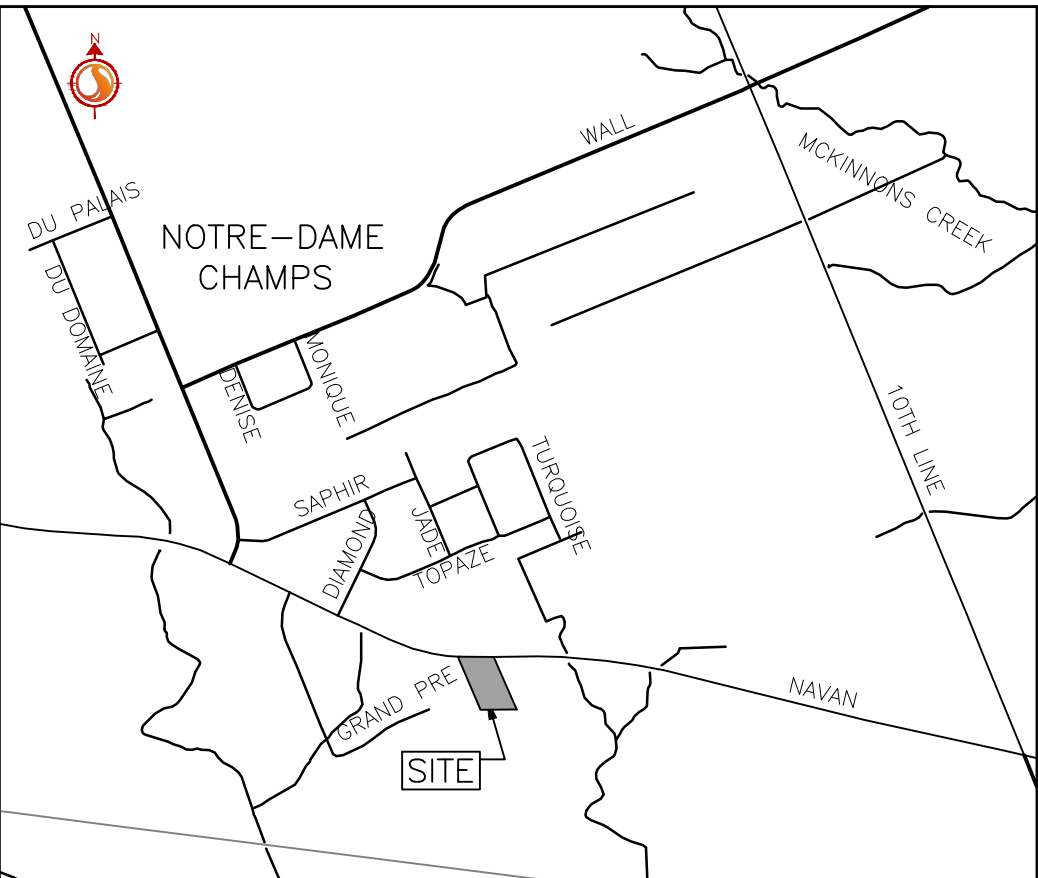

RIP RAP OUTLET AS
PER OPSD 810.010

SLOPE AT 2:1 TO BE
INTO EX. DITCH EX
CULVERT TO REMAIN

BENCHMARK
Top Of Arrow
Head Elev=86.87



Stantec Consulting Ltd.
400 - 1331 Clyde Avenue
Ottawa ON
Tel. 613.722.4420
www.stantec.com

Copyright Reserved

The Contractor shall verify and be responsible for all dimensions. DO NOT scale the drawing - any errors or omissions shall be reported to Stantec without delay.
The Copyrights to all designs and drawings are the property of Stantec. Reproduction or use for any purpose other than that authorized by Stantec is forbidden.

Legend

- ORIGINAL GROUND ELEVATION
- PROPOSED ELEVATION
- PROPOSED LOT CORNER ELEVATION
- EXISTING ELEVATION AT LOT CORNER
- FLOW DIRECTION AND GRADE
- FINISHED FIRST FLOOR ELEVATION
- TOP OF FOUNDATION ELEVATION
- UNDERSIDE OF FOOTING ELEVATION
- TERRACING 3:1 SLOPE MAXIMUM (UNLESS OTHERWISE SHOWN)
- PROPOSED SWALE
- DIRECTION OF OVERLAND FLOW
- PROPOSED VALVE BOX
- PROPOSED SANITARY SEWER MANHOLE
- PROPOSED STORM SEWER MANHOLE
- PROPOSED CATCHBASIN
- PROPOSED DEPRESSED CURB LOCATION
- PROPOSED DOOR LOCATIONS
- PROPOSED HEAVY DUTY ASPHALT
- PROPOSED RETAINING WALL

- SERVICE CONNECTION TO EXISTING WATERMAIN TO BE COMPLETE BY CITY FORCES. EXCAVATION, BACKFILL AND REINSTATEMENT BY CONTRACTOR.
- TOPOGRAPHIC SURVEY AND BENCHMARK COMPLETED BY ARPENTAGE DUTRASAC SURVEYING INC. DATED SEPTEMBER 27, 2016.
- SITE PLAN PREPARED BY TEMPRANO & YOUNG ARCHITECTS INC. DATED OCTOBER 17, 2018.
- GEOTECHNICAL REPORT PREPARED BY STANTEC CONSULTING LTD. DATED MARCH 9, 2018.

| Revision | By | Appd. | YY.MM.DD |
|----------|-------------------------------|-------|-------------|
| 3 | REVISÉ SITE PLAN | MJS | KS 19.02.21 |
| 2 | REVISED SITE PLAN | WAJ | KS 18.10.29 |
| 1 | ISSUED FOR SITE PLAN APPROVAL | WAJ | KS 18.04.27 |

| | | | | | |
|------------|-----------|------|-------|-------|----------|
| File Name: | 160410200 | WAJ | KS | WAJ | 18.04.19 |
| | | Dwn. | Chkd. | Dsgn. | YY.MM.DD |

Permit-Seal

Client/Project

ST. GEORGE AND ST. ANTHONY
COPTIC ORTHODOX CHURCH
3856, 3866 & 3876 NAVAN ROAD

OTTAWA, ON, CANADA

Title

GRADING PLAN

Project No.
160410200

Drawing No.

Scale
1:300

Sheet

Revision

GP-1

2 of 4

3

SITE GRADING

- ALL GRANULAR BASE & SUB BASE COURSE MATERIALS SHALL BE COMPACTED AS PER GEOTECHNICAL CONSULTANT RECOMMENDATIONS.
- ALL DISTURBED GRASSED AREAS SHALL BE RESTORED TO ORIGINAL CONDITION OR BETTER, WITH SOD ON MIN. 100mm TOPSOIL. THE RELOCATION OF TREES AND SHRUBS SHALL BE SUBJECT TO APPROVAL BY THE PROJECT LANDSCAPE ARCHITECT OR ENGINEER.
- INSPECTIONS: ALL WORK ON THE MUNICIPAL RIGHT OF WAY AND EASEMENTS TO BE INSPECTED BY THE MUNICIPALITY PRIOR TO BACKFILLING. ALL WORK RELATING TO WATERMANS AND SEWERS TO BE INSPECTED BY THE MUNICIPALITY WHEN REQUIRED.
- REFER TO ARCHITECTURAL SITE PLAN FOR DIMENSIONS AND SITE DETAILS.
- CONTRACTOR TO OBTAIN A ROAD OCCUPANCY PERMIT 48 HOURS PRIOR TO COMMENCING ANY WORK WITHIN THE MUNICIPAL ROAD ALLOWANCE IF REQUIRED BY THE MUNICIPALITY.
- EMBANKMENTS TO BE SLOPED AT MIN. 3:1, UNLESS OTHERWISE SPECIFIED.
- ALL NECESSARY CLEARING AND GRUBBING SHALL BE COMPLETED BY THE CONTRACTOR. REVIEW WITH DEVELOPER AND THE CITY OF OTTAWA PRIOR TO TREE CUTTING.
- SUB-EXCAVATE SOFT AREAS & FILL WITH GRANULAR 'B' COMPACTED IN 0.15m LAYERS.
- NO ALTERATION TO EXISTING GRADES OR DRAINAGE PATTERN ON PROPERTY LINE MAY BE MADE WHERE NO PERMISSION TO ENTER ADJACENT PROPERTY EXISTS.
- ALL TREES ON THE RIGHT-OF-WAY ARE TO BE MAINTAINED BEFORE AND AFTER CONSTRUCTION AND ALL TREES WITHIN THE PROPERTY SHALL BE PROTECTED AS PER 'MUNICIPAL TREES AND NATURAL AREAS PROTECTION BY-LAWS' AND 'URBAN TREES CONSERVATION BY-LAW'.
- NO EXCESS DRAINAGE TO BE DIRECTED TO NEIGHBOURING PROPERTIES EITHER BEFORE OR AFTER CONSTRUCTION.

ROADWORKS

- ALL TOPSOIL AND ORGANIC MATERIAL TO BE STRIPPED FROM WITHIN THE FULL RIGHT OF WAY PRIOR TO CONSTRUCTION.
- SUB-EXCAVATE SOFT AREAS & FILL WITH GRANULAR 'B' COMPACTED IN 0.30m LAYERS.
- ALL GRANULAR FOR ROADS SHALL BE COMPACTED TO A MINIMUM OF 100% STANDARD PROCTOR MAXIMUM DRY DENSITY (SPMDD).
- ROAD SUBDRAINS SHALL BE CONSTRUCTED AS PER CITY OF OTTAWA STANDARD R1.
- ASPHALT WEAR COURSE SHALL NOT BE PLACED UNTIL THE VIDEO INSPECTION OF SEWERS & NECESSARY REPAIRS HAVE BEEN CARRIED OUT TO THE SATISFACTION OF THE CONSULTANT.
- CONTRACTOR TO OBTAIN A ROAD OCCUPANCY PERMIT 48 HOURS PRIOR TO COMMENCING ANY WORK WITHIN THE MUNICIPAL ROAD ALLOWANCE IF REQUIRED BY THE MUNICIPALITY. ALL WORK ON THE MUNICIPAL RIGHT OF WAY AND EASEMENTS TO BE INSPECTED BY THE MUNICIPALITY PRIOR TO BACKFILLING.
- PAVEMENT REINSTATEMENT FOR SERVICE AND UTILITY CUTS SHALL BE IN ACCORDANCE WITH CITY OF OTTAWA STANDARD R10, AND OPSD 509.010, AND OPSD 510.
- CONCRETE BARRIER CURBS SHALL BE CONSTRUCTED AS PER CITY STANDARD SC1.1
- CONCRETE SIDEWALKS SHALL BE CONSTRUCTED AS PER CITY STANDARDS SC3 AND SC1.4.
- PAVEMENT CONSTRUCTION AS PER GEOTECHNICAL INVESTIGATION STANTEC CONSULTING LTD. DATED MARCH 9, 2018.

STANDARD PARKING AREAS
60mm SUPERPAVE 12.5
150mm OPSS GRANULAR A BASE
300mm OPSS GRANULAR B TYPE II

HEAVY DUTY PARKING
40mm SUPERPAVE 12.5
50mm SUPERPAVE 19.0
150mm OPSS GRANULAR A BASE
400mm OPSS GRANULAR B TYPE II

V:\01\active\1 Planning\bridges\1604 Project\160410200_3856, 3866 And 3876 Navan Road\design\drawing\160410200-08.dwg
2019/02/27 1:35 PM WJ, JWP, MJS

ORIGINAL SHEET - ARCH 0