

Key	Qty	Botanical Name	Common Name	Size/Condition	Remarks
Trees					
ApC	2	ACER platanoides 'Crimson King'	CRIMSON KING MAPLE	60mm	
MFS	3	MALUS 'PINK SPIRES'	PINK SPIRES CRAB APPLE	45mm	Leave 4' soil disk at base
MST	3	MALUS 'SUGAR TITE'	SUGAR TITE CRAB APPLE	45mm	
Conifers					
PpF	2	PICEA pungens 'FAT ALBERT' or PUNG. GLAUCA	FAT ALBERT BLUE SPRUCE	225cm	Leave 5' soil disk at base
TxC	7	THUJA occ. 'FASTIGIATA COMPACTA'	COMPACT PYRAMID CEDAR	180cm	
Shrubs					
EaC	19	EUONYMUS alatus 'Compactus'	DWARF BURNING BUSH	50cm	
SJ	25	SPRAEA jap. dwarf Gold variety	GOLDMOUND SPIREA	3 gallon pot	
Smp	21	SYRINGA meyeri 'Patibini'	PALEIN DWARF LLAC	50cm	
Perennials					
Hem	81	Dwarf Hemerocallis yellow	DAYLILY - Dwarf yellow	8" pot	

- Path surface: Natural square cut patio stone
Size: 60cm X 60cm (24" x 24")
Color: Grey
- Riverbed stone: 2" diam

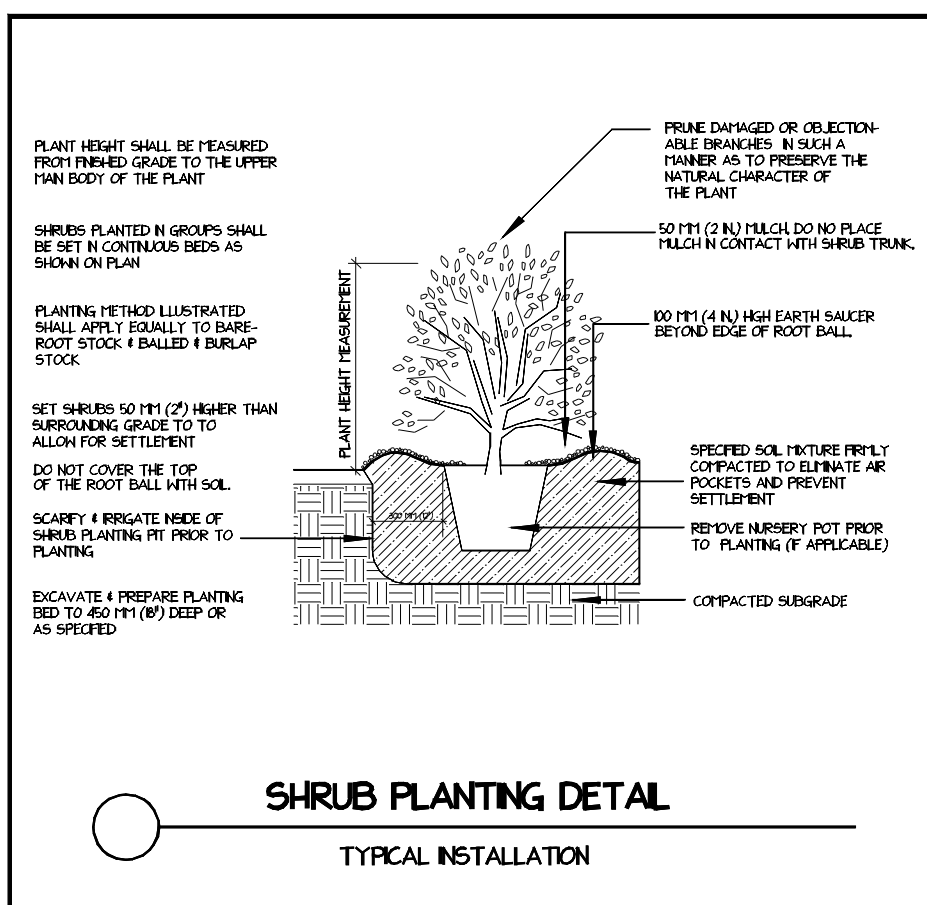
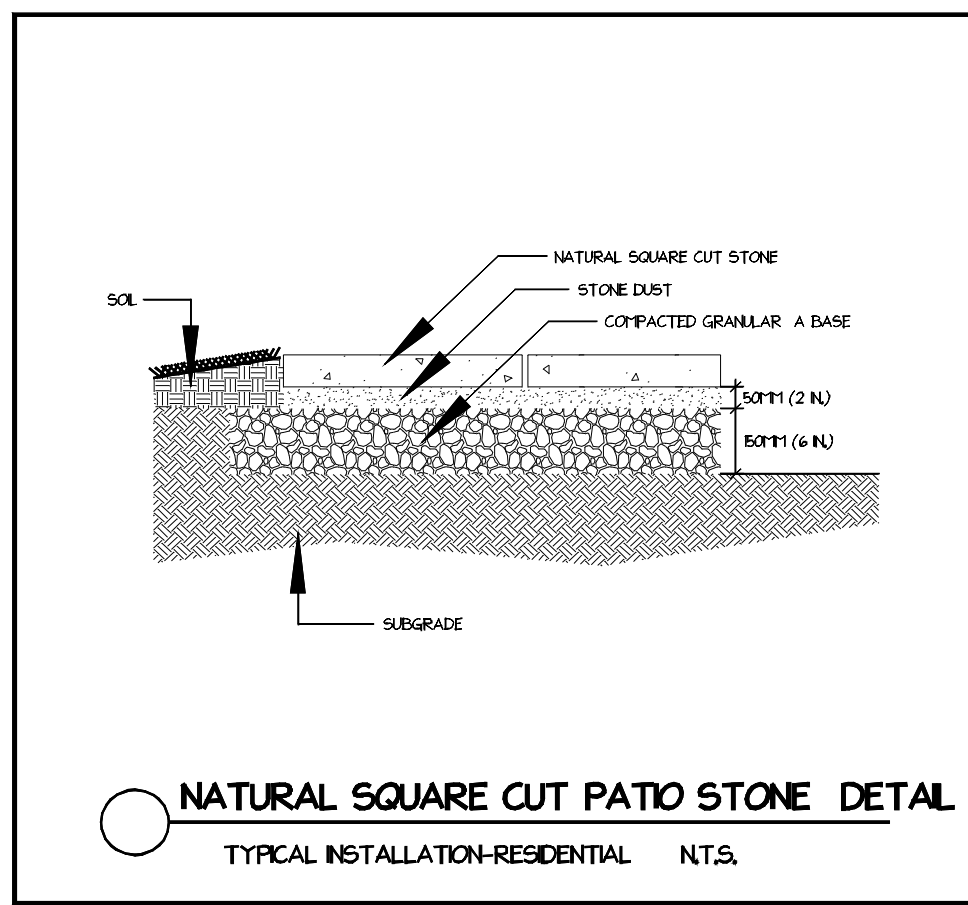

NOTES

GENERAL CONDITIONS:

The contractor shall visit the site to verify the true existing conditions. Any unclear issues shall be clarified with the consulting/design team.

It is the responsibility of the appropriate contractor to check and verify all dimensions on site and report all errors and omissions to the landscape designer.

Noted dimensions take precedence over scale, larger scale over smaller scale, addenda and classifications over previous documentation.

The contractor must comply with all pertinent city codes and bylaws.

The contractor must contact all relevant local planning authority and building control service to obtain necessary permits before starting work.

The contractor is responsible for determining the existence, location and elevation of all utilities and concealed structure, and is responsible for notifying appropriate companies, department or person of its intention to carry out the operation.

CONSTRUCTION

All landscape items shall be installed according to the manufacture installation & technical guidelines.

Substitution of material or color choice shall be permitted with notification and written approval from landscape designer.

The contractor shall assure positive drainage from all parts of the project.

SOIL PREPARATION

Soil Preparation of a landscape design is a critical factor in creating healthy and long lasting landscape.

Soil should include a mixture of 1/3 mushroom compost and 2/3 screened topsoil, and have a depth of no less than 12".

Planting beds beyond 10' deep shall have a minimum depth of 18".

Finished planting beds shall be graded to provide positive drainage.

De-compaction of soils must be done in planting areas, such as those in parking areas, former patio areas, driveways etc.

Removal of the compacted soil may be required, to the depth of 18" and then reinstalled loosely with required amendments.

PLANTING

Contractors are responsible to determine plant list quantities from the plan.

Graphic representation on the plan supersedes in case of discrepancy with quantities on legend.

All plants shall meet or exceed standards set in the Canadian standard for Nursery Stock.

All plants shall be equal or exceed the measurements and sites specified in the legend.

Substitutions shall be permitted with notification and written approval from the landscape designer.

Substituted plants shall have the same essential characteristics and growth habit of the specified plant.

Contractor may adjust plant locations as necessary to avoid utilities.

Remove all pots from plants and entire wire cage from root ball.

Out and remove burlap from 1/3 of root ball.

Compact soil around plants leaving a depressed soil disk for proper water supply. Do not plant deeper than original pot soil level.

All trees and shrubs in 5 gallon pots and larger shall be staked.

Contractor shall thoroughly water all plants at time of installation and as needed until project acceptance by owner.

All trees, shrubs, perennials to be fertilized with a commercial grade fertilizer consisting of fast and slow release nitrogen.

TREE PRESERVATION

Trees to be preserved shall be fully protected with snow fencing erected beyond their drip line to the satisfaction of the City. Areas within the protective fencing shall remain undisturbed and shall not be used for the storage of building materials or equipment. This work shall be completed prior to the commencement of site clearance, demolition or any type of construction. Snow fencing must be durable for the term of the project.

Surplus soil, equipment, debris or materials shall not be placed over the root systems of the trees within the protective fencing.

Avoid raising the grade or soil level over the existing tree roots. Major changes in grading will require a drywell and adequate drain piping to provide aeration.

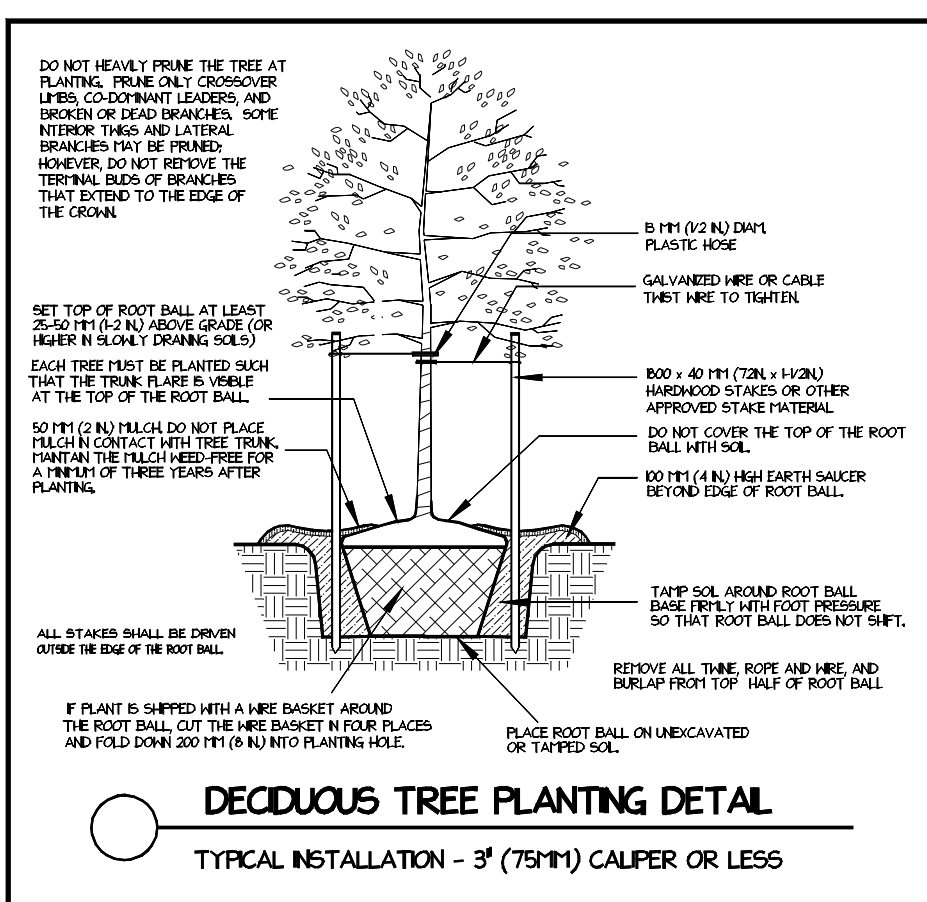

No.	Date	Description
1		
2		
3		
4		
5		
6		
7		
8		
9		
10		
11		
12		
13		
14		
15		
16		
17		
18		
19		
20		
21		
22		
23		
24		
25		
26		
27		
28		
29		
30		
31		
32		
33		
34		
35		
36		
37		
38		
39		
40		
41		
42		
43		
44		
45		
46		
47		
48		
49		
50		
51		
52		
53		
54		
55		
56		
57		
58		
59		
60		
61		
62		
63		
64		
65		
66		
67		
68		
69		
70		
71		
72		
73		
74		
75		
76		
77		
78		
79		
80		
81		
82		
83		
84		
85		
86		
87		
88		
89		
90		
91		
92		
93		
94		
95		
96		
97		
98		
99		
100		

Design supplied by:
ARTISTIC LANDSCAPE DESIGNS LTD

LANDSCAPE DESIGN

METCALF MEWS
Metcalf, Ontario

SCALE: 1cm = 200cm	PROJECT NO. 1
DRAWN BY: Metcalf	SHEET NO.
CHECKED BY:	
DATE: June 7 2016	
DATE OF PRINT:	