

CLIENT:
 AHLUL-BAYT CENTRE OTTAWA (ABCO)
 200 BARBIAU STREET
 OTTAWA, ONTARIO, K1L 7S8

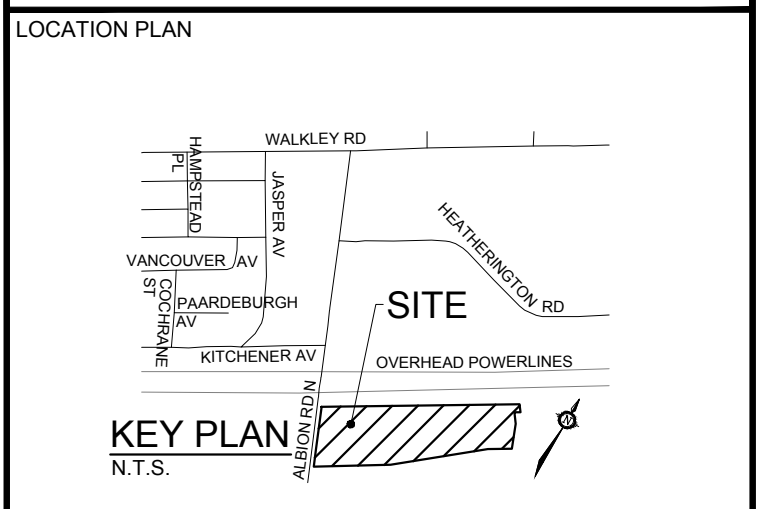

CONSULTANTS
 ARCHITECTS:
SJL
S. J. LAWRENCE
 ARCHITECT INCORPORATED
 18 South Street, Suite 205, Nepean, ON K2E 8Z7
 Tel: (613) 739-7770 Fax: (613) 739-7703
 Email: sjl@sjlarchitect.com

CIVIL ENGINEERS
NOVATECH
 Engineers, Planners & Landscape Architects
 Suite 200, 240 Michael Cowpland Drive
 Ottawa, Ontario, Canada K2M 1P6
 Telephone: (613) 254-9643
 Facsimile: (613) 254-5867
 Website: www.novatech-eng.com

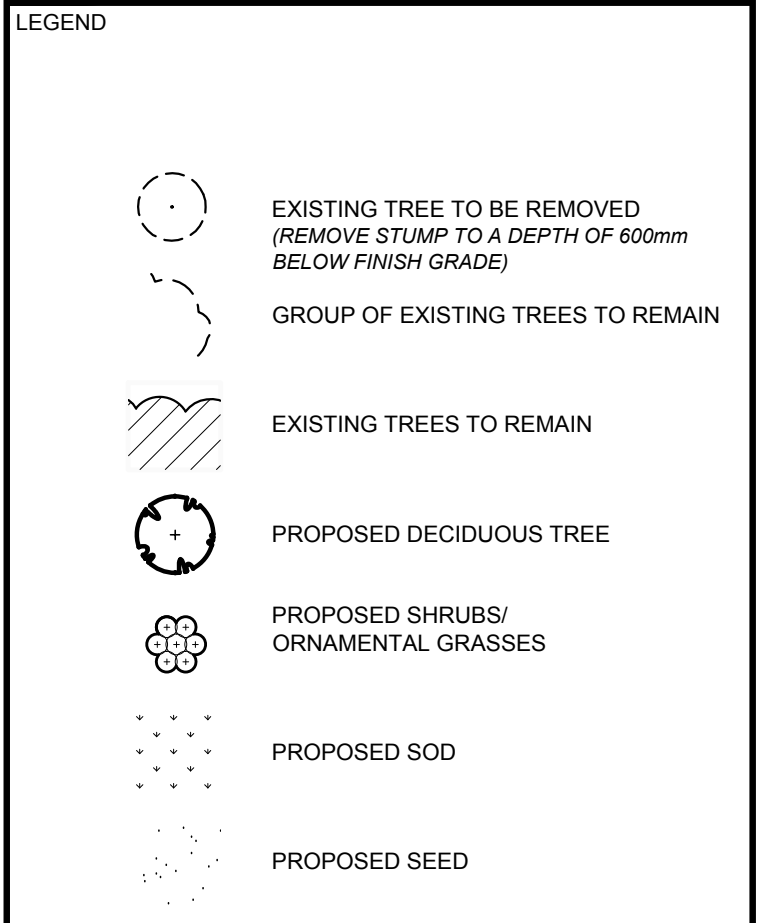

1	REVISED PER CLIENT'S COMMENTS	29/01/2016	ML	JL
No.	Issue	Date	DR	CK

JAMES B. LENNOX & ASSOCIATES INC.
 LANDSCAPE ARCHITECTS
 3332 CABLING AVE. OTTAWA, ONTARIO K2H 5A8
 Tel: (613) 723-6168 Fax: (1866) 343-3942

PROJECT
 AHLUL-BAYT CENTRE OTTAWA
 3095 ALBION ROAD NORTH, OTTAWA ONTARIO

DRAWING
 TREE CONSERVATION REPORT AND
 LANDSCAPE PLAN

STAMP
 SCALE
 1:400

START DATE
 JANUARY 2016

PROJECT NORTH
 DRAWING NO.

L.1
 PLOT SIZE ARCH D.

1 TREE CONSERVATION REPORT AND LANDSCAPE PLAN
 SCALE 1:400

KEY	QTY.	BOTANICAL NAME	COMMON NAME	SIZE	CONDITION	REMARKS
EXISTING TREE LIST						
AN	1	Acer negundo	Manitoba Maple	100-300mm Ø	GOOD	See Plan
AS	1	Acer saccharum	Sugar Maple	400mm Ø	GOOD	See Plan
EA	1	Elaeagnus angustifolia	Russian Olive	100-300mm Ø	GOOD	See Plan
FR	1	Fraxinus pennsylvanica	Green Ash	100-300mm Ø	POOR	See Plan
QM	1	Quercus macrocarpa	Bur Oak	150mm Ø	GOOD	See Plan
RC	1	Rhamnus cathartica	Common Buckthorn	100-150mm Ø	GOOD	See Plan
UA	1	Ulmus americana	American Elm	100-300mm Ø	DEAD-FAIR	See Plan

*DENOTES NUMEROUS

PROPOSED PLANT LIST

KEY	QTY.	BOTANICAL NAME	COMMON NAME	SIZE	CONDITION	REMARKS
TREES						
SM	2	Acer saccharum	Sugar Maple	70mm Ø	Ball and Burlap	See Plan
TA	2	Tilia americana	Basswood	70mm Ø	Ball and Burlap	See Plan
SHRUBS						
AH	16	Hydrangea arborescens 'Annabelle'	Annabelle Hydrangea	1 Gallon Pot	Potted	Space 1000mm O.C.
JH	9	Juniperus horizontalis	Creeping Juniper	600mm Spr.	Potted	Space 500mm O.C.
RR	15	Rosa rugosa	Rugosa Rose	600mm HT.	Potted	Space 1000mm O.C.
SS	9	Sorbaria sorbifolia 'Sem'	Sem Falsa Spirea	600mm HT.	Potted	Space 1000mm O.C.
ORNAMENTAL GRASSES						
KF	60	Calamagrostis x acutiflora 'Karl Foerster'	Feather Reed Grass	250mm Pot.	Potted	Space 1000mm O.C.

- GENERAL NOTES:**
- It is the responsibility of the appropriate contractor or official to report any errors, omissions or discrepancies on this plan with actual site conditions to the Landscape Architect before proceeding with construction.
 - The contractor is to notify all utility companies and authorities prior to any excavation and ascertain locations of underground services.
 - The contractor is to reinstate all areas and items damaged as a result of construction activity.
 - The contractor is to comply with all pertinent codes and by-laws.
 - The contractor is to maintain a positive surface run-off throughout the entire construction period.
 - The Landscape Architect is not responsible for subsurface conditions.
 - The contractor is to identify all existing trees to remain on site with the Landscape Architect prior to construction.
 - The contractor is to stake the proposed location of all plant material in conjunction with the Landscape Architect prior to excavation.
 - Minimum distances for selected deciduous trees are as follows:
 - Building Foundations 7.5m
 - Public Streets 2.5m
 - Sidewalks 1.5m
 - Underground Infrastructure 2.0m
 - All trees within 1m of underground utility trenches are to be excavated by hand.
 - Remove all protective wrapping from tree trunks after installation.
 - Staking of trees shall only be performed if necessary.
 - Ensure that mulch is pulled back a min. distance of 75mm from base of tree trunk.

