

CONSULTANTS

ARCHITECTS:

SJL

S. J. LAWRENCE ARCHITECT INCORPORATED

18 Beekin Street, Suite 205, Nepean, ON K2E 8B7
Tel: (613) 759-7770 Fax: (613) 759-7703
Email: @sjlarchitect.com

CIVIL ENGINEERS

NOVATECH

Engineers, Planners & Landscape Architects
Suite 200, 240 Michael Cowpland Drive
Ottawa, Ontario, Canada K2M 1P5

Telephone: (613) 254-9643
Facsimile: (613) 254-5867
Website: www.novatech-eng.com

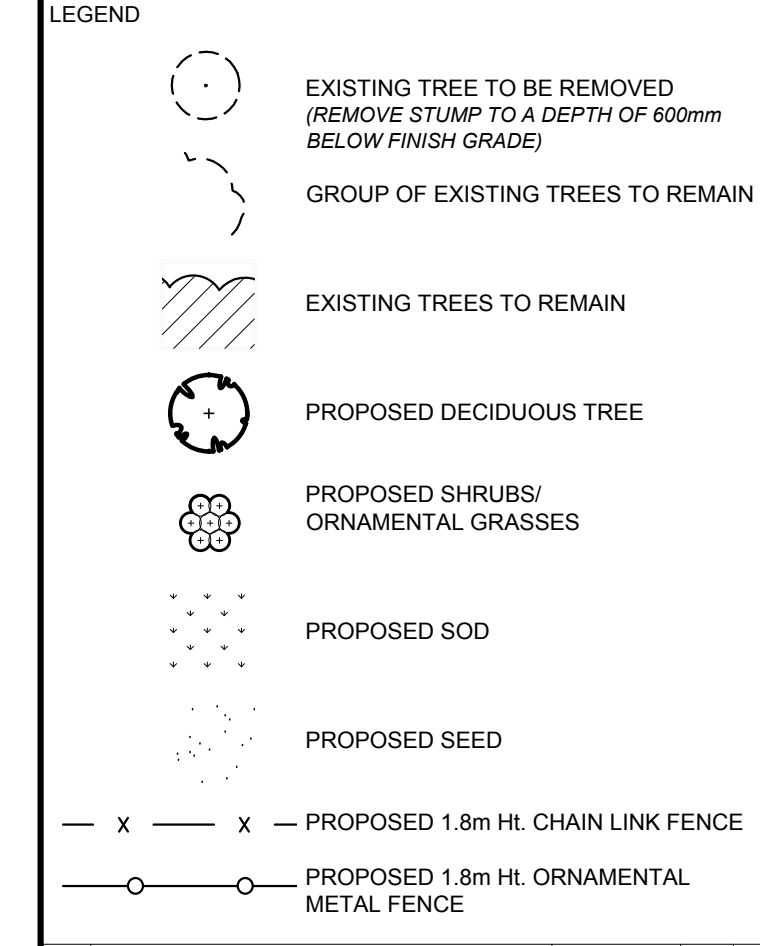

No.	Issue	Date	DR	CK
3	ISSUED FOR SPC AND ZBA	06/01/2017	ML	JL
2	REVISED PER NEW SITE PLAN	23/12/2016	ML	JL
1	REVISED PER CLIENT'S COMMENTS	29/01/2016	ML	JL

JAMES B. LENNOX & ASSOCIATES INC. LANDSCAPE ARCHITECTS

3332 CARLING AVE. OTTAWA, ONTARIO K2H 5A8
Tel: (613) 722-5168 Fax: (1866) 343-3942

PROJECT: AHLUL-BAYT CENTRE OTTAWA
3095 ALBION ROAD NORTH, OTTAWA ONTARIO

DRAWING: TREE CONSERVATION REPORT AND LANDSCAPE PLAN

STAMP: SCALE 1:400

START DATE: JANUARY 2016

PROJECT NO.: 16-SJL-1610

PROJECT NORTH: DRAWING NO. L.1

PLOT SIZE ARCH. D.

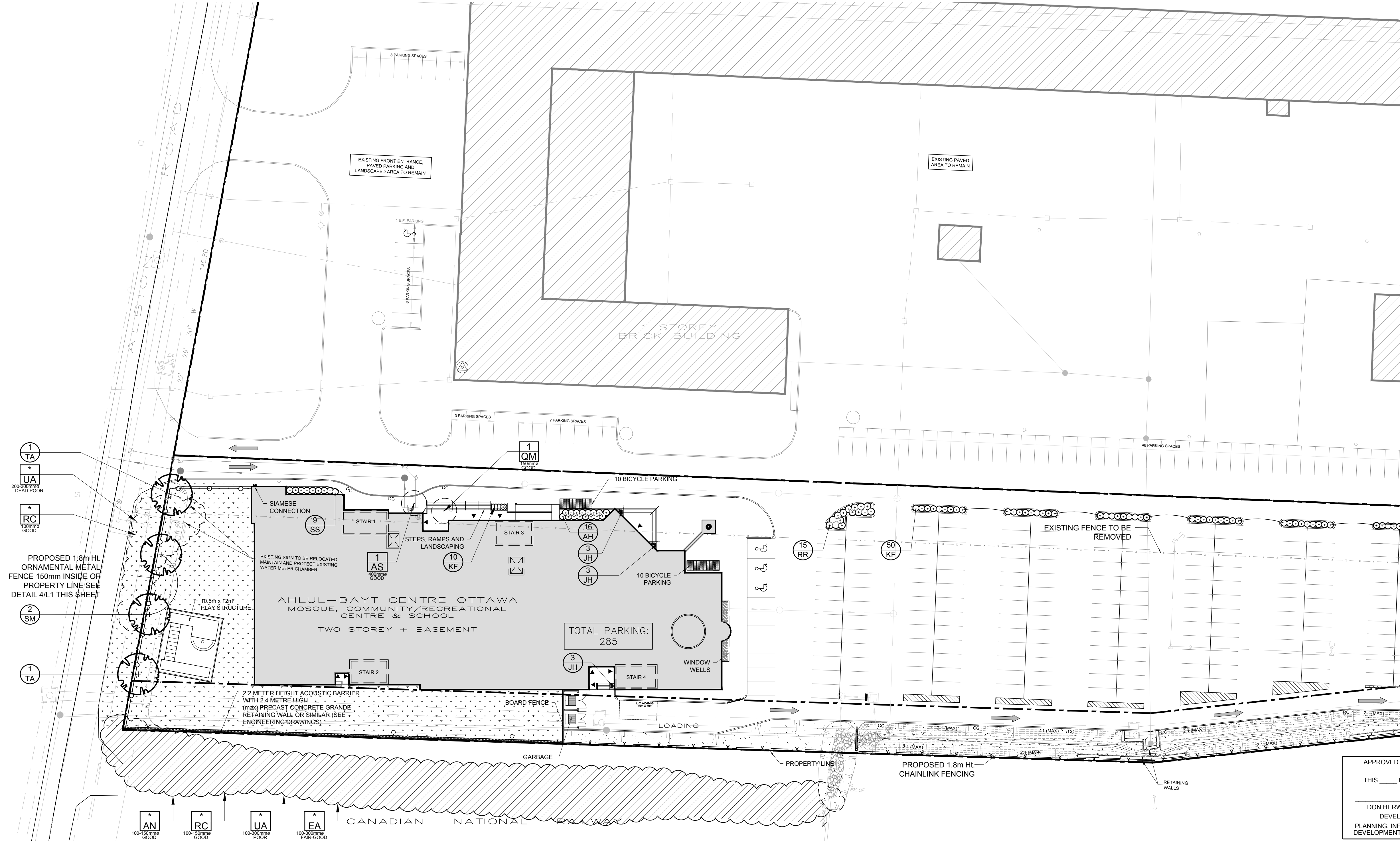

REFER TO DRAWING L-2 FOR CONTINUATION OF SITE

APPROVED REFUSED

THIS ___ DAY OF _____, 20__

DON HERWEYER, MCIP, RPP, MANAGER
DEVELOPMENT REVIEW SOUTH
PLANNING, INFRASTRUCTURE AND ECONOMIC DEVELOPMENT DEPARTMENT, CITY OF OTTAWA

1 TREE CONSERVATION REPORT AND LANDSCAPE PLAN
SCALE 1:400

EXISTING TREE LIST

KEY	QTY.	BOTANICAL NAME	COMMON NAME	SIZE	CONDITION	REMARKS
AN	*	Acer negundo	Manitoba Maple	100-300mm Ø	GOOD	See Plan
AS	*	Acer saccharum	Sugar Maple	400mm Ø	GOOD	See Plan
EA	*	Elaeagnus angustifolia	Russian Olive	100-300mm Ø	GOOD	See Plan
FR	*	Fraxinus pennsylvanica	Green Ash	100-300mm Ø	POOR	See Plan
QM	1	Quercus macrocarpa	Bur Oak	150mm Ø	GOOD	See Plan
RC	*	Rhamnus cathartica	Common Buckthorn	100-150mm Ø	GOOD	See Plan
UA	*	Ulmus americana	American Elm	100-300mm Ø	DEAD-FAIR	See Plan

*DENOTES NUMEROUS

PROPOSED PLANT LIST

KEY	QTY.	BOTANICAL NAME	COMMON NAME	SIZE	CONDITION	REMARKS
SM	2	Acer saccharum	Sugar Maple	70mm Ø	Ball and Burlap	See Plan
TA	2	Tilia americana	Basswood	70mm Ø	Ball and Burlap	See Plan
TREES						
AH	16	Hydrangea arborescens 'Annabelle'	Annabelle Hydrangea	1 Gallon Pot	Potted	Space 1000mm O.C.
JH	9	Juniperus horizontalis	Creeping Juniper	600mm Spr.	Potted	Space 500mm O.C.
RR	15	Rosa rugosa	Rugosa Rose	600mm Ht.	Potted	Space 1000mm O.C.
SS	9	Sorbaria sorbifolia 'Sem'	Sem False Spirea	600mm Ht.	Potted	Space 1000mm O.C.
SHRUBS						
ORNAMENTAL GRASSES						
KF	60	Calamagrostis x acutiflora 'Karl Foerster'	Feather Reed Grass	250mm Pot.	Potted	Space 1000mm O.C.

- GENERAL NOTES:**
- It is the responsibility of the appropriate contractor or official to report any errors, omissions or discrepancies on this plan with actual site conditions to the Landscape Architect before proceeding with construction.
 - The contractor is to notify all utility companies and authorities prior to any excavation and ascertain locations of underground services.
 - The contractor is to reinstate all areas and items damaged as a result of construction activity.
 - The contractor is to comply with all pertinent codes and by-laws.
 - The contractor is to maintain a positive surface run-off throughout the entire construction period.
 - The Landscape Architect is not responsible for subsurface conditions.
 - The contractor is to identify all existing trees to remain on site with the Landscape Architect prior to construction.
 - The contractor is to stake the proposed location of all plant material in conjunction with the Landscape Architect prior to excavation.
 - Minimum distances for selected deciduous trees are as follows:
 - Building Foundations 7.5m
 - Sidewalks 1.5m
 - Public Streets 2.5m
 - Underground Infrastructure 2.0m
 - All trees within 1m of underground utility trenches are to be excavated by hand.
 - Remove all protective wrapping from tree trunks after installation.
 - Staking of trees shall only be performed if necessary.
 - Ensure that mulch is pulled back a min. distance of 75mm from base of tree trunk.

NOTE REGARDING THE REMOVAL OR DAMAGE OF EXISTING TREES:

A City of Ottawa tree removal permit from the Planning and Growth Management Department is required to remove any of the trees indicated for removal on this plan. In addition to this, the contractor is to receive approval from the owner's of adjacent properties where the trees may be on or close to the property line such as along the north lot line of the subject property. Property owners and the city of Ottawa planning and growth management department must be notified prior to any activity within the critical root zone (CRZ) of "existing trees to remain." The city of Ottawa Planning and Growth Management Department is to approve in writing the removal of any additional trees to be removed which are not indicated on this plan.

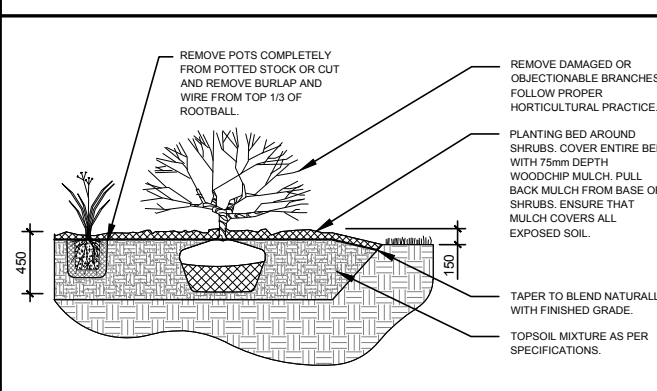

2 SHRUB/PERENNIAL PLANTING
SCALE: N.T.S.

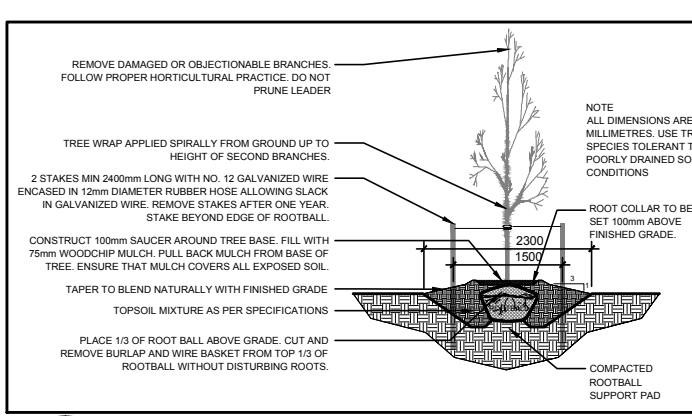

3 DECIDUOUS TREE PLANTING
SCALE: N.T.S.

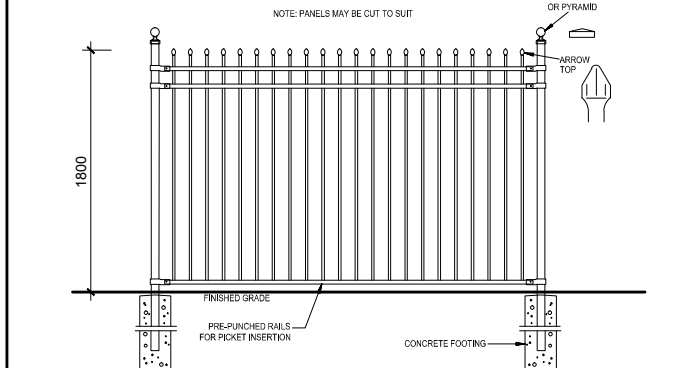

4 1.8m Ht. ORNAMENTAL METAL FENCE
SCALE: N.T.S.

D07-12-16-0025