

Legend

- X 85.59 PROPOSED ELEVATION
- EXISTING GROUND ELEVATIONS
- 1.0% PROPOSED GRADE
- MAJOR OVERLAND FLOW ROUTE
- PROPOSED STORM MANHOLE
- PROPOSED CATCHBASIN MANHOLE
- PROPOSED SANITARY MANHOLE
- PROPOSED CATCHBASIN
- PROPOSED BARRIER CURB SC1.1
- PROPOSED DEPRESSED BARRIER CURB SC1.1
- 3:1 TERRACING UNLESS OTHERWISE SHOWN

GENERAL NOTES

1. ALL WORK SHALL BE CARRIED OUT IN COMPLIANCE WITH THE ONTARIO OCCUPATIONAL HEALTH AND SAFETY ACT AND REGULATIONS FOR CONSTRUCTION PROJECTS.
2. ALL WORK AND MATERIALS TO CONFORM WITH CURRENT MINISTRY OF THE ENVIRONMENT & ENERGY OF ONTARIO, TOWN OF HAWKSBURY AND ONTARIO PROVINCIAL STANDARDS AND SPECIFICATIONS. LOCAL UTILITY STANDARDS AND MINISTRY OF TRANSPORTATION STANDARDS WILL APPLY WHERE REQUIRED.
3. SITE PLAN PREPARED BY: ROSALINE J. HILL  
REVISION: JANUARY 4, 2015  
DRAWING: SITE PLAN  
SITE BENCHMARK PROVIDED BY: ANNIS, O'SULLIVAN, AND VOLLEBECK LTD.  
LOCATION / DESCRIPTION: TOP OF SPINDLE OF EX. SOUTHWEST FIRE HYDRANT ON BEDALE DRIVE  
TOPO SURVEY PREPARED BY: ANNIS, O'SULLIVAN, AND VOLLEBECK LTD.  
DATED: AUGUST 14, 2015
4. THE CONTRACTOR IS ADVISED THAT WORKS BY OTHERS MAY BE ONGOING DURING THE PERIOD OF THIS CONTRACT. THE CONTRACTOR SHALL COORDINATE CONSTRUCTION ACTIVITIES AND COORDINATION WITH ALL OTHER CONTRACTORS AND PREVENT CONSTRUCTION CONFLICTS.
5. THE INFORMATION SHOWN FOR EXISTING UTILITIES WAS PROVIDED BY OTHERS. THE CONTRACTOR IS RESPONSIBLE FOR LOCATING AND PROTECTING ALL UTILITIES DURING CONSTRUCTION. ALL EXISTING UTILITIES MUST BE LOCATED AND VERIFIED BY EACH UTILITY PRIOR TO COMMENCEMENT OF WORK. ANY VARIANCE IS TO BE IMMEDIATELY REPORTED TO THE ENGINEER. LOST TIME DUE TO FAILURE OF THE CONTRACTOR TO CONFIRM UTILITY LOCATIONS AND NOTIFY THE ENGINEER OF POSSIBLE CONFLICTS PRIOR TO CONSTRUCTION WILL BE AT THE CONTRACTOR'S EXPENSE.
6. ALL CONSTRUCTION SHALL BE CARRIED OUT IN ACCORDANCE WITH THE RECOMMENDATIONS MADE IN THE GEOTECHNICAL REPORT.
7. THE CONTRACTOR IS RESPONSIBLE FOR OBTAINING ALL PERMITS REQUIRED AND TO BEAR THE COST OF SAME INCLUDING WATER PERMIT AND ASSOCIATED COSTS.
8. ALL DISTURBED AREAS SHALL BE REINSTATED TO EQUAL OR BETTER CONDITION TO THE SATISFACTION OF THE ENGINEER AND THE CITY. PAVEMENT REINSTATEMENT FOR SERVICE AND UTILITY CUTS SHALL BE IN ACCORDANCE WITH DETAIL R10 ON DWG GP-1.
9. FOR DETAILS RELATING TO STORMWATER MANAGEMENT AND ROOF DRAINAGE, SEE THE STORMWATER MANAGEMENT REPORT PREPARED BY STANTEC CONSULTING LTD. ROOF DRAINAGE TO BE PROVIDED VIA RESTRICTED FLOW ROOF DRAINS.
10. BENCHMARKS: IT IS THE RESPONSIBILITY OF THE CONTRACTOR TO VERIFY THAT THE SITE BENCHMARK(S) HAS NOT BEEN ALTERED OR DISTURBED AND THAT ITS RELATIVE ELEVATION AND DESCRIPTION AGREES WITH THE INFORMATION SHOWN ON DRAWING GP-1.
11. THE CONTRACTOR SHALL PROVIDE TO THE ENGINEER 1 (ONE) SET OF AS CONSTRUCTED SITE SERVICING, GRADING, AND SITE ELECTRICAL DWGS.
12. SANITARY AND WATER SERVICE SIZED TO BE CONFIRMED BY MECHANICAL CONSULTANT AT DETAILED DESIGN.

Revision	By	Appd.	YY.MM.DD
1	WAJ	SGG	16.01.29

File Name: 160401218-FB  
Dwn. Chkd. Dgn. YY.MM.DD

Client/Project  
CARDEL DEVELOPMENTS LTD  
3368 CARLING AVE  
OTTAWA, ON

Title  
GRADING PLAN

Project No. 160401218  
Scale 1:150  
Drawing No. GP-1  
Sheet  
Revision  
2 of 4

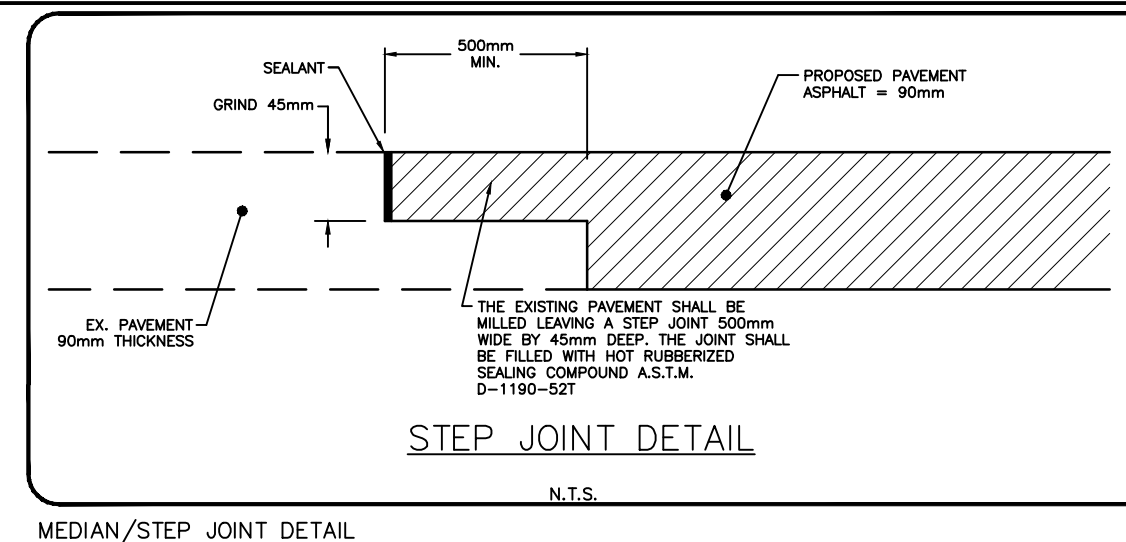
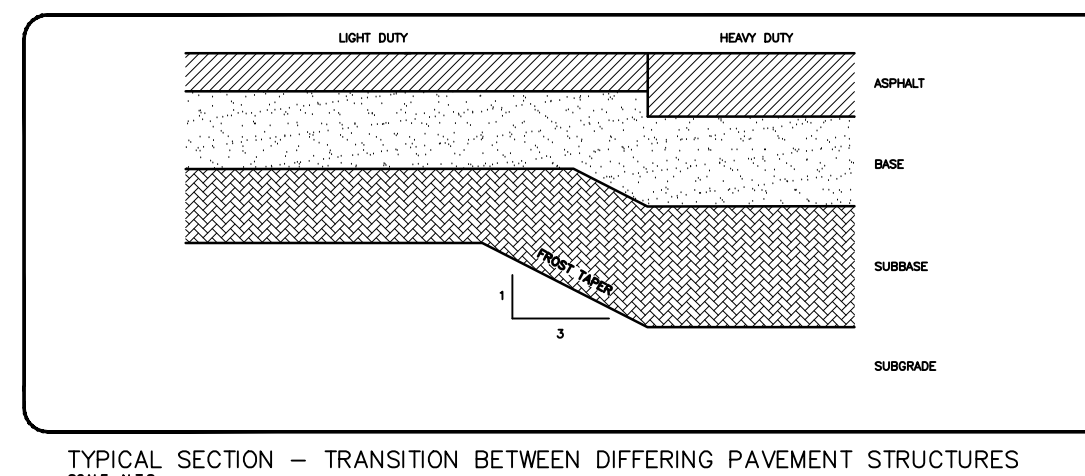
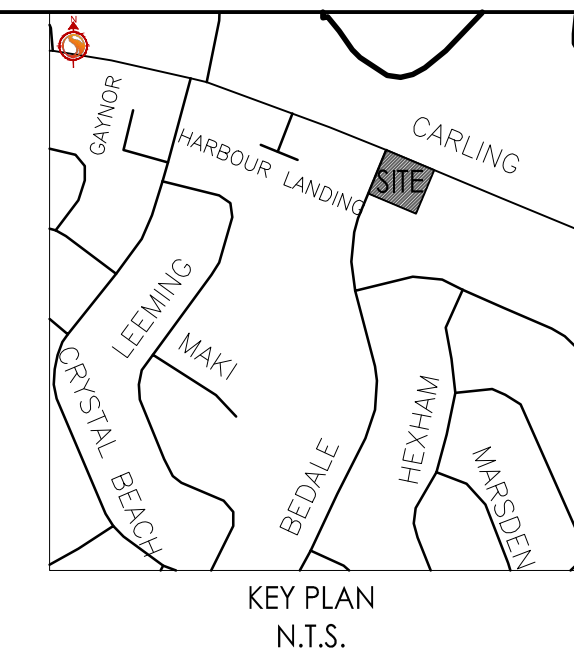

MEDIAN/STEP JOINT DETAIL

TYPICAL SECTION - TRANSITION BETWEEN DIFFERING PAVEMENT STRUCTURES

CARLING AVENUE

BEDALE DRIVE

**PROPOSED APARTMENT**  
15 DWELLING UNITS  
18 INDOOR PARKING SPACES  
FFE = 66.34  
TBS = 63.29  
USF = 62.89  
MAX ROOF RELEASE RATE = 3.7 L/s  
ROOFTOP STORAGE REQUIRED = 20.7m<sup>3</sup>

\*SUMP PUMP REQUIRED IN MECHANICAL ROOM TO DISCHARGE INTERNAL STORM SYSTEM GRADE RAISE=1.5m

- SITE GRADING**
1. ALL GRANULAR BASE & SUB BASE COURSE MATERIALS SHALL BE COMPACTED TO 98% STANDARD PROCTOR MAX. DRY DENSITY.
  2. ALL DISTURBED GRASSED AREAS SHALL BE RESTORED TO ORIGINAL CONDITION OR BETTER, WITH 500 ON MIN. 100mm TOPSOIL. THE RELOCATION OF TREES AND SHRUBS SHALL BE SUBJECT TO APPROVAL BY THE PROJECT LANDSCAPE ARCHITECT OR ENGINEER.
  3. ALL BARRIER CURBS, CONCRETE ISLANDS AND SIDEWALKS (SEE LEGEND) SHOWN ON THIS DRAWING ARE TO BE PRICED IN THE SITEMWORKS PORTION OF THE CONTRACT. ALL BARRIER CURBS AND SIDEWALKS TO BE CONSTRUCTED PER CITY OF OTTAWA STANDARD DRAWING SC1 AND SC2.
  4. INSPECTIONS: ALL WORK ON THE MUNICIPAL RIGHT OF WAY AND EASEMENTS TO BE INSPECTED BY THE MUNICIPALITY PRIOR TO BACKFILLING. ALL WORK RELATING TO WATERMANS AND SEWERS TO BE INSPECTED BY THE MUNICIPALITY WHEN REQUIRED.
  5. REFER TO ARCHITECTURAL SITE PLAN FOR DIMENSIONS AND SITE DETAILS.
  6. STEP JOINTS ARE TO BE USED WHERE PROPOSED ASPHALT MEETS EXISTING ASPHALT AS PER DETAIL ON DS-1. ALL JOINTS MUST BE SEALED AS PER DETAIL.
  7. CONTRACTOR TO OBTAIN A ROAD OCCUPANCY PERMIT 48 HOURS PRIOR TO COMMENCING ANY WORK WITHIN THE MUNICIPAL ROAD ALLOWANCE IF REQUIRED BY THE MUNICIPALITY.
  8. EMBANKMENTS TO BE SLOPED AT MIN. 3:1, UNLESS OTHERWISE SPECIFIED.
  9. ALL PAVEMENT MARKING, LINE PAINTING, DIRECTIONAL LINES/ARROWS ETC. SHALL BE PLACED IN ACCORDANCE WITH THE ARCHITECTURAL SITE PLAN OR THE OWNER'S TRAFFIC ENGINEERING CONSULTANT'S DRAWINGS. LINE PAINTING AND DIRECTIONAL SYMBOLS SHALL BE APPLIED WITH A MINIMUM OF TWO COATS OF ORGANIC SOLVENT BASED PAINT.
  10. THE CONTRACTOR SHALL PROVIDE TO THE ENGINEER 1 (ONE) SET OF AS CONSTRUCTED SITE SERVICING, GRADING, AND SITE ELECTRICAL DWGS.
  11. SITE SIGNAGE TO BE INSTALLED AS PER ARCHITECTURAL SITE PLAN.
  12. ALL NECESSARY CLEARING AND GRUBBING SHALL BE COMPLETED BY THE CONTRACTOR. REVIEW WITH ARCHITECT AND THE CITY OF OTTAWA PRIOR TO TREE CUTTING.
  13. SUB-EXCAVATE SOFT AREAS & FILL WITH GRANULAR "B" COMPACTED IN 0.15m LAYERS.
  14. FOR ALL LANDSCAPING FEATURES (ie. TREES, WALKWAYS, PARK DETAILS, NOISE BARRIERS, FENCES etc.) REFER TO LANDSCAPE ARCHITECT PLAN.
  15. ROUGH GRADING FOR LANDSCAPED ISLANDS TO BE LEFT 150mm BELOW CURB AND COMPACTED TO 95%.
  16. WHERE APPLICABLE THE CONTRACTOR IS TO SUBMIT SHOP DRAWINGS FOR RETAINING WALLS (INCLUDE RAINLINES IF APPLICABLE) TO THE ENGINEER FOR APPROVAL PRIOR TO CONSTRUCTION. SHOP DRAWINGS MUST BE SITE SPECIFIC, SIGNED AND SEALED BY A LICENSED STRUCTURAL ENGINEER. THE CONTRACTOR WILL ALSO BE REQUIRED TO SUBMIT STRUCTURAL AND GEOTECHNICAL CERTIFICATION OF THE AS-CONSTRUCTED RETAINING WALL TO THE ENGINEER PRIOR TO FINAL ACCEPTANCE.

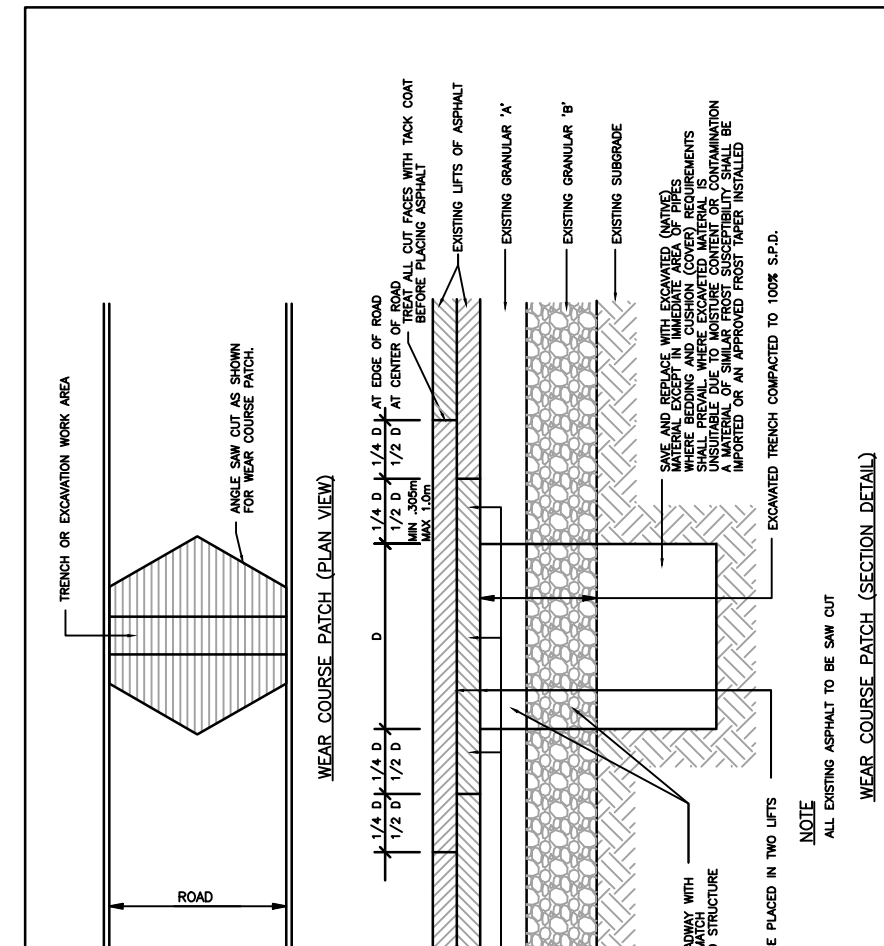

STANDARD ROAD CUT REINSTATEMENT

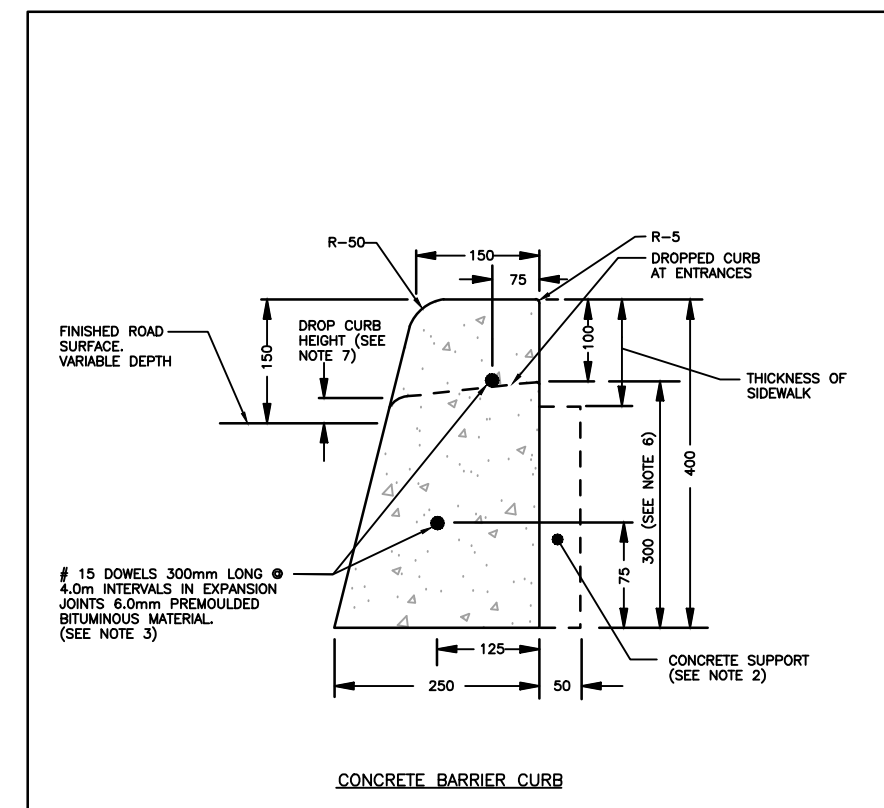

CONCRETE BARRIER CURB FOR GRANULAR BASE PAVEMENT (MODIFIED OPSD-600.110)



W:\active\160401218\_3368 Carling Ave (west 2023)\design\dwg\160401218-FB.dwg  
20/01/2024 2:42 PM by: J. Johnson, W. W. W.