

**LEGEND**

- PROPOSED HYDRANT
- PROPOSED VALVE AND VALVE BOX
- PROPOSED 600mm x 600mm CATCH BASIN
- CW 150mm Ø PERFORATED SUBDRAIN
- PROPOSED 1200mmØ CATCH BASIN MANHOLE
- CW 150mm Ø PERFORATED SUBDRAIN
- PROPOSED STORM MANHOLE (1200mmØ UNLESS OTHERWISE NOTED)
- PROPOSED SANITARY MANHOLE (1200mmØ UNLESS OTHERWISE NOTED)
- PROPOSED WATER METER
- PROPOSED REMOTE WATER METER
- PROPOSED SIAMISE CONNECTION
- PROPOSED SANITARY SEWER
- PROPOSED WATERMAIN
- PROPOSED STORM SEWER
- PROPERTY LINE
- PROPOSED SEWER EASEMENT
- PROPOSED CAP
- PROPOSED BUILDING ENTRANCE
- PROPOSED SITE LIGHTING
- PROPOSED SERVICING
- PROPOSED REDUCER
- EXISTING SANITARY SEWER
- EXISTING STORM SEWER
- EXISTING WATERMAIN
- EXISTING FENCE
- EXISTING UTILITY EASEMENT
- EXISTING SITE LIGHTING
- EXISTING MANHOLE
- EXISTING CATCHBASIN
- EXISTING TOP OF GRATE ELEVATION
- EXISTING HYDRANT
- EXISTING VALVE AND VALVE BOX
- EXISTING BUILDING ENTRANCE
- EXISTING LIGHT POLE TO BE RELOCATED

**NOTES: SEWER**

1. CATCHBASINS SHALL BE PRECAST 600 x 600 AS PER OPSD STD. 705.01. FRAMES AND COVERS SHALL BE AS PER OPSD 400.01
2. SEWER BEDDING AS PER OPSD STD. 802.03 WITH MIN. 150mm GRANULAR 'A' BEDDING COMPACTED TO 95% STANDARD PROCTOR DENSITY.
3. ALL WORK SHALL BE PERFORMED, AS APPLICABLE IN ACCORDANCE WITH CITY OF OTTAWA SPECIFICATIONS, AND IN PARTICULAR, WITH O.P.S.S. 407, AND 410.
4. ALL SANITARY SEWERS ARE TO BE THE SIZES INDICATED AND THE MATERIAL SHALL BE PVC.
5. ALL STORM SEWER TO BE PVC SDR 35 OR APPROVED EQUIVALENT.
6. ALL MANHOLES, CATCHBASINS AND CATCHBASIN MANHOLES TO BE BACKFILLED WITH MIN. 0.3m HORIZ. THICKNESS OF GRANULAR A.
7. ALL MANHOLES AND CBMH TO BE OPSD 701.010 & 701.011 COVERS TO BE PER CITY OF OTTAWA STANDARDS.
8. U/G CONTRACTOR TO CONFIRM LOCATION(S) AND ELEVATION(S) OF EXISTING SERVICES AND STRUCTURES TO BE CONNECTED TO AND EXISTING SERVICES THAT MAY CAUSE CONFLICTS PRIOR TO CONSTRUCTION OF ANY NEW SEWER, WATER AND/OR STORM WATER WORKS. THE ENGINEER SHALL BE INFORMED IMMEDIATELY OF ANY ERRORS, DISCREPANCIES, CONFLICTS, OMISSIONS etc. THAT ARE
9. SUPPLY AND INSTALL ALL PIPING AND APPURTENANCES AS SHOWN TO WITHIN 1.0m OF BUILDING WALLS. PROVIDE TEMPORARY CAPS.
10. CONNECT TO CITY'S SANITARY SEWERS, USING A MANUFACTURED TEE INSTALLED AS PER STD. DWG. S11.
11. ADJUST ALL EXISTING AND PROPOSED MANHOLES TO PROPOSED GRADE.

**NOTES: WATERMAIN**

1. ALL WATERMAIN WORK AND MATERIAL SHALL BE IN ACCORDANCE WITH CITY OF OTTAWA STANDARDS. NO WORK SHALL COMMENCE UNLESS A CITY WATER WORKS INSPECTOR IS ON SITE.
2. INSTALLATION OF WATER METER AND REMOTE RECEPTACLE SHALL BE IN ACCORDANCE WITH CITY OF OTTAWA STANDARDS.
3. HYDRANT LOCATION AND INSTALLATION AS PER STD. DWG. W18 & W19
4. ALL WATERMAIN TO BE INSTALLED AT MINIMUM COVER OF 2.4m.
5. WATERMAIN BEDDING IS TO BE AS PER CITY OF OTTAWA DETAIL W-17.
6. CATHODIC PROTECTION REQUIRED FOR ALL IRON FITTINGS PER CITY OF OTTAWA DETAILS W-40 AND W-42.
7. IF WATERMAIN MUST BE DEFLECTED TO MEET ALIGNMENT, ENSURE THAT THE AMOUNT OF DEFLECTION USED IS LESS THAN HALF THAT RECOMMENDED BY THE MANUFACTURER.

ORIFICE SUMMARY					
Location	Controlled Release	Outlet Pipe Dia.	Orifice Dia.	Hydrovex Model	Head on Hydrovex
CB MH 407	10.0	381	N/A	75-VHV-1	3.80
CB MH 418	35.0	303	100	N/A	N/A
BUILDING 500	22.1	381	N/A	N/A	N/A
CB MH 415	90.0	381	165	N/A	N/A
CB MH 411	40.0	457	108	N/A	N/A
CB 413	28.0	284	90	N/A	N/A
CB 419	75.0	306	146	N/A	N/A
BUILDING 500	37.6	381	N/A	N/A	N/A

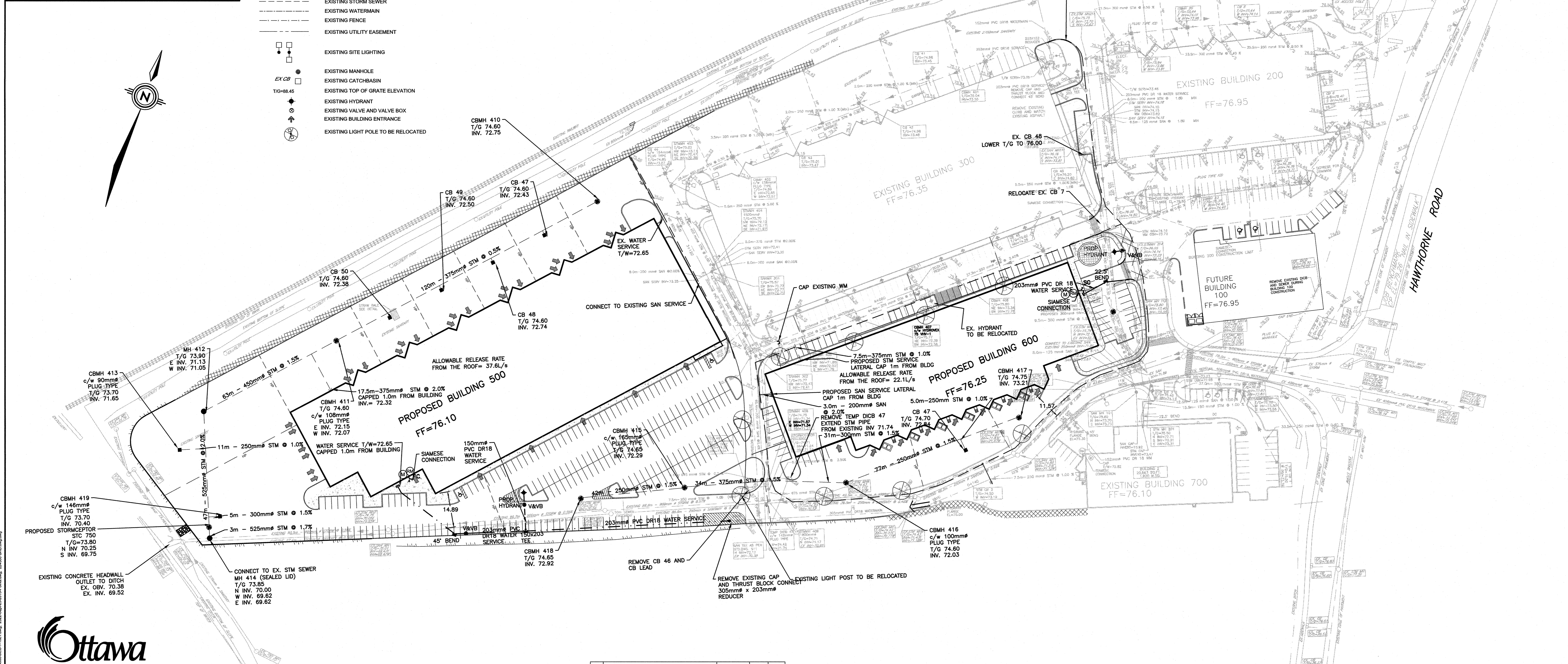

**NOTES**  
 THE POSITION OF ALL POLE LINES, CONDUITS, WATERMANS, SEWERS AND OTHER UNDERGROUND AND OVERGROUND UTILITIES AND STRUCTURES IS NOT NECESSARILY SHOWN ON THE CONTRACT DRAWINGS, AND WHERE SHOWN, THE ACCURACY OF THE POSITION OF SUCH UTILITIES AND STRUCTURES IS NOT GUARANTEED. BEFORE STARTING WORK, DETERMINE THE EXACT LOCATION OF ALL SUCH UTILITIES AND STRUCTURES AND ASSUME ALL LIABILITY FOR DAMAGE TO THEM.

NO.	REVISION DESCRIPTION	DATE	BY	APPD
2	REVISED ISSUE FOR SITE PLAN APPROVAL BUILDING 500 & 600	11/12/15	ML	AA
1	ISSUED FOR SITE PLAN APPROVAL BUILDING 500 & 600	09/11/15	ML	AA

SCALE  
1:750

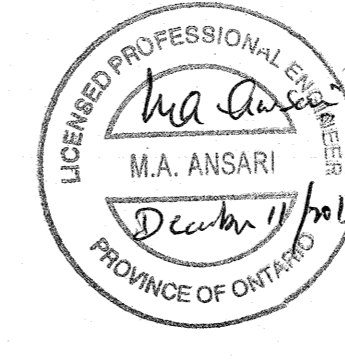

1172321 ONTARIO INCORPORATED  
 223 COLONNADE RD. S., OTTAWA  
 K2E 7K3  
 613-723-7490

exp Services Inc.  
 1-813-688-1891 | 1-813-256-7330  
 2650 Queenston Drive, Unit 100  
 Ottawa, ON K2B 8K6  
 Canada  
 www.exp.com  
 • BUILDINGS • EARTH & ENVIRONMENT • ENERGY •  
 • INDUSTRIAL • INFRASTRUCTURE • SUSTAINABILITY •

DESIGN	PROJECT
exp	3020 HAWTHORNE ROAD
AA/ML	BUILDING 500, 600
AA	CITY OF OTTAWA
ML	SITE SERVICING
AA	PLAN
AA	

PROJ. NO.	DATE	DRAWING NO.
224388	OCTOBER 2015	SS1