

5 AND 100 YEAR SURFACE STORAGE VOLUMES

DRAINAGE AREA ID	TOTAL AREA (sq.m)	5 YEAR			100 YEAR		
		AREA (sq.m)	DEPTH (m)	VOLUME (cu.m)	AREA (sq.m)	DEPTH (m)	VOLUME (cu.m)
A301	3400	180	0.15	9.0	492	0.26	42.6
A302	1090	178	0.15	8.9	475	0.26	41.2
A303	1380	327	0.15	16.4	626	0.26	54.3
A304	920	189	0.15	9.5	451	0.26	39.1
A305	920	161	0.15	8.1	424	0.26	36.8
A306	1980	142	0.15	7.1	254	0.20	17.0
A307	9360	9400	0.02	188	9400	0.041	388
A308	820	206	0.15	10.3	492	0.25	41.0
A309	800	191	0.15	9.6	476	0.25	39.7
A310	1050	245	0.15	12.3	600	0.25	50.0
A301*	5530	5530	0.02	94.5	5530	0.041	229.8
A302	690	48	0.05	0.8	155	0.20	10.3
A303	820	198	0.10	6.5	519	0.25	43.2
A304	1920	625	0.15	28.3	1188	0.30	118
A305	5180	670	0.15	33.5	1280	0.30	128
A306	1980	504	0.15	25.2	917	0.30	91.7
A307	1100	0	0	0	0	0	0
TOTAL	38950			446.7			1382.2

5 AND 100 YEAR SURFACE STORAGE VOLUMES

DRAINAGE AREA ID	TOTAL AREA (sq.m)	5 YEAR			100 YEAR		
		AREA (sq.m)	DEPTH (m)	VOLUME (cu.m)	AREA (sq.m)	DEPTH (m)	VOLUME (cu.m)
A501*	9430	9430	0.02	161.3	9430	0.041	392.1
A502	960	168	0.15	8	447	0.30	44.7
A503	670	123	0.15	6.1	480	0.30	48
A504	670	159	0.15	8	485	0.30	48.5
A505	670	186	0.15	9.3	449	0.30	44.9
A506	670	156	0.15	7.8	445	0.30	45.5
A507	1180	294	0.15	14.7	1021	0.30	102
A508	1790	386	0.15	19.3	890	0.2	59.3
A509	3530	466	0.15	23.3	466	0.15	23.3
TOTAL	19530			240			825.7

\* - BUILDING ROOFTOP STORAGE VOLUME ASSUMED WITH UNIFORM DEPTH ACROSS ENTIRE ROOF AREA.

Location	ORIFICE SUMMARY				
	Controlled Release	Outlet Pipe Dia.	Orifice Dia.	Hydrovex Model	Head on Hydrovex
STMMH 402	54.2	457	128	N/A	N/A
CB 44	62.0	254	154	N/A	N/A
<b>CBM 407</b>	<b>10.0</b>	<b>381</b>	<b>N/A</b>	<b>75-VHV-1</b>	<b>3.60</b>
<b>CBM 416</b>	<b>40.0</b>	<b>305</b>	<b>108</b>	<b>N/A</b>	<b>N/A</b>
<b>BUILDING 600</b>	<b>22.1</b>	<b>381</b>	<b>N/A</b>	<b>N/A</b>	<b>N/A</b>
<b>CBM 415</b>	<b>125.0</b>	<b>381</b>	<b>194</b>	<b>N/A</b>	<b>N/A</b>
<b>CBM411</b>	<b>40.0</b>	<b>457</b>	<b>108</b>	<b>N/A</b>	<b>N/A</b>
<b>CB 413</b>	<b>30.0</b>	<b>254</b>	<b>99</b>	<b>N/A</b>	<b>N/A</b>
<b>CB 419</b>	<b>100.0</b>	<b>305</b>	<b>171</b>	<b>N/A</b>	<b>N/A</b>
<b>BUILDING 500</b>	<b>37.6</b>	<b>381</b>	<b>N/A</b>	<b>N/A</b>	<b>N/A</b>

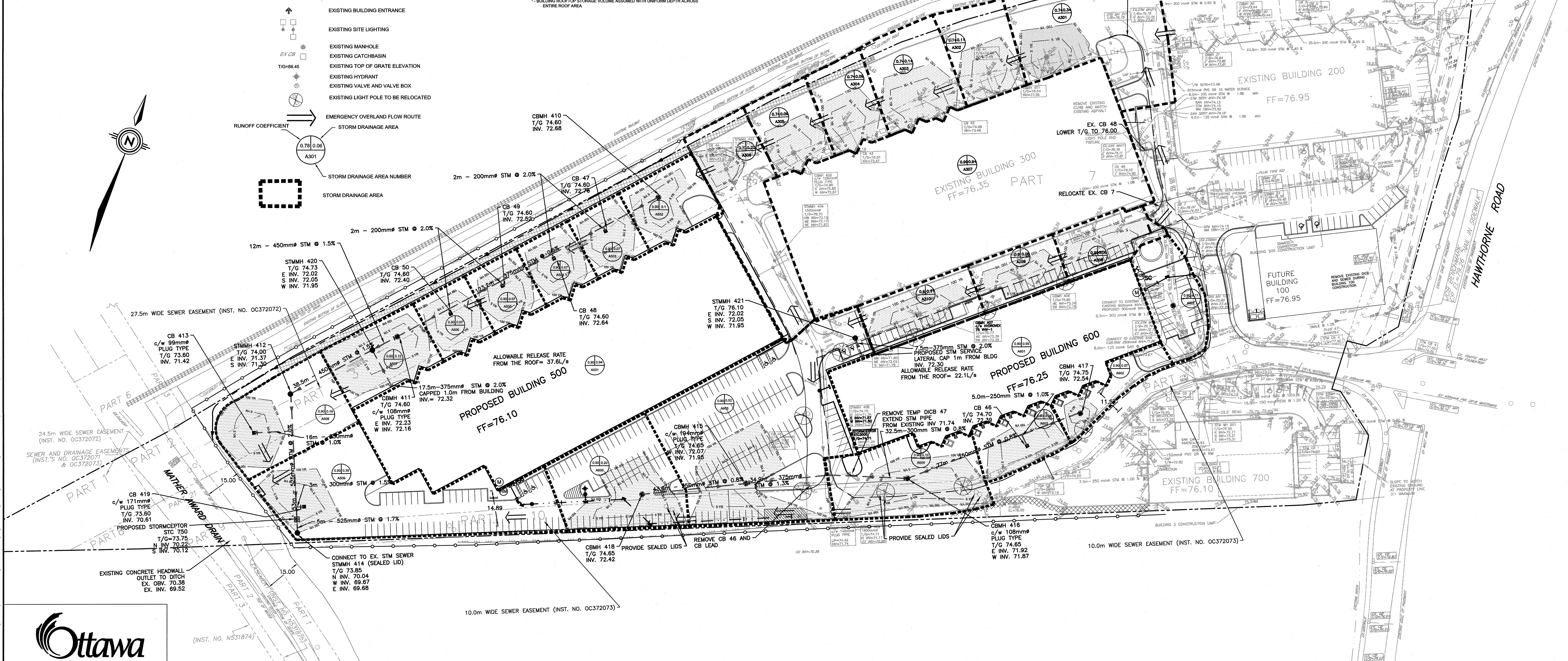

**Ottawa**

NOTES  
THE POSITION OF ALL POLE LINES, CONDUITS, WATERMANS, SEWERS AND OTHER UNDERGROUND AND OVERGROUND UTILITIES AND STRUCTURES IS NOT NECESSARILY SHOWN ON THE CONTRACT DRAWINGS, AND WHERE SHOWN, THE ACCURACY OF THE POSITION OF SUCH UTILITIES AND STRUCTURES IS NOT GUARANTEED. BEFORE STARTING WORK, DETERMINE THE EXACT LOCATION OF ALL SUCH UTILITIES AND STRUCTURES AND ASSUME ALL LIABILITY FOR DAMAGE TO THEM.

**PRELIMINARY**  
NOT FOR CONSTRUCTION

NO.	REVISION DESCRIPTION	DATE	BY	APPD
4	REVISED PER CITY COMMENTS	12/05/16	ML	AA
3	REVISED PER CITY COMMENTS	18/04/16	ML	AA
2	REVISED ISSUE FOR SITE PLAN APPROVAL BUILDING 500 & 600	11/12/15	ML	AA
1	ISSUED FOR SITE PLAN APPROVAL BUILDING 500 & 600	09/11/15	ML	AA

SCALE	
1:750	

1172321 ONTARIO INCORPORATED  
223 COLONNADE RD. S., OTTAWA  
K2E 7K3

exp Services Inc.  
1172321 ONTARIO INCORPORATED  
223 COLONNADE RD. S., OTTAWA  
K2E 7K3  
613-723-7490

exp

exp Services Inc.  
1172321 ONTARIO INCORPORATED  
223 COLONNADE RD. S., OTTAWA  
K2E 7K3  
613-723-7490

exp

exp Services Inc.  
1172321 ONTARIO INCORPORATED  
223 COLONNADE RD. S., OTTAWA  
K2E 7K3  
613-723-7490

exp

DESIGN	exp
DESIGN	exp
CHECKED	AA/ML
DRAWN	AA
PROJ. MAN	AA
APPROVED	AA

3020 HAWTHORNE ROAD  
BUILDING 500, 600  
CITY OF OTTAWA

**STORMWATER MANAGEMENT PLAN**

PROJ. NO.	224388
PROJ. NO.	224388
SURVEY	exp.
DATE	OCT 2015
DRAWING NO.	SWM1