

inches 1/8 0 1 2 3 4

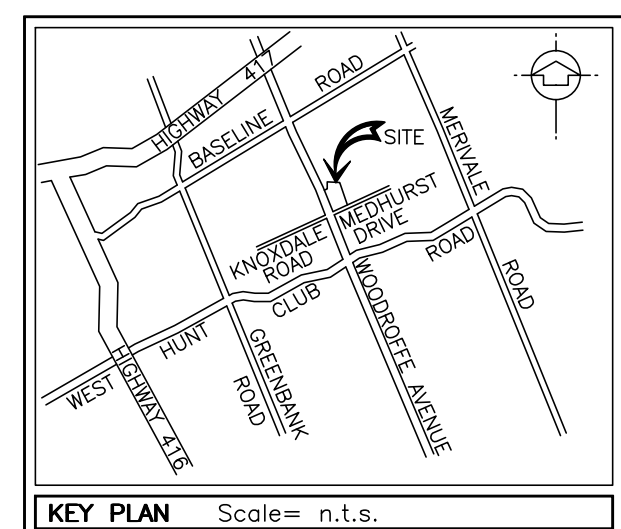

LEGAL DESCRIPTION
 PART OF LOT 30
 PART OF THE ROAD ALLOWANCE
 BETWEEN LOTS 30 & 31
 CONCESSION 1 (RIDEAU FRONT)
 CITY OF OTTAWA
 (GEOGRAPHIC TOWNSHIP OF NEPEAN)

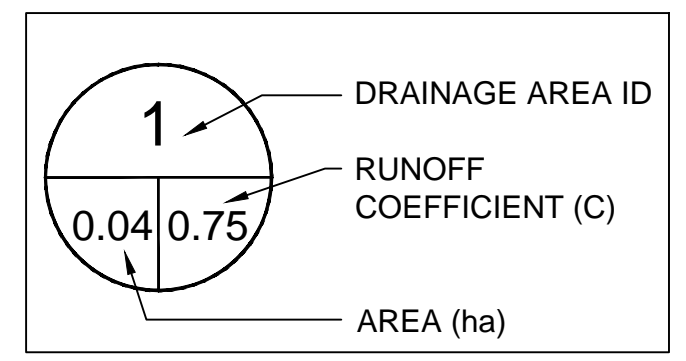

Imperial Oil **Esso** **Imperial**

FILE'S MARKETING
 ASSET MANAGEMENT - ENGINEERING SERVICES
 MARKETING DESIGN SERVICES
 DESIGN DIVISION - SANITARY ENGINEERING

90 WOODROFFE DRIVE
 TORONTO, ONTARIO
 M8C 1K5

Date	Revision
15 02 06	ISSUED FOR SITE PLAN APPROVAL
15 04 09	REVISED FOR COMMENTS
15 10 21	REVISED FOR COMMENTS
15 11 16	REVISED FOR COMMENTS

Project/Project	By
1345 WOODROFFE AVE. & MEDHURST DR OTTAWA, ONTARIO	TKK
Drainage Area Plan	TKK
Scale: (22x34") Echelle: 1:250	TKK
Scale: (11"x17") Echelle: 1:500	TKK
Date: 15 03 02	TKK
By/For: NR	TKK
PM/Sup: TKM	TKK
Schema Proposition: 01	TKK
Sheet/Fauille: 004	TKK
Rev. No./Rev: 3	TKK
PBL No. PBL 0000302287-03P	
SAP No. SAP 88001626-03P	

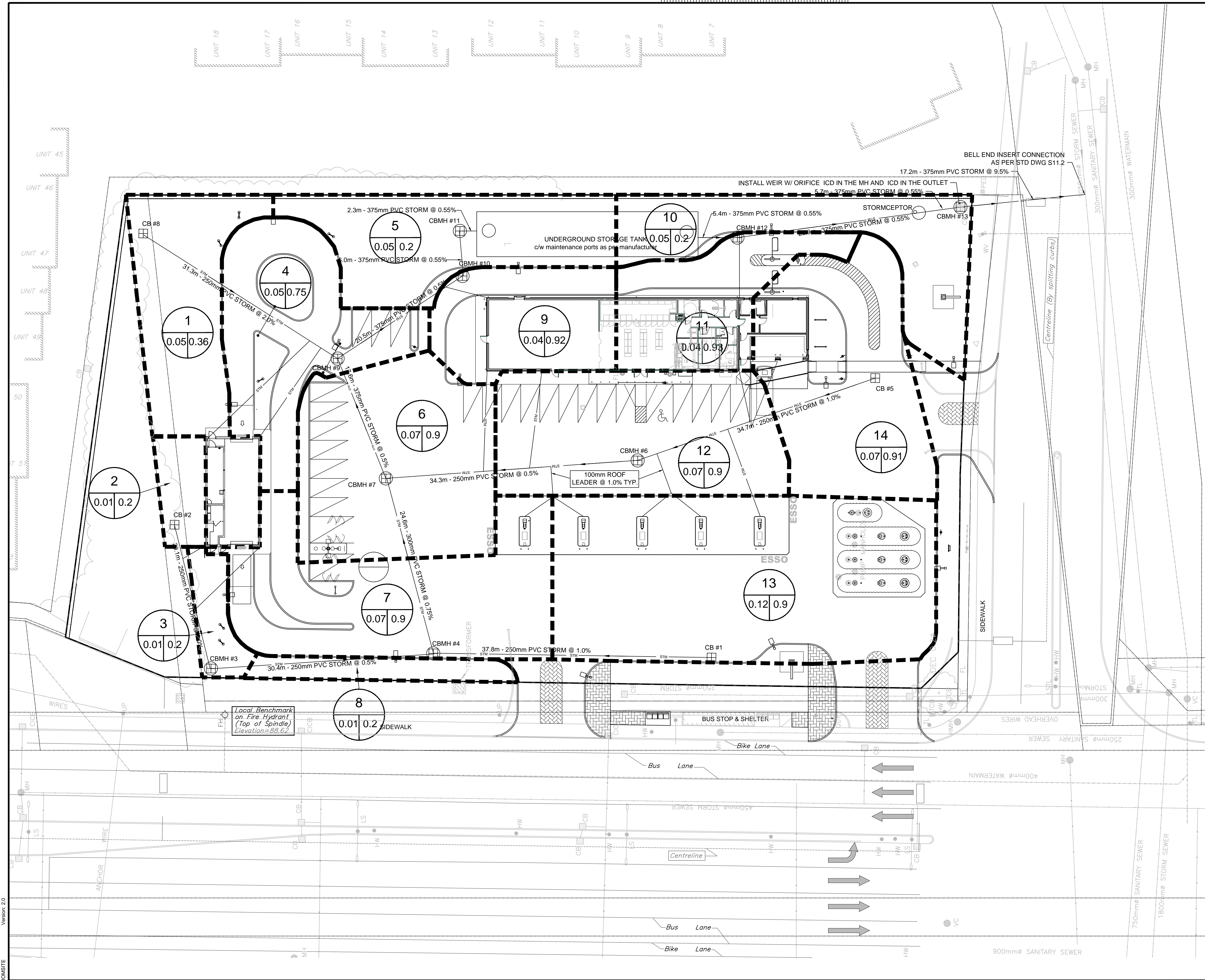

mm 0 1 2 3 4 5 6 7 8 9 10