

LEGEND

CIP CONCRETE PAVING

CIP CONCRETE PAVING  
COMMERCIAL PATIO

CIP CONCRETE PAVING  
COMMERCIAL PATIO

CIP CONCRETE PAVING  
COMMERCIAL PATIO

LAWN

PROPERTY LINE

BIKE PARKING

TACTILE  
WARNING  
STRIPS

GRASS MIX A

GRASS MIX B

PERENNIALS

SHRUB PLANTING

Rg

+

Ac

NEW TREE  
PLANTING

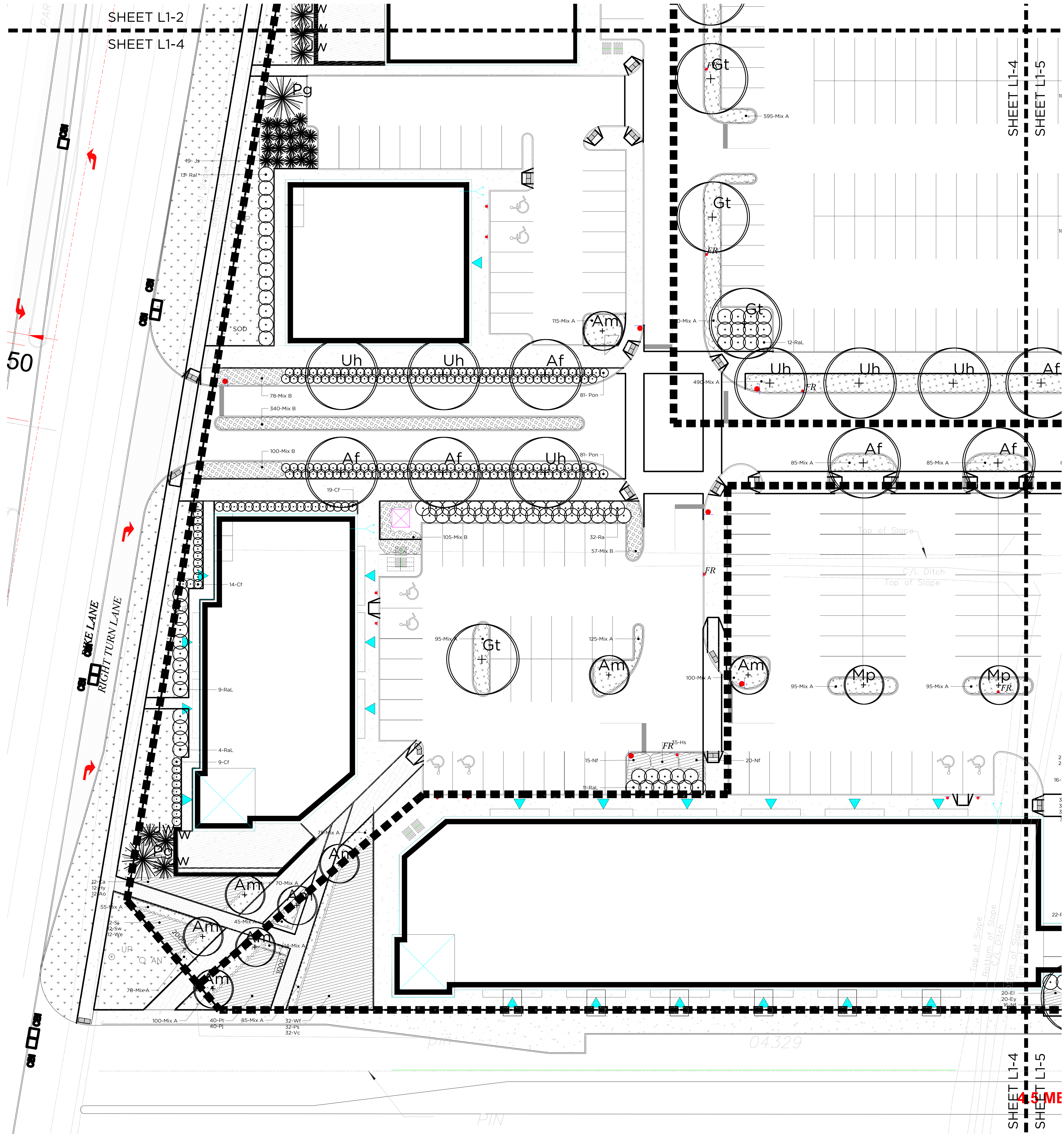

- GENERAL NOTES:
- The General Contractor shall verify all conditions in the field and report any discrepancies to the Landscape Architect prior to construction.
  - Any areas outside the limit of work damaged by the General Contractor shall be restored by the General Contractor to the satisfaction of the contract administrator at no additional cost to the Owner.
  - All underground utilities to be located by the General Contractor prior to the commencement of any work.
  - This drawing is a portion of a complete project and shall be read in conjunction with all other drawings, specifications and tender documents related to the project, regardless of origin.
  - All measurements in millimeters unless otherwise noted.
  - Do not scale drawing.

6	SUBMITTED FOR SPA	2016/03/12
5	REVISED FOR REVIEW	2016/08/28
4	REVISED FOR REVIEW	2016/08/15
3	REVISED AS PER COMMENTS	2014/08/19
2	SUBMITTED FOR SPA	2014/04/08
1	FOR REVIEW	2014/03/10

PROJECT / LOCATION / PROJECT / ENDNOT

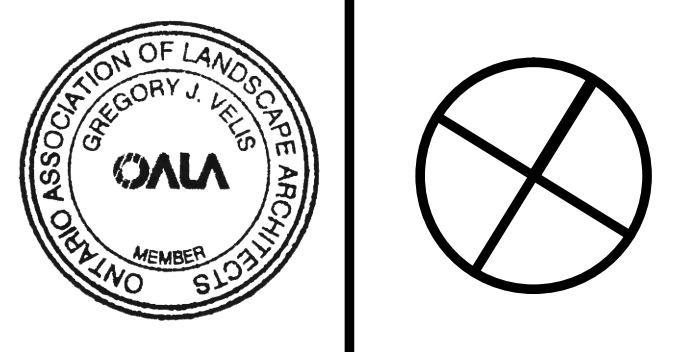

**RIVERSIDE SOUTH SHOPPING CENTRE**  
1420 EARL ARMSTRONG ROAD  
OTTAWA, ONTARIO

**LANDSCAPE PLAN  
PART PLAN**

DESIGNED BY / CONSULTANT L.M./G.V./E.P.	SHEET NO. / FEUILLE NO.
DRAWN BY / DESIGNED FOR L.M./G.V./E.P.	
CHECKED BY / VERIFIED FOR M.S.	
SCALE / ÉCHELLE 1:200	

**L1-4**