

HEADWALL AS PER GP50 804.030 WITH
 500 mm REINFORCED CONCRETE
 SPACING 300 mm PER 500 mm
 BOTH BANKS OF ROADSIDE DITCH
 8 m DOWNSTREAM OF 51M OUTLET

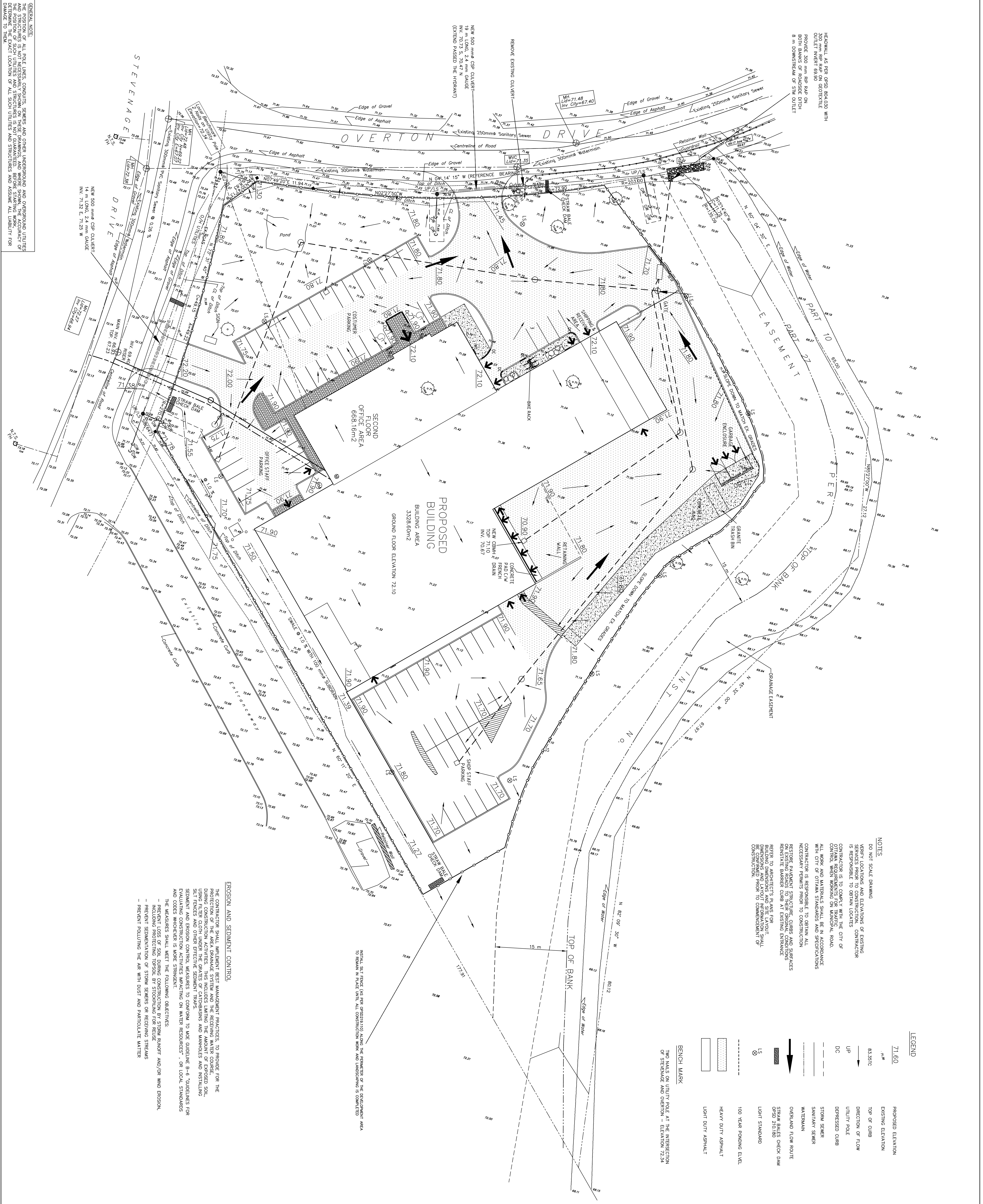

NOTES
 DO NOT SCALE DRAWING
 VERIFY LOCATIONS AND ELEVATIONS OF EXISTING SERVICES PRIOR TO CONSTRUCTION. CONTRACTOR IS RESPONSIBLE TO OBTAIN LOCATIONS
 CONTRACTOR IS TO COMPLY WITH THE CITY OF OTTAWA REQUIREMENTS FOR MUNICIPAL ROAD. ALL WORK AND MATERIALS SHALL BE IN ACCORDANCE WITH CITY OF OTTAWA STANDARDS AND SPECIFICATIONS
 CONTRACTOR IS RESPONSIBLE TO OBTAIN ALL NECESSARY PERMITS PRIOR TO CONSTRUCTION
 RESTORE EXISTING STRUCTURE CURBS AND SURFACES TO ORIGINAL CONDITIONS
 REINSTATE BARRIER CURB AT EXISTING ENTRANCE
 REFER TO ARCHITECT'S PLANS FOR BUILDING DIMENSIONS AND SITE LAYOUT
 CONTRACTOR SHALL BE RESPONSIBLE TO OBTAIN ALL NECESSARY PERMITS PRIOR TO COMMENCEMENT OF CONSTRUCTION.

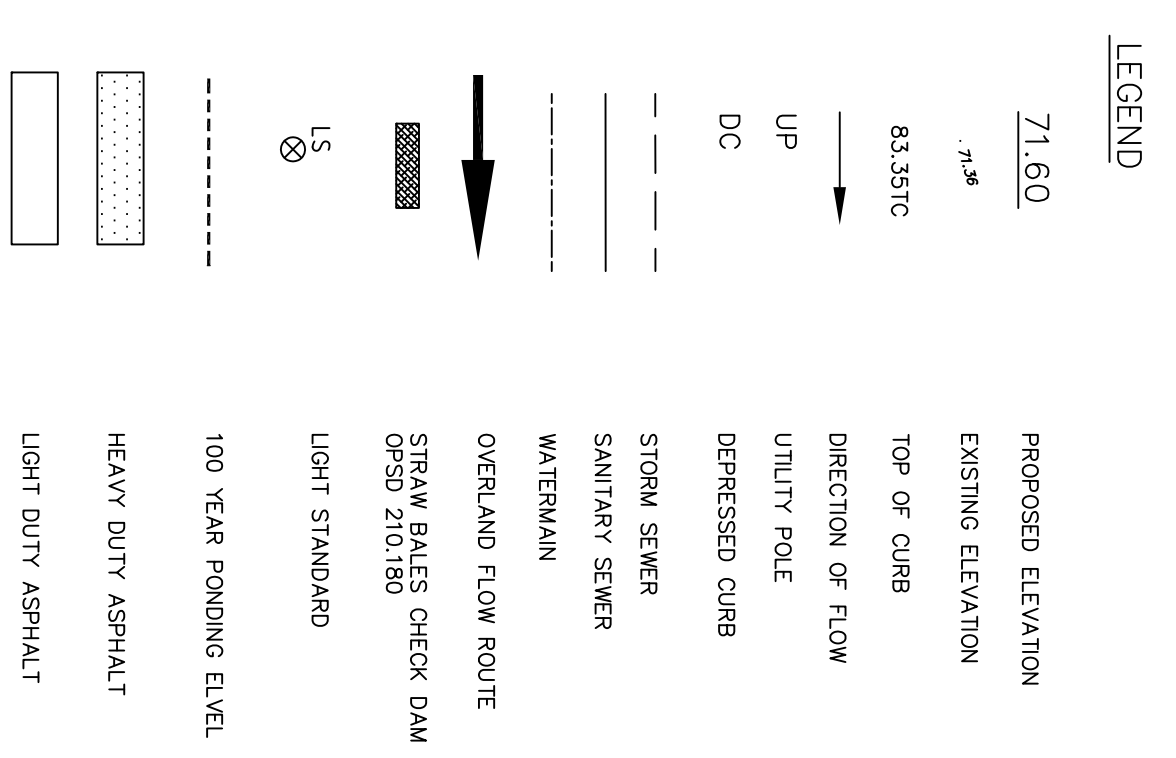

EROSION AND SEDIMENT CONTROL
 THE CONTRACTOR SHALL IMPLEMENT BEST MANAGEMENT PRACTICES, TO PROVIDE FOR THE PROTECTION OF THE AREA DRAINAGE SYSTEM AND THE RECEIVING WATER COURSE DURING CONSTRUCTION ACTIVITIES. THIS INCLUDES LIMITING THE AMOUNT OF EXPOSED SOIL, PREVENTING EROSION, PREVENTING SEDIMENTATION OF STORM SEWERS AND INSTALLING SILT FENCES AND OTHER EFFECTIVE SEDIMENT TRAPS.
 SEDIMENT AND EROSION CONTROL MEASURES TO CONFORM TO MFC GUIDELINE B-4 "GUIDELINES FOR EVALUATING CONSTRUCTION ACTIVITIES IMPACTING ON WATER RESOURCES" OR LOCAL STANDARDS AND CODES WHOEVER IS MORE STRINGENT.
 THE MEASURES SHALL MEET THE FOLLOWING OBJECTIVES:
 - PREVENT LOSS OF SOIL DURING CONSTRUCTION BY STORM RUNOFF AND/OR WIND EROSION.
 - PREVENT PROBLEMS CAUSED BY SEDIMENTATION FROM REDUCING THE CAPACITY OF STORM SEWERS OR RECEIVING STREAMS
 - PREVENT SEDIMENTATION OF STORM SEWERS OR RECEIVING STREAMS
 - PREVENT POLLUTING THE AIR WITH DUST AND PARTICULATE MATTER

INSTALL SILT FENCE (AS PER PROVISION) ALONG THE PERIMETER OF THE CONSTRUCTION AREA TO RETAIN IN PLACE UNTIL ALL CONSTRUCTION WORK AND LANDSCAPING IS COMPLETED

GENERAL NOTE:
 ALL POLE LINES, CONDUITS, SEWERS AND OTHER UNDERGROUND AND OVERGROUND UTILITIES AND STRUCTURES IS NOT NECESSARILY SHOWN ON THESE DRAWINGS, AND WHERE SHOWN THE ACCURACY OF THE POSITION OF SUCH UTILITIES AND STRUCTURES IS NOT GUARANTEED. THE CONTRACTOR SHALL VERIFY THE LOCATION OF ALL SUCH UTILITIES AND STRUCTURES AND ASSUME THE LIABILITY FOR DAMAGE TO THEM.

<p>Do not scale. Refer any dimensional errors and/or possible omissions to the project engineer. No responsibility for construction prior to commencement of the work. The conditions of the contract apply.</p> <p>SCALE - 1 : 300 DRAWN - ANDREW CHECKED - AN</p>	<p>DRAWING NO. 2717 PROJECT NO. 13-65 DRAWING NO. 13-65 REVISION NO. 1</p>	<p>Erosion and Sediment Control Plan</p>	<p>2717 Overton Drive Ottawa, Ontario</p>	<p>P & R P & R ARCHITECTS INC 575, 443 7th Street Ottawa, Ontario K1N 1G2 TEL: 613 724-5900 FAX: 613 724-1289 EMAIL: info@prarch.com WEBSITE: www.pandrichards.com</p>	<p>Capital Engineering Group Ltd Municipal / Land Development 110 Dowssett Way Ottawa, Ontario K1N 6G6 T: (613) 738-0776 F: (613) 738-7202 E: ce@cegroup.com</p>	<p>Survey By FARLEY, SMITH AND DENIS SURVEYING LTD. October 2012</p>	<p>PARTS OF LOTS 22 AND 23 CONCESSION 2 (OTTAWA FRONT) (PARTS OF LOTS 11 AND 27, PLAN SR-5187) GEOGRAPHIC TOWNSHIP OF GLOUCESTER CITY OF OTTAWA</p>
---	---	---	--	---	--	--	---