

PLANT MATERIAL SCHEDULE

CODE	BOTANICAL NAME	COMMON NAME	QTY.	SIZE	REMARKS
DECIDUOUS TREES					
AR	AZELA NANCY KAMAPENSIS	SHARBL OW SERVICEBERRY	3	50mm call	B&B single stem
AR	ACER RUBRUM RED SUNSET	RED SUNSET MAPLE	3	60mm call	B&B
CO	CELTIS OCCIDENTALIS	COMMON HACKBERRY	8	60mm call	B&B
OR	QUERCUS RUBRA	RED OAK	1	60mm call	B&B
CONIFEROUS TREES					
PG	PICEA GLAUCA	WHITE SPRUCE	6	180 cm Ht.	B&B
SHRUBS					
PM	PRUNUS MUGO MUGOLUS	MUGHO PINE	69	50cm Ht.	potted 100cm o/c
PM	PRUNUS CARPUS OPULIFOLIUS	COMMON VINEBARK	29	50cm Ht.	potted 100cm o/c
PM	PRUNUS SPINOSA	THORN BRamble	30	50cm Ht.	potted 100cm o/c
PM	ROSA CHARLES ALBANEL	CHARLES ALBANEL EXPLORER ROSE	33	50cm Ht.	potted 80cm o/c
PERENNIALS					
Eth	ECHINACEA pallida	PALE PURPLE CONEFLOWER	90	15 cm pot.	plant 50cm o/c
Ger	GERANIUM maculatum	WILD GERANIUM	35	15 cm pot.	plant 50cm o/c
Hem	HEMEROCALLIS cultivers	Sheila Dorn DAVILLY	40	15 cm pot.	plant 50cm o/c
Rud	RUDEBECKIA hirta	BROWN-EYED SUSAN	128	15 cm pot.	plant 50cm o/c
GRASSES					
Call	CALAMAGOSTIS x acutiflora	KARL FOSTER REED GRASS	28	15cm pot.	plant 75cm o/c
Spo	SPODOPODIUM heterophyllum	PRAIRIE DROSSSEED	20	15cm pot.	plant 75cm o/c

FUTURE DEVELOPMENT

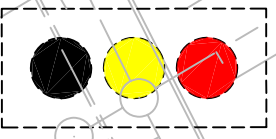
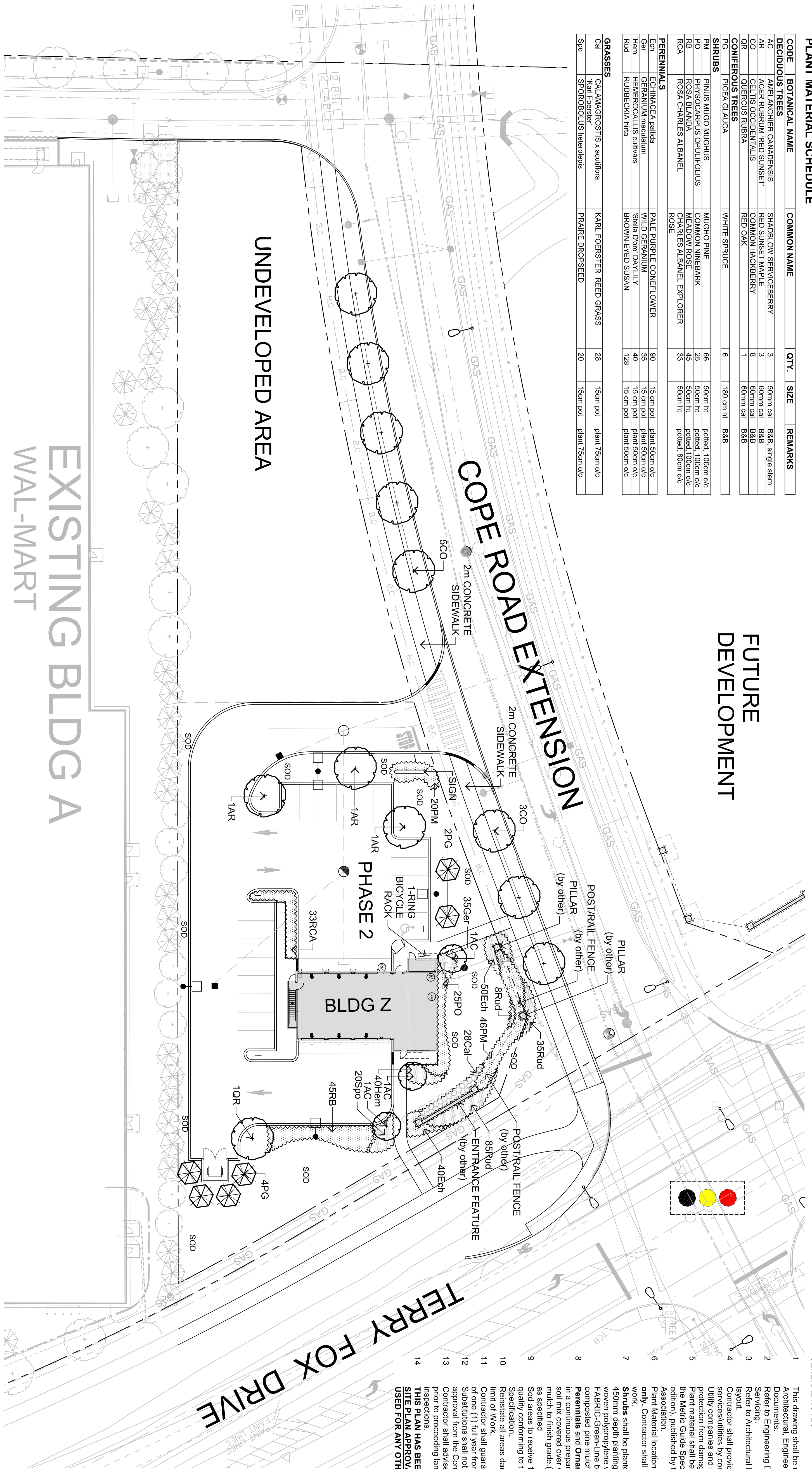

GENERAL NOTES

- This drawing shall be read in conjunction with all relevant Architectural, Engineering and related Drawings and Documents.
- Refer to Engineering Drawings for Grading and Surveying.
- Refer to Architectural Drawings (Site Plan) for Site Layout.
- Contractor shall provide the location(s) of all services/utilities by consulting Municipal Authorities and Utility companies and shall be responsible for adequate protection from damage during construction.
- Plant material shall be No. 1 Grade and shall comply with the Metric Guide Specifications For Nursery Stock (latest edition), published by the Canadian Nursery Trades Association.
- Plant Material locations are **Schematic / Approximate only**. Contractor shall stake out locations on site prior to work.
- Shrubs shall be planted in a continuous prepared bed of 450mm depth planting soil mix covered over with a woven polypropylene weed control fabric (LANDSCAPE FABRIC-Green-Line by Tri-tee-LIND) and 75mm depth Permalite pine mulch to finish grade, as specified.
- Perennials and Ornamental trees shall be planted in soil mix covered over with 75mm depth composted pine mulch to finish grade. **(NO WEED CONTROL FABRIC)**, as specified.
- Sod areas to receive 125mm topsoil. Sod shall be No. 1 quality conforming to the Canadian Nursery Sod Growers Specification.
- Restoration all areas damaged or disturbed beyond the limit of Work.
- Contractor shall guarantee all plant material for a period of one (1) full year from the date of final acceptance. Substitutions shall not be permitted without written approval from the consultant.
- Contractor shall advise Consultant a minimum of 48hrs. prior to proceeding landscape work and any required approvals.
- THIS PLAN HAS BEEN PREPARED FOR MUNICIPAL SITE PLAN APPROVAL ONLY AND MAY NOT BE USED FOR ANY OTHER PURPOSE.**

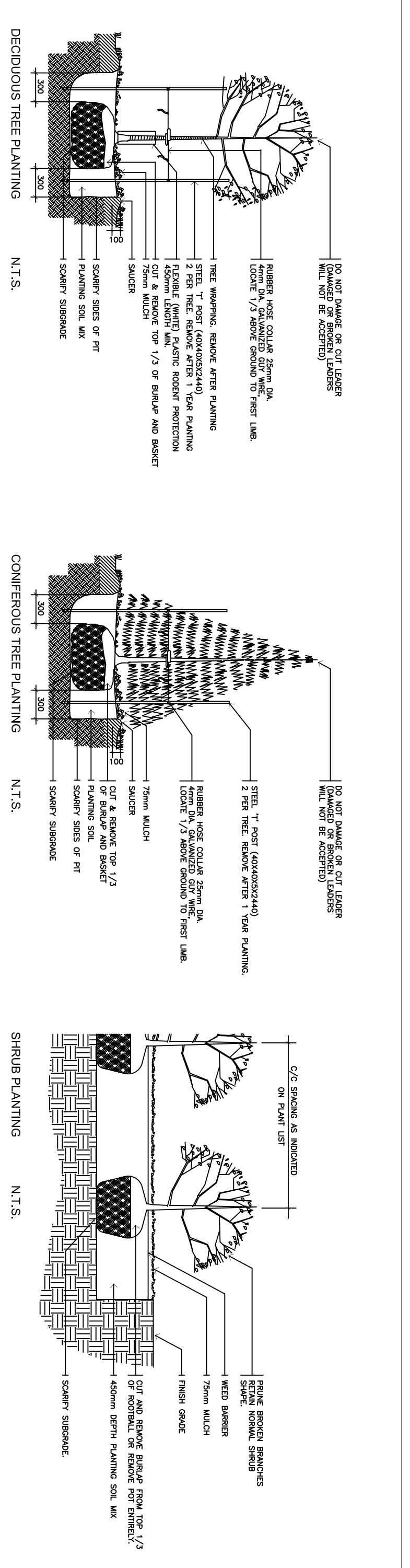

1.1.01 PLANTING DETAILS NTS

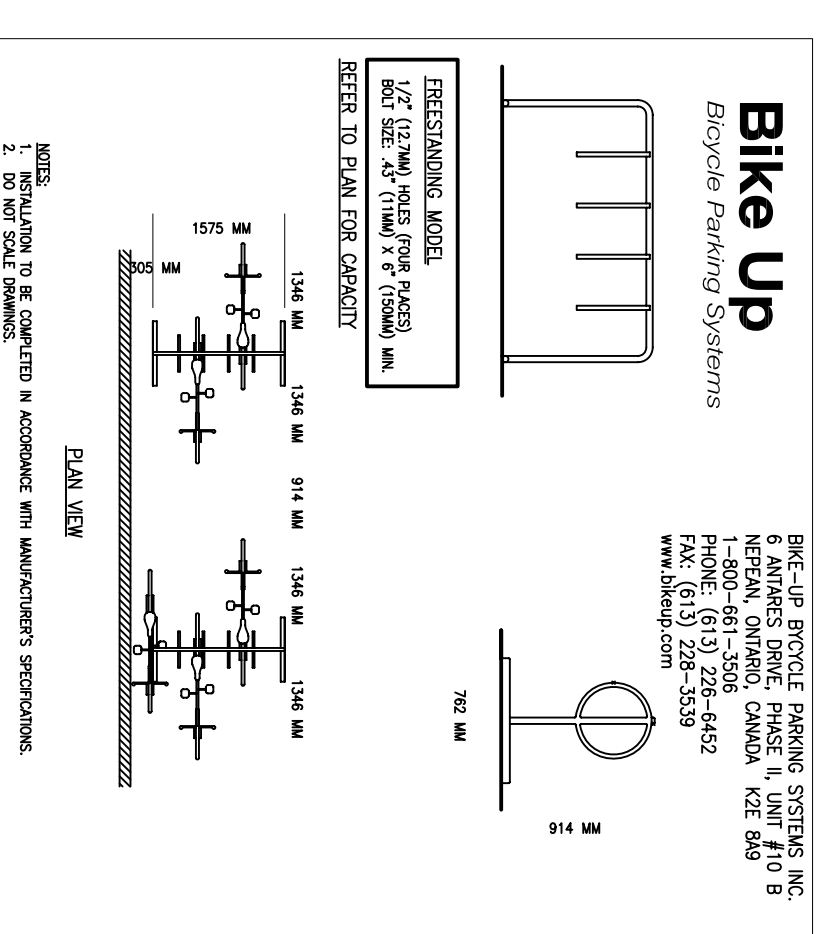

2.1.01 BICYCLE RACK DETAIL (TYPICAL) NTS

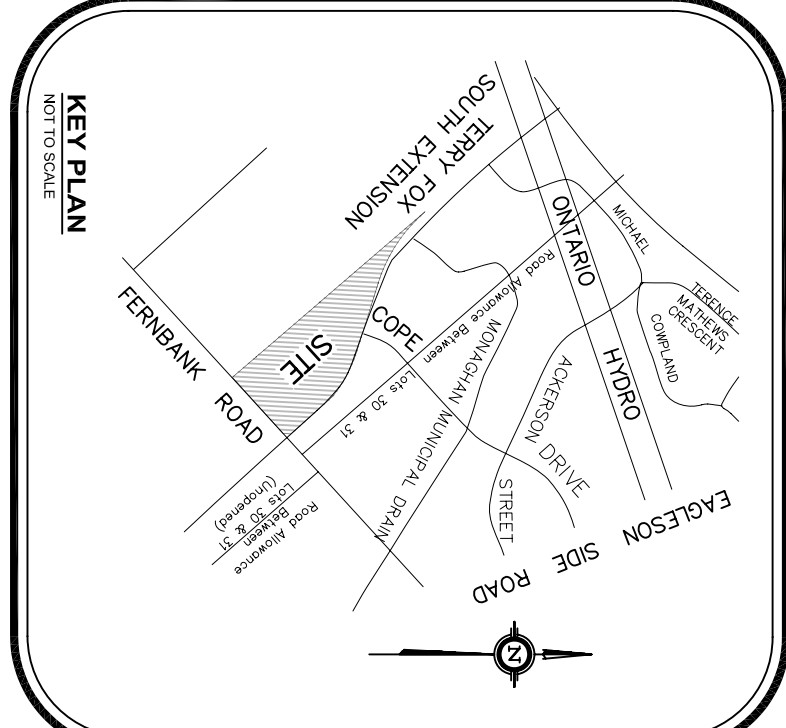

LEGEND

- Proposed Deciduous Tree
- Proposed Coniferous Tree
- Proposed Shrubs/ Groundcover

LEVSTEK CONSULTANTS
 LANDSCAPE ARCHITECTS
 5871 HUGH CRAWFORD DRIVE • GERRARD • R6A 2W6
 416-291-8888 • 905-881-8888

NOT FOR CONSTRUCTION

COMMERCIAL DEVELOPMENT
FERNBANK ROAD & TERRY FOX DRIVE
 700 APT. ENWOOD GREENS, VANQUAN ON L4K 5X3
 15000 SHEPPARD AVENUE EAST, UNIT 108
 VANCOUVER, BC V6N 1N1
 TEL: 604-273-8223

LANDSCAPE PLAN - PHASE 2 - BLDG. Z

DESIGNED BY: [Signature]
 CHECKED BY: [Signature]
 SCALE: 1:300
 DATE: JANUARY 2014

PROJECT NO: 978.4
 DRAWING NO: L1.01

ASSOCIATION OF LANDSCAPE ARCHITECTS OF BRITISH COLUMBIA