

**PLANT MATERIAL SCHEDULE**

CODE	BOTANICAL NAME	COMMON NAME	QTY.	SIZE	REMARKS
<b>DECIDUOUS TREES</b>					
AC	AMELANCHIER CANADENSIS	SHADBL OW SERVICEBERRY	3	50mm call	B&B single stem
AR	ACER RUBRUM	RED SUNSET MAPLE	3	60mm call	B&B
CO	CELTIS OCCIDENTALIS	COMMON HACKBERRY	3	60mm call	B&B
OR	QUERCUS RUBRA	RED OAK	1	60mm call	B&B
<b>CONIFEROUS TREES</b>					
PG	PICEA GALUCA	WHITE SPRUCE	6	180 cm ht	B&B
SHRUBS					
PM	PINUS MUGO MUGUS	MUGHO PINE	35	50cm ht	potted 100cm o/c
RD	PRUNUS SPINOSA	PRUNE BRAMBLES	40	50cm ht	potted 100cm o/c
RO	ROSA CHARLES ALBANEL	CHARLES ALBANEL EXPLORER	45	50cm ht	potted 80cm o/c
RCA	ROSA CHARLES ALBANEL	ROSE	31	50cm ht	potted 80cm o/c
<b>PERENNIALS</b>					
Ech	ECHINACEA pallida	PALE PURPLE CONEFLOWER	45	15 cm pot	plant 50cm o/c
Ger	GERANIUM maculatum	WILD GERANIUM	35	15 cm pot	plant 50cm o/c
Hem	HEMEROCALLIS callitars	Stella D'oro DAYLILY	85	15 cm pot	plant 50cm o/c
Rud	RUDBECKIA trim	BROWN-EYED SUSAN	110	15 cm pot	plant 50cm o/c
<b>GRASSES</b>					
Cal	CALAMAGROSTIS x acutiflora	KARL FOERSTER REED GRASS	50	15cm pot	plant 75cm o/c
Fas	FESTUCA amethystina 'Superta'	AMETHYST FESCUE	45	15cm pot	plant 50cm o/c
Spo	SPOROBOLOUS heterotrips	PRAIRIE DROPSEED	20	15cm pot	plant 75cm o/c

**FUTURE DEVELOPMENT**

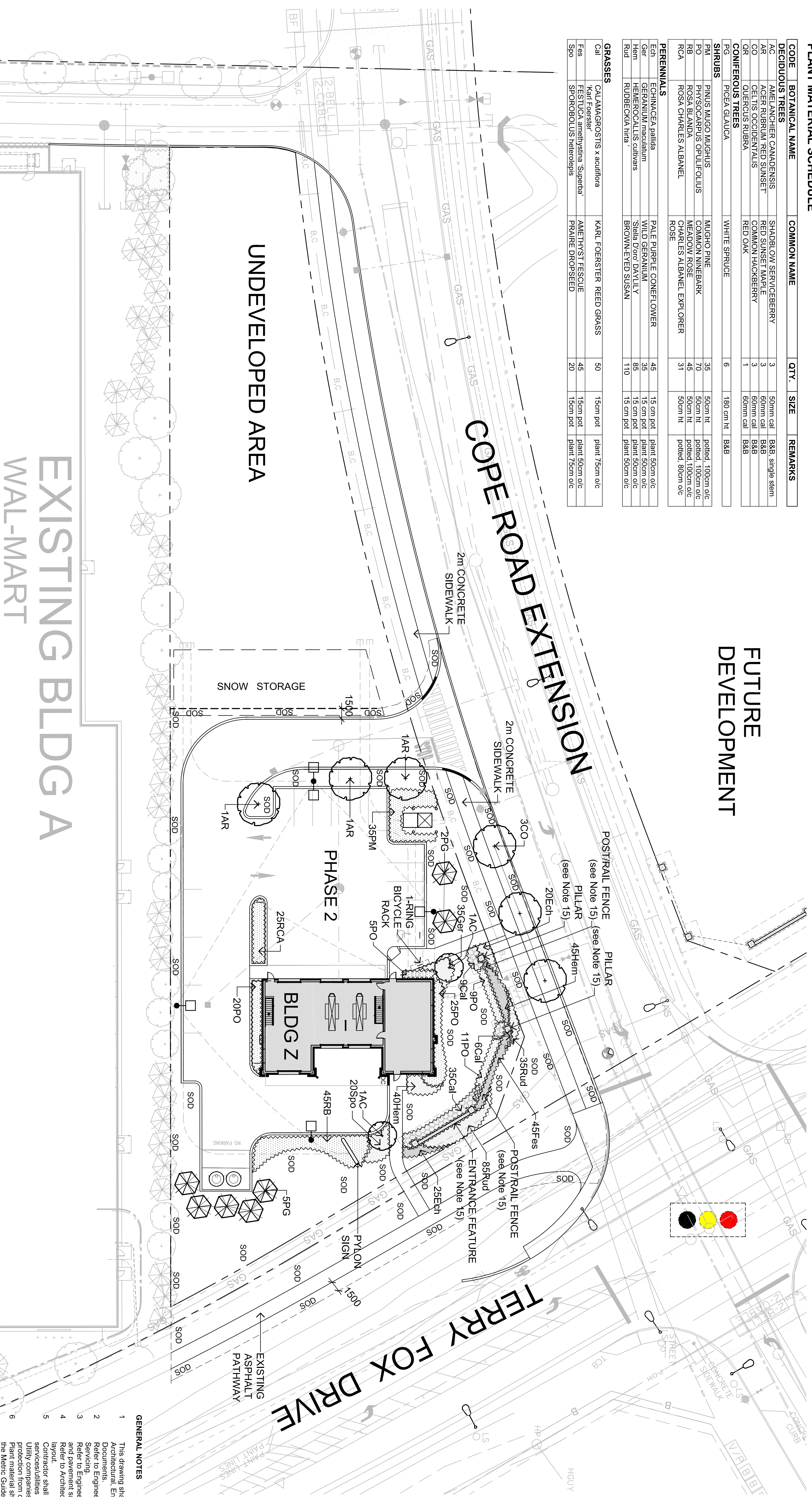

**EXISTING BLDG A  
WAL-MART**

**UNDEVELOPED AREA**

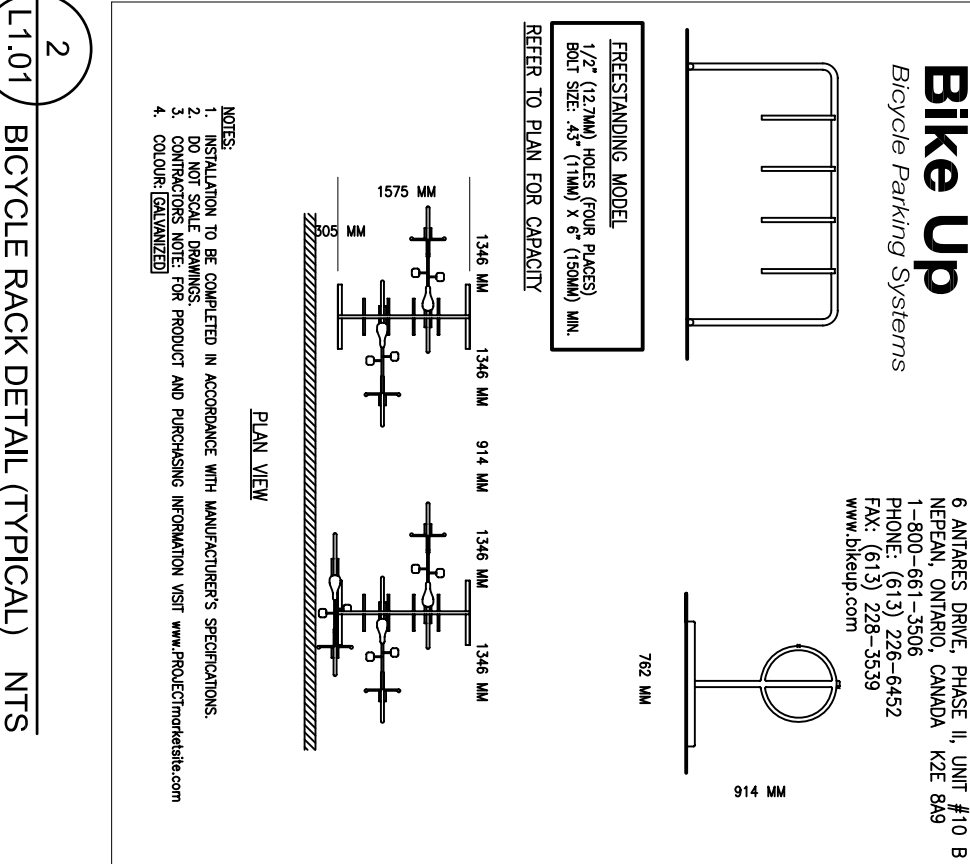
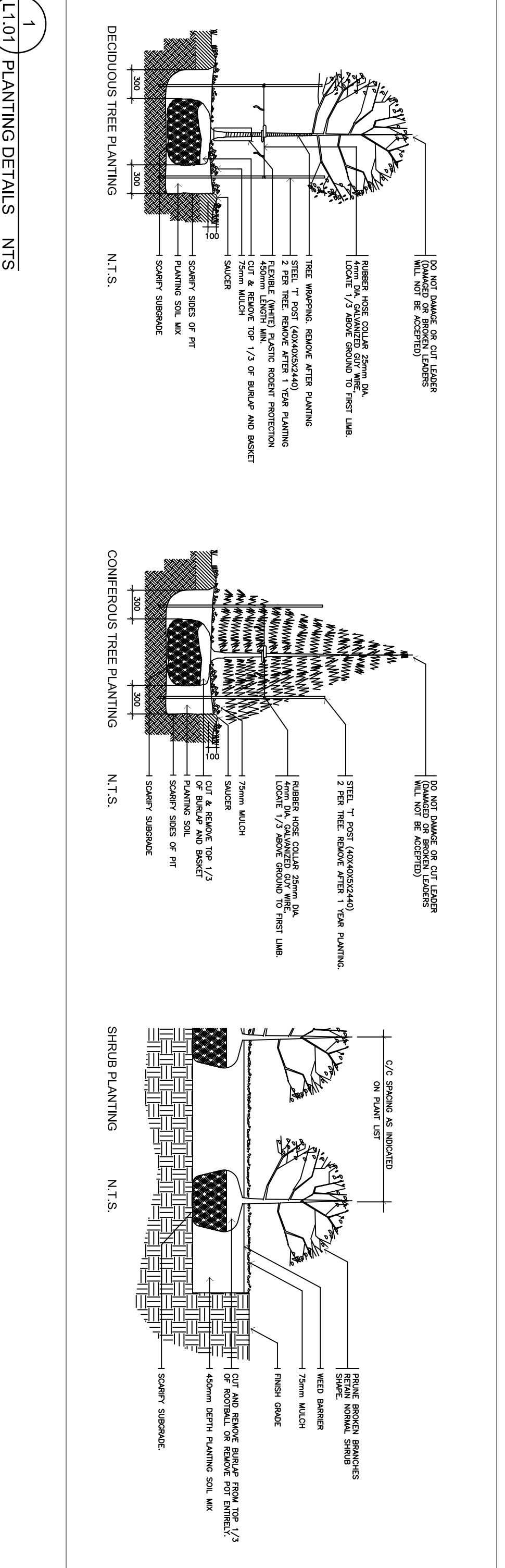

- GENERAL NOTES**
- This drawing shall be read in conjunction with all relevant Architectural, Engineering and related Drawings and Documents.
  - Refer to Engineering Drawings for Grading and Sectioning.
  - Refer to Engineering Drawings for pavement structures and pavement surfaces.
  - Refer to Architectural Drawings (Site Plan) for Site layout.
  - Contractor shall provide the location(s) of all services/utilities by consulting Municipal Authorities and Utility companies and shall be responsible for adequate protection from damage during construction.
  - Plant material shall be No. 1 Grade and shall comply with the Master Guide Specifications for Nursery Stock (latest edition) as published by the Canadian Nursery Trades Association.
  - Plant Material locations are Schematic / Approximate only. Contractor shall stake out locations on site prior to work.
  - Shrubs shall be planted in a continuous prepared bed of 75mm depth and 125mm width. The bed shall be lined with a woven polypropylene weed control fabric (LANDESCAPE FABRIC-Green-Line by Thence-LINO) and 75mm depth composted pine mulch to finish grade, as specified.
  - Perennials and Ornamental Grasses shall be planted in a continuous prepared bed of 450mm depth planting mulch to finish grade. (NO WEED CONTROL FABRIC) as specified.
  - Soil areas to receive 125mm topsoil. Seed shall be No. 1 quality conforming to the Canadian Nursery Sod Growers Specification.
  - Contractor shall guarantee all plant material for a period of one (1) full year from the date of final acceptance. Substitutions shall not be permitted without written approval from the Consultant.
  - Contractor shall plant a minimum of 48hrs prior to proceeding landscape work and any required inspections.
  - Gateway Feature Design and Layout - Refer to Drawings prepared by J.D. Fountain.
- THE FOLLOWING SPECIFICATION SECTIONS SHALL FORM PART OF THESE DOCUMENTS:**
- 31 22 19 TOPSOIL PLACEMENT AND GRADING OPERATION AND MAINTENANCE OF
  - 32 01 90 PLANTING
  - 32 37 00 EXTERIOR SITE FURNISHINGS
  - 32 82 23 SOILING AND SOIL PREPARATION
  - 32 93 10 TREES, SHRUBS AND GROUNDCOVER PLANTING
- SCHEDULE OF ITEMS**
- PART A**

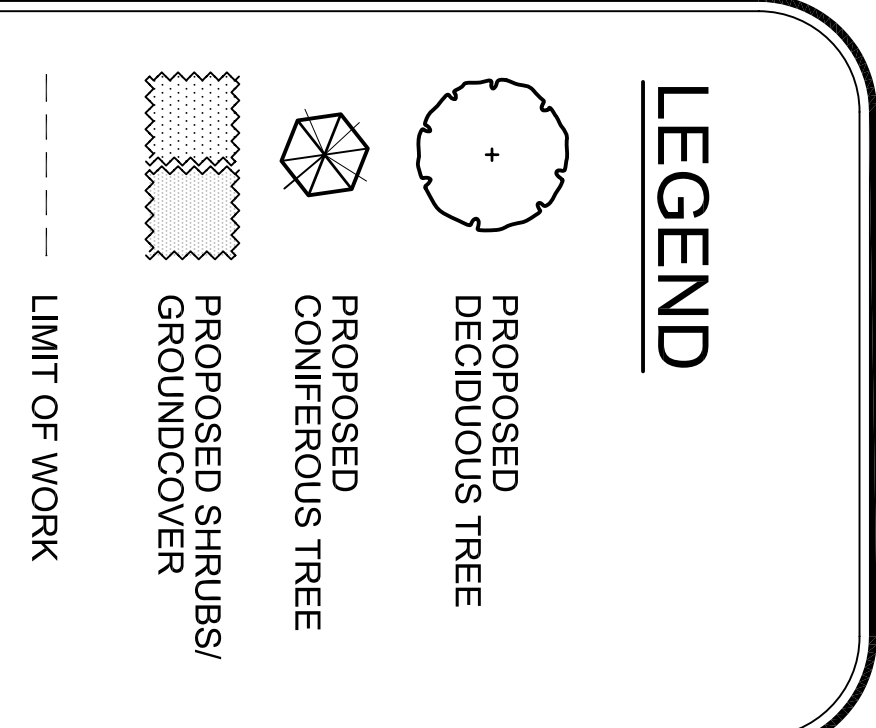
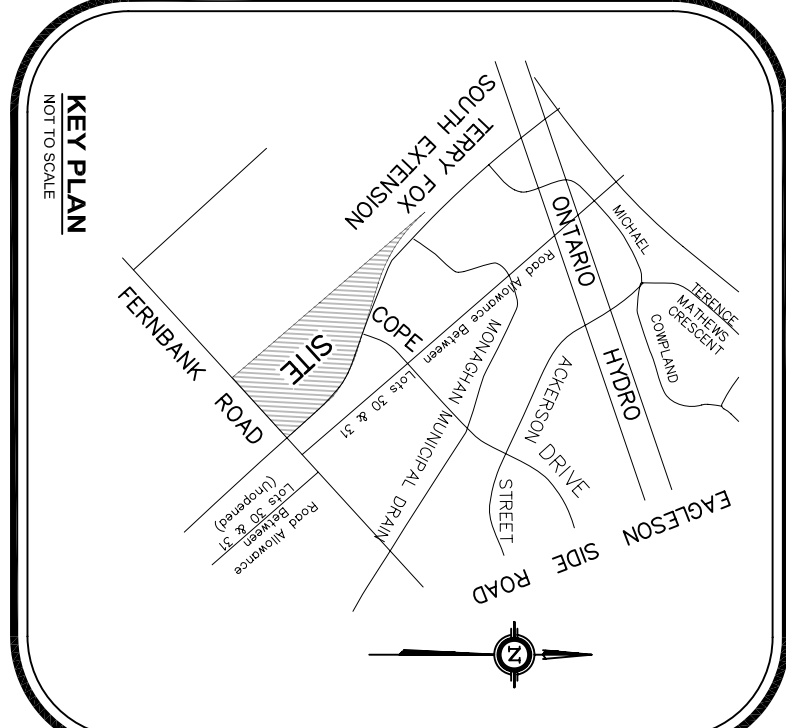

**LEVSTEK CONSULTANTS**  
 LANDSCAPE ARCHITECTS  
 5871 HUGH CREEK RD. UNIT 101  
 MISSISSAUGA, ONTARIO L4W 2V6  
 TEL: 905.876.8113 FAX: 905.876.8118

**NOT FOR CONSTRUCTION**

**COMMERCIAL DEVELOPMENT  
 FERRIBANK ROAD & TERRY FOX DRIVE  
 SMART CENTRES**

707 APT. EMMOD CRESENT, VANCOUVER, BC V6L 5C3  
 TEL: 604.276.0200 FAX: 604.276.0203

DESIGNED BY: [Signature]  
 CHECKED BY: [Signature]  
 SCALE: 1:300  
 DATE: JANUARY 2014

PROJECT NO: 978.4  
 DRAWING NO: L1.01