

PROPOSED ADDITION
 OTTAWA ISLAMIC SCHOOL
 10 CORAL AVE.
 OTTAWA, ONT.
 K2E 5Z6

(613) 727-5066 Ext. 21
 www.ottawaislamicschool.org

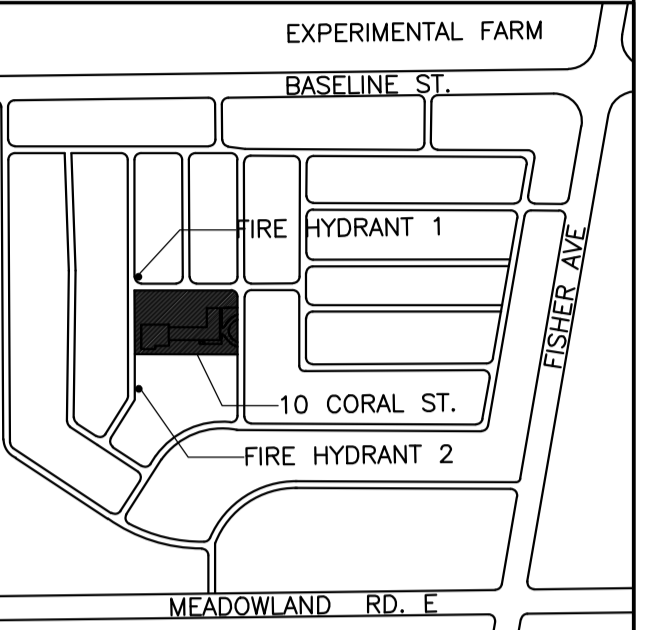

LOCATION PLAN
 NTS

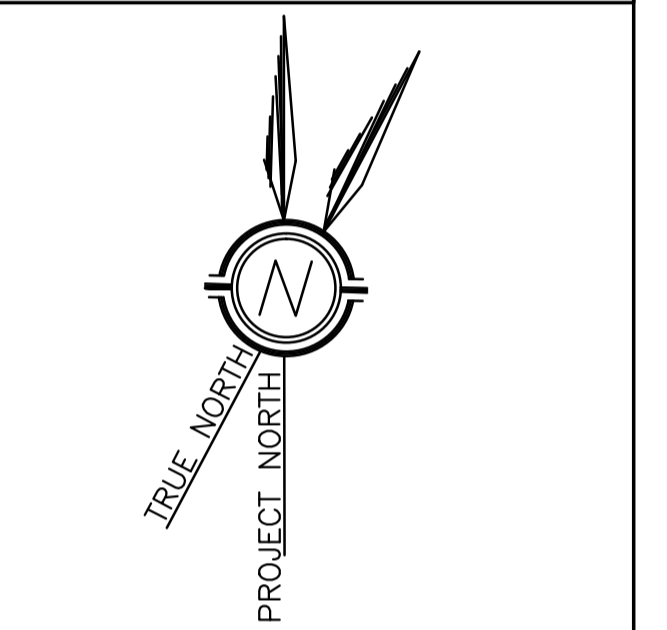

SCALE:
 1 5 10 15

CIVIL ENGINEER
 T.L. MAK ENGINEERING CONSULTANTS LTD.
 1455 YOUVILLE DR.
 OTTAWA, ONTARIO
 K1C 6Z7
 613-837-5516

GEOTECHNICAL
 HOULE CHEVRIER ENGINEERING LTD.
 180 WESCAR LANE
 OTTAWA, ONTARIO
 K0A 1L0
 613-836-1422

LANDSCAPE ARCHITECT
 JAMES B LENNOX & ASSOCIATES INC.
 1419 CARLING AVE.
 OTTAWA, ONTARIO
 K1Z 7L6
 613-722-5168

SURVEYOR
 FARLEY, SMITH & DENIS SURVEYOR LTD.
 190 COLONNADE RD.
 OTTAWA, ONTARIO
 613-727-8226

SUSAN D. SMITH ARCHITECT
 1114 GLADSTONE AVE
 OTTAWA, ONTARIO
 K1Y 3H5
 613-722-5327
 sds@magma.ca

| | | |
|-----|------------------------------|---------------|
| 6 | | |
| 5 | | |
| 4 | REISSUED FOR S. PLAN CONTROL | MAR. 21/2014 |
| 3 | ISSUED FOR SITE PLAN CONTROL | NOV. 29/2013 |
| 2 | ISSUED FOR REVIEW | SEPT. 16/2013 |
| 1 | ISSUED FOR PRESENTATION | JULY 20/2013 |
| No. | REVISION | DATE |

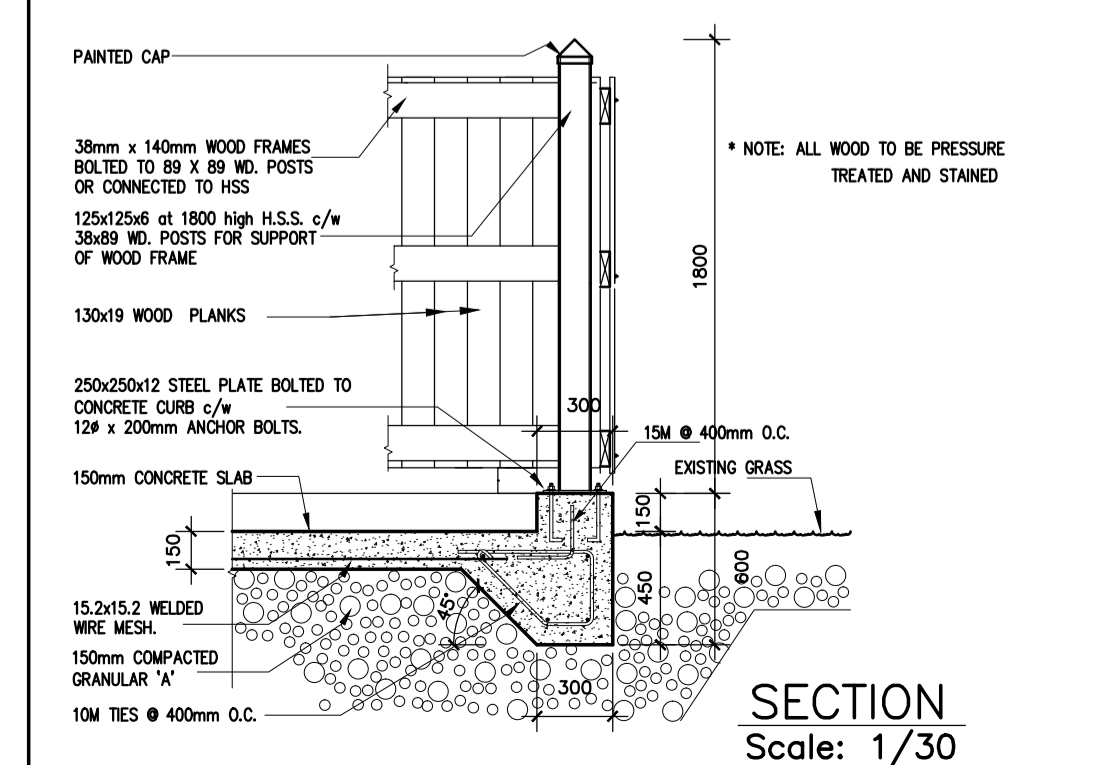
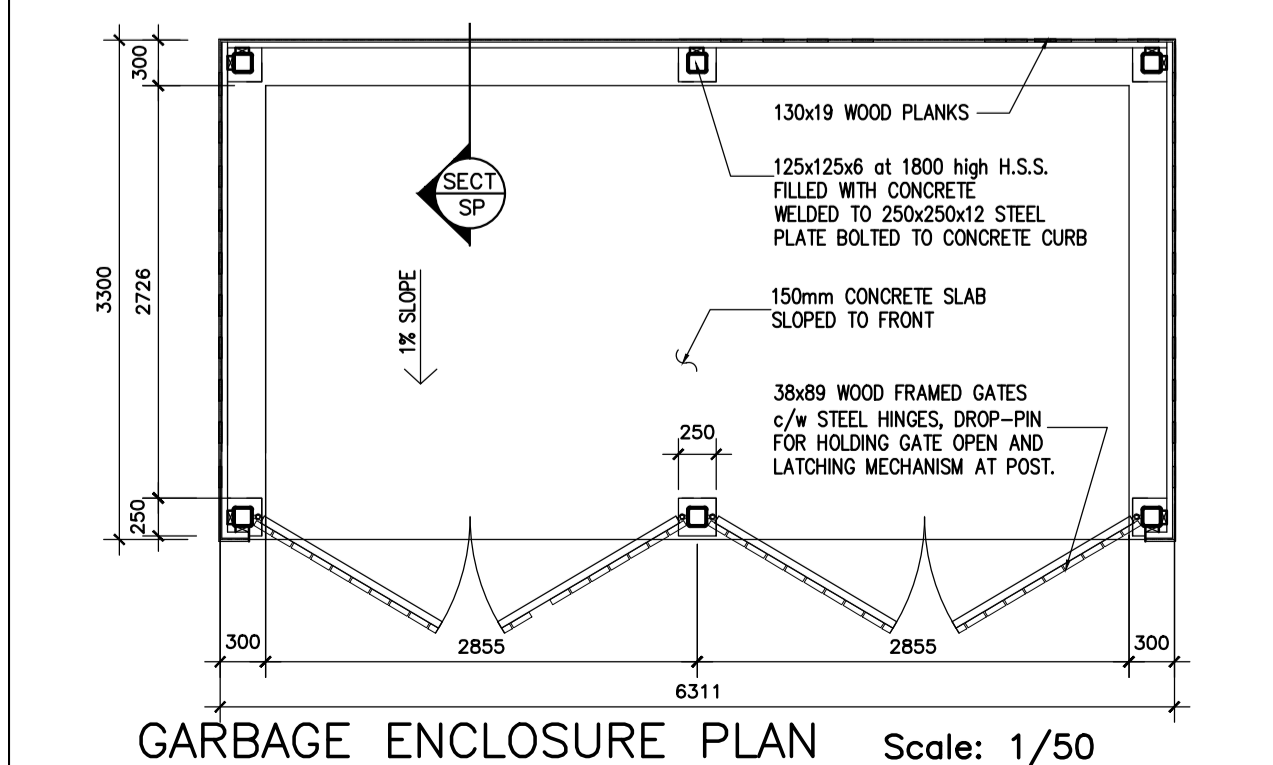
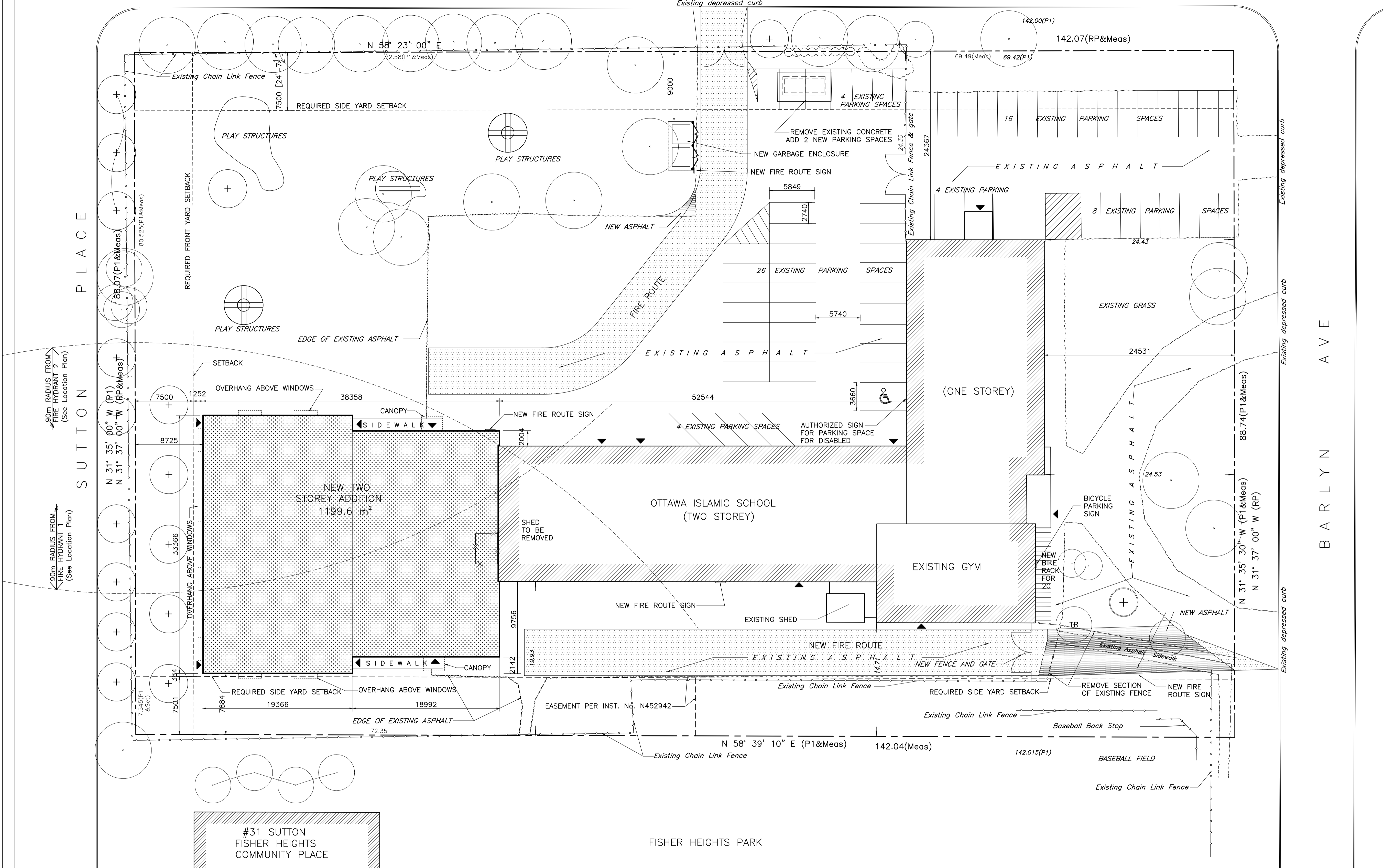

PROPERTY DESCRIPTION:
 LEGAL DESCRIPTION: PART OF BLOCK A (Being PART OF 2, 3 & 4 PLAN SR-11668) REGISTER PLAN: 310509 - CITY OF OTTAWA Based on survey plan prepared by Farley, Smith & Denis Surveying Ltd. 2009

DEVELOPMENT DATA:
 Site Zoning Designation: 11A (Table 170A -AREA C Schedule 1)
 Site area: 12558.8 sqm/3.1acre
 Frontage as per survey: 88.07 m.
 Depth as per survey: 142.04 m.
 Proposed permitted uses: Addition of Gym room and classrooms
 Existing Building (Footprint): 1791 m²
 Existing Gross (GFA) : 2674 m²
 New addition (Footprint) : 1199.6 m²
 Gross Addition (GFA) : 1767.1 m² (39.8% of entire building)
 New Gross area (GFA) : 4441.1 m²
 Entire building Footprint : 2990.6 m² (23.8% lot cover)
 Area of parking lot : 4383.44 sq.m. (35%)
 Area of landscaping : 4994.77 sq.m. (40%)

| Zoning Mechanism | Required | Provided |
|--|-------------------|-----------------------|
| Minimum Lot Width | 15m | 88.07m |
| Minimum Lot Area | 400m ² | 12558.8m ² |
| Maximum Lot Coverage | 35% | 23.8% |
| Minimum Front Yard Setback | 7.5m | 8.7m |
| Minimum Rear Yard Setback | 7.5m | 24.5m |
| Minimum Interior Side Setback | 7.5m | 7.9m |
| Minimum Corner Side Setback | 4.5m | 34.5m |
| Maximum Building Height (abutting on R1) | 11m | 10.1m |
| Parking Rate | Required | Provided |
| Grades 9-12 (8 at 3/classroom) | 53 spaces | 60 spaces |
| All Other Grades (19 at 1.5/classroom) | | |
| Bicycle Parking (1/100m ² gross floor area) | 19 spaces | 20 spaces |

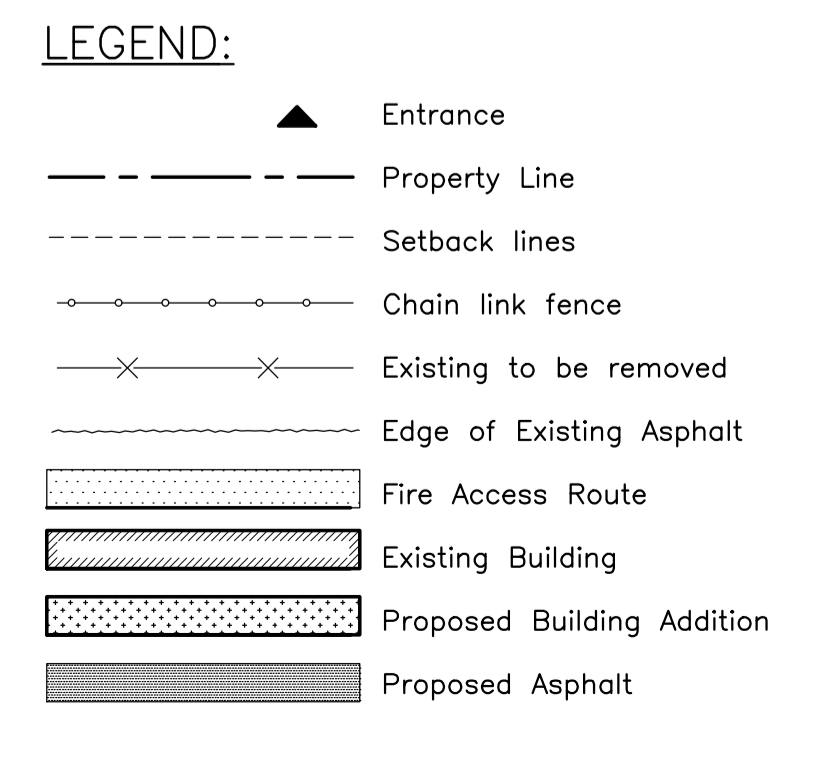

NOTES:
 1. All dimensions are to be checked on site. Discrepancies or ambiguities should be reported prior to work on site or ordering of materials.
 2. All work to be in accordance with the Ontario Building Code, latest edition.

SITE PLAN

SCALE: 1:250

Drawn TD
 Checked SDS
 Date JUNE 11/2013
 JOB # 1309

SP