

SUBJECT TO THE CONDITIONS, IF ANY, SET FORTH IN OUR LETTER DATED _____

THIS DRAFT PLAN IS APPROVED BY THE CITY OF OTTAWA UNDER SECTION 51 OF THE PLANNING ACT, THIS _____ DAY OF _____

FELICE PETTI, MANAGER
DEVELOPMENT REVIEW, SUBURBAN SERVICES
PLANNING AND GROWTH MANAGEMENT DEPARTMENT
PLANNING AND INFRASTRUCTURE PORTFOLIO
CITY OF OTTAWA

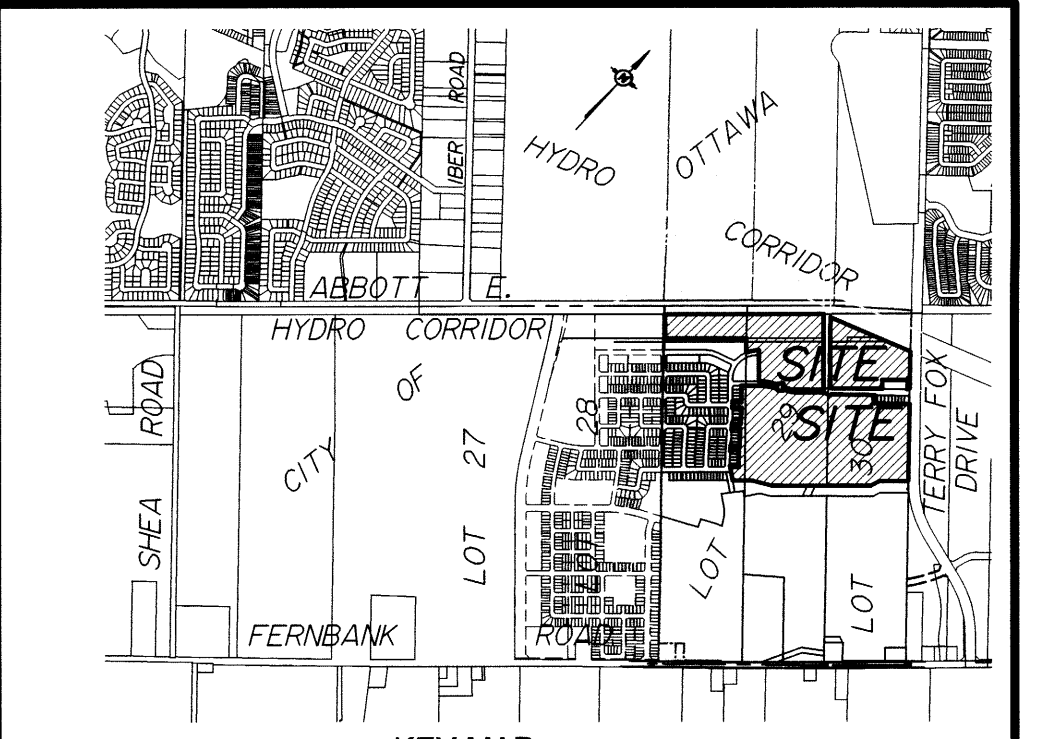

DRAFT PLAN OF SUBDIVISION OF PART OF LOTS 29 And 30 CONCESSION 10
Geographic Township of Goulbourn
CITY OF OTTAWA
Prepared by Annis, O'Sullivan, Vollebek Ltd.
NOVEMBER 28, 2011
(See Revision Schedule)

Scale 1: 2000
0 20 40 60 80 Metres

Metric
DISTANCES SHOWN ON THIS PLAN ARE IN METRES AND CAN BE CONVERTED TO FEET BY DIVIDING BY 0.3048

SURVEYOR'S CERTIFICATE

I CERTIFY THAT:
The boundaries of the lands to be subdivided and their relationship to adjoining lands have been accurately and correctly shown.

July 9th 2013 Edward M. Lancaster
Ontario Land Surveyor

OWNER'S CERTIFICATE

This is to certify that I am the owner of the lands to be subdivided and that this plan was prepared in accordance with my instructions.

July 9th 2013 Rob Pierce
2129786 Ontario Limited
I have the authority to bind the corporation.

ADDITIONAL INFORMATION REQUIRED UNDER SECTION 51-17 OF THE PLANNING ACT

- (a) see plan
- (b) see plan
- (c) see plan
- (d) residential housing, storm water management, parkland and open space.
- (e) see plan
- (f) see plan
- (g) see plan
- (h) City of Ottawa
- (i) see soils report
- (j) see plan
- (k) sanitary, storm sewers, municipal water, bell, hydro, cable and gas to be available
- (l) see plan

REVISION SCHEDULE

DATE	REVISION
NOVEMBER 28, 2011	PLAN PREPARED
May 25, 2012	PLAN REVISED
August 15, 2012	PLAN REVISED
November 29, 2012	PLAN REVISED
January 8, 2013	PLAN REVISED
January 15, 2013	PLAN REVISED
February 28, 2013	PLAN REVISED
March 1, 2013	PLAN REVISED
March 18, 2013	PLAN REVISED
March 21, 2013	PLAN REVISED
March 27, 2013	PLAN REVISED
April 29, 2013	PLAN REVISED
MAY 7, 2013	STREET NO. 10 REVISED
MAY 8, 2013	LOTS 137-146 REVISED
JULY 8, 2013	LOTS & BLOCKS REVISED PER M-PLAN

TABLE TO ILLUSTRATE BOUNDARY DATA

BOUNDARY LINE	DATA
1	N 13°32'40" E 6.27
2	N 52°21'10" E 18.00
3	N 37°38'50" W 12.57
4	R=200.00 A=C=0.27 N 37°41'10" W 33.83
5	N 63°59'20" E 118.43
6	N 48°53'50" E 118.43
7	N 86°51'10" W 7.12
8	N 48°53'50" E 191.02
9	N 48°53'50" E 2.64
10	N 3°54'50" E 7.07
11	N 41°56'10" W 27.00
12	N 3°28'50" E 7.02
13	N 48°53'50" E 164.02
14	N 3°28'50" E 7.02
15	N 73°31'20" E 28.80
16	N 48°53'50" E 119.90
17	N 63°59'20" E 32.81
18	R=200.00 A=C=3.97 N 41°14'10" W 18.00
19	N 48°11'40" E 18.00
20	N 78°12'20" W 7.98
21	N 64°44'20" E 29.12
22	R=100.00 A=29.36 C=29.25 N 56°19'40" E 78.10
23	N 47°55'10" E 78.10
24	N 42°04'50" W 64.00
25	N 47°55'10" E 27.00
26	N 87°04'50" W 7.07
27	N 42°04'50" W 28.00
28	N 2°55'10" E 7.07
29	N 47°55'10" E 27.00
30	N 42°04'50" W 28.88
31	N 38°39'00" W 35.18
32	N 47°55'10" E 27.06
33	N 85°22'00" W 6.86
34	N 38°39'00" W 28.03
35	N 47°55'10" E 7.28
36	N 47°55'10" E 27.06
37	N 38°39'00" W 64.11
38	N 47°55'10" E 27.06
39	N 85°22'00" W 6.86
40	N 38°39'00" W 28.03
41	N 4°38'00" E 7.08
42	N 47°55'10" E 27.06
43	N 38°39'00" W 39.06
44	N 43°58'00" W 25.02
45	N 47°55'10" E 27.45
46	N 89°42'50" E 7.46
47	R=100.00 A=C=9.71 N 49°50'20" W 46.13
48	N 52°37'20" W 46.13



ANNIS, O'SULLIVAN, VOLLEBEK LTD.
14 Concourse Gate, Suite 500
Nepean, Ont. K2E 7S6
Phone: (613) 727-8850 / Fax: (613) 727-1079
Email: info@anniso.com

