

TRIM ROAD PARK AND RIDE

SOUTH FRONTAGE DRIVE (PRIVATE)

SOUTH FRONTAGE DRIVE (PRIVATE)

DAIRY DRIVE

- LEGEND**
- PROPERTY LINE
 - - - PROPOSED PROPERTY LINE
 - BUILDING SETBACK
 - - - DEPRESSED CURB
 - CULVERT
 - EX. HYD
 - HYD
 - PROPOSED HYDRANT
 - PROPOSED SIAMESE CONNECTION
 - LIGHT STANDARD
 - PROPOSED LIGHT STANDARD
 - LIGHT STANDARD TO BE RELOCATED
 - CATCH BASIN
 - CATCH BASIN IN DITCH
 - FENCE
 - SLIDING GATE
 - BUILDING ENTRANCE
 - DIRECTIONAL TRAFFIC ARROWS
 - CONCRETE SIDEWALK
 - UNIT PAVEMENT (CONCRETE BASE)
 - UNIT PAVEMENT (CONCRETE PAVING)
 - TURF STONE
 - EXCESS GRAVEL PARKING
 - MOLOK UNIT
 - TRANSFORMER PAT
 - FIRE ROUTE
 - ROAD SIGN

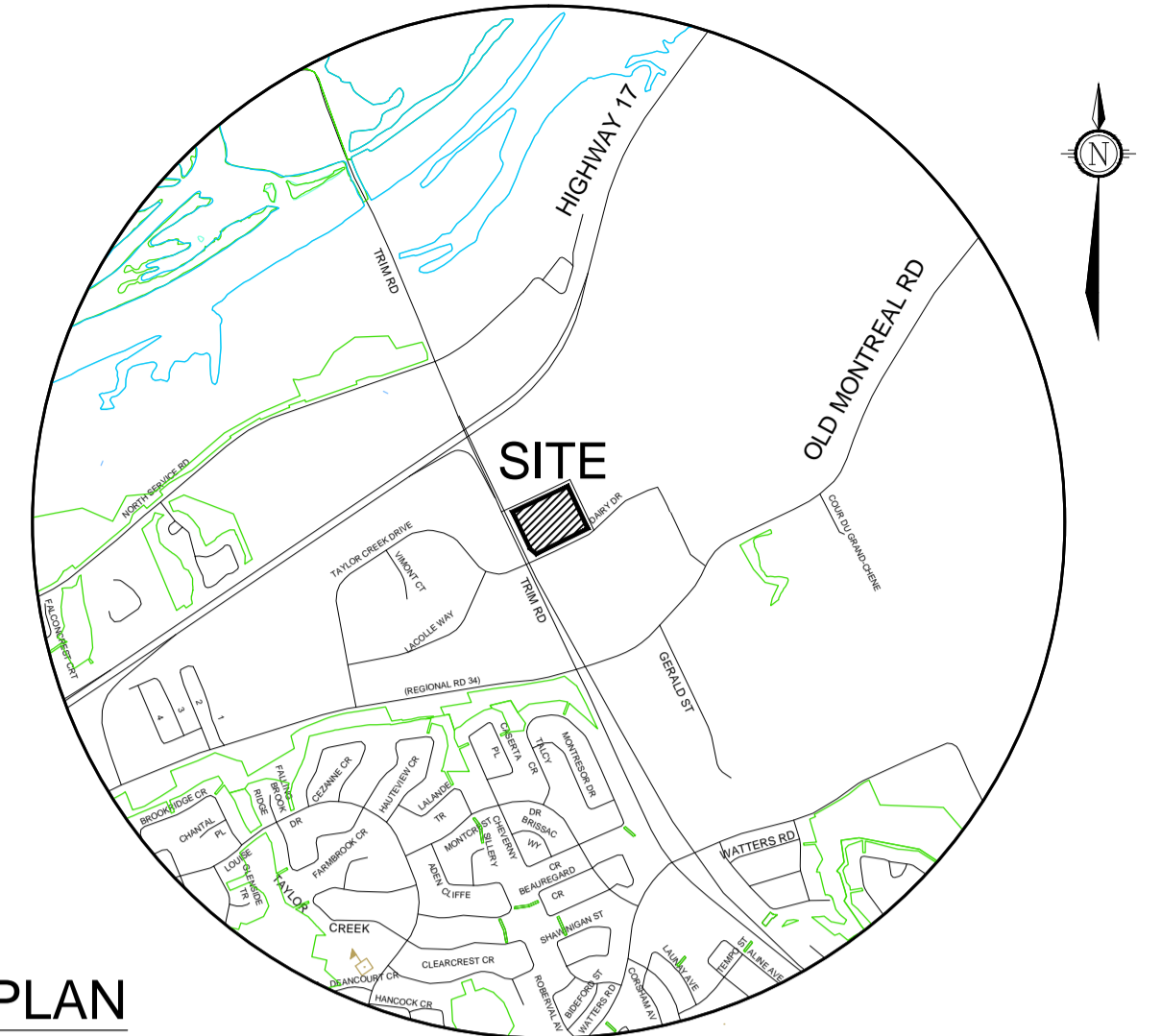

SITE PLAN

955 DAIRY DRIVE

PART OF LOT 30
CONCESSION 1
TOWNSHIP OF CUMBERLAND
Now CITY OF OTTAWA
PARTS 2, PLAN 4R-8326
PARTS 1,2,3, PLAN 4R-27638



ORLEANS VOLKSWAGEN

TRIMTERRA

43 AURIGA DR. OTTAWA, ON, K2E 7Y8 613-723-3093

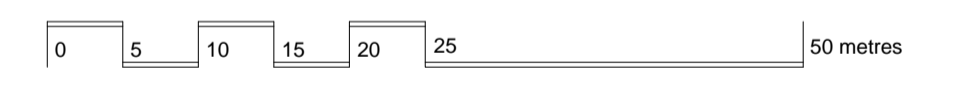

SCALE 1:500

ZONING PROVISIONS: IL [295] H (21)
City of Ottawa By-Law 2008-250

	TRIMTERRA Proposed Retirement Home		VW CAR DEALERSHIP Existing LTC	
	Required	Provided	Required	Provided
Minimum Lot Width (m)	N/A	79.947m	N/A	93.025m
Minimum Lot Area (ha)	0.2 ha	1.1 ha	0.2 ha	1.38 ha
Minimum Front Yard (m)	7.5m	7.5m	7.5m	25.06m
Minimum Rear Yard (m)	7.5m	7.5m	7.5m	82.50m
Minimum Interior Side Yard (m)	7.5m	7.5m	7.5m	18.38m
Minimum Corner Side Yard (m)	7.5m	7.5m	7.5m	17.75m
Maximum Height (m)	21m	8.2m	21m	7.5m
Maximum Lot Coverage (%)	65%	29.8%	65%	14.3%
Maximum Floor Space Index (%)	2%	0.43%	2%	0.24%
Parking (Section 101)	102	127	44	79
Barmer Free Parking (By-Law 2003-530)	4	10	5	2
Bicycle Parking (Section 111)	14	15	3	5
Loading Spaces (Section 113)	5	12	2	2

NOTE:
THIS PLAN HAS BEEN COMPILED USING LEGAL INFORMATION OBTAINED FROM
ANNIS O'SULLIVAN VOLLEBEKK Ltd., ONTARIO LAND SURVEYORS
PLAN OF SURVEY(E-5854-13); DATED MARCH 21, 2013

NOVATECH
ENGINEERING
CONSULTANTS LTD.
ENGINEERS & PLANNERS
Suite 200, 240 Michael Cowplander Drive
Ottawa, Ontario, Canada
K2M 1P6
Telephone (613) 254-9643
Facsimile (613) 254-5867
Email novainfo@novatech-eng.com

ISSUED
FEBRUARY ,2014
PROJECT No.
113071
DRAWING No.
113071-SP

No.	REVISION	DATE	BY
1	ISSUED FOR SITE PLAN APPROVAL	FEB/24th, 2014	HL