

PLANT LIST

| SYM | BOTANICAL NAME                            | COMMON NAME                 | QTY | GRADE         | COMMENTS     |
|-----|---|-----------------------------|-----|---------------|--------------|
|     | DECIDUOUS TREES                           |                             |     |               |              |
| AA  | AMELANCHIER ALNIFOLIA                     | SERVICEBERRY                | 2   | 1.5m HT CLUMP | B.B./W.B     |
| GB  | GINGKO BILOBA                             | GINGKO TREE                 | 3   | 50mm CAL.     | B.B./W.B     |
| GT  | GLEDITSIA TRICANTHOS                      | HONEYLOCUST                 | 4   | 70mm CAL.     | B.B./W.B     |
| MBC | MALUS BAICCATA 'COLUMNARIS'               | COLUMNAR SIBERIAN CRABAPPLE | 3   | 50mm CAL.     | B.B./W.B     |
| MRB | MALUS 'RED BARRON'                        | RED BARRON CRABAPPLE        | 6   | 50mm CAL.     | B.B./W.B     |
| QR  | QUERCUS RUBRA                             | RED OAK                     | 2   | 50mm CAL.     | B.B./W.B     |
| TC  | TILIA CORBATA                             | LITTLELEAF LINDEN           | 3   | 50mm CAL.     | B.B./W.B     |
|     | CONIFEROUS TREES                          |                             |     |               |              |
| PG  | PICEA GLAUCA                              | WHITE SPRUCE                | 2   | 180cm HT.     | B.B./W.B     |
|     | DECIDUOUS SHRUBS                          |                             |     |               |              |
| HAA | HYDRANGEA ARBORESCENS                     | ANNABELLE HYDRANGEA         | 15  | 80cm HT.      | #7 CONTAINER |
| RA  | RIESES ALPNUM                             | FLOWERING CURRANT           | 90  | 50cm HT.      | #5 CONTAINER |
| RJM | ROSA 'JENS MUNK'                          | JENS MUNK EXPLORER ROSE     | 56  | 80cm HT.      | #7 CONTAINER |
| SSS | SORBARIA SOBIFOLIA 'SEMI'                 | SEMI FALSE SHREA            | 6   | 80cm HT.      | #7 CONTAINER |
| SA  | SPIRAEA ARGUTA 'GARLAND'                  | GARLAND SPIREA              | 16  | 50cm HT.      | #5 CONTAINER |
| SV  | SYRINGA VULGARIS 'ALBA'                   | WHITE LILAC                 | 2   | 12cm HT.      | #7 CONTAINER |
| WFP | WEIGELA FLORIDA 'POLKA'                   | POLKA WEIGELA               | 14  | 80cm HT.      | #7 CONTAINER |
|     | CONIFEROUS SHRUBS                         |                             |     |               |              |
| JHP | JUNIPERUS HORIZONTALIS 'PLUMOSA COMPACTA' | COMPACT ANDORRA JUNIPER     | 16  | 80cm SPR.     | #5 CONTAINER |
| TCN | TAKUS GUSPIDATA 'NANA'                    | DWARF JAPANESE YEW          | 12  | 80cm SPR.     | #5 CONTAINER |

LEGEND

- Proposed Building
- Proposed Parking Area
- Concrete Pavement - Private Walkways
- Turf (SOD)
- Tree Protection Fencing
- Existing Trees
- Proposed Trees
- Proposed Game Table
- Proposed Bench
- Proposed Bike Rack

NOTES:  
 1) FOR EXISTING TREES - SEE TREE CONSERVATION DRAWING - ARB1  
 2) FOR GRADING AND SERVING, REFER TO CIVIL

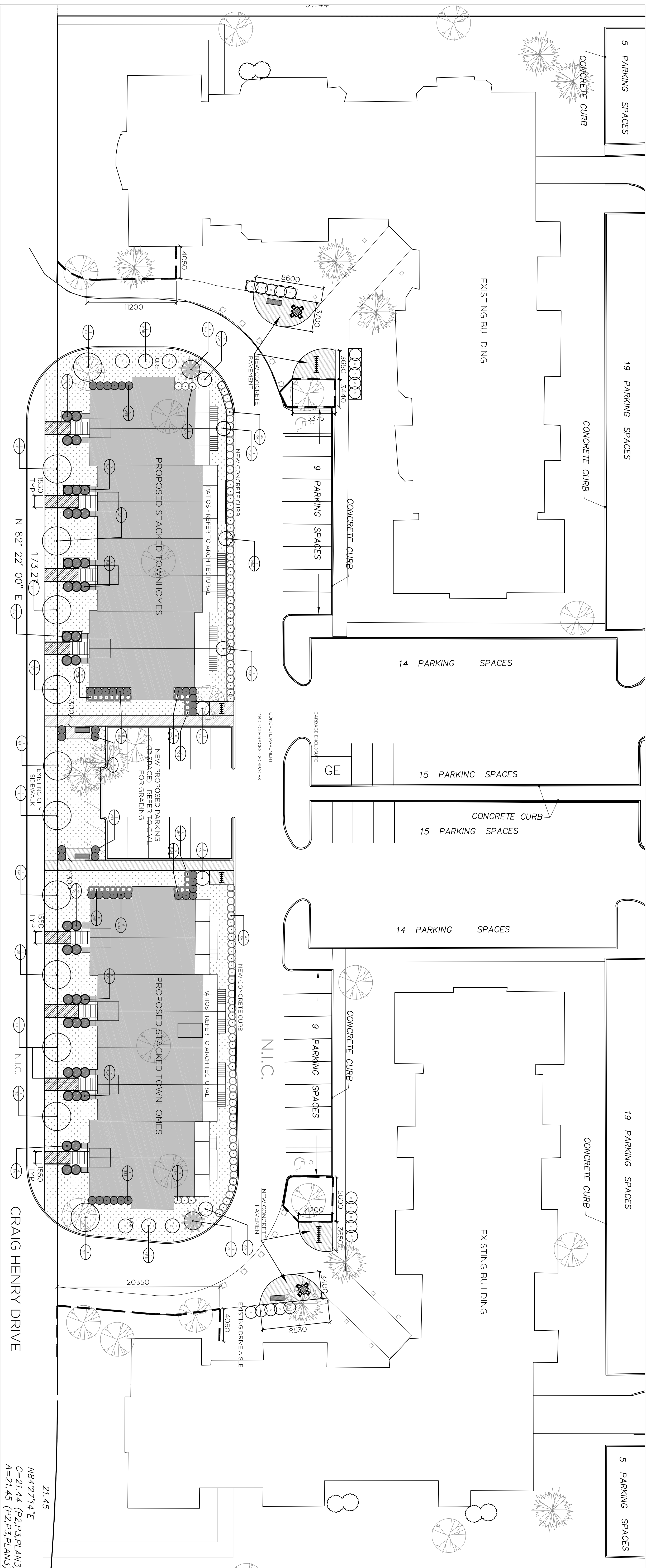

| NO. | ISSUE & REVISIONS | DATE       |
|-----|-------------------|------------|
| 3   | FOR REVIEW        | 2014-01-31 |
| 2   | SUBMITTED FOR SPA | 2013-10-04 |
| 1   | FOR REVIEW        | 2013-10-03 |

1. The General Contractor shall verify all conditions in the field and report any discrepancies to the Landscape Architect prior to construction.  
 2. Any areas outside the limit of work damaged by the General Contractor shall be restored by the General Contractor to the satisfaction of the contract administrator at no additional cost to the Owner.  
 3. All underground utilities to be located by the General Contractor prior to the commencement of any work.  
 4. This drawing is a portion of a complete project and shall be read in conjunction with all other drawings, specifications and tender documents related to the project, regardless of origin.  
 5. All measurements in millimeters unless otherwise noted.  
 6. No proposed retaining wall indicated on this drawing is to exceed drawing height.  
 7. No proposed retaining wall indicated on this drawing is to exceed drawing height above grade except in reference to engineering drawing.  
 8. Do not scale drawing.

PROJECT NORTH

**FOTENN**

PROJECT  
 239 CRAIG HENRY DRIVE  
 OTTAWA, ON

DRAWING  
 LANDSCAPE DRAWING

SCALE: 1:150  
 DRAWN: LM  
 CHECKED: LM  
 DATE: 2013-09-12

DRAWING NO. **L-01**  
 REVISION NO.