

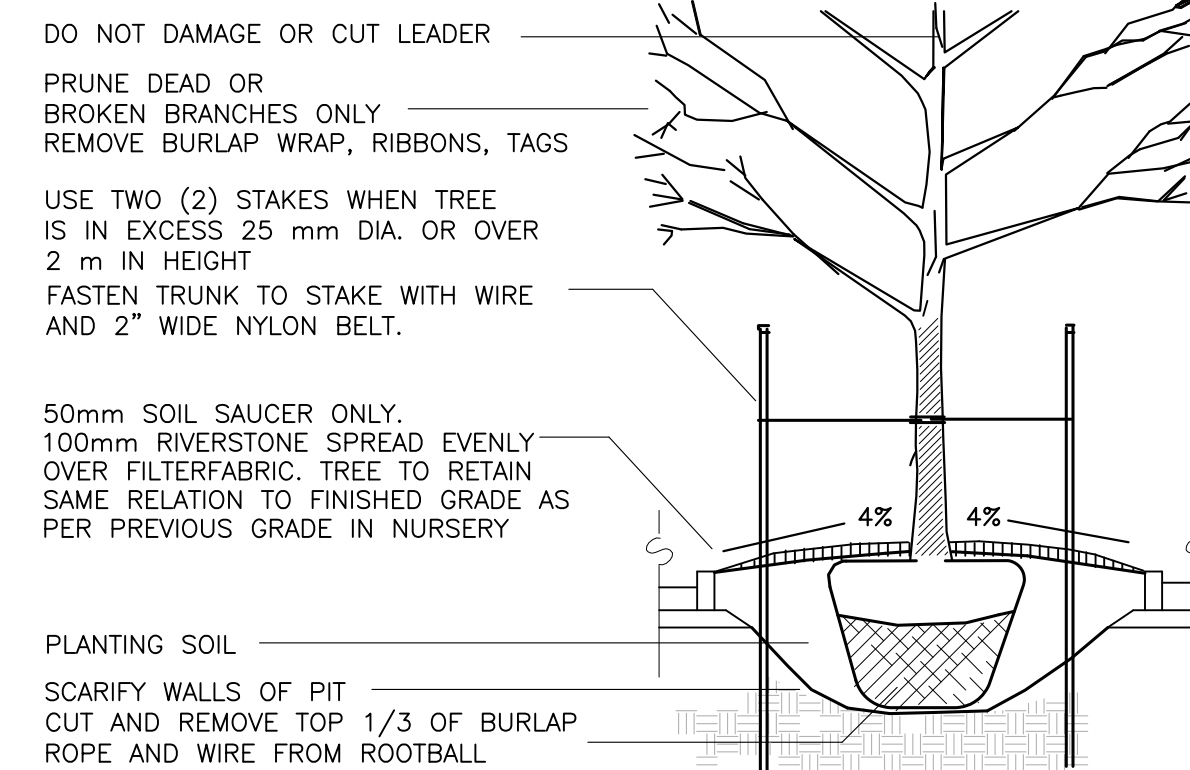

PLANT LIST

| SYM.                         | BOTANICAL NAME                                  | COMMON NAME              | QTY. | SIZE       | REMARKS         |
|------------------------------|---|--------------------------|------|------------|-----------------|
| <b>LARGE DECIDUOUS TREES</b> |   |                          |      |            |                 |
| AF                           | ACER FREEMANII 'AUTUMN BLAZE'                   | AUTUMN BLAZE MAPLE       | 11   | 70mm CAL.  | B&B / W.B.      |
| GT                           | GLEDITSIA TRIACANTHOS VER. INERM. 'SHADEMASTER' | SHADEMASTER HONEY LOCUST | 31   | 70mm CAL.  | B&B / W.B.      |
| QR                           | QUERCUS RUBRA                                   | RED OAK                  | 7    | 70mm CAL.  | B&B / W.B.      |
| UM                           | ULMUS X MORTON                                  | ACCOLADE ELM             | 18   | 70mm CAL.  | B&B / W.B.      |
| <b>SMALL DECIDUOUS TREES</b> |   |                          |      |            |                 |
| MD                           | MALUS DOLGO                                     | DOLGO CRABAPPLE          | 5    | 50mm CAL.  | B&B / W.B.      |
| <b>CONIFEROUS TREES</b>      |   |                          |      |            |                 |
| PP                           | PICEA PUNGENS                                   | COLORADO SPRUCE          | 8    | 2000mm HT. | B&B / W.B.      |
| <b>SHRUBS</b>                |   |                          |      |            |                 |
| JH                           | JUNIPERUS HORIZONTALIS 'PLUMOSA COMPACTA'       | PLUMOSA COMPACTA JUNIPER | 284  | 500mm SPR. | POT. 750mm O.C. |
| RR                           | ROSA RUGOSA                                     | RUGOSA ROSE              | 572  | 500mm HT.  | POT. 750mm O.C. |
| SB                           | SPIREA X BUMALDA 'GOLDFLAME'                    | GOLDFLAME SPIREA         | 705  | 400mm HT.  | POT. 750mm O.C. |
| SS                           | SORBARIA SORBIFOLIA                             | FALSE SPIREA             | 470  | 600mm SPR. | POT. 900mm O.C. |
| <b>PERENNIALS</b>            |   |                          |      |            |                 |
| MS                           | MISCANTHUS SINENSIS 'SILBERFEDER'               | SILVER FEATHER GRASS     | 591  | 500mm HT.  | POT. 750mm O.C. |



TREE IN PARKING ISLAND DETAIL  
TYPICAL NTS

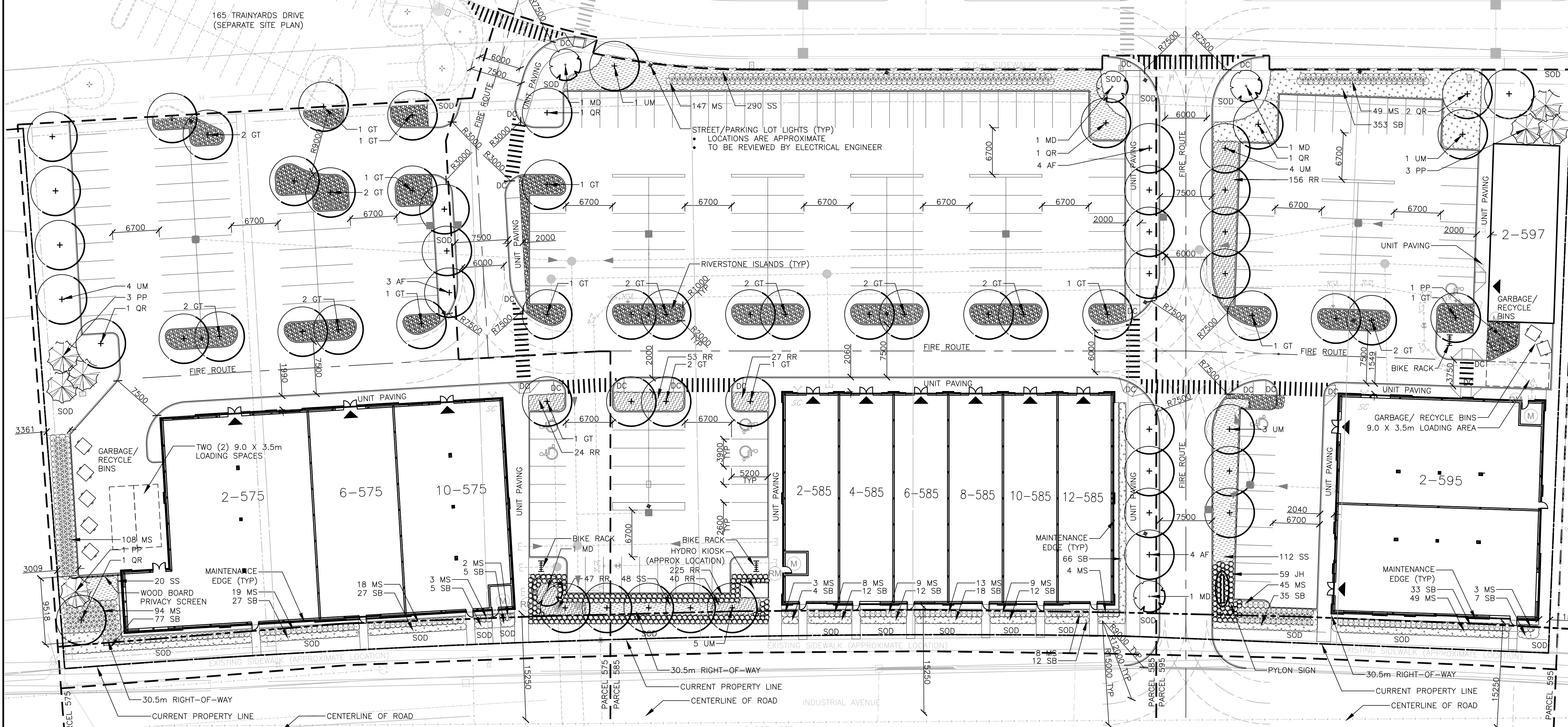

|                                      |                     |            |           |
|--------------------------------------|---------------------|------------|-----------|
| PARCEL 575                           | BUILDING '2-575' =  | 7,500 SF/  | 696.50 SM |
|                                      | BUILDING '6-575' =  | 5,000 SF/  | 464.50 SM |
|                                      | BUILDING '10-575' = | 4,000 SF/  | 371.60 SM |
| GROSS FLOOR AREA =                   |                     | 16,500 SF/ | 1532.90   |
| 3.4 PARKING SPACES/100 SM REQUIRED = |                     | 52.12      |           |
| PARKING SPACES PROPOSED =            |                     | 61         |           |
| DISABLED PARKING SPACES REQUIRED =   |                     | 1          |           |
| DISABLED PARKING SPACES PROPOSED =   |                     | 2          |           |
| BIKE PARKING SPACES REQUIRED =       |                     | 6          |           |
| BIKE PARKING SPACES PROPOSED =       |                     | 10         |           |

|                                      |                     |            |           |
|--------------------------------------|---------------------|------------|-----------|
| PARCEL 585                           | BUILDING '2-585' =  | 2,500 SF/  | 232.25 SM |
|                                      | BUILDING '4-585' =  | 2,500 SF/  | 232.25 SM |
|                                      | BUILDING '6-585' =  | 2,500 SF/  | 232.25 SM |
|                                      | BUILDING '8-585' =  | 2,500 SF/  | 232.25 SM |
|                                      | BUILDING '10-585' = | 2,500 SF/  | 232.25 SM |
|                                      | BUILDING '12-585' = | 2,500 SF/  | 232.25 SM |
| GROSS FLOOR AREA =                   |                     | 15,000 SF/ | 1393.50   |
| 3.4 PARKING SPACES/100 SM REQUIRED = |                     | 47.38      |           |
| PARKING SPACES PROPOSED =            |                     | 124        |           |
| DISABLED PARKING SPACES REQUIRED =   |                     | 2          |           |
| DISABLED PARKING SPACES PROPOSED =   |                     | 2          |           |
| BIKE PARKING SPACES REQUIRED =       |                     | 6          |           |
| BIKE PARKING SPACES PROPOSED =       |                     | 10         |           |

|                                      |                    |            |           |
|--------------------------------------|--------------------|------------|-----------|
| PARCEL 595                           | BUILDING '2-595' = | 10,000 SF/ | 929.42 SM |
|                                      | BUILDING '2-597' = | 2,500 SF/  | 232.25 SM |
| GROSS FLOOR AREA =                   |                    | 12,500 SF/ | 1161.67   |
| 3.4 PARKING SPACES/100 SM REQUIRED = |                    | 39.50      |           |
| PARKING SPACES PROPOSED =            |                    | 50         |           |
| DISABLED PARKING SPACES REQUIRED =   |                    | 1          |           |
| DISABLED PARKING SPACES PROPOSED =   |                    | 2          |           |
| BIKE PARKING SPACES REQUIRED =       |                    | 5          |           |
| BIKE PARKING SPACES PROPOSED =       |                    | 10         |           |

|   |                                 |              |
|---|---------------------------------|--------------|
| 2 | REISSUED FOR SITE PLAN APPROVAL | 21 OCT, 2013 |
| 1 | ISSUED FOR SITE PLAN APPROVAL   | 20 DEC, 2012 |

North

Stamp

It is the responsibility of the contractor to:  
\*check and verify all pertinent codes and by-laws  
\*check and verify locations of all underground services with all local utilities prior to any digging.  
Do not scale drawings. Copyright reserved. This drawing may not be used for construction until signed by the landscape architect.

**C-S-W** Landscape Architecture  
Urban Design  
Site Planning  
Recreation and Park Planning  
Project Management  
1960 Scott Street, Suite 200, Ottawa, Ontario K1Z 8L8  
Tel: (613) 729-4536 Fax: (613) 729-3018

Project  
**OTTAWA TRAIN YARDS**  
PHASE 3  
PARCEL 575-585-595  
OTTAWA, ONTARIO

Drawing  
**LANDSCAPE PLAN**

|                |          |              |              |
|----------------|----------|--------------|--------------|
| Scale:         | 1:300    | Date:        | 12 DEC, 2012 |
| Design By:     | SM       | Drawn By:    | SM           |
| Project Number | 1311-09B | Sheet Number | L 1.2        |