

PAVING SCHEDULE		
	TYPE A	TRANSPAVE BOULVARD TLI 90MM PAVER - CRESCENDO 320  - MODIFIED RUNNING BOND PATTERN IN CHECKER BOARD COLOUR PATTERN  - MIX TO CONSIST OF MODULE 'E' AND MODULE 'A' PAVERS  - COLOUR TO BE DETERMINED  - GRANITECH FINISH
	TYPE B	SQUARE CUT (610MM X 610MM) WHITE GRANITE STONES

SITE FURNISHING SCHEDULE			
ITEM	QTY	TYPE	COMMENTS
BENCH ON PRECAST CONCRETE BASE	5	MLB872BL-W: BACKLESS LEGLESS BENCH, SUPPLIED BY MAGLIN SITE FURNITURE	MOUNTING: SURFACE COLOUR: METAL COMPONENTS = GUNMETAL FINETEX, SEAT = IPE WOOD
CANTILEVERED BENCH	1	MLB872BL-W: BACKLESS CANTILEVER BENCH, SUPPLIED BY MAGLIN SITE FURNITURE	MOUNTING: SURFACE COLOUR: METAL COMPONENTS = GUNMETAL FINETEX, SEAT = IPE WOOD
WASTE RECEPTACLE	2	AUSTIN LITTER RECEPTACLE, TOP OPENING, SUPPLIED BY LANDSCAPE FORMS	MOUNTING: SURFACE COLOUR: TITANIUM
BIKE RACKS	10	RING BIKE RACK, SUPPLIED BY LANDSCAPE FORMS	MOUNTING: SURFACE COLOUR: TITANIUM
TABLE AND 4 CHAIRS	4	CHIPMAN TABLE AND CHAIRS, SUPPLIED BY LANDSCAPE FORMS	MOUNTING: FREESTANDING COLOUR: TBD
DOUBLE CANTILEVERED UMBRELLA	1	TUUCI UMBRELLA DUAL CANTILEVER	MOUNTING: SURFACE COLOUR: METAL COMPONENTS = ANODIZED ALUMINUM, UMBRELLA FABRIC = NATURAL (#6004)



- Legend**
- UNIT PAVERS (TYPE A) - SEE PAVING SCHEDULE
  - UNIT PAVERS (TYPE B) - SEE PAVING SCHEDULE
  - BROOM FINISH CONCRETE
  - PLANTING BED - REFER TO SHEET L2.0
  - SOD
  - BENCH TOPPER ON PRECAST CONCRETE
  - BIKE RACK
  - CUSTOM TREE GRATE
  - TABLE AND 4 CHAIRS
  - DOUBLE CANTILEVERED UMBRELLA

**NOTES:**  
 1. REFER TO SHEET L2.00 FOR PLANTING PLAN  
 2. REFER TO CIVIL FOR ALL SITE GRADING AND DRAINAGE  
 3. REFER TO SHEET L3.00 FOR CONSTRUCTION DETAILS

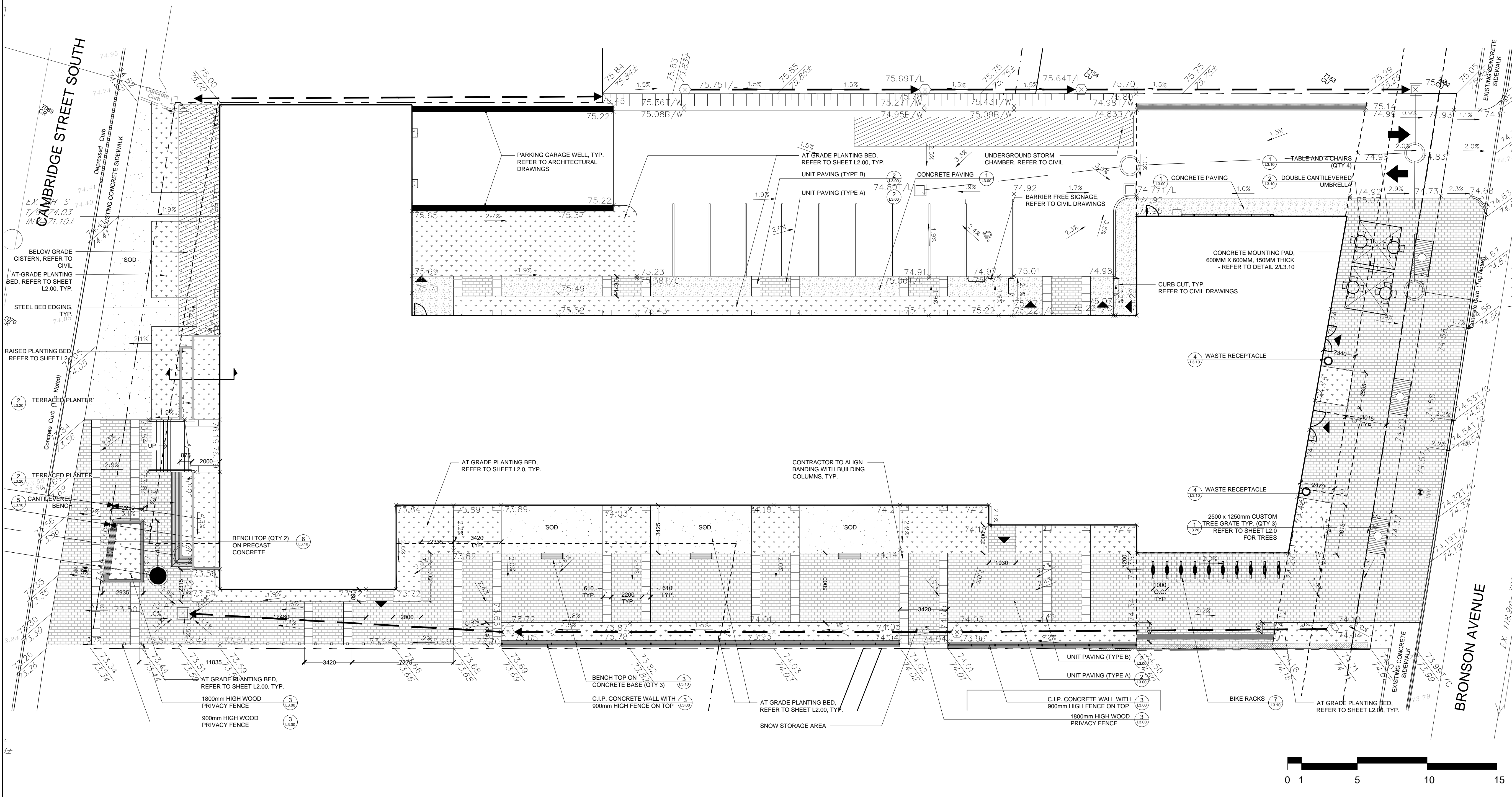

- GENERAL NOTES:**
- Drawings not to be used for construction unless authorized by the Landscape Architect
  - Contractor shall report any discrepancies between the drawings and site conditions prior to commencement of the work
  - All utility locates are the responsibility of the Contractor. Hand dig within the limits recommended by the service utility. Utility conflicts with proposed tree locations must be reported immediately to the Landscape Architect
  - Base drawing provided by SRM Architects Inc.

**HARDSCAPE PLAN**  
 774 BRONSON AVENUE  
 OTTAWA, ON.

ISSUED FOR SPA ONLY

DATE	ISSUE	BY
11/12/2015	ISSUED FOR SITE PLAN APPROVAL	CM

NOT FOR CONSTRUCTION

**GSP group**

2512 Victoria Street South  
 Ottawa, Ontario K1V 4T5  
 T 613 960 8822  
 F 613 960 8843  
 www.gspgroup.ca

102 Locke Street South, Suite 200  
 Ottawa, Ontario K1P 4J9  
 T 613 972 1417  
 F 613 972 1417

Date: NOV. 23, 2015  
 Scale: 1:150  
 Drawn By: CZ  
 Project No.: 15183

L1.00

774 BRONSON PLANT LIST						
DECIDUOUS TREES	QTY	BOTANICAL NAME	COMMON NAME	CONT	CAL	REMARKS
AC	4	Amelanchier canadensis (Clump Form)	Canadian Serviceberry (Clump Form)	W.B.	150cm	MIN. 3 TRUNKS
AS	3	Acer saccharum 'Fall Fiesta'	Fall Fiesta Sugar Maple	W.B.	60mm Cal	STRAIGHT CENTRAL LEADER
BN	3	Betula nigra (Standard)	River Birch (Standard)	W.B.	60mm Cal	SINGLE TRUNK, STRAIGHT CENTRAL LEADER
CA	1	Cornus alternifolia	Pagoda Dogwood	W.B.	45mm Cal	900MM HT, CLEAR TRUNK
QR	3	Quercus rubra	Red Oak	W.B.	60mm	STRAIGHT CENTRAL LEADER
CONIFEROUS SHRUBS	QTY	BOTANICAL NAME	COMMON NAME	CONT	SPACING	REMARKS
JsT	44	Juniperus sabinna 'Tamariscifolia'	Tamarix Savin Juniper	50cm, 3 gal.	1,30m	
TcC	60	Taxus cuspidata 'Capitata'	Capitata Japanese Yew	80cm Ht, B&B	1m	
DECIDUOUS SHRUBS	QTY	BOTANICAL NAME	COMMON NAME	CONT	SPACING	REMARKS
CaH	72	Clethra alnifolia 'Hummingbird'	Summersweet	60cm, 3 gal.	0,75m	
CsA	75	Cornus sericea 'Artic Fire'	Artic Fire Dogwood	60cm, 3 gal.	0,80m	
HpB	52	Hydrangea paniculata 'Bombshell'	Bombshell Hydrangea	60cm, 3 gal.	0,60m	
HpF	40	Hydrangea paniculata 'Fire and Ice'	Fire and Ice Hydrangea	60cm, 3 gal.	1m	
SnBL	16	Sambucus nigra 'Black Lace'	Black Lace Elderberry	60cm, 3 gal.	1,50m	
ORNAMENTAL GRASSES	QTY	BOTANICAL NAME	COMMON NAME	CONT	SPACING	REMARKS
caK	95	Calamagrostis acutiflora 'Karl Foerster'	Feather Reed Grass	1 gal	0,70m	
cc	44	Calamagrostis canadensis	Bluejoint Reed Grass	3 gal	0,70m	
msL	47	Miscanthus sinensis 'Little Kitten'	Little Kitten Eulalia Grass	1 gal	0,60m	
msP	67	Miscanthus sinensis 'Purpurescens'	Flame Grass	1 gal	0,70m	
pVP	63	Panicum virgatum 'Prairie Fire'	Red Switch Grass	1 gal	0,60m	
PERENNIALS	QTY	BOTANICAL NAME	COMMON NAME	CONT	SPACING	REMARKS
or	26	Osmunda regalis	Royal Fern	3 gal	1,40m	
GROUND COVERS	QTY	BOTANICAL NAME	COMMON NAME	CONT	SPACING	REMARKS
go	357	Galium odoratum	Sweet Woodruff	9cm pot	300mm	
PERENNIALS	QTY	BOTANICAL NAME	COMMON NAME	CONT	SPACING	REMARKS
ccB	401	Cornus canadensis	Bunchberry Dogwood	1 gal	300mm	
hHW	79	Hosta x 'Heat Wave'	Heat Wave Hosta	1 gal	450mm	
snM	98	Salvia nemorosa 'May Night'	May Night Sage	1 gal	450mm	

**PLANTING NOTES:**

- All plant material shall be No.1 nursery grown, meeting specifications for size, height, spread, grading, quality, method of cultivation, and baling and burlap specifications as set out in the 8th Edition 2006 Guide Specification for Nursery Stock prepared by the CNLA.
- No substitutions in species, cultivar, quantity, size or condition will be permitted without the written approval of the Consultant. Any unapproved substituted material will be required to be removed from the site.
- Any inconsistencies found in the quantities as shown on the plan and the plant list shall be immediately reported to the Consultant.
- Layout shall be the responsibility of the Contractor. Layout, plant stake-out and delivered plant material shall be approved by the Consultant prior to installation.
- Native or Imported topsoil shall be tested as specified and approved by the Consultant prior to adding any amendments and placement. Planting mix, where indicated, shall follow the mix specifications.
- Provide 400mm minimum depth of approved topsoil or planting mix in all beds, unless otherwise noted. All beds shall be mulched with approved mulch to a minimum depth of 100mm, unless otherwise noted. Depths shall be those achieved under light compaction. Areas to be sodded or seeded shall be provided with 150 mm of approved topsoil, compacted to 85% SPD.
- No bare-root planting shall be permitted between May 15 and October 15.
- Plant material shall be thoroughly watered at the time of planting.
- Those areas not specifically identified for planting, or otherwise noted, shall be sodded. Sodding shall be maintained and warranted until First Cut. Seeding shall be maintained and warranted until October 1 for Spring seeding and June 1 for Fall seeding.
- All trees and shrubs shall be under warranty for a period of 12 months commencing on the Date of Acceptance.
- The contractor shall provide maintenance immediately after the plants are installed and continue throughout the entire warranty period. Maintenance requirements shall include all procedures consistent with proper horticultural practices to ensure normal, vigorous, and healthy growth of all material planted. All stakes, wire, hose, and other accessories must be removed prior to final warranty inspection.
- All plant material used as replacements for unacceptable material shall be of the same quality and requirements prescribed for the original material. Replacements shall be made once under the warranty.

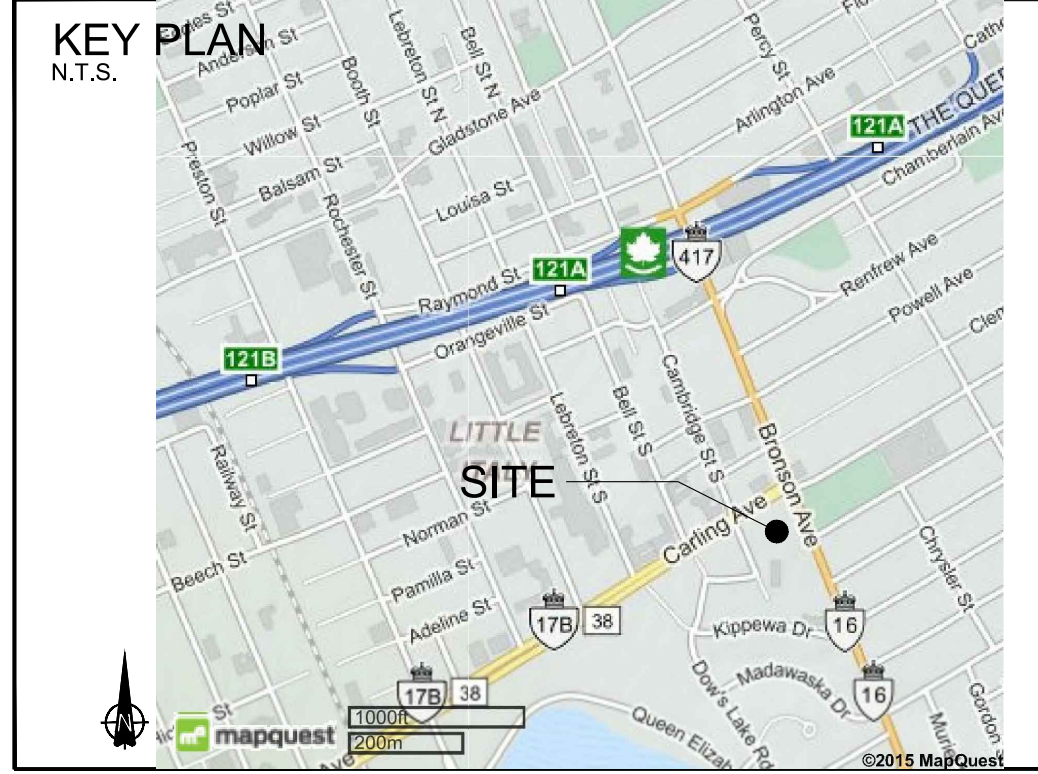

**Legend**

- GENERAL NOTES:**
- Drawings not to be used for construction unless authorized by the Landscape Architect
  - Contractor shall report any discrepancies between the drawings and site conditions prior to commencement of the work
  - All utility locates are the responsibility of the Contractor. Hand dig within the limits recommended by the service utility. Utility conflicts with proposed tree locations must be reported immediately to the Landscape Architect
  - Base drawing provided by SRM Architects Inc.

NOTE: CONTRACTOR TO REFER TO SHEET L1.00 FOR ALL HARDSCAPE ELEMENTS, INCLUDING SITE FURNISHING.

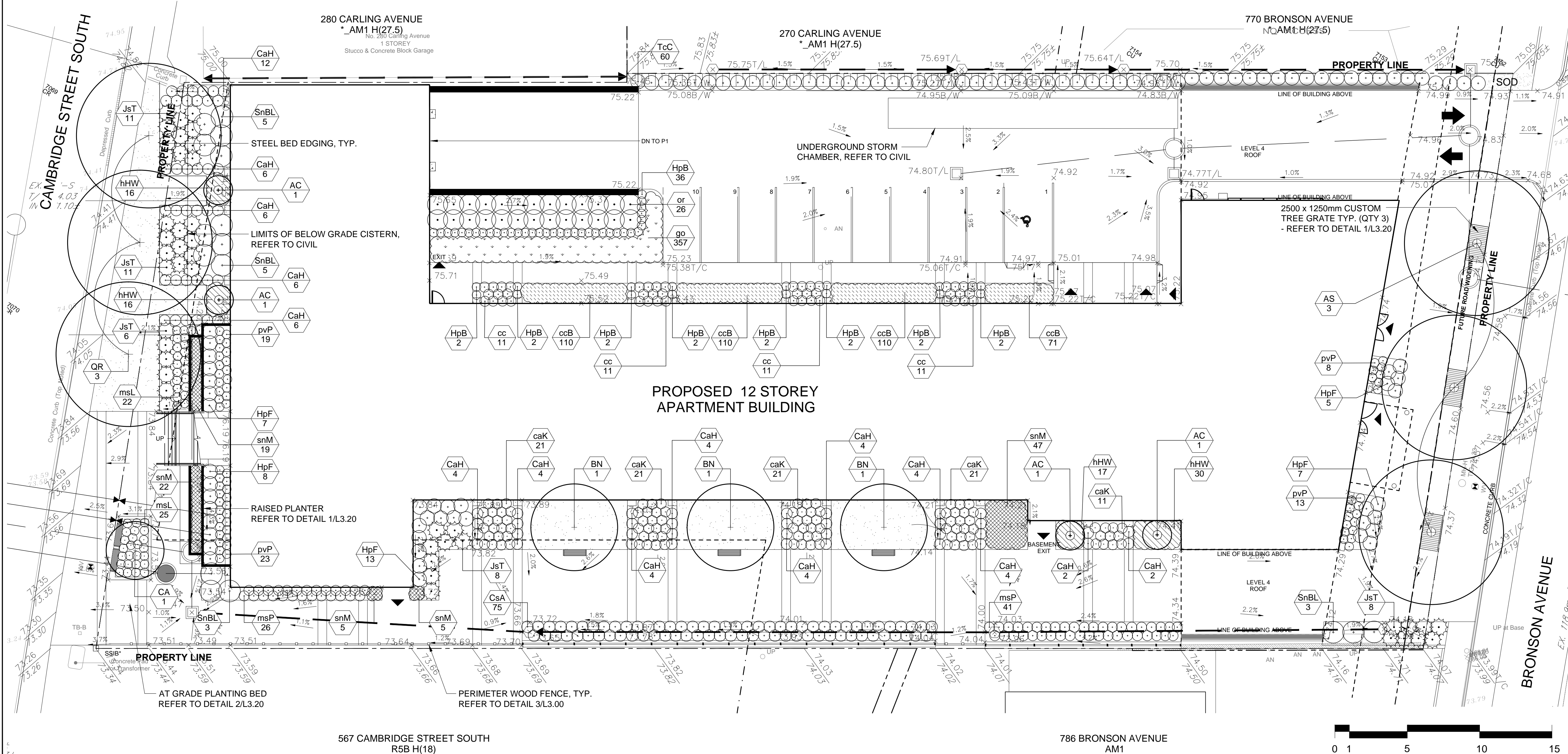

**PLANTING PLAN**  
774 BRONSON AVENUE  
OTTAWA, ON.

ISSUED FOR SPA ONLY

DATE	ISSUE	BY
11/12/2015	ISSUED FOR SITE PLAN APPROVAL	CM
DATE	REVISIONS	BY

**NOT FOR CONSTRUCTION**



2012 Victoria Street East  
Ottawa, Ontario K1P 4T8  
T 613 960 9882  
F 613 960 9844  
www.gspgroup.ca

**L2.00**

**GROWING MEDIUM NOTES:**

**1.0 GROWING MEDIUM TESTING:**

1.1 Growing mediums (Topsoil; Planting Mixes) and organic amendments must be tested by an OMAFRA accredited agency and approved prior to use. Test topsoil for P, K, Ca and Mg, minor element values, soluble salt content, organic matter, texture and pH value appropriate for the establishment and growth of ornamental nursery stock. Submit test results and analysis including recommendations for amendments and fertilizer to the Consultant.

**2.0 TOPSOIL:**

- 2.1 Topsoil shall be fertile, friable, topsoil, free of: fragments larger than 75mm in size; stones over 30mm in diameter; debris; plants or their roots; sticks; noxious seed plants; stolons; seeds; salts; soil sterilants; chemical contaminants; or other materials detrimental to plant growth.
- 2.2 Fertilizer and Amendments: must be made as per soil testing agency recommendations.
- 2.3 All topsoil for the intensive use lawn areas shall be sandy loam class only.
- 2.4 Topsoil: shall not be moved, delivered or worked on while in a frozen state or condition.

**3.0 GROWING MEDIUM - PLANTING MIXES:**

- 3.1 Planting Mix: (where specified) shall be thoroughly combined prior to placement in planting bed areas to the following proportions: 4 parts approved topsoil, 1 part compost, 1 part shredded peat moss and an application of high phosphorous fertilizer (0-20-0).
- 3.2 Mixes containing a significant amount of peat moss shall not be permitted to dry out. The moisture content of the peat moss at the time of mixing shall be not less than 60% to 75%.

**4.0 FERTILIZER AND AMENDMENTS:**

- 4.1 Organic Soil Additive: "Gro-Bark" Fine Composted Pine Mulch or an approved alternative.
- 4.2 Fertilizer: complete commercial fertilizer with 50% of the elements derived from organic sources.
- 4.3 Peat Moss: decomposed plant material, fairly elastic and homogenous, free of decomposed colloidal residue, wood, sulphur and iron and of brown colour containing minimum 60% organic matter by weight, moisture content not exceeding 15% and pH value of 3.4 - 5.5.
- 4.4 Compost and Manure: shall meet the standards found in the Interim Guidelines for the Production and Use of Aerobic Compost in Ontario published by the Ontario Ministry of Environment and Energy (MOEE), and shall be virtually free from all viable weed seeds, or other plant reproductive parts, pathogens, chemicals or toxic contaminants. Manure shall be well rotted, unbleached cattle manure, free from harmful chemicals and other injurious substances, at least eight months old, but not more than two years old and with no more than 25% straw, leaves or other materials. Physical contaminants such as rock, plastic, metal or glass shall be less than 0.5%. Total carbon to nitrogen ratio in the resulting growing medium shall not exceed 30:1.
- 4.5 Lime: Limestone containing not less than 8% of calcium and magnesium carbonates combined, finely ground to pass a 10 mesh sieve with at least one half passing a 100 mesh sieve. Rate of application shall be determined after the pH of the topsoil.
- 4.6 Bonemeal: raw, finely ground with a minimum analysis of 4% nitrogen and 20% phosphoric acid.
- 4.7 Sand: sharp, clean sand, to OPSS 1002-3.

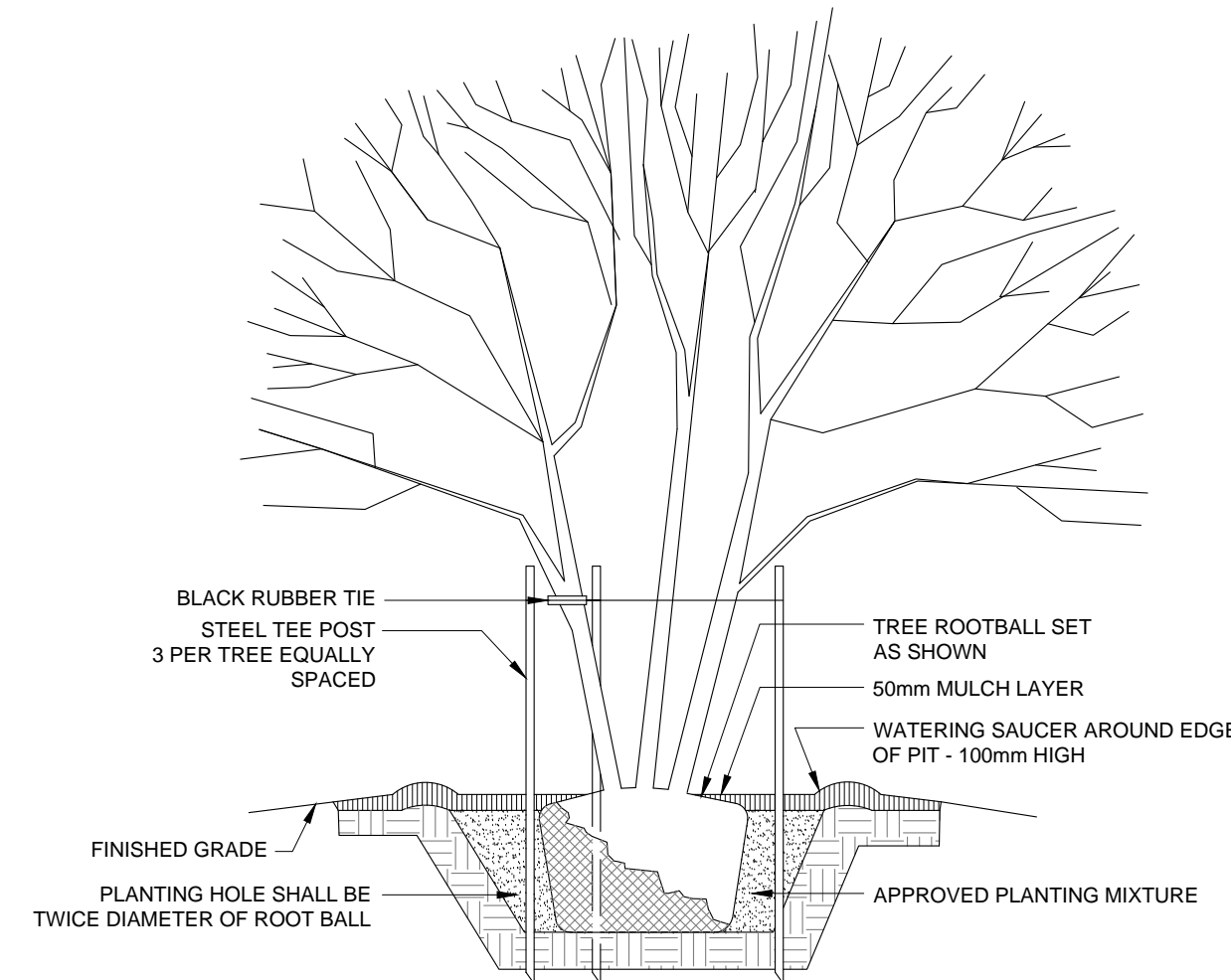

**1 TYPICAL MULTI-TRUNK TREE PLANTING**  
N.T.S.

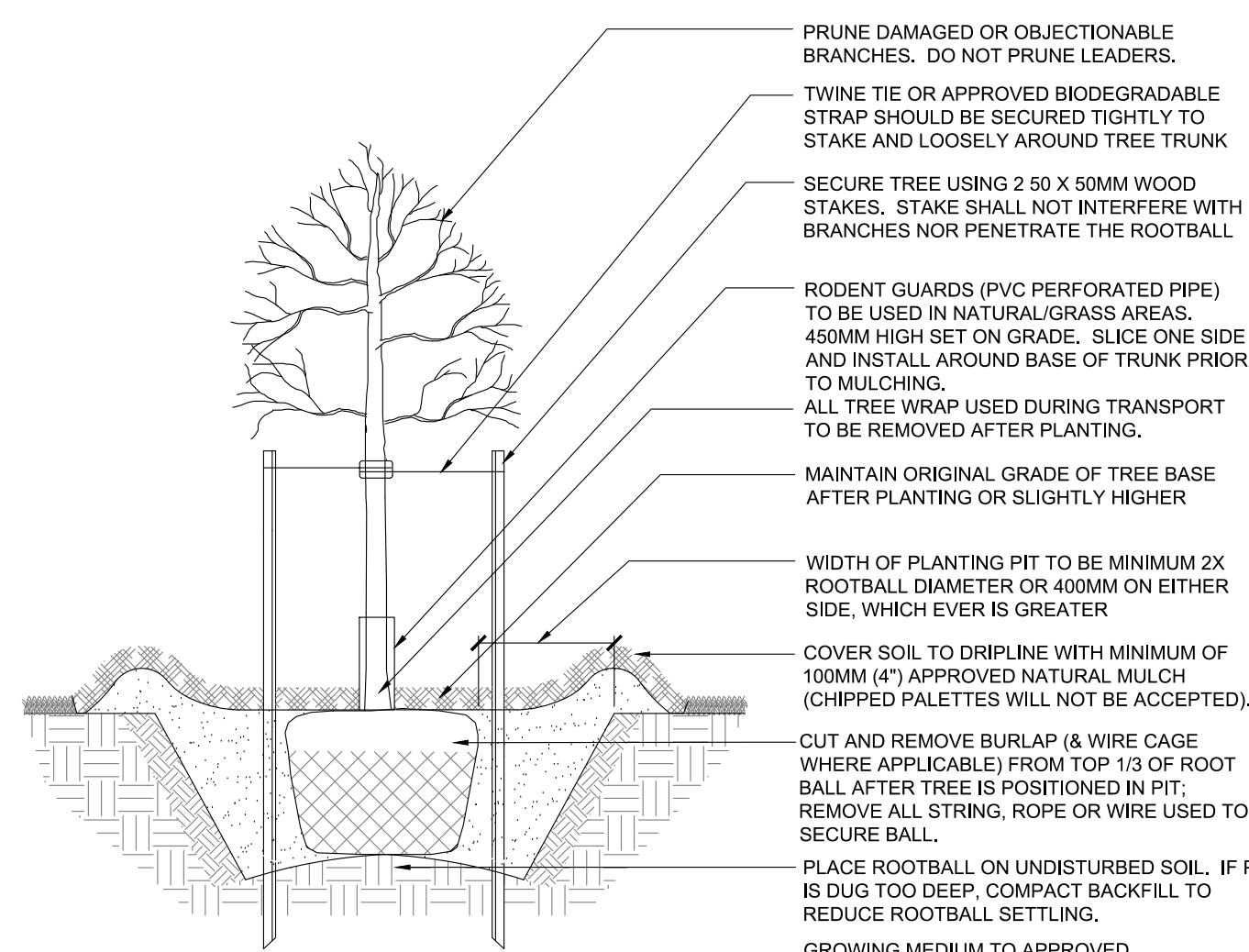

- NOTES**
1. GROWING MEDIUM MIX: 4 PARTS TOPSOIL, 1 PART COMPOST, 1 PART SHREDDED PEAT & APPLICATION OF HIGH PHOSPHOROUS FERTILIZER (0-20-0)
  2. PLANT MATERIAL SHALL BE THOROUGHLY WATERED AT TIME OF PLANTING.
  3. PLANT MATERIAL SHALL BE SET PLUMB IN THE MIDDLE OF THE PIT.
  4. TREE SHALL BEAR SAME RELATION OR SLIGHTLY HIGHER TO FINISHED GRADE AS ORIGINALLY GROWN.
  5. PLANT STOCK MOVED WHILE IN LEAF SHALL BE COVERED WHILE IN TRANSIT. ROOTS SHOULD BE KEPT MOIST UNTIL PLANTED. TREES IN LEAF TO BE TREATED WITH ANTI-DESICCANT.
  6. DIMENSIONS ARE IN MILLIMETERS UNLESS OTHERWISE NOTED.
  7. STAKING IS TO OCCUR ONLY AT THE DIRECTION OF THE LANDSCAPE ARCHITECT.
  8. 100MM HIGH SAUCER EXCEPT WHEN PLANTING IN BED.

**2 DECIDUOUS TREE PLANTING B.W/B - UP TO 80MM CALIPER**  
N.T.S.

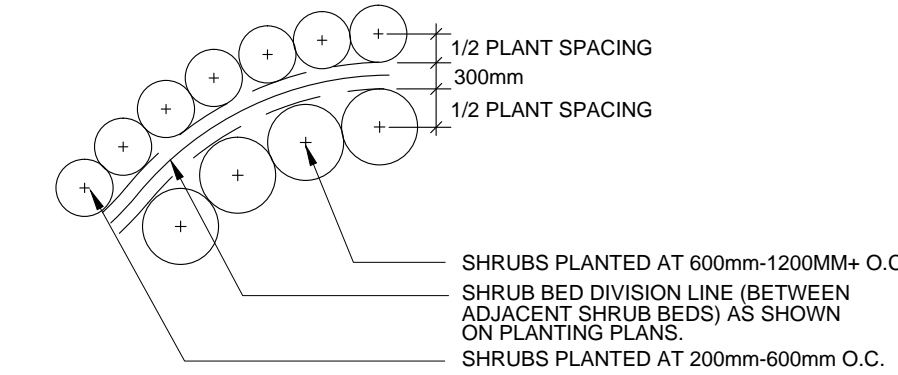

**NOTE:**  
DETAIL SHOWS THE INTENDED PLANTING LAYOUT OF ADJACENT SHRUB BEDS ALONG CURVES. CONTRACTOR TO PLANT ALL PERIMETERS OF PLANTING BED AREAS AS SHOWN AND THEN PLANT THE REMAINDER OF THE PLANTING BED TRIANGULARLY AT THE SPECIFIED SPACING ON PLANS.

**3 ADJACENT PLANT SPACING**  
N.T.S.

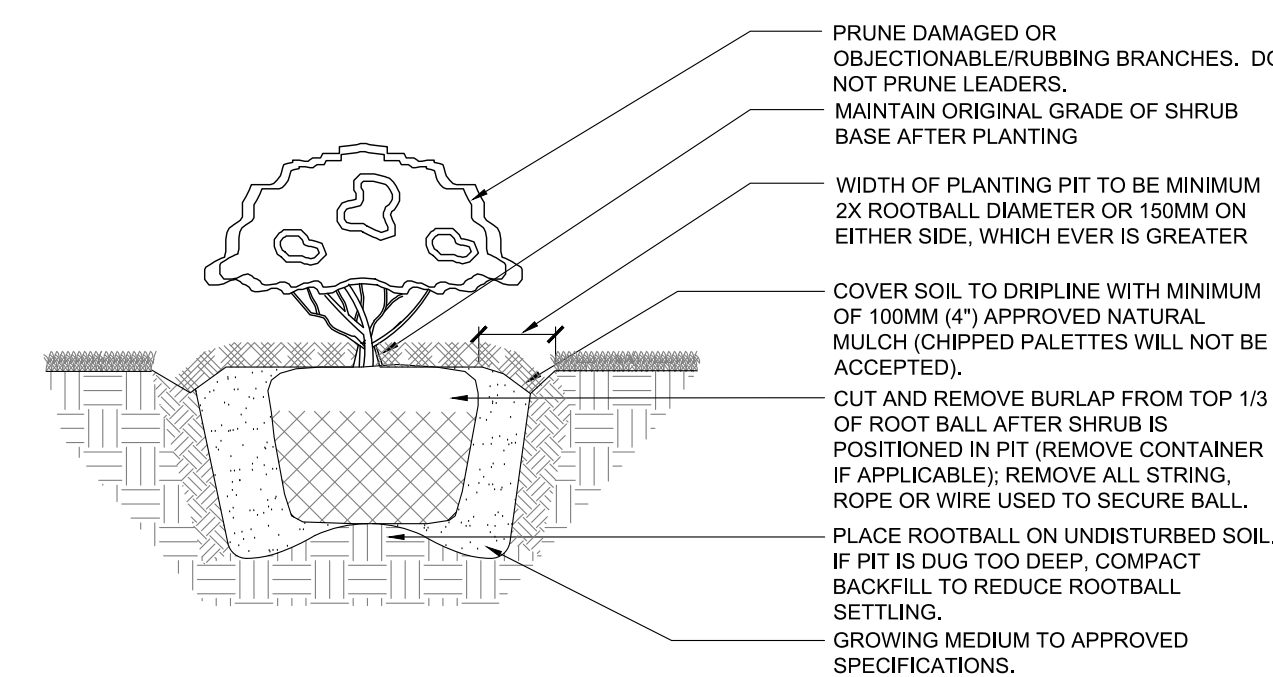

- NOTES**
1. GROWING MEDIUM MIXTURE: 4 PARTS TOPSOIL, 1 PART COMPOST, 1 PART SHREDDED PEAT & APPLICATION OF HIGH PHOSPHOROUS FERTILIZER (0-20-0).
  2. PLANTING BED SHALL BE THOROUGHLY WATERED IMMEDIATELY AFTER PLANTING & PRIOR TO MULCHING.
  3. FOR POTTED SHRUBS, SATURATE CONTAINER/ROOTS/SOIL PRIOR TO REMOVAL OF CONTAINER BEFORE PLANTING.
  4. SHRUBS ARE TO BE SPACED AS DIRECTED.
  5. ALL DIMENSIONS ARE IN MILLIMETERS.

**4 B&B/CONTAINER STOCK SHRUB / GRASS PLANTING**  
N.T.S.

**GROWING MEDIUM REQUIREMENTS:**

1. CONTRACTOR TO PROVIDE SOIL TESTING RESULTS OF GROWING MEDIUM TO LANDSCAPE CONSULTANT FOR APPROVAL PRIOR TO INSTALLATION.
2. CONTRACTOR SHALL PREPARE PLANTING BEDS AND TREE PITS WITH APPROVED GROWING MEDIUM PRIOR TO INSTALLATION OF PLANT MATERIAL.
3. CONTRACTOR SHALL PAY ALL COSTS TO CORRECT GROWING MEDIUM AND REPLACEMENT OF PLANT MATERIAL IF SPECIFIED TESTS, AMENDMENTS, AND WRITTEN APPROVAL OF THE LANDSCAPE CONSULTANT ARE NOT OBTAINED.

**PLANTING DETAILS**  
774 BRONSON AVENUE  
OTTAWA, ON.

ISSUED FOR SPA ONLY

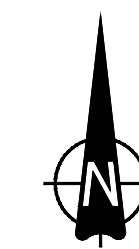

DATE	ISSUE	BY
11/12/2015	ISSUED FOR SITE PLAN APPROVAL	CM
DATE	ISSUE	BY

NOT FOR  
CONSTRUCTION



21-075 Victoria Street South  
Mississauga, Ontario L5S 1Y5  
T 905 883 8833  
F 905 883 8843  
www.gspgroup.ca

180 Lake Street South, Suite 200  
Mississauga, Ontario L5L 1A8  
T 905 972 1477

Date: NOV-23, 2015  
Scale: AS NOTED

Drawn By: CZ  
Project No.: 15183

L2.10

NOTE: EXPANSION JOINT - AT ALL COLD JOINTS OR PERIMETER BOUNDARIES WITH OTHER STRUCTURES OF PAVING.

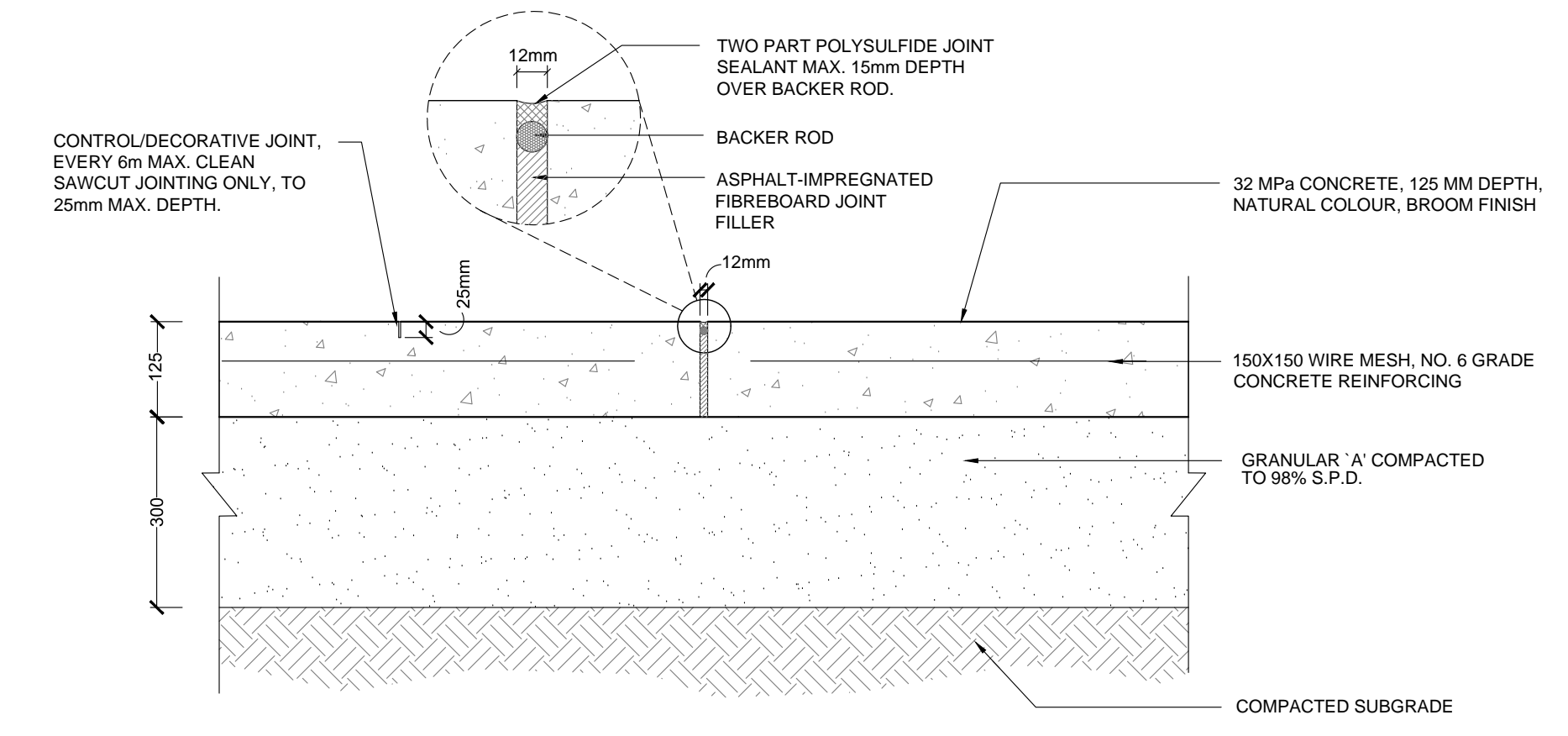

1 DECORATIVE CONCRETE PAVING  
Scale 1:10

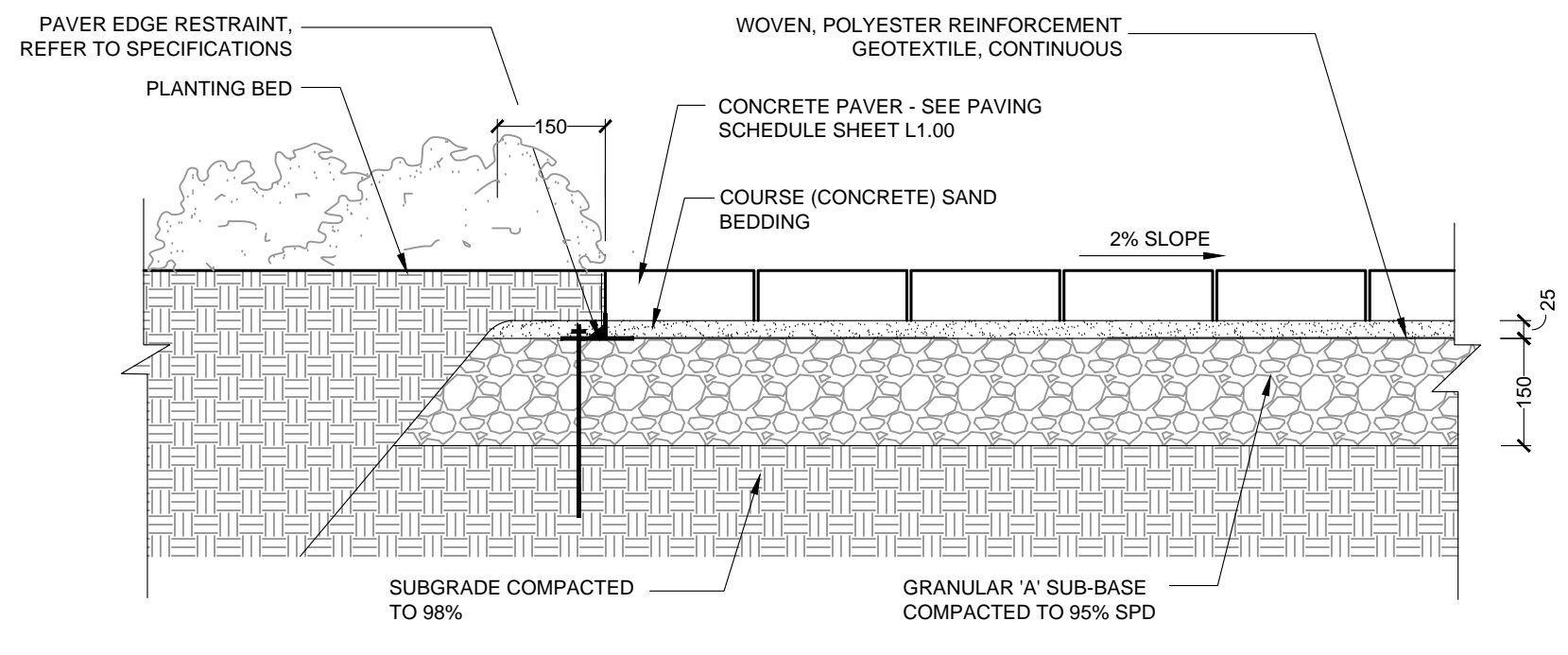

2 UNIT PAVER WITH EDGER  
Scale 1:10

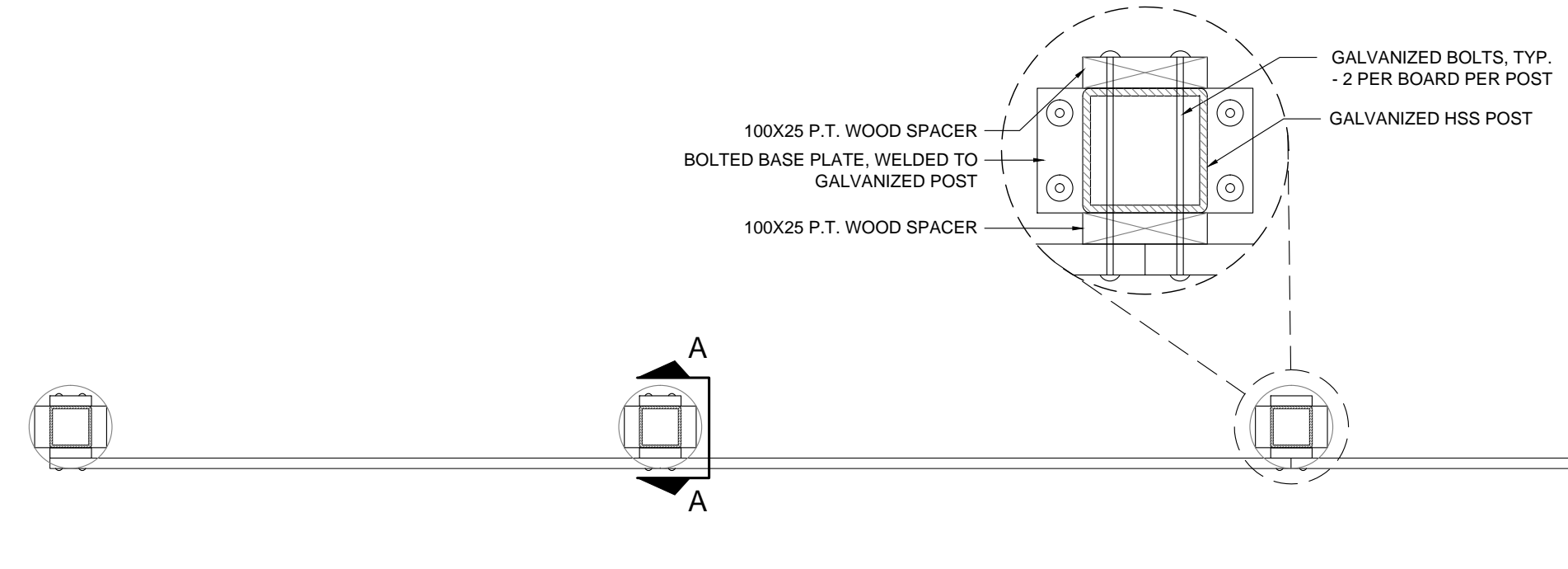

Dimensional	Metric (Nominal)
1"	= 25mm
1.5"	= 38mm
2"	= 50mm
4"	= 100mm
6"	= 150mm

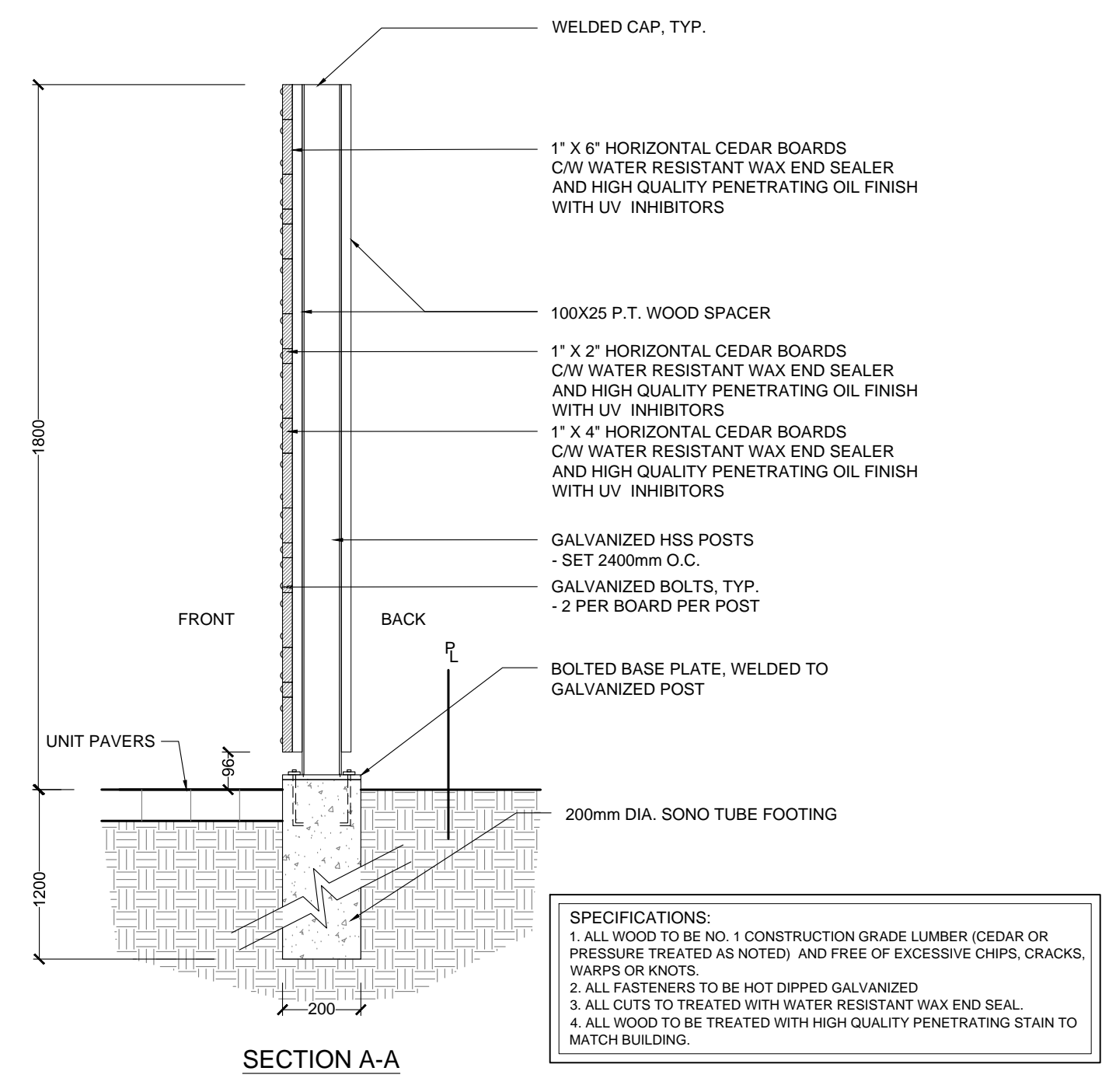

SECTION A-A

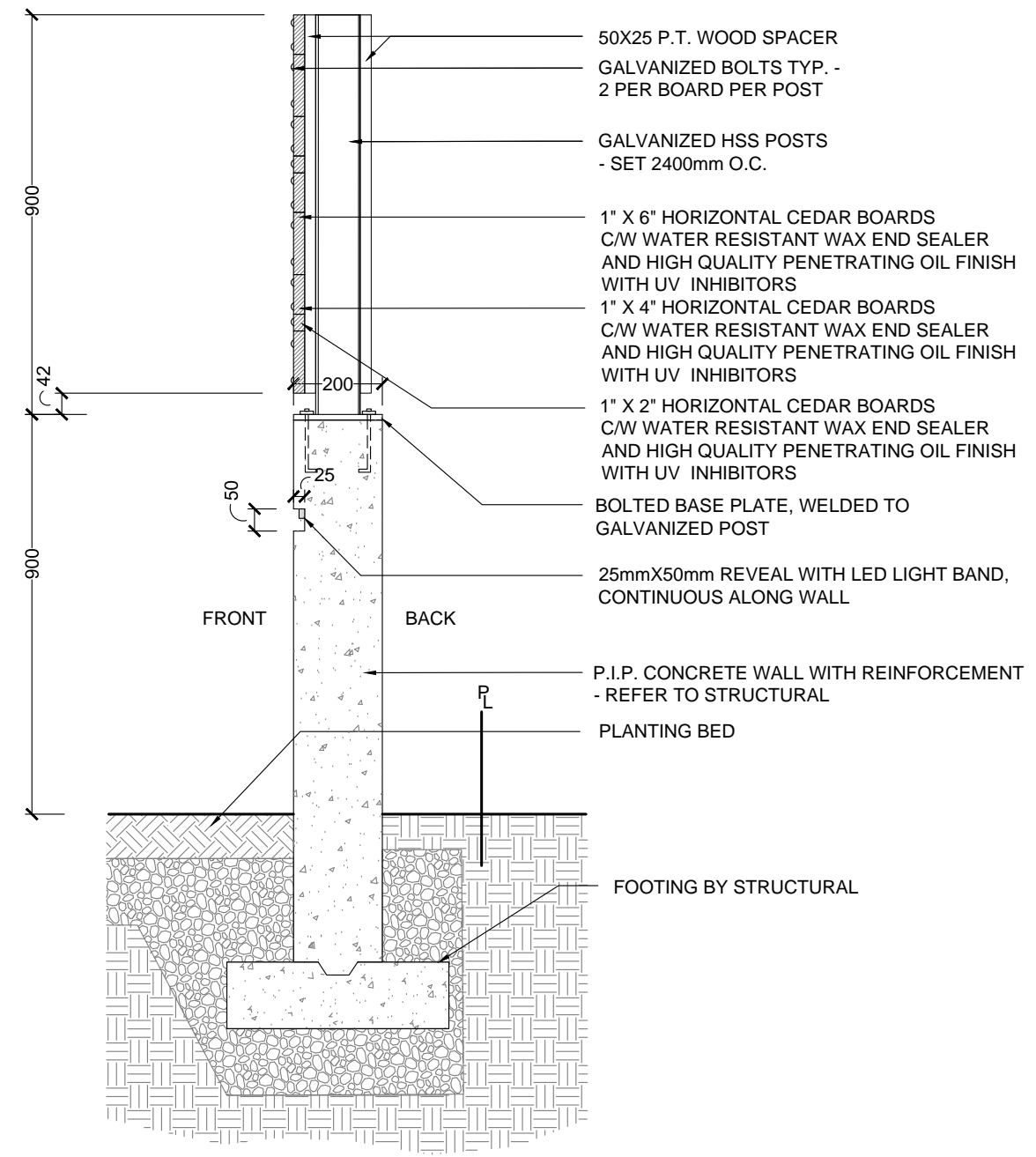

SECTION B-B

- SPECIFICATIONS:
1. ALL WOOD TO BE NO. 1 CONSTRUCTION GRADE LUMBER (CEDAR OR PRESSURE TREATED AS NOTED) AND FREE OF EXCESSIVE CHIPS, CRACKS, WARPS OR KNOTS.
  2. ALL FASTENERS TO BE HOT DIPPED GALVANIZED
  3. ALL CUTS TO BE TREATED WITH WATER RESISTANT WAX END SEAL.
  4. ALL WOOD TO BE TREATED WITH HIGH QUALITY PENETRATING STAIN TO MATCH BUILDING.

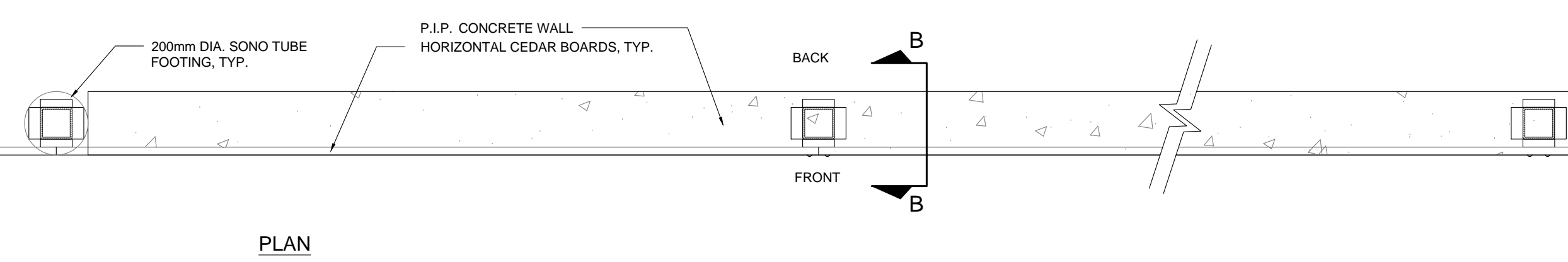

PLAN

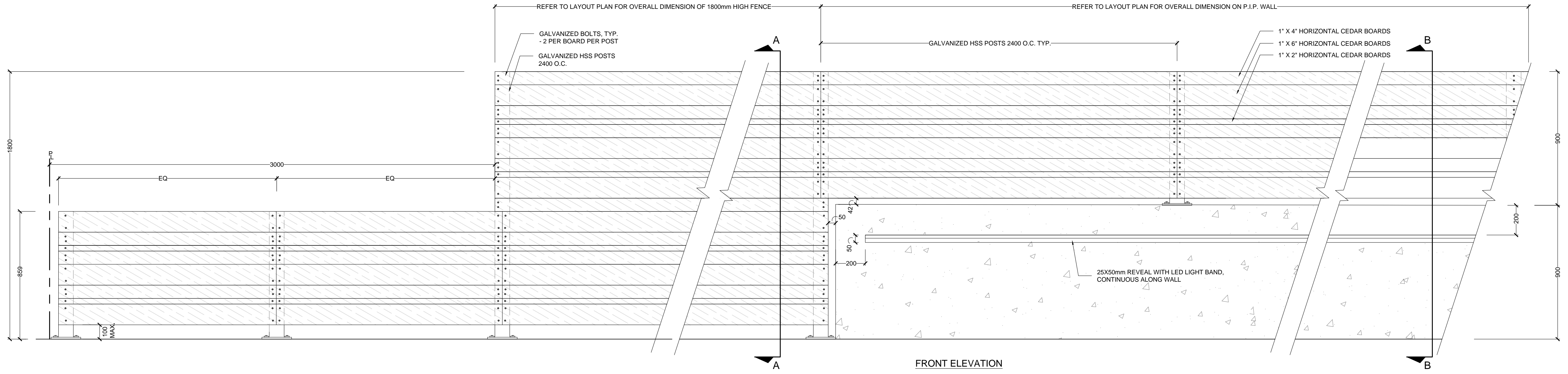

FRONT ELEVATION

3 CEDAR FENCE ALONG SOUTH PROPERTY LINE  
1:15

KEY PLAN  
N.T.S.



Legend

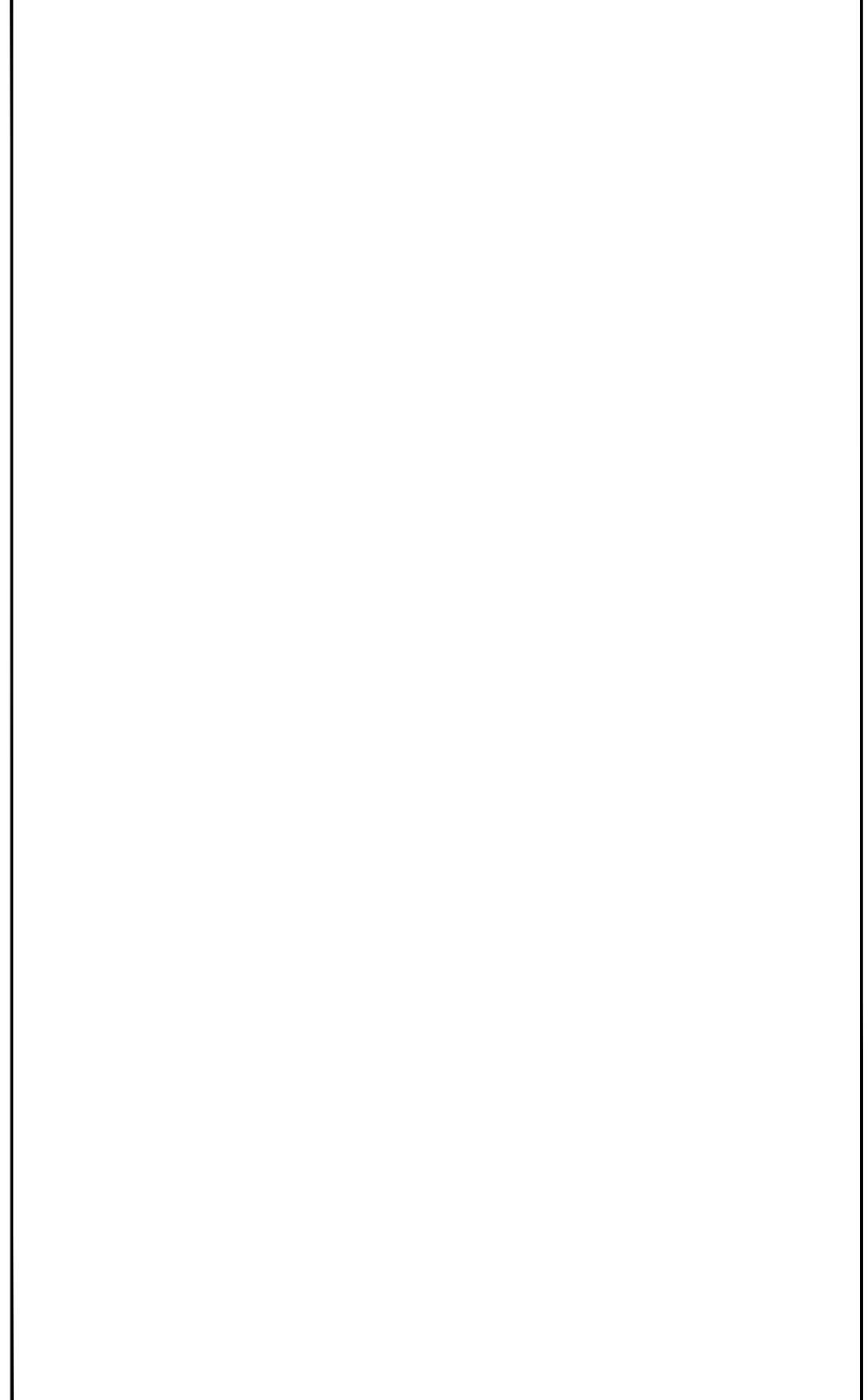

CONSTRUCTION  
DETAILS  
774 BRONSON AVENUE  
OTTAWA, ON.

ISSUED FOR SPA ONLY

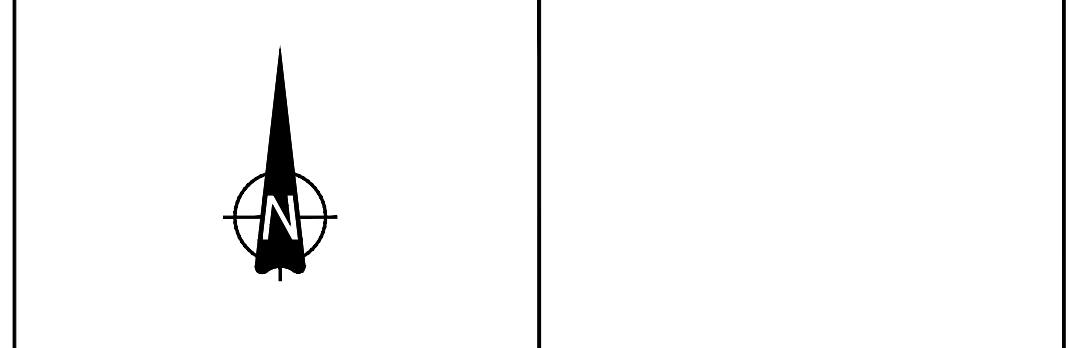

DATE	ISSUE	BY
Date	Issued for ????	??

NOT FOR  
CONSTRUCTION



25-72 Victoria Street South  
Richmond, Ontario M5C 4T5  
T 416 593-9852  
F 416 593-9843  
www.gspgroup.ca

Date: NOV. 23, 2015  
Scale: 1:150  
Drawn By: CZ  
Project No.: 15183

L3.00

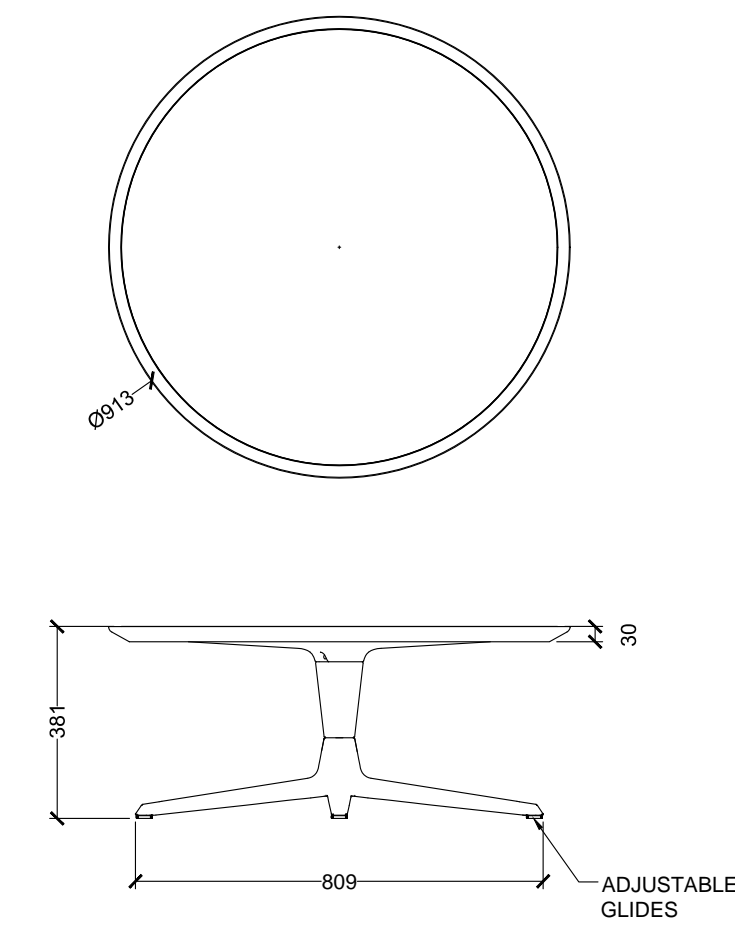

CONFIDENTIAL DRAWING INFORMATION CONTAINED HEREIN IS THE PROPERTY OF LANDSCAPE FORMS, INC. INTENDED USE IS LIMITED TO DESIGN PROFESSIONALS SPECIFYING LANDSCAPE FORMS, INC. PRODUCTS AND THEIR DIRECT CLIENTS. DRAWING IS NOT TO BE COPIED OR DISCLOSED TO OTHERS WITHOUT THE CONSENT OF LANDSCAPE FORMS, INC.

© 2014 LANDSCAPE FORMS, INC. ALL RIGHTS RESERVED

landscapiforms Drawing: CA203-01  
Dimensions are in inches (mm)  
Patent Pending

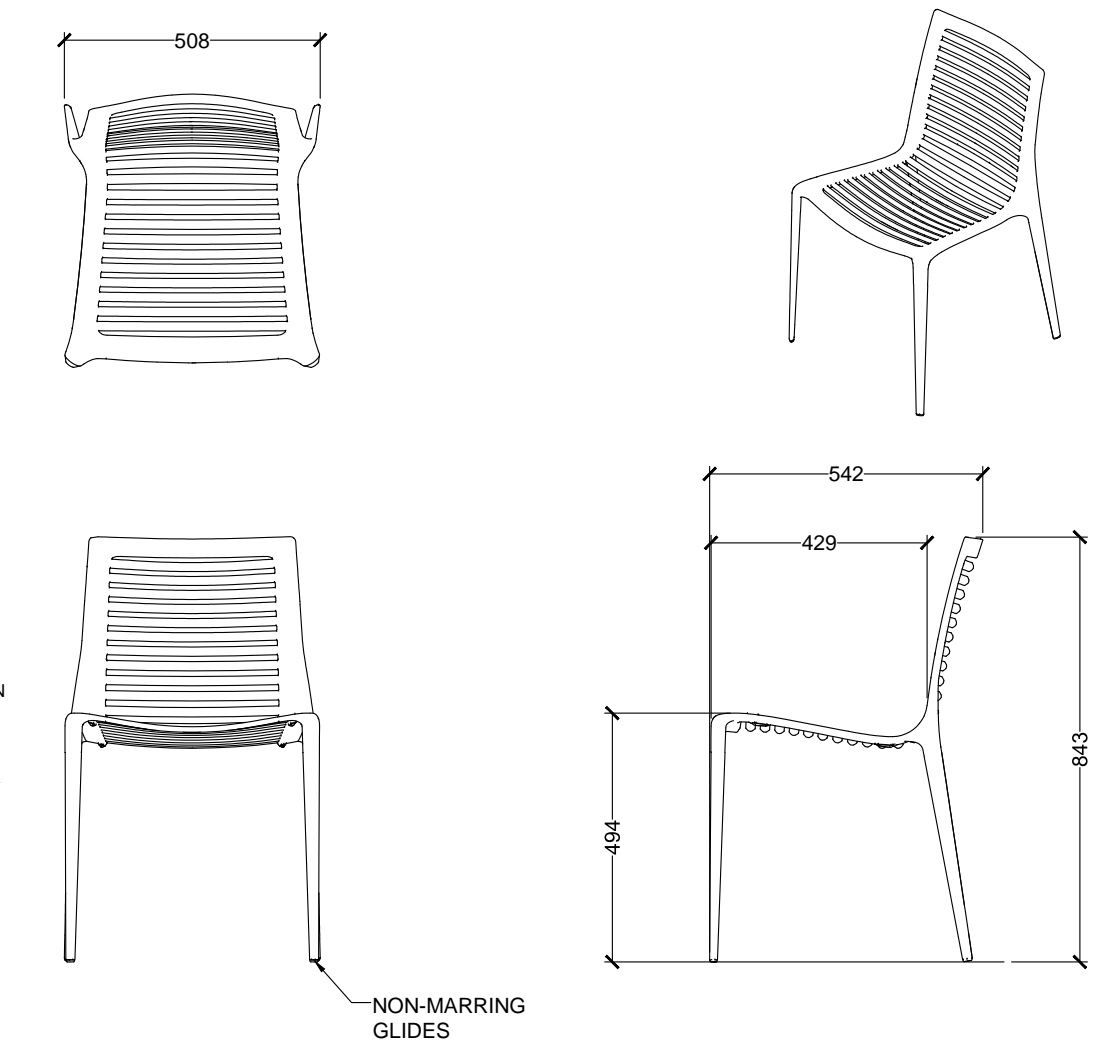

landscapiforms Drawing: CA103-01  
Dimensions are in inches (mm)  
Patent Pending

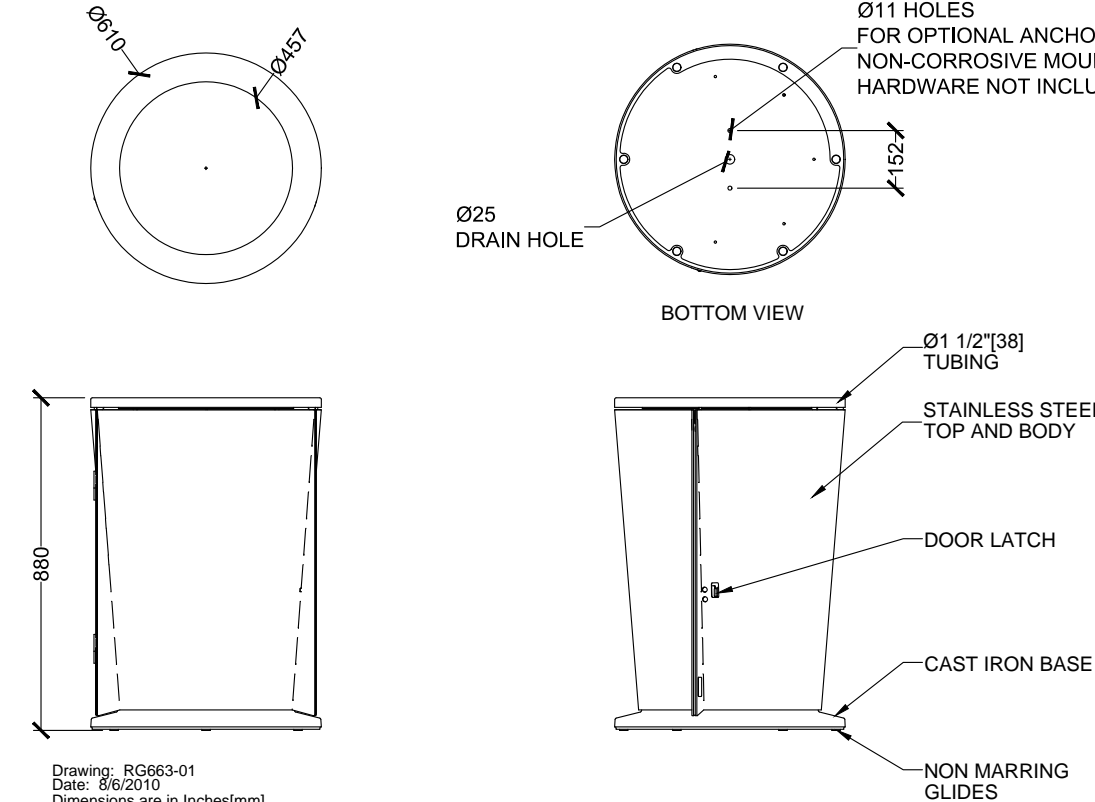

CONFIDENTIAL DRAWING INFORMATION CONTAINED HEREIN IS THE PROPERTY OF LANDSCAPE FORMS, INC. INTENDED USE IS LIMITED TO DESIGN PROFESSIONALS SPECIFYING LANDSCAPE FORMS, INC. PRODUCTS AND THEIR DIRECT CLIENTS. DRAWING IS NOT TO BE COPIED OR DISCLOSED TO OTHERS WITHOUT THE CONSENT OF LANDSCAPE FORMS, INC.

- NOTES:
1. ALL DIMENSIONS ARE IN MILLIMETERS UNLESS OTHERWISE NOTED.
  2. ALL FURNITURE LOCATIONS TO BE STAKED OUT AND/OR APPROVED BY THE LANDSCAPE ARCHITECT.
  3. FINISH: ALL STEEL COMPONENTS ARE RUSTPROOFED BEFORE POWDER COATING. TITANIUM POWDER COAT FINISH.
  4. INSTALLATION: INSTALL ONTO CONCRETE PAD PER MANUFACTURER'S INSTRUCTIONS WITH CORROSION AND VANDAL RESISTANT ANCHOR BOLTS.
  5. MANUFACTURER: LANDSCAPE FORMS, 431 LAKESIDE AVE, KALAMAZOO, MI 49048 TEL: 1-416-968-6655 CANADIAN SALES CONTACT: LEE DUNN TEL: 1-416-968-6655, FAX: 1-416-968-1944. EMAIL: LEE@LANDSCAPEFORMS.COM
  6. MODEL TYPE: LANDSCAPE FORMS TOP OPENING LITTER RECEPTACLE, FREESTANDING / SURFACE MOUNT, (OR EQUAL TO BE APPROVED BY LANDSCAPE ARCHITECT)
  7. REFER TO LANDSCAPE DRAWINGS FOR LAYOUT.

4 Trash Receptacle - LANDSCAPE FORMS 'Austin'  
Scale 1:20

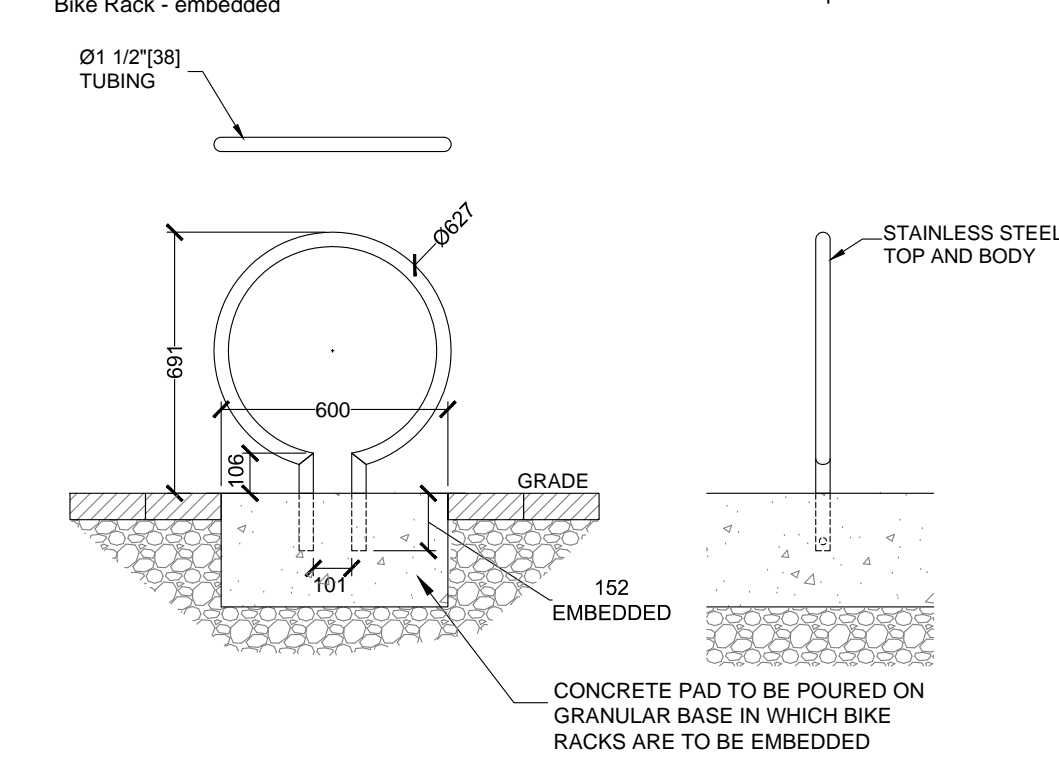

CONFIDENTIAL DRAWING INFORMATION CONTAINED HEREIN IS THE PROPERTY OF LANDSCAPE FORMS, INC. INTENDED USE IS LIMITED TO DESIGN PROFESSIONALS SPECIFYING LANDSCAPE FORMS, INC. PRODUCTS AND THEIR DIRECT CLIENTS. DRAWING IS NOT TO BE COPIED OR DISCLOSED TO OTHERS WITHOUT THE CONSENT OF LANDSCAPE FORMS, INC.

- NOTES:
1. ALL DIMENSIONS ARE IN MILLIMETERS UNLESS OTHERWISE NOTED.
  2. ALL FURNITURE LOCATIONS TO BE STAKED OUT AND/OR APPROVED BY THE LANDSCAPE ARCHITECT.
  3. MATERIALS: POWDER COATED, ALUMINUM TUBING. TITANIUM POWDER COAT FINISH.
  4. FINISH: ALL STEEL COMPONENTS ARE RUSTPROOFED BEFORE POWDER COATING. TITANIUM POWDER COAT FINISH.
  5. INSTALLATION: INSTALL ONTO CONCRETE PAD PER MANUFACTURER'S INSTRUCTIONS.
  6. MANUFACTURER: LANDSCAPE FORMS, 431 LAKESIDE AVE, KALAMAZOO, MI 49048 TEL: 1-416-968-6655 CANADIAN SALES CONTACT: LEE DUNN TEL: 1-416-968-6655, FAX: 1-416-968-1944. EMAIL: LEE@LANDSCAPEFORMS.COM
  7. MODEL TYPE: LANDSCAPE FORMS RING BIKE RACK, EMBEDDED, (OR EQUAL TO BE APPROVED BY LANDSCAPE ARCHITECT)
  8. REFER TO LANDSCAPE DRAWINGS FOR LAYOUT.

7 Bike Rack - LANDSCAPE FORMS 'Ring'  
Scale 1:20

1 PATIO TABLE AND CHAIRS  
1:15

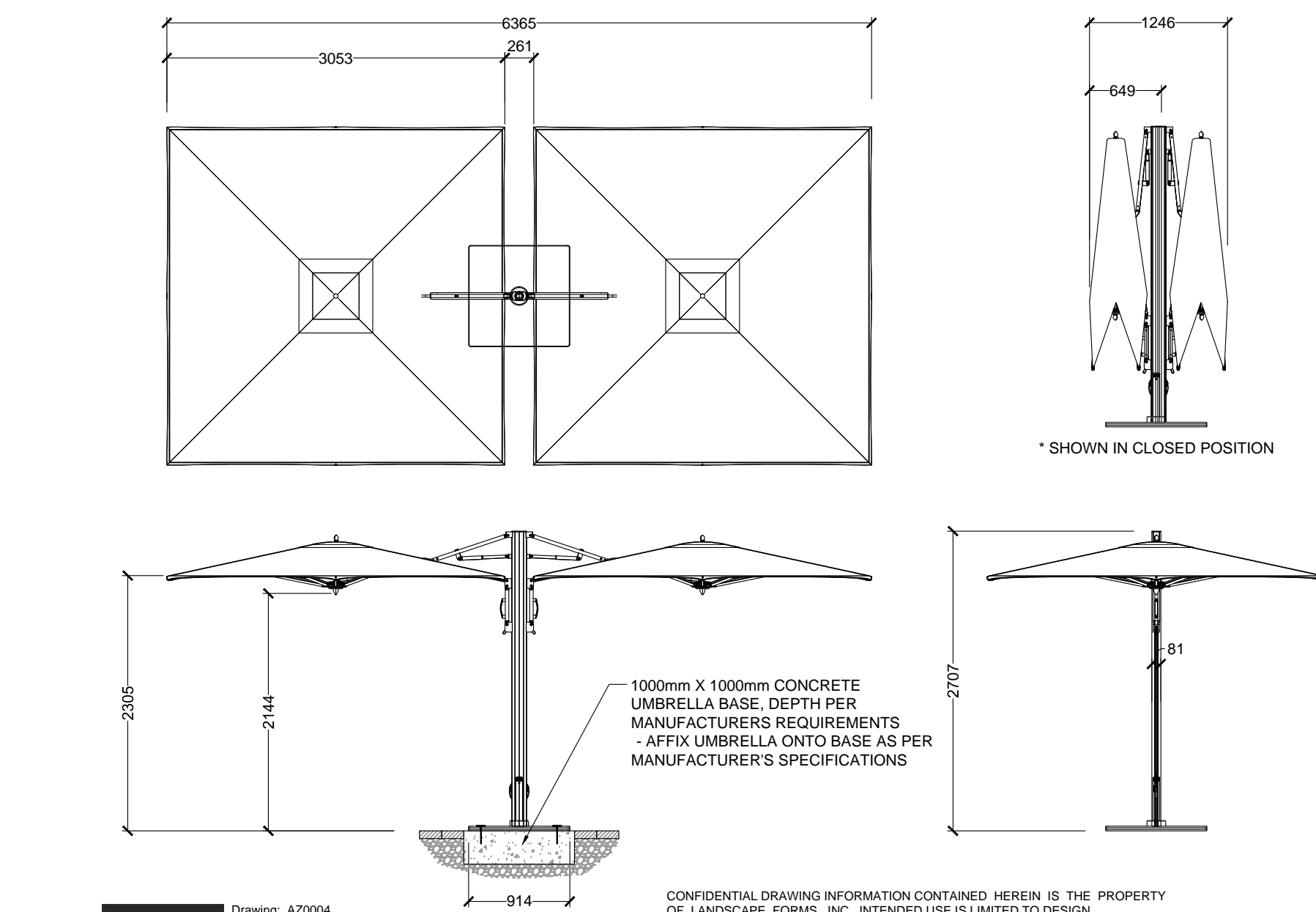

CONFIDENTIAL DRAWING INFORMATION CONTAINED HEREIN IS THE PROPERTY OF LANDSCAPE FORMS, INC. INTENDED USE IS LIMITED TO DESIGN PROFESSIONALS SPECIFYING LANDSCAPE FORMS, INC. PRODUCTS AND THEIR DIRECT CLIENTS. DRAWING IS NOT TO BE COPIED OR DISCLOSED TO OTHERS WITHOUT THE CONSENT OF LANDSCAPE FORMS, INC.

© 2014 LANDSCAPE FORMS, INC. ALL RIGHTS RESERVED

2 DUAL CANTILEVER UMBRELLA  
1:50

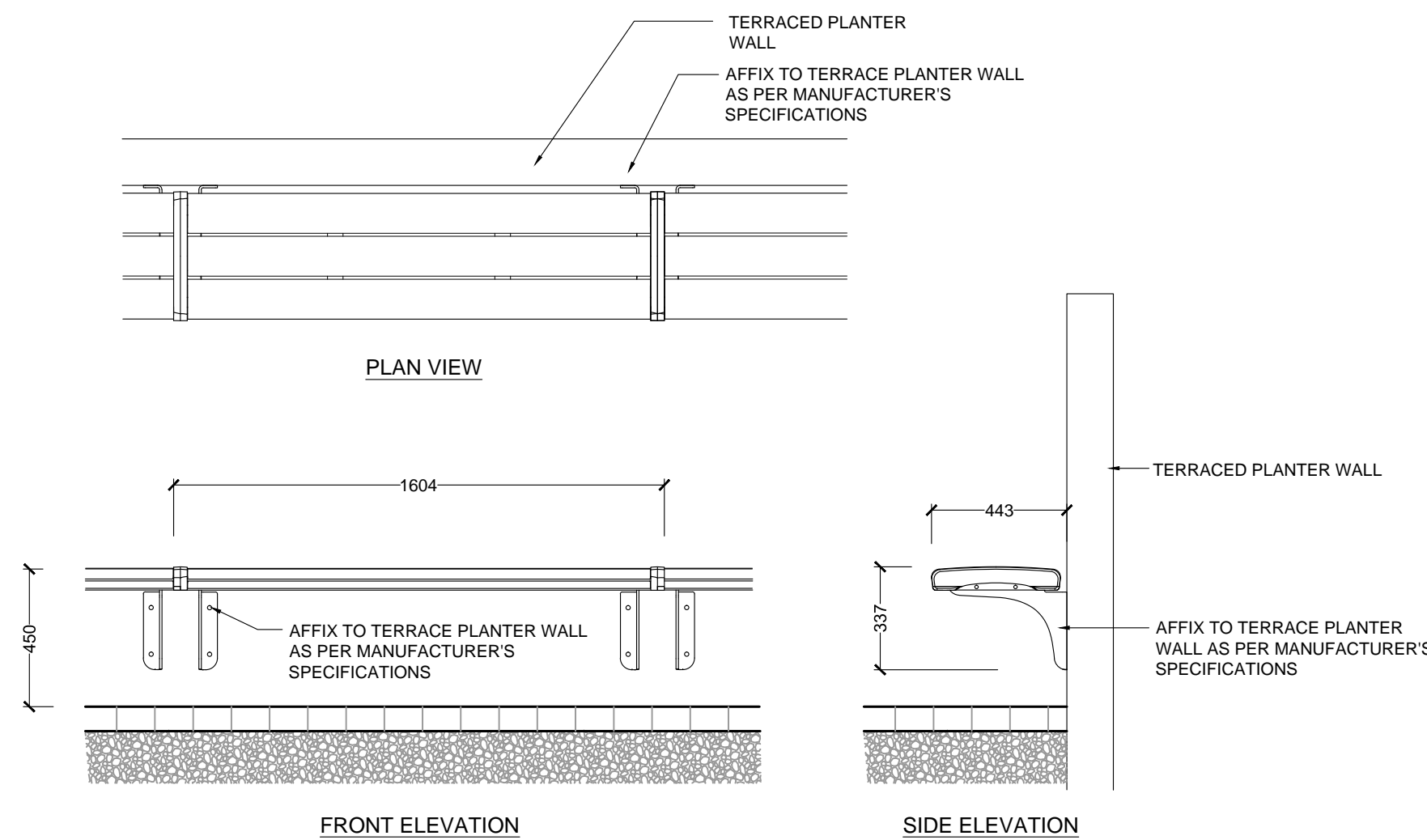

CANTILEVERED BENCH MODEL # MLB870-BCL-W.  
870: BACKLESS, CANTILEVER, ARMLESS, WOOD AVAILABLE THROUGH:



MAGLIN SITE FURNITURE INC. TEL: 800-716-5506  
WWW.MAGLIN.COM FAX: 877-260-5993

5 CANTILEVERED BENCH ON TERRACED PLANTER WALL  
1:20

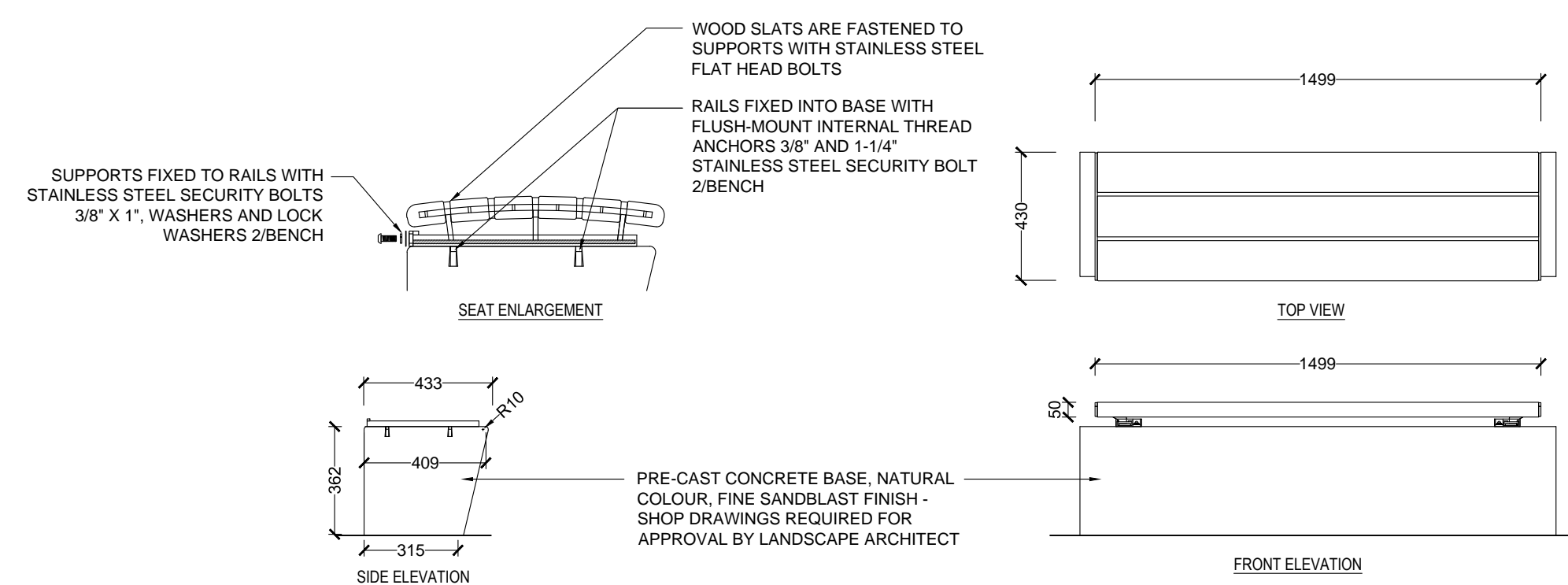

- NOTES:
1. INSTALLATION TO BE COMPLETED IN ACCORDANCE WITH MANUFACTURER'S SPECIFICATIONS.
  2. ALL DIMENSIONS ARE CONSIDERED TRUE AND REFLECT MANUFACTURER'S SPECIFICATIONS.
  3. DO NOT SCALE DRAWING.

EQUIPARC  
1001 JAMES-BRODIE  
ST-JEAN-SUR-RICHELIEU, QC J2X 0C1  
TOLL FREE: 1-800-363-9264  
PHONE: (450) 346-1882  
FAX: (866) 346-2538  
www.equiparc.com

3 BENCH TOPPER ON CONCRETE BLOCK  
1:20

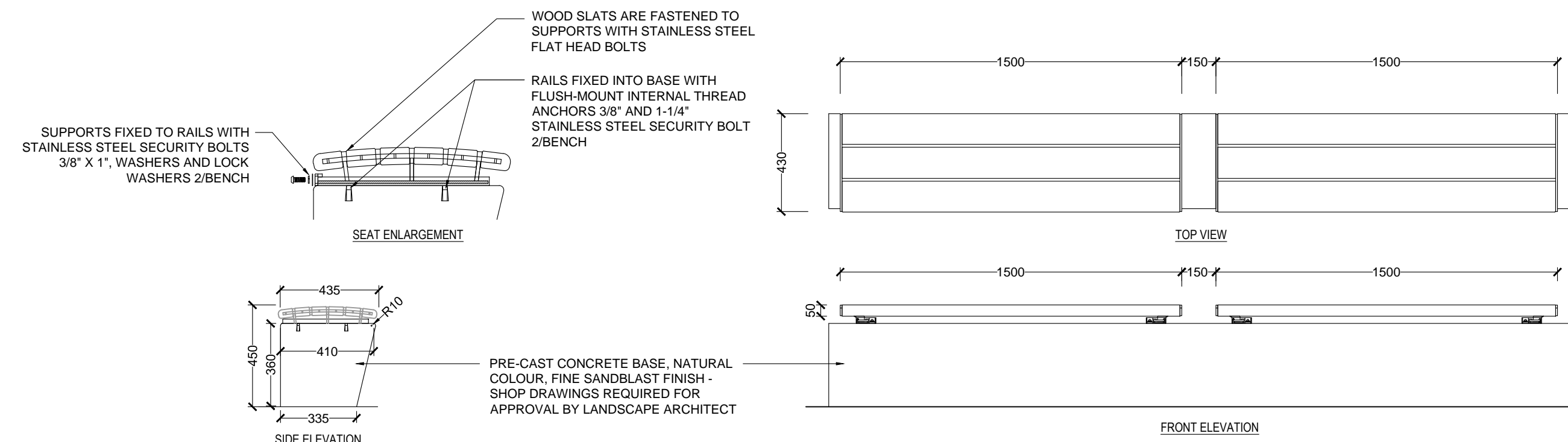

- NOTES:
1. INSTALLATION TO BE COMPLETED IN ACCORDANCE WITH MANUFACTURER'S SPECIFICATIONS.
  2. ALL DIMENSIONS ARE CONSIDERED TRUE AND REFLECT MANUFACTURER'S SPECIFICATIONS.
  3. DO NOT SCALE DRAWING.

EQUIPARC  
1001 JAMES-BRODIE  
ST-JEAN-SUR-RICHELIEU, QC J2X 0C1  
TOLL FREE: 1-800-363-9264  
PHONE: (450) 346-1882  
FAX: (866) 346-2538  
www.equiparc.com

6 BENCH TOPPERS ON CONCRETE BLOCK AT PLANTER  
1:20

CONSTRUCTION  
DETAILS  
774 BRONSON AVENUE  
OTTAWA, ON.

ISSUED FOR SPA ONLY

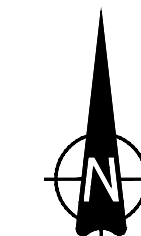

DATE	ISSUE	BY
Date	Issued for ????	??

NOT FOR  
CONSTRUCTION



2512 Victoria Street South  
Richmond, Ontario N9C 4Y7  
T 519 960 9852  
F 519 960 9843

102 Locke Street South, Suite 200  
Hamilton, Ontario L8P 4W7  
T 905 972 7177

