

CAIVAN
ABIC SITE

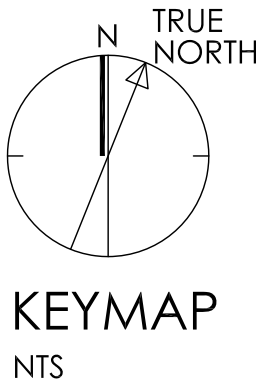

LIST OF DRAWINGS:

- L01 - SITE PLAN PHASE ONE
- L02 - PLANTING PLAN PHASE TWO
- D1 - DETAILS

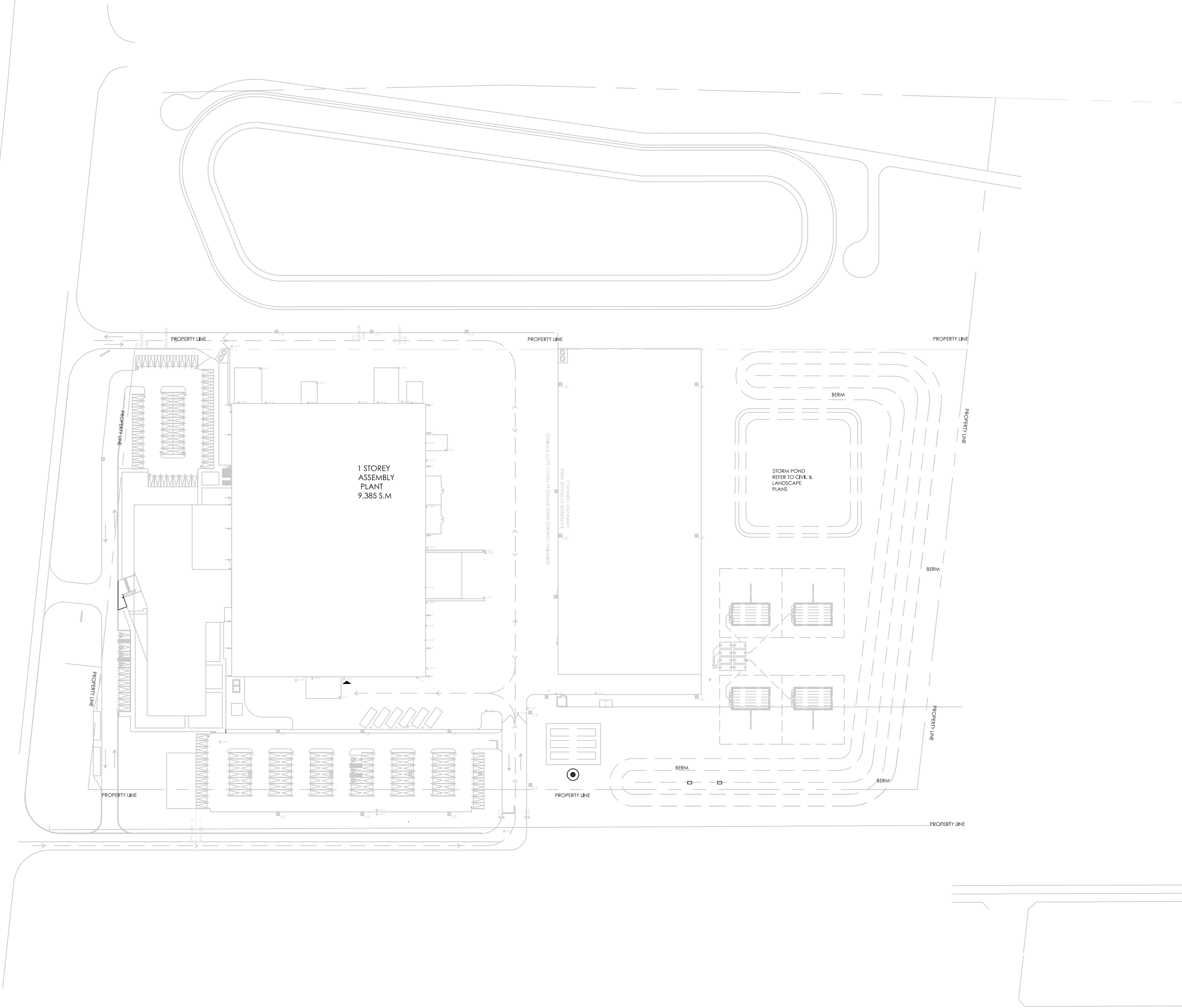

PLANT LIST PHASE 1

KEY	QTY.	BOTANICAL NAME	COMMON NAME	CAL/HT.	ROOT
CONIFEROUS TREES					
LD	41	LARIX DECIDUA	EUROPEAN LARCH	150cm	B&B
PS	32	PINUS STROBUS	WHITE PINE	150cm	B&B
DECIDUOUS TREES					
AR	11	ACER RUBRUM	RED MAPLE (mm)	70	B&B
MULTI-STEM TREE					
AC	18	AMALANCHIER CANADENSIS	SERVICEBERRY		1 GAL.
DECIDUOUS WHIPS					
CC	10	CARPINUS CAROLINIANA	BLUE-BEECH	150cm	B&B
QR	25	QUERCUS RUBRA	RED OAK	150cm	B&B
SA	17	SORBUS AMERICANA	MOUNTAIN-ASH	150cm	B&B
DECIDUOUS SHRUBS					
AS	27	AMELANCHIER SPP.	SERVICEBERRY		7 GAL.
Rt	10	RHUS TYPHINA	STAGHORN SUMAC		7 GAL.
Ea	79	EUONYMUS ALATUS 'COMPACTUS'	DWARF BURNING BUSH		7 GAL.

GENERAL NOTES:

1. ACER RUBRUM, AND QUERCUS RUBRA TO BE SPRING DUG SPECIMENS AND PLANTED IN THE SPRING ONLY.
2. THE LOCATION OF THE TREES SHOWN ON THIS PLAN IS APPROXIMATE AND SHALL NOT BE SCALED FROM THIS DRAWING. THIS PLAN MUST BE READ IN CONJUNCTION WITH THE APPROVED CUP AND CITY CROSS SECTIONS.
3. CONTRACTOR SHALL ENSURE THAT ALL UTILITY LOCATIONS ARE OBTAINED PRIOR TO ANY EXCAVATION FOR LANDSCAPING.
4. LOCATION OF ALL PLANT MATERIALS TO BE STAKED BY THE CONTRACTOR AND VERIFIED IN THE FIELD BY LANDSCAPE ARCHITECT PRIOR TO THE EXCAVATION OF PITS.
5. ALL PLANT MATERIAL SHALL BE NURSERY GROWN STOCK UNLESS OTHERWISE NOTED.
6. TREES TO HAVE A MINIMUM 1800 CLEAR STEM ABOVE GRADE.
7. PLACE SOD ON A MINIMUM 150mm TOPSOIL.
8. CONTRACTOR TO MAKE GOOD ALL EXISTING AREAS DAMAGED BY HIS WORK TO THE SATISFACTION OF THE LANDSCAPE ARCHITECT.
9. THE CITY WILL BE NOTIFIED IF ANY TREES CANNOT BE LOCATED OR PLANTED DUE TO CONFLICTS WITH UTILITIES OR DRIVEWAYS. THE REQUIRED TREES NOT PLANTED ARE SUBJECT TO TREE BANKING. THE FINAL NUMBER OF TREES TO BE BANKED WILL BE PROVIDED TO THE CITY FOLLOWING ALL PLANTINGS.
10. ALL PLANT MATERIAL SHALL BE WARRANTIED FOR TWO YEARS FROM THE DATE OF PERFORMANCE ACCEPTANCE AS DETERMINED BY THE CITY OF OTTAWA.
11. PERIODIC REVIEWS OF PLANTING SHALL BE CARRIED OUT BY THE LANDSCAPE ARCHITECT.
12. PLANTINGS TO BE STAKED FOR APPROVAL PRIOR TO CONSTRUCTION
13. CITY GRASS CUTTING RESPONSIBILITIES FOR SODDED AREAS SHALL BEGIN FOLLOWING PERFORMANCE ACCEPTANCE INSPECTION BY THE LANDSCAPE ARCHITECT AND THE CITY. ACCEPTANCE WILL BE PROVIDED ONLY IF:
 - SOD IS PROPERLY ESTABLISHED.
 - TURF IS FREE OF DEAD SPOTS AND WEEDS.
 - SODDED AREAS HAVE BEEN CUT WITHIN 24 HOURS PRIOR TO ACCEPTANCE INSPECTION.
 - MINIMUM OF 3 WEEKS HAVE ELAPSED FOLLOWING LAYING OF SOD.
 - A MINIMUM OF TWO CUTS HAVE TAKEN PLACE.
 - SODDED AREAS HAVE BEEN TOP-DRESSED, SEEDED AND AERATED
14. TREE PLANTING GUIDELINE / DISTANCES
 - 4.5m - STREET LIGHT
 - 2.5m - STREET LIGHT (SMALL TREE <7m MATURE HT.)
 - 3.0m - HYDRO TRANSFORMER
 - 1.5m - PATH, DRIVEWAY, FENCE, SOUND WALL
 - 4.5m - CONIFERS MINIMUM SETBACK FROM CURB
 - 2.5m - FIRE HYDRANTS
 - 2.0m - WATER SERVICE / CURB STOP
 - 1.0m - BELL / CABLE PEDESTALS
15. CURRENT CITY STANDARDS AND SPECIFICATIONS HAVE BEEN USED FOR THIS DRAWING

APPROVED
By Lily Xu at 11:48 am, Jul 14, 2020

LILY XU, MCIP, RPP

MANAGER, DEVELOPMENT REVIEW SOUTH
PLANNING, INFRASTRUCTURE & ECONOMIC
DEVELOPMENT DEPARTMENT, CITY OF OTTAWA

Contractor shall check all dimensions on the work and report any discrepancy to the Landscape Architect before proceeding. All drawings and specifications are the property of the Landscape Architect and must be returned at the completion of the work. This drawing is not to be used for construction until signed by the Landscape Architect.

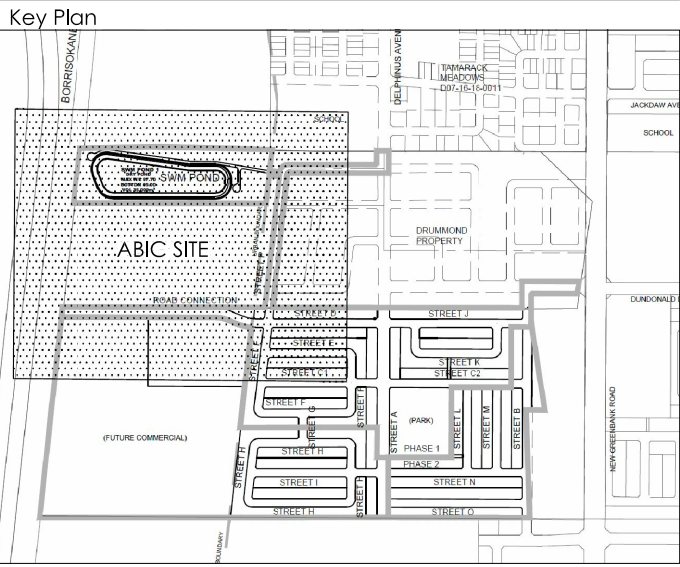

LEGEND

PROPERTY LINE	
PLANTING	
	DECIDUOUS STREET TREE
	DECIDUOUS WHIP
	CONIFEROUS TREE
	MULTI-STEM TREE
	STREET TREE
	DECIDUOUS SHRUB
	CONIFEROUS SHRUB
	FERN BED (114 m2)
	SEEDING (24,000 m2)
	GRASSES AND PERENNIALS (295 m2)
	GROUND COVER MIX (890 m2)
SURFACING	
	UNIT PAVING
	CONCRETE SIDEWALKS
PLANTING KEY	
	TREE SPECIES QUANTITY
	SHRUB SPECIES QUANTITY
DETAIL KEY	
	DETAIL NO. SHEET NO.

-		
5	Reissued for Second Submission	May, 25/20
4	Issued for Second Submission	Apr. 23/20
3	Re-design Issued for Client Review	Feb. 26/20
2	Issued for First Submission	Jan. 15/20
1	Issued for Client Review	Nov. 15/19
No.	Description	Date
Revision		
City Approval Stamp		

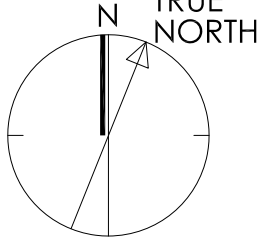

NAK
design strategies

1285 WELLINGTON STREET WEST, OTTAWA, ON K1T 3A8 CANADA
T 613.237.2345 F 613.237.6423 NAKDESIGNSTRATEGIES.COM

Project

ABIC SITE

Title

SITE PLAN - PHASE ONE

Date: NOV 2019
Scale: 1:600
Drawn: TY, JC
Checked:mc
Job #: 19-264

Sheet

L01

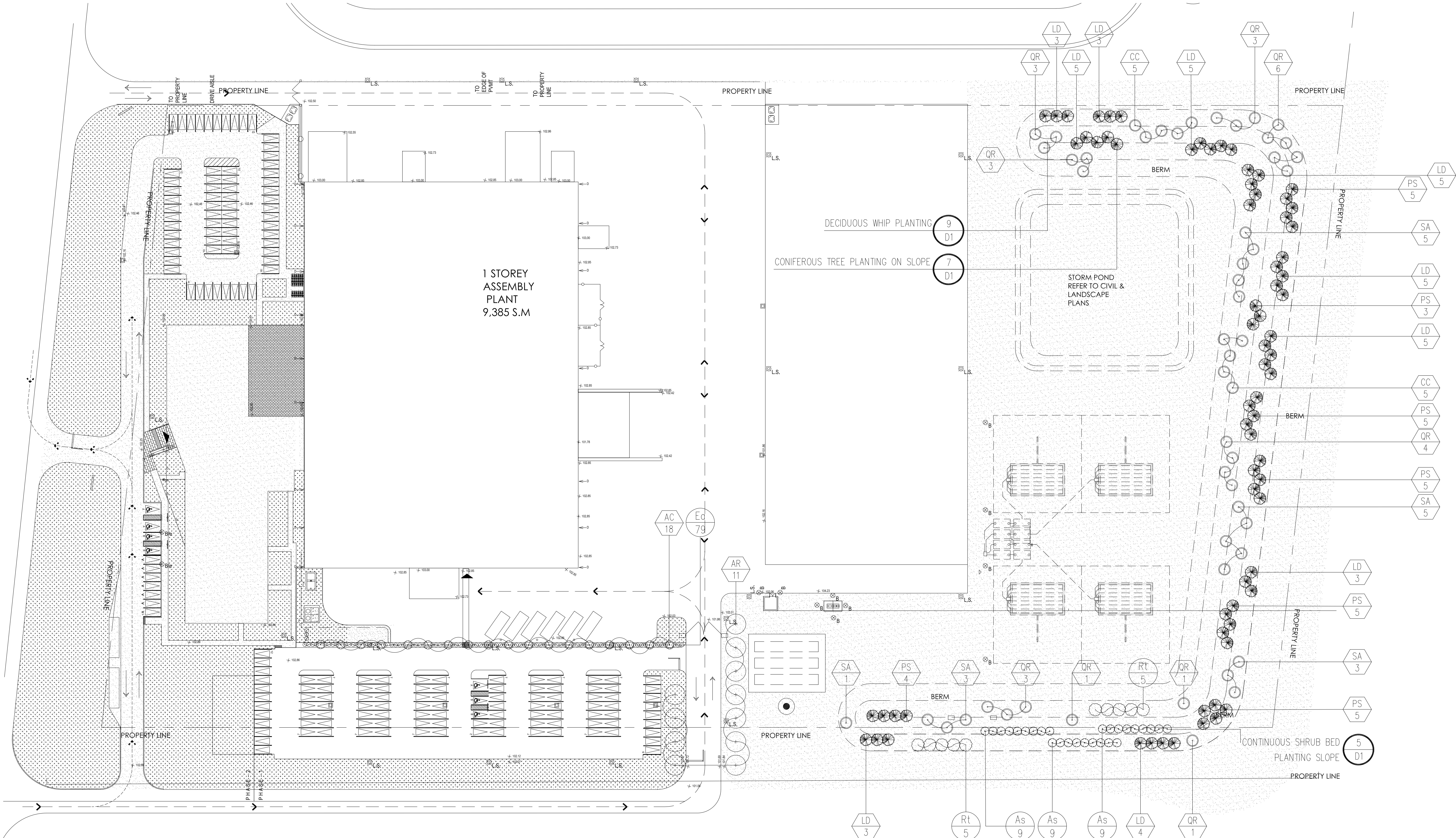

PLANT LIST PHASE 2

KEY	QTY.	BOTANICAL NAME	COMMON NAME	CAL./HT. (mm)	ROOT
DECIDUOUS TREES					
AR	30	ACER RUBRUM	RED MAPLE	70	B&B
QP	3	QUERCUS PALUSTRIS	PIN OAK	70	B&B
QR	15	QUERCUS RUBRA	RED OAK	70	B&B
MULTI-STEM TREES					
AG	23	ACER GINNALA 'FLAME'	AMUR MAPLE	60	B&B
CC	6	CARPINUS CAROLINIANA	BLUE-BEECH	60	B&B
PP	5	PRUNUS PADUS 'COLORATA'	BIRD CHERRY	60	B&B
SM	7	SYRINGIA MEYERI 'PALABIN'	AMUR MAPLE	60	B&B
DECIDUOUS SHRUBS					
SV	23	SYRINGA VULGARIS	COMMON LILAC	1500	W.B.
SM	6	SYRINGA MEYERI 'PALABIN'	DWARF KOREAN LILAC	15 GAL.	1 GAL.
VA	3	VIBURNUM ACERIFOLIUM	MAPLE-LEAVED VIBURNUM		

PLANT LIST B - GROUND COVER MIX

KEY	QTY.	BOTANICAL NAME	COMMON NAME	CAL./HT.	ROOT
CONIFEROUS SHRUB					
jh	172	JUNIPERUS HORIZONTALIS 'PRINCE OF WALES'	PRINCE OF WALES JUNIPER	3 GAL.	
tc	172	TAXUS CANADENSIS	CANADIAN YEW	3 GAL.	
GROUND COVER					
DI	200	BERBERIS THUNBERGII 'AUREA NANA'	DWARF GOLDEN BERRY	2 GAL.	
CS	200	CORNUS SERICEA 'KESEY'	KESEY RED OSIER DOGWOOD	3 GAL.	
PERENNIALS					
oa	500	ASTILBE ARENDsii	FALSE SPIREA	1 GAL.	
vs	500	VERONICA SPICATA 'GILES VAN HEES'	SPEEDWELL	PLUG.	

PLANT LIST C - FERNS

KEY	QTY.	BOTANICAL NAME	COMMON NAME	CAL./HT.	ROOT
FERNS					
qp	30	ADIANTUM PEDANTUM	NORTHERN MAIDENHAIR FERN	1 GAL.	
on	30	ATHYRIUM NIPONICUM 'PICTUM'	JAPANESE PAINTED FERN	1 GAL.	
ot	30	ATHYRIUM FILIX-FEMINA	LADY FERN	1 GAL.	
ms	30	MATTEUCCIA STRUTHIOPTERIS	OSTRICH FERN	1 GAL.	

PLANT LIST D - GRASS AND PERENNIALS MIX

KEY	QTY.	BOTANICAL NAME	COMMON NAME	CAL./HT.	ROOT
GRASSES/PERENNIALS					
om	290	ACHILLEA MILLEFOLIUM	COMMON YARROW	PLUG	
dc	290	DESCHAMPSIA CESPTIOSA	TUFTED HAIR GRASS	PLUG	
ig	345	IRIS GERMANICA	BEARDED IRIS	PLUG	
ms	75	MISCANTHUS SINENSIS 'SILBERFEDER'	SILVER FEATHER MAIDEN GRASS	PLUG	

GENERAL NOTES:

- ACER RUBRUM, AND QUERCUS RUBRA TO BE SPRING DUG SPECIMENS AND PLANTED IN THE SPRING ONLY.
- THE LOCATION OF THE TREES SHOWN ON THIS PLAN IS APPROXIMATE AND SHALL NOT BE SCALED FROM THIS DRAWING. THIS PLAN MUST BE READ IN CONJUNCTION WITH THE APPROVED CUP AND CITY CROSS SECTIONS.
- CONTRACTOR SHALL ENSURE THAT ALL UTILITY LOCATIONS ARE OBTAINED PRIOR TO ANY EXCAVATION FOR LANDSCAPING.
- LOCATION OF ALL PLANT MATERIALS TO BE STAKED BY THE CONTRACTOR AND VERIFIED IN THE FIELD BY LANDSCAPE ARCHITECT PRIOR TO THE EXCAVATION OF PITS.
- ALL PLANT MATERIAL SHALL BE NURSERY GROWN STOCK UNLESS OTHERWISE NOTED.
- TREES TO HAVE A MINIMUM 1800 CLEAR STEM ABOVE GRADE.
- PLACE SOD ON A MINIMUM 150mm TOPSOIL.
- CONTRACTOR TO MAKE GOOD ALL EXISTING AREAS DAMAGED BY HIS WORK TO THE SATISFACTION OF THE LANDSCAPE ARCHITECT.
- THE CITY WILL BE NOTIFIED IF ANY TREES CANNOT BE LOCATED OR PLANTED DUE TO CONFLICTS WITH UTILITIES OR DRIVEWAYS. THE REQUIRED TREES NOT PLANTED ARE SUBJECT TO TREE BANKING. THE FINAL NUMBER OF TREES TO BE BANKED WILL BE PROVIDED TO THE CITY FOLLOWING ALL PLANTINGS.
- ALL PLANT MATERIAL SHALL BE WARRANTIED FOR TWO YEARS FROM THE DATE OF PERFORMANCE ACCEPTANCE AS DETERMINED BY THE CITY OF OTTAWA.
- PERIODIC REVIEWS OF PLANTING SHALL BE CARRIED OUT BY THE LANDSCAPE ARCHITECT.
- PLANTINGS TO BE STAKED FOR APPROVAL PRIOR TO CONSTRUCTION
- CITY GRASS CUTTING RESPONSIBILITIES FOR SODDED AREAS SHALL BEGIN FOLLOWING PERFORMANCE ACCEPTANCE INSPECTION BY THE LANDSCAPE ARCHITECT AND THE CITY. ACCEPTANCE WILL BE PROVIDED ONLY IF:
 - SOD IS PROPERLY ESTABLISHED.
 - TURF IS FREE OF DEAD SPOTS AND WEEDS.
 - SODDED AREAS HAVE BEEN CUT WITHIN 24 HOURS PRIOR TO ACCEPTANCE INSPECTION.
 - MINIMUM OF 3 WEEKS HAVE ELAPSED FOLLOWING LAYING OF SOD.
 - A MINIMUM OF TWO CUTS HAVE TAKEN PLACE.
 - SODDED AREAS HAVE BEEN TOP-DRESSED, SEEDED AND AERATED
- TREE PLANTING GUIDELINE / DISTANCES
 - 4.5m - STREET LIGHT
 - 2.5m - STREET LIGHT (SMALL TREE <7m MATURE HT.)
 - 3.0m - HYDRO TRANSFORMER
 - 1.5m - PATH, DRIVEWAY, FENCE, SOUND WALL
 - 4.5m - CONIFERS MINIMUM SETBACK FROM CURB
 - 2.5m - FIRE HYDRANTS
 - 2.0m - WATER SERVICE / CURB STOP
 - 1.0m - BELL / CABLE PEDESTALS
- CURRENT CITY STANDARDS AND SPECIFICATIONS HAVE BEEN USED FOR THIS DRAWING

APPROVED
By Lily Xu at 11:49 am, Jul 14, 2020

LILY XU, MCIP, RPP
MANAGER, DEVELOPMENT REVIEW SOUTH
PLANNING, INFRASTRUCTURE & ECONOMIC
DEVELOPMENT DEPARTMENT, CITY OF OTTAWA

Contractor shall check all dimensions on the work and report any discrepancy to the Landscape Architect before proceeding. All drawings and specifications are the property of the Landscape Architect and must be returned at the completion of the work. This drawing is not to be used for construction until signed by the Landscape Architect.

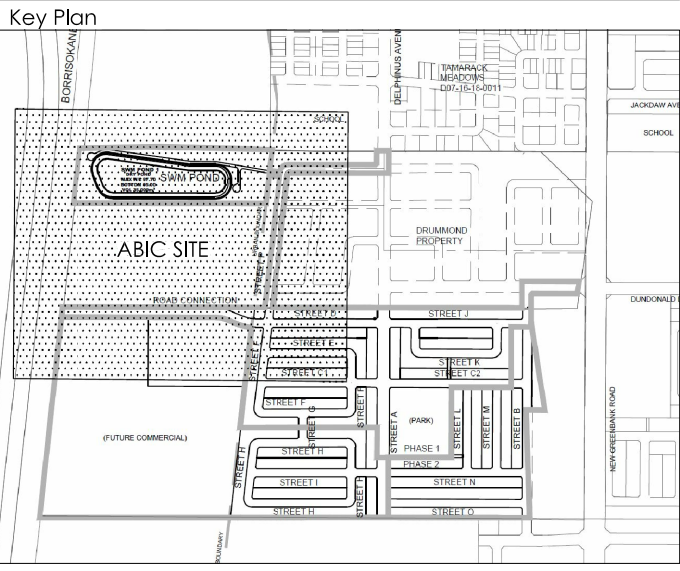

LEGEND

PROPERTY LINE	
PLANTING	
	DECIDUOUS STREET TREE
	DECIDUOUS WHIP
	CONIFEROUS TREE
	MULTI-STEM TREE
	STREET TREE
	DECIDUOUS SHRUB
	CONIFEROUS SHRUB
	FERN BED (114 m2)
	SEEDING (24,000 m2)
	GRASSES AND PERENNIALS (295 m2)
	GROUND COVER MIX (890 m2)
SURFACING	
	UNIT PAVING
	CONCRETE SIDEWALKS
PLANTING KEY	
	TREE SPECIES
	QUANTITY
	SHRUB SPECIES
	QUANTITY
DETAIL KEY	
	DETAIL NO.
	SHEET NO.

-		
-		
5	Reissued for Second Submission	May, 25/20
4	Issued for Second Submission	Apr. 23/20
3	Re-design Issued for Client Review	Feb. 26/20
2	Issued for First Submission	Jan. 15/20
1	Issued for Client Review	Nov. 15/19
No.	Description	Date
Revision		
City Approval Stamp		

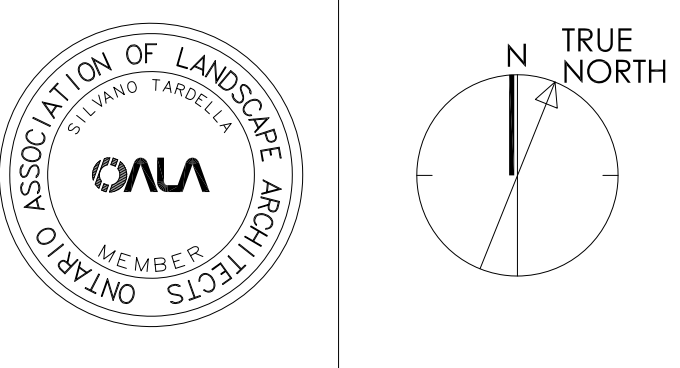

NAK
design strategies
1285 WELLINGTON STREET WEST, OTTAWA, ON K1Y 3A8 CANADA
T 613.237.2345 F 613.237.6423 NAKDESIGNSTRATEGIES.COM

Project

ABIC SITE

Title

LANDSCAPE - PHASE TWO

Date: NOV 2019	Sheet
Scale: 1:600	
Drawn: TY, JC	
Checked:mc	
Job #: 19-264	

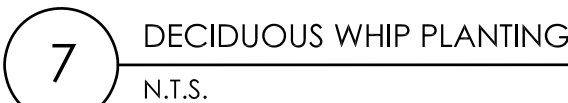
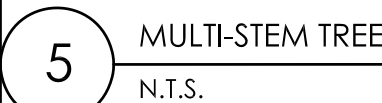

-		
-		
5	Reissued for Second Submission	May, 25/2019
4	Issued for Second Submission	Apr. 23/2019
3	Re-design Issued for Client Review	Feb. 26/2019
2	Issued for First Submission	Jan. 15/2019
1	Issued for Client Review	Nov. 15/1919
No.	Description	Date
Revision		
City Approval Stamp		



NAK 
design strategies

1285 WELLINGTON STREET WEST, OTTAWA, ON K1Y 3A8 CANADA
T 613.237.2345 F 613.237.6423 NAKDESIGNSTRATEGIES.COM

ABIC SITE

DETAILS

Date: NOV. 06/19
Scale: N.T.S.
Drawn: JC
Checked MC/JH
Job #: 19-233

Sheet

D1