

VETERANS MEMORIAL HIGHWAY 416

BORRISOKANE ROAD

350.60

55.02

307.84

N 58°45'30" E (P6&MEAS) N 58°46'30" E (P4)
159.58 (P4&MEAS) 159.61 (P6)

N 64°30'35" E (P6&MEAS)

196.78 (P6&MEAS)

18.55 (P6&MEAS)

312.72
97.40 (P6&SET)

N 60°06'40" E

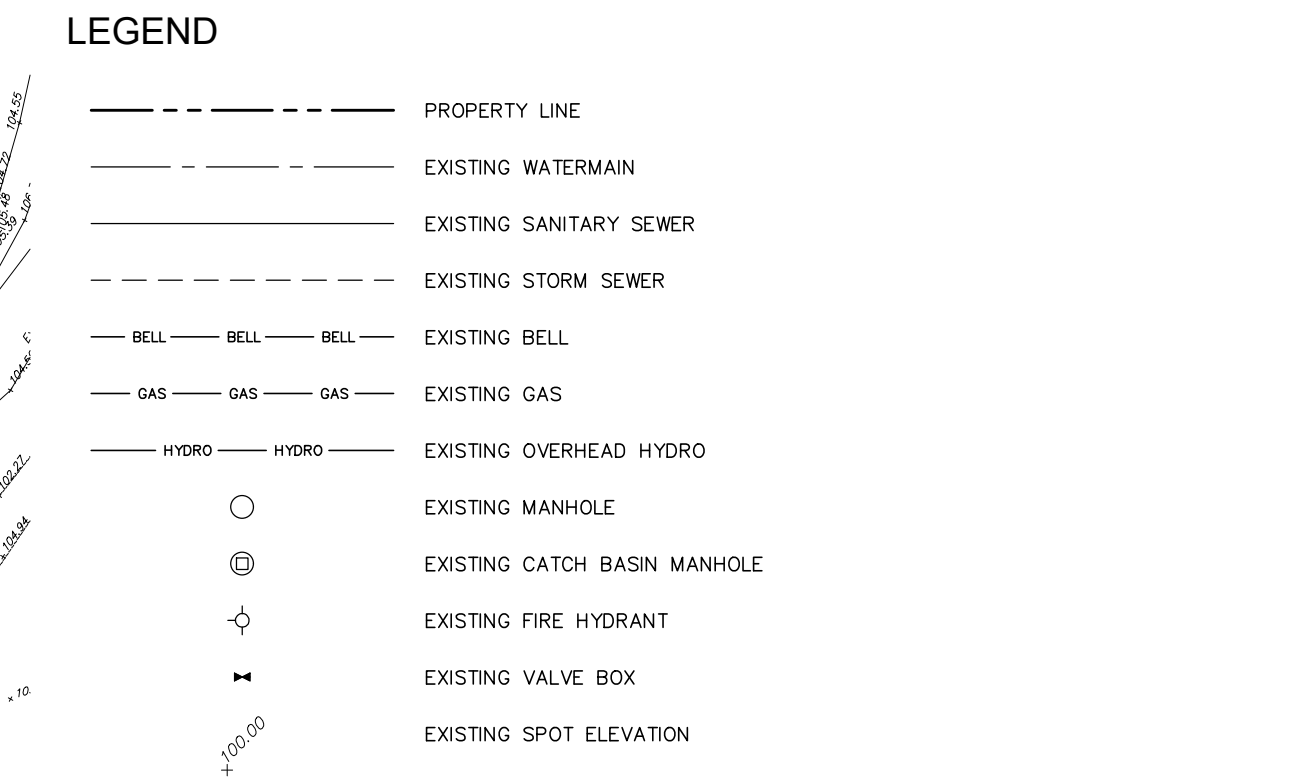
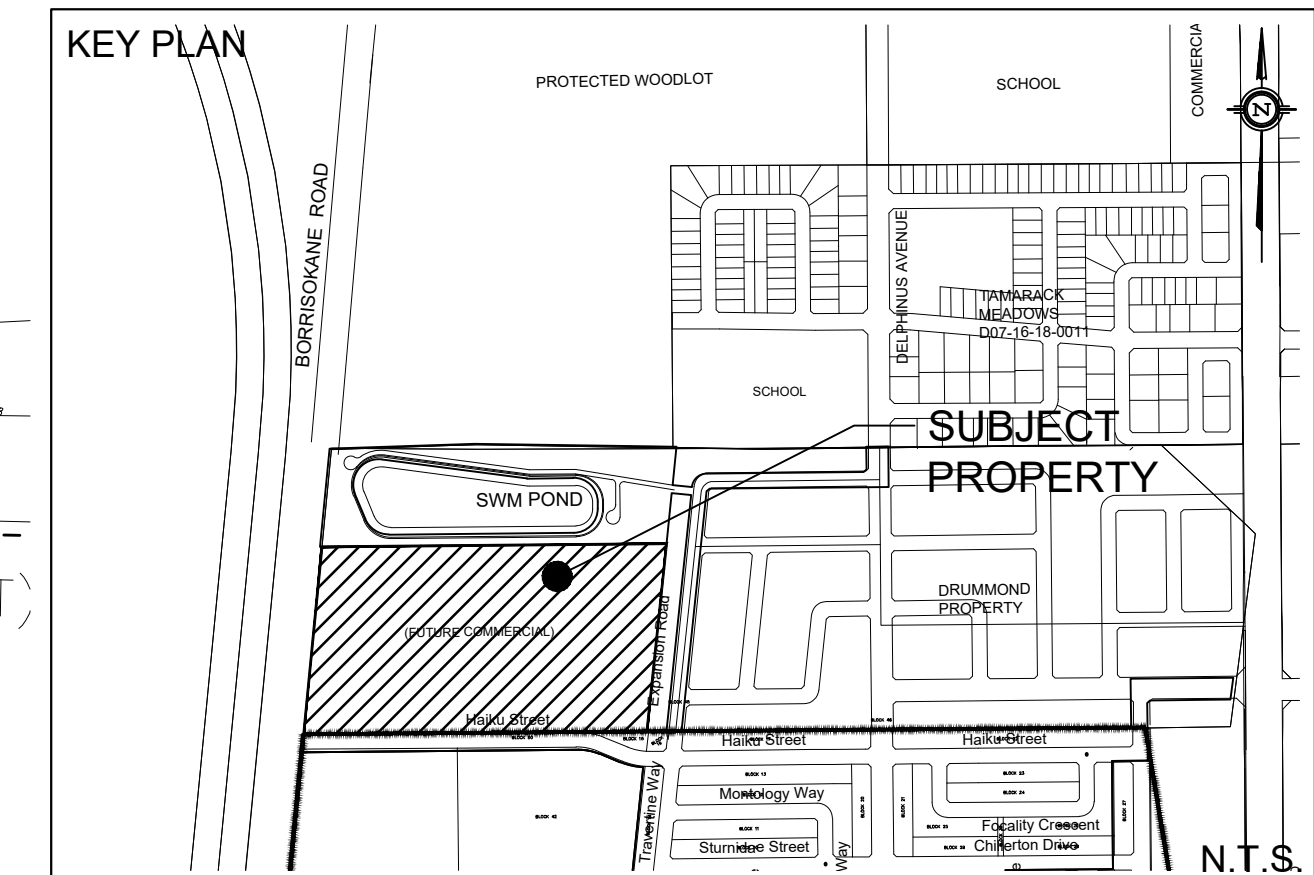

NOT FOR CONSTRUCTION

TOPOGRAPHIC INFORMATION
TOPOGRAPHIC INFORMATION PROVIDED BY J.D. BARNES LIMITED
PROJ. NO. 18-10-145-00
DATED JULY 10, 2019

SITE PLAN INFORMATION
SITE PLAN PROVIDED BY FIGURR COLLECTIF D'ARCHITECTES
PROJ. NO. 19-1134
DATED MAY 25, 2020

GEOTECHNICAL STUDY
GEOTECHNICAL RECOMMENDATIONS PROVIDED BY PATERSON GROUP
PROJ. NO. PG5155-1
DATED FEBRUARY 10, 2020

SITE SERVICING AND STORMWATER MANAGEMENT STUDY
SERVICING AND STORMWATER MANAGEMENT RECOMMENDATIONS PROVIDED BY DSEL
PROJ. NO. 19-1134
DATED JULY 2020

BENCH MARK
LOCATION: CONCRETE ROAD BRIDGE OVER JOCK RIVER (N45°15'39", W75°44'06")
ELEVATIONS SHOWN ON THIS PLAN ARE RELATED TO GEODETIC DATUM AND ARE DERIVED FROM THE MUNICIPALITY BENCHMARK No. 001196403710 HAVING A PUBLISHED ELEVATION OF 91.724 METERS

No.	BY	YY.MM.DD	DESCRIPTION
6	A.J.G.	20.07.09	ISSUED FOR MUNICIPAL REVIEW
5	A.J.G.	20.06.24	ISSUED FOR MUNICIPAL REVIEW
4	A.J.G.	20.06.12	ISSUED FOR MUNICIPAL REVIEW
3	A.J.G.	20.05.28	ISSUED FOR MUNICIPAL REVIEW
2	A.J.G.	20.04.24	ISSUED FOR MUNICIPAL REVIEW
1	A.J.T.	20.01.15	ISSUED FOR MUNICIPAL REVIEW

APPROVED
By Lily Xu at 11:40 am, Jul 14, 2020

Lily Xu

LILY XU, MCIP, RPP
MANAGER, DEVELOPMENT REVIEW SOUTH
PLANNING, INFRASTRUCTURE & ECONOMIC
DEVELOPMENT DEPARTMENT, CITY OF OTTAWA

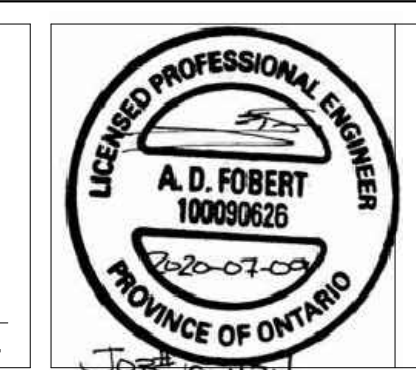

PROJECT No. 19-1134

EXISTING CONDITIONS PLAN
3713 BORRISOKANE ROAD

CAIVAN GREENBANK NORTH INC. 2934 Baseline Road, Suite 302
Ottawa, Ontario, K2H 1B2
Tel. (613) 518-1864

DSEL
david schaeffer engineering ltd
120 Ibr Road Unit 103
Stittsville, Ontario, K2S 1E9
Tel. (613) 836-0856
Fax. (613) 836-7183
www.DSEL.ca

DESIGNED BY: A.J.G.	CHECKED BY: R.D.F.	DRAWING NO. EX-1	SHEET NO. 1 of 7
SCALE: 1:750	DATE: DECEMBER 2019		

CITY PLAN No.: #18112
D07-12-20-0002