

Copyright Reserved

The Contractor shall verify and be responsible for all dimensions. DO NOT scale the drawing - any errors or omissions shall be reported to Stantec without delay.
The Copyrights to all designs and drawings are the property of Stantec. Reproduction or use for any purpose other than that authorized by Stantec is forbidden.

Legend

- AREA ID
- RUNOFF COEFFICIENT
- STORM DRAINAGE AREA ha.
- STORM DRAINAGE BOUNDARY
- EX. OFFSITE AREA ID
- EX. OFFSITE RUNOFF COEFFICIENT
- EX. OFFSITE STORM DRAINAGE AREA ha.
- EX. OFFSITE STORM DRAINAGE BOUNDARY
- MAXIMUM STATIC PONDING LIMITS
- DIRECTION OF OVERLAND FLOW
- PROPOSED STORM SEWER
- PROPOSED CATCHBASIN MANHOLE
- PROPOSED CATCHBASIN
- CIRCULAR ORIFICE (SEE SEE ICD TABLE SD-1)
- EXISTING STORM SEWER
- EXISTING CATCHBASIN
- THERMAL INSULATION ON STORM SEWER WHERE COVER IS LESS THAN 1.5m. THERMAL INSULATION ON WATERMAIN WHERE COVER IS LESS THAN 2.4m AS PER W22.

Notes

SCHEDULE OF INLET CONTROL DEVICES				
AREA ID	STRUCTURE ID	ICD TYPE	100YR HEAD (m)	100YR FLOW (L/s)
POND 1	STM OUTLET	115mmØ ORIFICE	1.58	35.3
POND 2	CBMH 4	102mmØ ORIFICE	2.09	29.9

SCHEDULE OF ROOF RELEASE RATES				
BUILDING	DRAIN TYPE	# DRAINS	100YR Head (m)	100YR RELEASE RATE (L/s)
BUILDING	WATTS ACCUFLOW	10	0.15	12.3

9	REVISED PER CITY COMMENTS	MJS	DT	26.06.17
8	REVISED PER CITY COMMENTS	MJS	DT	26.03.24
7	REVISED PER CITY COMMENTS	MJS	DT	25.11.28
6	REVISED PER NEW SITE PLAN	MJS	DT	25.07.11
5	REVISED AS PER SITE PLAN AND CITY COMMENTS	MJS	DT	24.12.02
4	REVISED AS PER SITE PLAN AND CITY COMMENTS	MJS	DT	24.04.08
3	REVISED WATERMAIN SEE	MJS	DT	22.04.08
2	REVISED AS PER CITY COMMENTS	MJS	TR	21.05.07
2	ISSUED FOR REVIEW	MJS	TR	20.11.23

Revision By Appd. YY.MM.DD

File Name:	160401570.DB	MJS	ANP	MJS	20.08.17
		Dwn.	Chkd.	Dgn.	YY.MM.DD

Permit-Seal

Client/Project

BRIGIL
100 STEACIE DRIVE
OTTAWA, ON

Title

STORM DRAINAGE AREA PLAN

Project No.	160401570	Scale	0 5 15 25m 1:500
Drawing No.	SD-1	Sheet	8 of 12
		Revision	9

PLANNING 18327

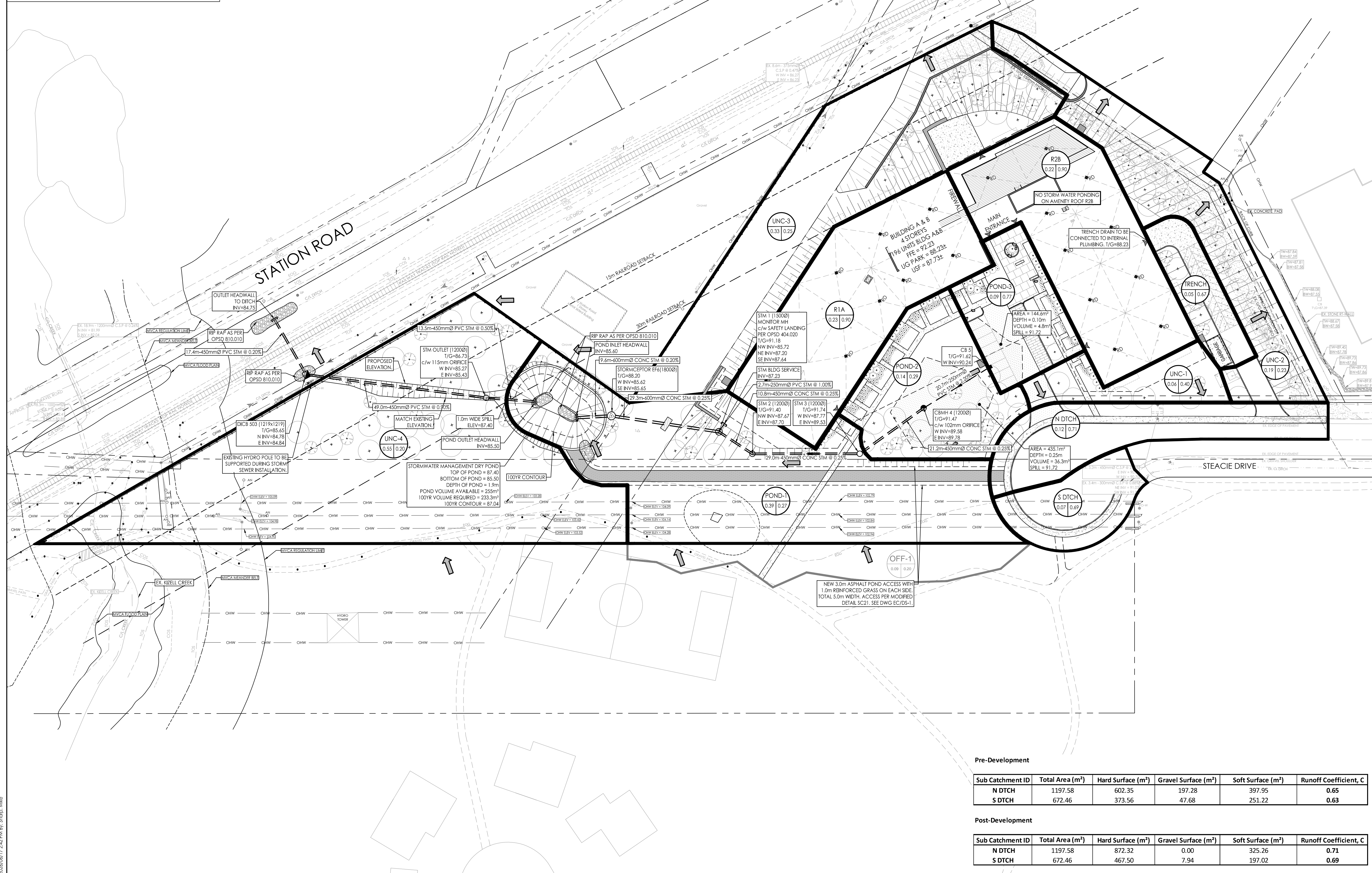
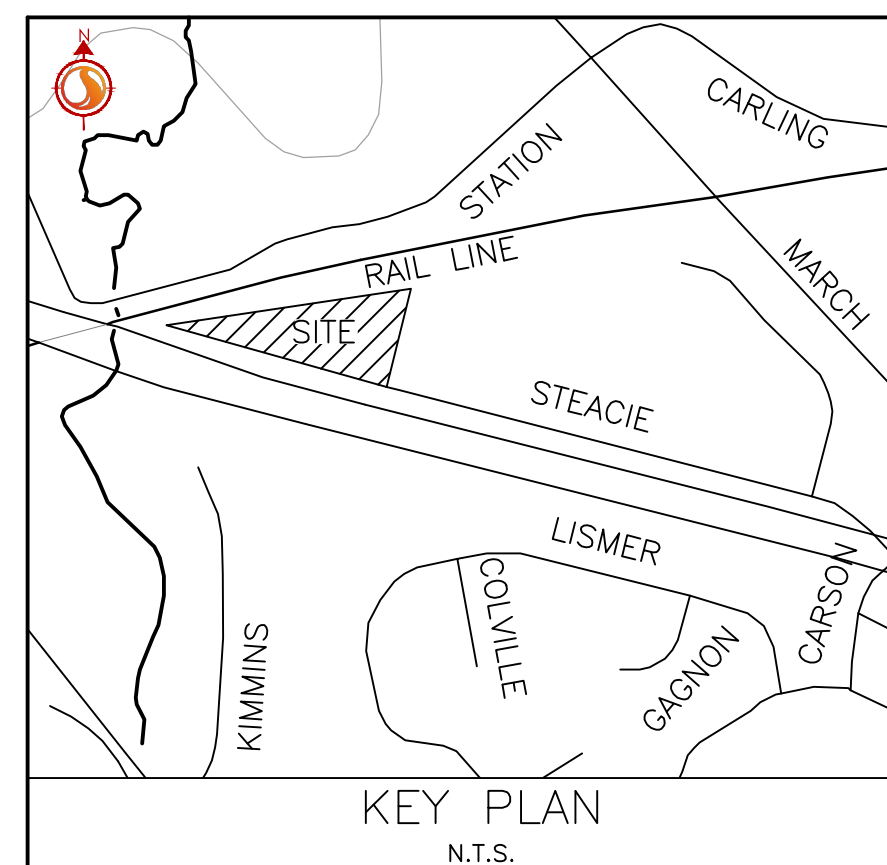

Pre-Development

Sub Catchment ID	Total Area (m ²)	Hard Surface (m ²)	Gravel Surface (m ²)	Soft Surface (m ²)	Runoff Coefficient, C
N DTCH	1197.58	602.35	197.28	397.95	0.65
S DTCH	672.46	373.56	47.68	251.22	0.63

Post-Development

Sub Catchment ID	Total Area (m ²)	Hard Surface (m ²)	Gravel Surface (m ²)	Soft Surface (m ²)	Runoff Coefficient, C
N DTCH	1197.58	872.32	0.00	325.26	0.71
S DTCH	672.46	467.50	7.94	197.02	0.69