

COSTCO
WHOLESALE
CORPORATION
 999 LAKE DRIVE
 ISSAQUAH, WA 98027
 T: 425.313.8100
 Costco.com

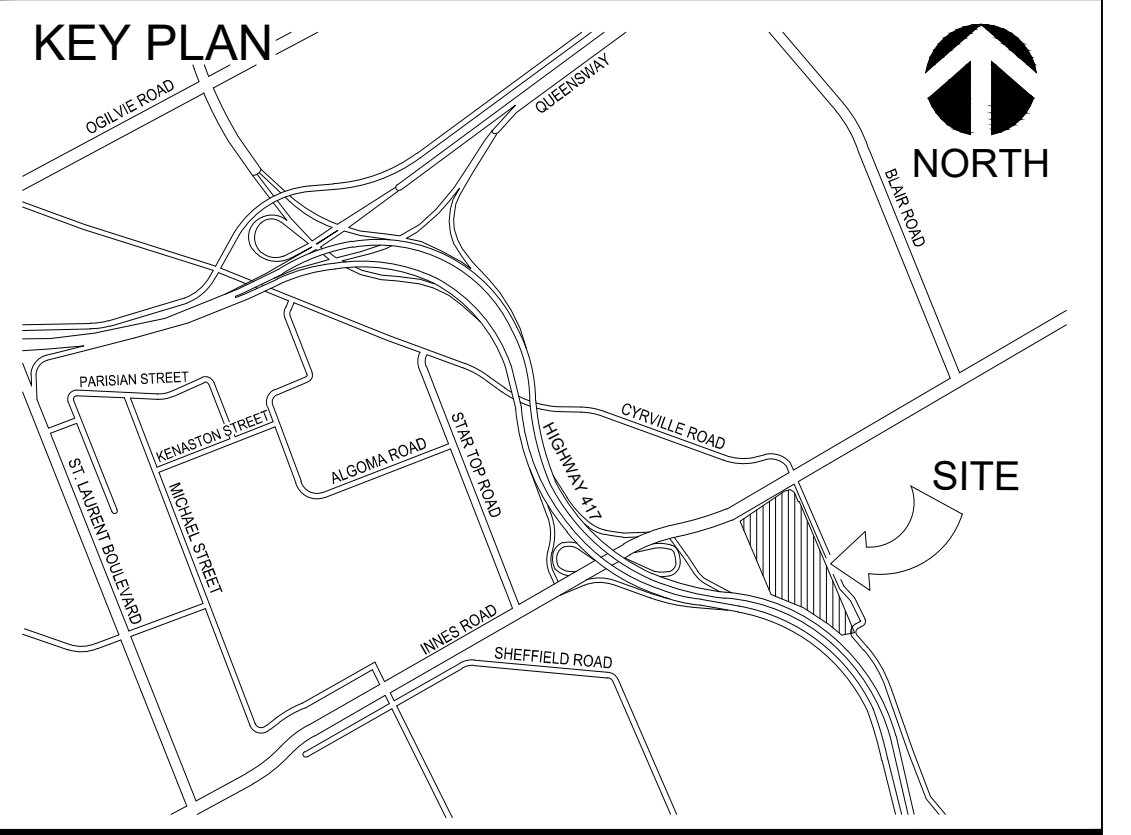

PROJECT DATA
 PROJECT ADDRESS: 1900 CYRVILLE ROAD
 OTTAWA, ONTARIO
 EXISTING AREA: 47,574.2m² (4.76 ha) / 11.76 ac
 PROPOSED AREA: 46,850.8m² (4.69 ha) / 11.58 ac
 ZONING: GM12 - GENERAL MIXED USE ZONE
 JURISDICTION: CITY OF OTTAWA
 BOUNDARY INFORMATION: THIS DRAWING IS BASED ON A SURVEY FROM WSP GEOMATICS ONTARIO LIMITED O.L.S. DATED 2020.

EXISTING BUILDING DATA	AREA	
BUILDING GROSS FLOOR AREA	11,730.0m ²	126,261ft ²
SHORE POWER BUILDING	8.7m ²	94ft ²
TOTAL GROSS FLOOR AREA	11,738.7m²	126,355ft²
PROPOSED BUILDING DATA	AREA	
BUILDING GROSS FLOOR AREA	11,730.0m ²	126,261ft ²
SHORE POWER BUILDING	8.7m ²	94ft ²
PROPOSED GAS BAR MECHANICAL ENCLOSURE	17.2m ²	185ft ²
PROPOSED GAS BAR ATTENDANT ENCLOSURE	1.4m ²	15ft ²
TOTAL GROSS FLOOR AREA	11,757.3m²	126,555ft²
PROPOSED FUEL FACILITY CANOPY HEIGHT:	5.64m	
PROPOSED MECHANICAL ENCLOSURE HEIGHT:	2.82m	
EXISTING SITE DATA	AREA	
LOT COVERAGE	24.7%	11,738.7m ²
LANDSCAPE OPEN SPACE	16.1%	7,687.1m ²
PAVED PARKING AREA	59.2%	28,148.4m ²
PROPOSED SITE DATA	AREA	
LOT COVERAGE	24.7%	11,757.3m ²
LANDSCAPE OPEN SPACE	17.7%	8,429.3m ²
PAVED PARKING AREA	57.6%	27,387.6m ²

EXISTING PARKING DATA	PARKING SPACES
REQUIRED PARKING (3.4 / 100m ²)	400
NUMBER OF 3.0m WIDE PARKING SPACES PROVIDED	555
NUMBER OF 2.75m WIDE PARKING SPACES PROVIDED	14
NUMBER OF LOADING SPACES PROVIDED	14
NUMBER OF BARRIER-FREE PARKING SPACES PROVIDED	20
TOTAL COSTCO PARKING SPACES PROVIDED	603
NO. STALLS PROVIDED PER 100m ² OF COSTCO BUILDING AREA	5.14
NUMBER OF 3.66m WIDE DELIVERY TRUCK STALLS	20
PROPOSED PARKING DATA	PARKING SPACES
REQUIRED PARKING (3.4 / 100m ²)	400
NUMBER OF 3.0m WIDE PARKING SPACES PROVIDED	429
NUMBER OF 2.75m WIDE PARKING SPACES PROVIDED	9
NUMBER OF LOADING SPACES PROVIDED	12
NUMBER OF BARRIER-FREE PARKING SPACES PROVIDED	20
TOTAL COSTCO PARKING SPACES PROVIDED	470
NO. STALLS PROVIDED PER 100m ² OF COSTCO BUILDING AREA	4.00
NUMBER OF 3.66m WIDE DELIVERY TRUCK STALLS	20

REVISIONS	BY	DATE	APPR.

ISSUED FOR APPROVAL, NOT FOR CONSTRUCTION
 ALL PREVIOUS ISSUES OF THIS DRAWING ARE SUPERSEDED

SHEET TITLE SWEPT PATH DIAGRAM
PLAN #: 19467
APPLICATION #: D07-12-25-0160

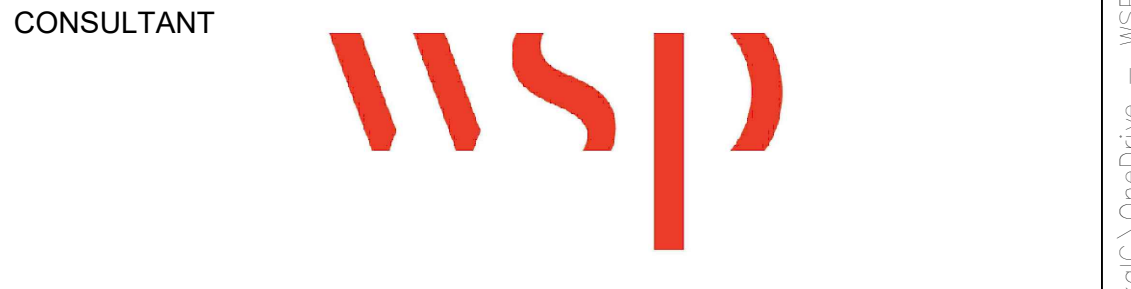

DESIGNED	DRAWN	CHECKED
CJM/KH	CJM	KH
SCALE	DATE	
1:500	JUNE 9, 2026	
PROJECT NUMBER	DWG. NUMBER	
211-12161-00-P01	SPD-1	

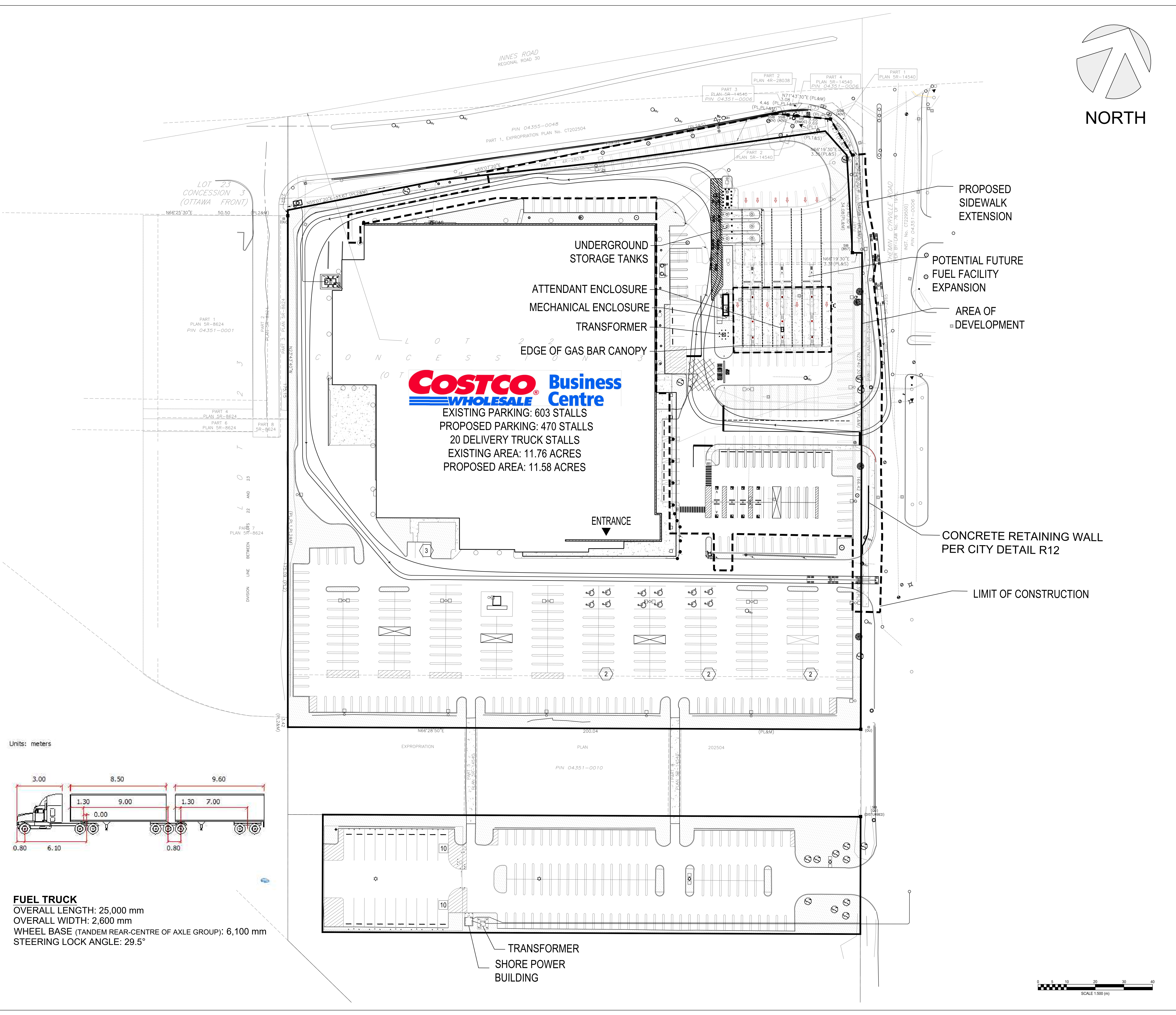

EXISTING PARKING: 603 STALLS
PROPOSED PARKING: 470 STALLS
20 DELIVERY TRUCK STALLS
EXISTING AREA: 11.76 ACRES
PROPOSED AREA: 11.58 ACRES

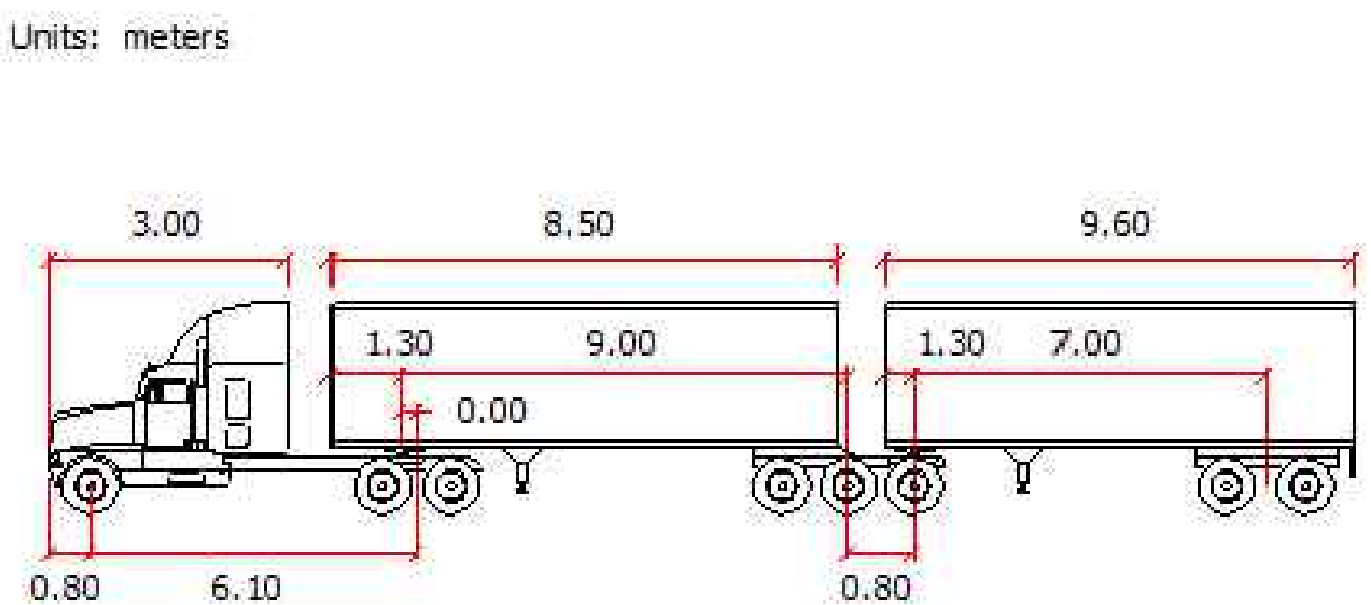

FUEL TRUCK
 OVERALL LENGTH: 25,000 mm
 OVERALL WIDTH: 2,600 mm
 WHEEL BASE (TANDEM REAR-CENTRE OF AXLE GROUP): 6,100 mm
 STEERING LOCK ANGLE: 29.5°

