

KEY PLAN, NTS

GENERAL NOTES

1. ALL SITE INFORMATION AND GENERAL CONDITIONS COMPILED FROM THE ARCHITECTS, SURVEY AND ENGINEERS PLANS AND REVIEWS.
2. DO NOT SCALE THIS DRAWING.
3. REPORT ANY ANOMALIES BEFORE THE BEGINNING OF THE ROADWORKS. THE LANDSCAPE ARCHITECT IS NOT RESPONSIBLE FOR UNKNOWN UNDERGROUND CONDITIONS.
4. RESTORE ALL DAMAGED AREAS AND FEATURES AS A RESULT OF CONSTRUCTION ACTIVITIES TO THE SATISFACTION OF THE LANDSCAPE ARCHITECT.
5. THE DRAWING CANNOT BE USED FOR CONSTRUCTION UNTIL HAVING BEEN SIGNED BY THE LANDSCAPE ARCHITECT AS ISSUED FOR CONSTRUCTION.
6. THE ACCURACY OF UTILITY POSITIONS IS NOT GUARANTEED.
7. EACH UTILITY COMPANY MUST BE CONTACTED TO CONFIRM THE EXISTENCE AND LOCATION OF UTILITIES BEFORE DIGGING. MUST BE CONTACTED TO CONFIRM THE EXISTENCE AND LOCATION OF PUBLIC SERVICES BEFORE DIGGING.
8. THIS DRAWING IS A SERVICE INSTRUMENT AND ITS USE REQUIRES AUTHORIZATION OF THE LANDSCAPE ARCHITECT. COPYRIGHT RESERVED BY LANDSCAPE ARCHITECT, DAVID LASHLEY.
9. THERE IS 1.5m SEPARATION BETWEEN THE PROPOSED TREES AND SERVICE LATERALS.

CLIENT:

1 EXISTING TREE PLAN
TP-01 Scale: 1:200

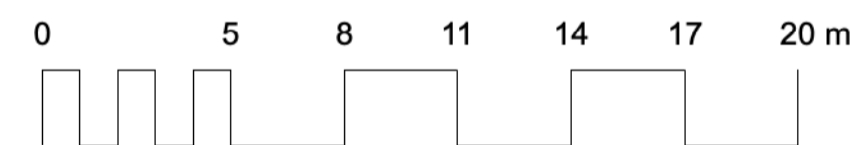

Existing Tree Report

ID	Botanical Name	Common Name	Average Spread	Height	DBH	No. of Stems	Condition	Action	Date Assessed	Notes
E01	Populus. orandidentata	Largetooth aspen	10	5	0.53	1	Good	Retain	2025-07-18	HYDROVAC ROOTS AT PERIMETER
E02	Populus. orandidentata	Largetooth aspen	11	5	0.65	1	Average	Retain	2025-07-18	HYDROVAC ROOTS AT PERIMETER
E03	Populus. orandidentata	Largetooth aspen	5	5	0.255	1	Average	Retain	2025-07-18	
E04	Populus. orandidentata	Largetooth aspen	5	5	0.145	1	Average	Retain	2025-07-18	
E05	Populus. orandidentata	Largetooth aspen	5	5	0.301	6	Poor	Remove	2025-07-18	Growing into fence
E06	Acer. neundo	Manitoba Maple	5	5	0.12	1	Poor	Remove	2025-07-18	Growing into fence
E07	Populus. tremuloides	Trembling Aspen	5	5	0.105	3	Average	Remove	2025-07-18	
E08	Acer. neundo	Manitoba Maple	4	5	0.211	3	Average	Retain	2025-07-18	
E09	Fraxinus. pensylvanica	Green Ash	5	5	0.13	1	Average	Remove	2025-07-18	
E10	Salix. Niora	Black Willow	5	5	0.27	1	Average	Retain	2025-07-18	
E11	Salix. Niora	Black Willow	5	5	0.235	1	Average	Retain	2025-07-18	
E12	Salix. Niora	Black Willow	5	5	0.13	1	Average	Retain	2025-07-18	
E13	Salix. Niora	Black Willow	5	5	0.22	2	Average	Retain	2025-07-18	

LEGEND

- PROPERTY LINE
- EXISTING TREE TO BE REMOVED
- EXISTING TREE TO BE RETAINED



2 2026-05-29 ISSUED FOR ENGINEER COORDINATION

1 2025-09-11 SITE PLAN CONTROL APPLICATION

NO. DATE DESCRIPTION

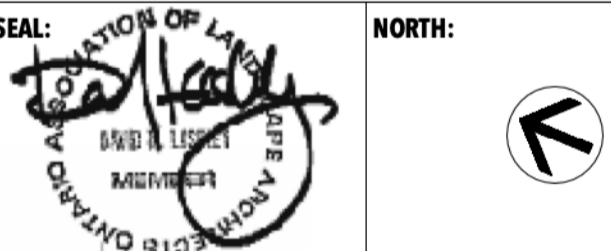

LASHLEY & ASSOCIATES
202-950 GLADSTONE
OTTAWA, ONTARIO
CANADA
K1Y 3E6
T: 613-233-8579
F: 613-233-4051

CONSULTANT:

PROJECT:

3210 Albion Road
3210 Albion road South
Ottawa ON

DRAWING TITLE:
EXISTING CONDITIONS AND
DEMOLITION PLAN

DATE: 2025-07-24 DRAWING NO.:

SCALE: AS NOTED

DRAWN BY: IS

LA PROJECT NO.: 125901-1

TP-01



KEY PLAN, NTS

GENERAL NOTES

1. ALL SITE INFORMATION AND GENERAL CONDITIONS COMPILED FROM THE ARCHITECTS, SURVEY AND ENGINEERS PLANS AND REVIEWS.
2. DO NOT SCALE THIS DRAWING.
3. REPORT ANY ANOMALIES BEFORE THE BEGINNING OF THE ROADWORKS. THE LANDSCAPE ARCHITECT IS NOT RESPONSIBLE FOR UNKNOWN UNDERGROUND CONDITIONS.
4. RESTORE ALL DAMAGED AREAS AND FEATURES AS A RESULT OF CONSTRUCTION ACTIVITIES TO THE SATISFACTION OF THE LANDSCAPE ARCHITECT.
5. THE DRAWING CANNOT BE USED FOR CONSTRUCTION UNTIL HAVING BEEN SIGNED BY THE LANDSCAPE ARCHITECT AS ISSUED FOR CONSTRUCTION.
6. THE ACCURACY OF UTILITY POSITIONS IS NOT GUARANTEED.
7. EACH UTILITY COMPANY MUST BE CONTACTED TO CONFIRM THE EXISTENCE AND LOCATION OF UTILITIES BEFORE DIGGING. MUST BE CONTACTED TO CONFIRM THE EXISTENCE AND LOCATION OF PUBLIC SERVICES BEFORE DIGGING.
8. THIS DRAWING IS A SERVICE INSTRUMENT AND ITS USE REQUIRES AUTHORIZATION OF THE LANDSCAPE ARCHITECT. COPYRIGHT RESERVED BY LANDSCAPE ARCHITECT, DAVID LASHLEY.
9. THERE IS 1.5m SEPARATION BETWEEN THE PROPOSED TREES AND SERVICE LATERALS.

CLIENT:

2 2026-05-29 ISSUED FOR ENGINEER COORDINATION

1 2025-09-11 SITE PLAN CONTROL APPLICATION

NO. DATE DESCRIPTION

SEAL: [Signature] NORTH: [North Arrow]



LASHLEY & ASSOCIATES
202-950 GLADSTONE
OTTAWA, ONTARIO
CANADA
K1Y 3E6
T: 613-233-8579
F: 613-233-4051

CONSULTANT:

PROJECT:

3210 Albion Road
3210 Albion road South
Ottawa ON

DRAWING TITLE:

PROPOSED PLANTING PLAN

DATE: 2025-09-08 DRAWING NO.:

SCALE: AS NOTED

DRAWN BY: IS

LA PROJECT NO.: 125901-1

TP-02

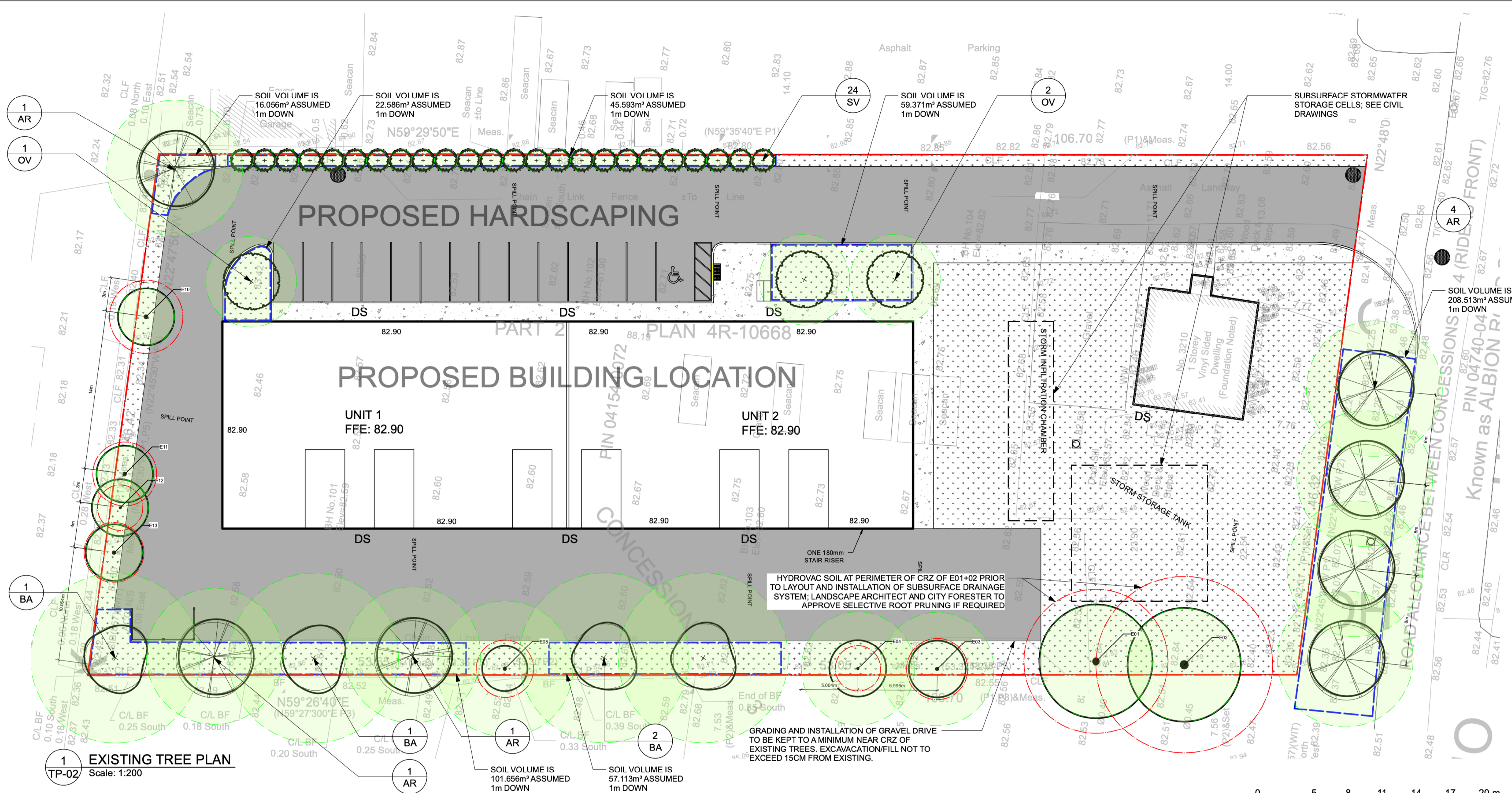

1 EXISTING TREE PLAN
TP-02 Scale: 1:200

- LEGEND**
- PROPERTY LINE
 - - - TREE PROTECTION FENCING
 - - - SOIL VOLUME FOR NEW TREES
 - APPROX. 40-YEAR TREE CANOPY
 - SOD
 - ASPHALT
 - CONCRETE
 - PROPOSED TREE
 - EXISTING TREE TO BE RETAINED

Existing Tree Report

ID	Botanical Name	Common Name	DBH	No. of Stems	Notes
E01	Populus grandidentata	Largetooth aspen	0.53	1	
E02	Populus grandidentata	Largetooth aspen	0.65	1	
E03	Populus grandidentata	Largetooth aspen	0.225	1	
E04	Populus grandidentata	Largetooth aspen	0.145	1	
E08	Acer negundo	Manitoba Maple	0.211	3	
E10	Salix Niora	Black Willow	0.27	1	
E11	Salix Niora	Black Willow	0.235	1	
E12	Salix Niora	Black Willow	0.13	1	
E13	Salix Niora	Black Willow	0.22	2	

Proposed Tree Report

ID	Botanical Name	Common Name	QTY	Scheduled Planting Size	Notes
AR	Acer Rubrum	Red Maple	7	50mm cal POT	
BA	Betula alleghaniensis	Yellow Birch	4	45mm Cal Pot	
OV	Ostrya virginiana	American Hoopbeam	3	45mm Cal Pot	
SV	Syringaa Vulcans	Common Lilac	24	150-200cm POT	

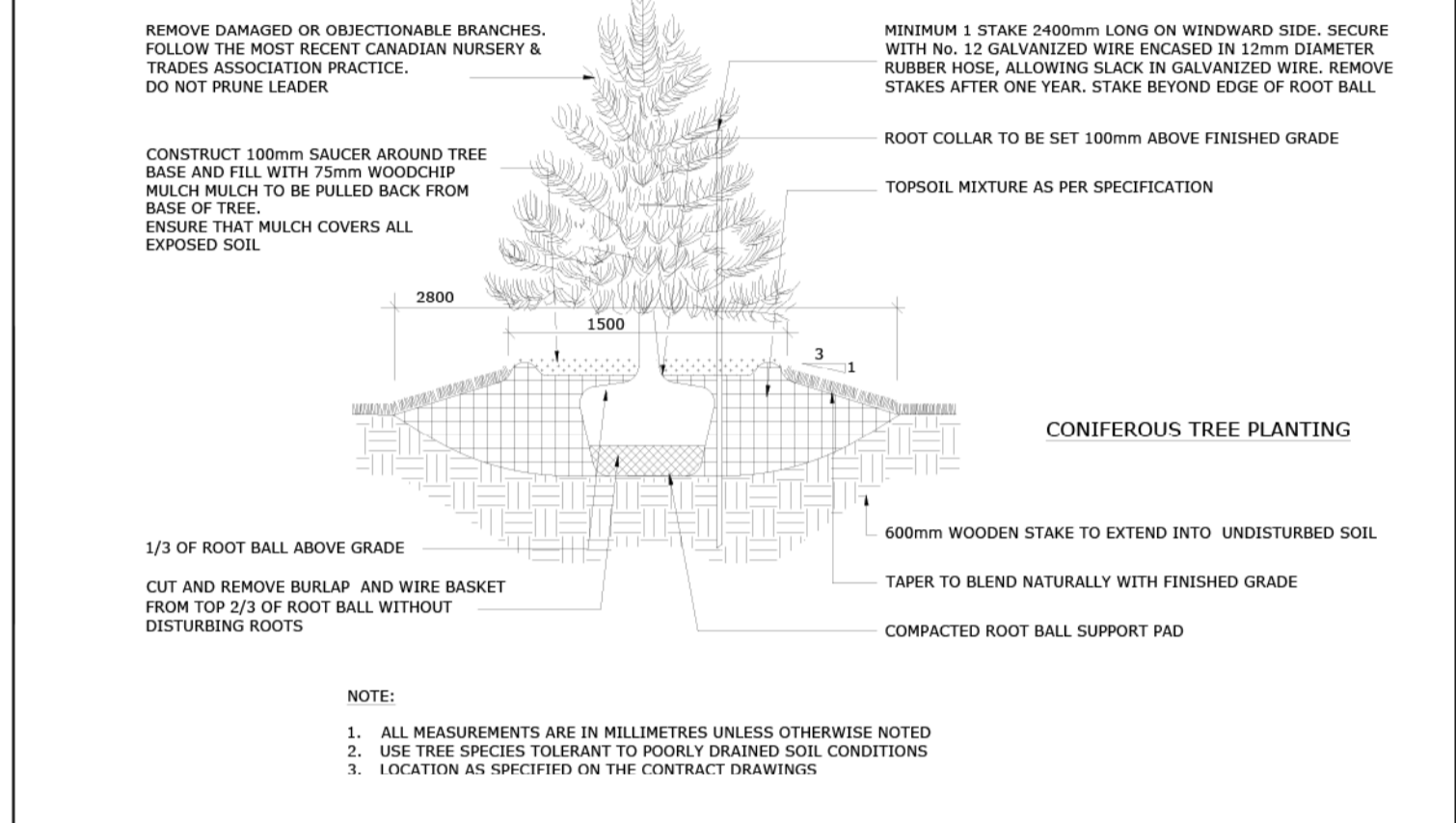
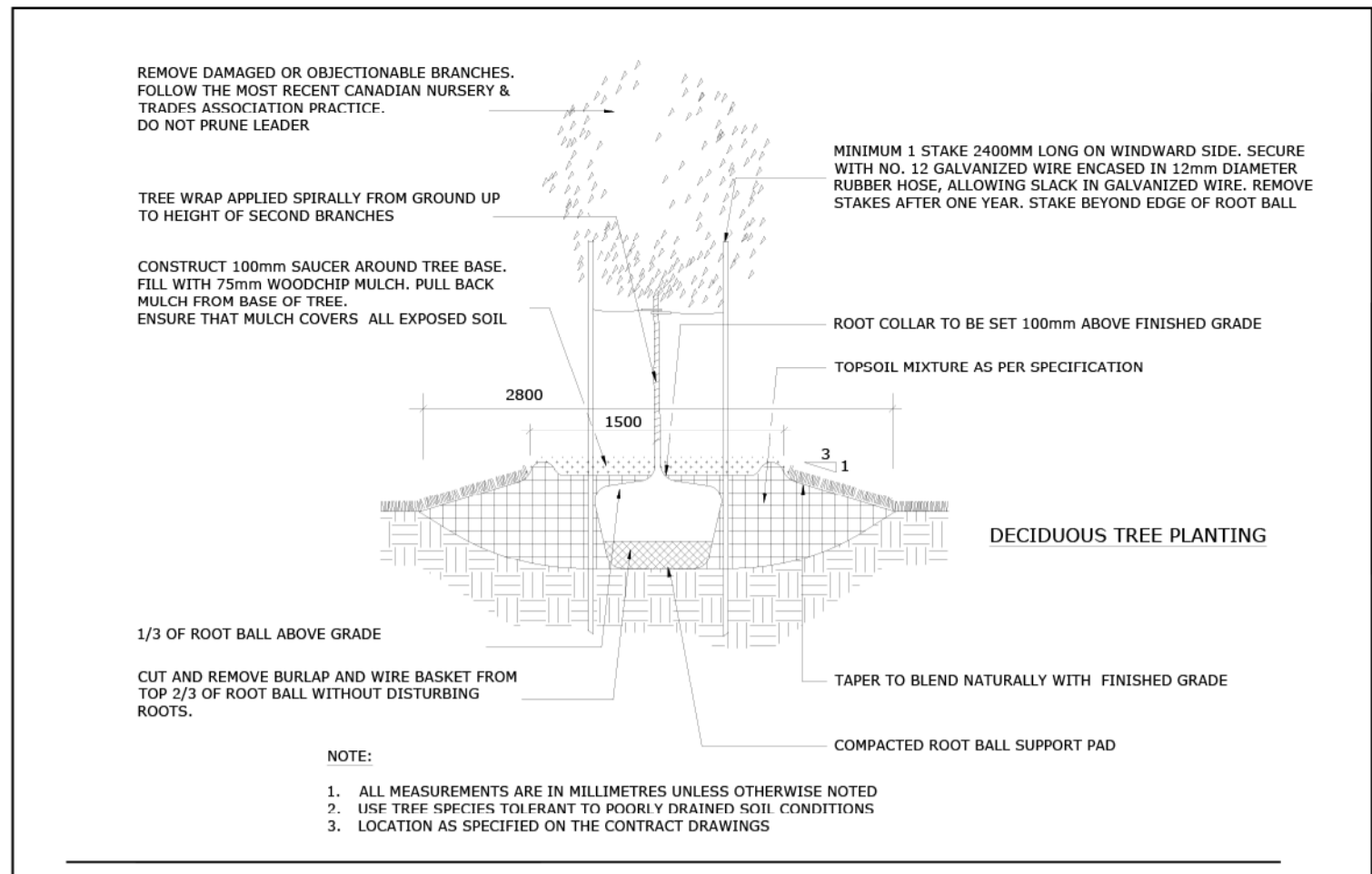

Ottawa TITLE: PLANTING PIT POORLY DRAINED SOILS DATE: MAY 2001
 REV: FEB 2017
 DWG No: L6

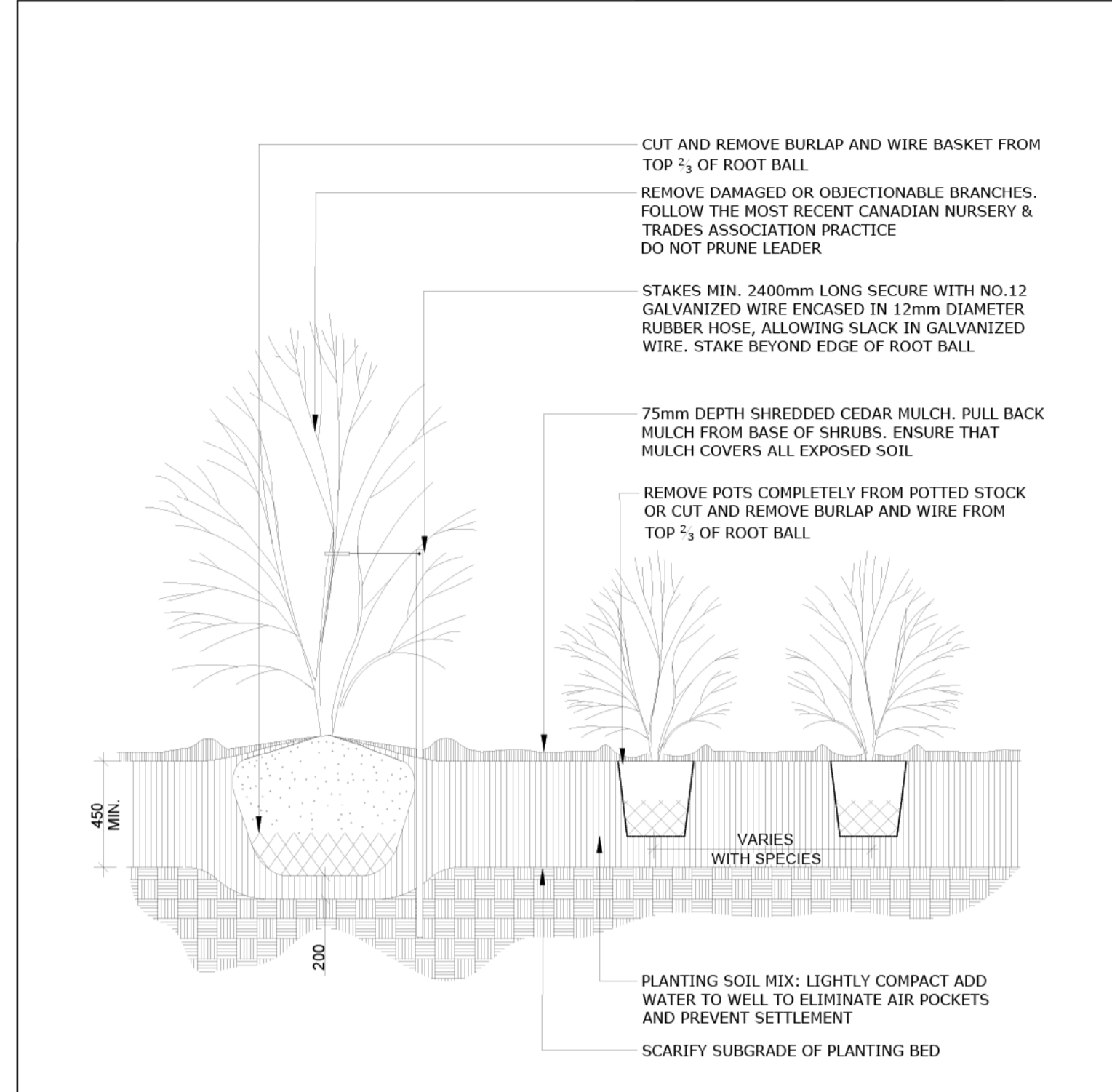

Ottawa TITLE: CONTINUOUS SHRUB BED PLANTING DATE: FEB 2013
 REV: FEB 2014
 DWG No: L17

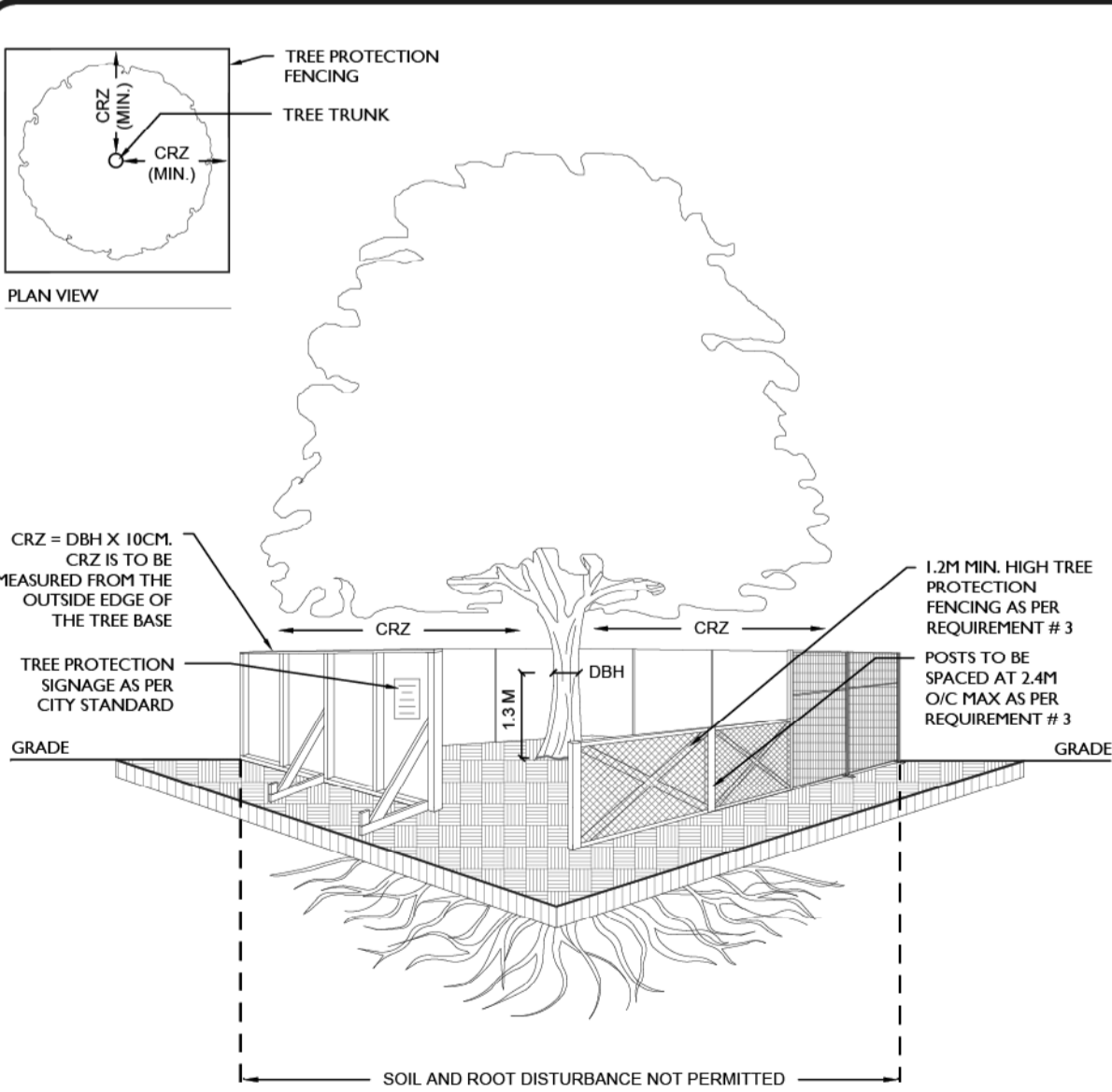

TREE PROTECTION REQUIREMENTS:

- PRIOR TO ANY WORK ACTIVITY WITHIN THE CRITICAL ROOT ZONE (CRZ = 10 X DIAMETER) OF A TREE, TREE PROTECTION FENCING MUST BE INSTALLED SURROUNDING THE CRITICAL ROOT ZONE, AND REMAIN IN PLACE UNTIL THE WORK IS COMPLETE.
- UNLESS PLANS ARE APPROVED BY CITY FORESTRY STAFF, FOR WORK WITHIN THE CRZ:
 - DO NOT PLACE ANY MATERIAL OR EQUIPMENT - INCLUDING OUTHOUSES;
 - DO NOT ATTACH ANY SIGNS, NOTICES OR POSTERS TO ANY TREE;
 - DO NOT RAISE OR LOWER THE EXISTING GRADE;
 - TUNNEL OR BORE WHEN DIGGING;
 - DO NOT DAMAGE THE ROOT SYSTEM, TRUNK, OR BRANCHES OR ANY TREE;
 - ENSURE THAT EXHAUST FLUMES FROM ALL EQUIPMENT ARE NOT DIRECTED TOWARD ANY TREE CANOPY;
 - DO NOT EXTEND HARD SURFACE OR SIGNIFICANTLY CHANGE LANDSCAPING
- TREE PROTECTION FENCING MUST BE AT LEAST 1.2M IN HEIGHT, AND CONSTRUCTED OF RIGID OR FRAMED MATERIALS (E.G. MODULOC - STEEL, PLYWOOD HOARDING, OR SNOW FENCE ON A 2"x4" WOOD FRAME) WITH POSTS 2.4M APART, SUCH THAT THE FENCE LOCATION CANNOT BE ALTERED. ALL SUPPORTS AND BRACING MUST BE PLACED OUTSIDE OF THE CRZ, AND INSTALLATION MUST MINIMISE DAMAGE TO EXISTING ROOTS. (SEE DETAIL)
- THE LOCATION OF THE TREE PROTECTION FENCING MUST BE DETERMINED BY AN ARBORIST AND DETAILED ON ANY ASSOCIATED PLANS FOR THE SITE (E.G. TREE CONSERVATION REPORT, TREE INFORMATION REPORT, ETC). THE PLAN AND CONSTRUCTED FENCING MUST BE APPROVED BY CITY FORESTRY STAFF PRIOR TO THE COMMENCEMENT OF WORK.
- IF THE FENCED TREE PROTECTION AREA MUST BE REDUCED TO FACILITATE CONSTRUCTION, MITIGATION MEASURES MUST BE PRESCRIBED BY AN ARBORIST AND APPROVED BY CITY FORESTRY STAFF. THESE MAY INCLUDE THE PLACEMENT OF PLYWOOD, WOOD CHIPS, OR STEEL PLATING OVER THE ROOTS FOR PROTECTION OR THE PROPER PRUNING AND CARE OF ROOTS WHERE ENCOUNTERED.

THE CITY'S TREE PROTECTION BY-LAW, 2020-340 PROTECTS BOTH CITY-OWNED TREES, CITY-WIDE, AND PRIVATELY-OWNED TREES WITHIN THE URBAN AREA. PLEASE REFER TO WWW.OTTAWA.CA/TREEBYLAW FOR MORE INFORMATION ON HOW THE TREE BY-LAW APPLIES.

Ottawa TREE PROTECTION SPECIFICATION
 TO BE IMPLEMENTED FOR RETAINED TREES, BOTH ON SITE AND ON ADJACENT SITES, PRIOR TO ANY TREE REMOVAL OR SITE WORKS AND MAINTAINED FOR THE DURATION OF WORK ACTIVITIES ON SITE.

SCALE: NTS
 DATE: MARCH 2021
 DRAWING NO: 1 of 1



Subject Site
 ALBION ROAD SOUTH
 JOHNSTON ROAD

KEY PLAN, NTS

GENERAL NOTES

- ALL SITE INFORMATION AND GENERAL CONDITIONS COMPILED FROM THE ARCHITECTS, SURVEY AND ENGINEERS PLANS AND REVIEWS.
- DO NOT SCALE THIS DRAWING.
- REPORT ANY ANOMALIES BEFORE THE BEGINNING OF THE ROADWORKS. THE LANDSCAPE ARCHITECT IS NOT RESPONSIBLE FOR UNKNOWN UNDERGROUND CONDITIONS.
- RESTORE ALL DAMAGED AREAS AND FEATURES AS A RESULT OF CONSTRUCTION ACTIVITIES TO THE SATISFACTION OF THE LANDSCAPE ARCHITECT.
- THE DRAWING CANNOT BE USED FOR CONSTRUCTION UNTIL HAVING BEEN SIGNED BY THE LANDSCAPE ARCHITECT AS ISSUED FOR CONSTRUCTION.
- THE ACCURACY OF UTILITY POSITIONS IS NOT GUARANTEED.
- EACH UTILITY COMPANY MUST BE CONTACTED TO CONFIRM THE EXISTENCE AND LOCATION OF UTILITIES BEFORE DIGGING. MUST BE CONTACTED TO CONFIRM THE EXISTENCE AND LOCATION OF PUBLIC SERVICES BEFORE DIGGING.
- THIS DRAWING IS A SERVICE INSTRUMENT AND ITS USE REQUIRES AUTHORIZATION OF THE LANDSCAPE ARCHITECT. COPYRIGHT RESERVED BY LANDSCAPE ARCHITECT, DAVID LASHLEY.
- THERE IS 1.5m SEPARATION BETWEEN THE PROPOSED TREES AND SERVICE LATERALS.

CLIENT:

2	2026-05-29	ISSUED FOR ENGINEER COORDINATION
1	2025-10-10	SITE PLAN CONTROL APPLICATION

NO.	DATE	DESCRIPTION
2	2026-05-29	ISSUED FOR ENGINEER COORDINATION
1	2025-10-10	SITE PLAN CONTROL APPLICATION

SEAL: [Professional Seal of David Lashley, Landscape Architect, Ontario]

NORTH: [North Arrow]

LASHLEY & ASSOCIATES
 202-950 GLADSTONE
 OTTAWA, ONTARIO
 CANADA
 K1Y 3E6
 T: 613-233-8579
 F: 613-233-4051

CONSULTANT:

PROJECT:

3210 Albion Road
 3210 Albion road South
 Ottawa ON

DRAWING TITLE:
 LANDSCAPE AND PLANTING
 DETAILS

DATE: 2025-10-10 DRAWING NO.:
 SCALE: AS NOTED
 DRAWN BY:
 LA PROJECT NO.: 125901-1

TP-03