

- PROPERTY LINE
- APPROXIMATE LINE OF REQUIRED SETBACK
- APPROXIMATE EXTENT OF BUILDING BELOW
- APPROXIMATE EXTENT OF BUILDING ABOVE
- DECIDUOUS TREE FORM SHRUB (SEE LANDSCAPE NOTES & SCHEDULE FOR SPECIES AND QUANTITIES)
- EXISTING TREES TO BE PROTECTED
- CIP CONCRETE
- UNIT PAVING
- 150mm TOPSOIL AND SEED
- BUILDING OVERHANG ABOVE

rev'n	description / la description	yyyy/mm/dd
05	re-issue for Site Plan Control	2026/05/26
04	re-issue for coordination	2026/02/20
03	re-issue for Site Plan Control	2025/12/01
02	issue for Site Plan Control	2025/10/28
01	issue for Site Plan Control	2025/07/28
00	issue for Client review	2025/06/10

FOTENN Planning + Design
420 O'Connor Street
Ottawa, ON, CANADA K2P 1W4
613.730.5709
fotenn.com

north / le nord stamp / le cachet

project / projet

312 Lisgar St.

drawing / dessin

SITE PLAN

designed / conçu	drawn / dessiné	reviewed / examiné
ST / DF	ST	DF
date	project number / No. du projet	
MAY 2025		

drawing number / No. du dessin

SP 1

PROJECT CONSULTANTS

DEVELOPER / OWNER
ISLAM CARE CENTRE
375 SOMERST ST.
OTTAWA, ONTARIO K2P 0K1
PHONE: 613-232-0210

ARCHITECT
ARCHICANA
2171 MCGEE SIDE RD.
CARP, ONTARIO K0A 1L0
PHONE: 613-800-2340

PLANNING / LANDSCAPE
FOTENN PLANNING + DESIGN
420 O'CONNOR ST.
OTTAWA, ONTARIO K2P 1W4
PHONE: 613-730-5709

CIVIL
LRL ENGINEERING SERVICES
5430 CANOTEK RD.
OTTAWA, ONTARIO K1J 9G2
PHONE: 613-842-3434

SURVEYOR
ANNIS, O'SULLIVAN, VOLLEBEKK LTD.
14 CONCOURSE GATE, SUITE 500
NEPEAN, ON K2E 7S6
PHONE: 613-727-0850

SITE INFORMATION

ZONING 11A (1912)

LOT DIMENSIONS
Minimum lot width 10.06 m
Minimum lot area 344 m²

SETBACKS F.Y. S.Y. R.Y. I.S.Y.
1.7m 0m 0m 4.5m
(EXCEPT GROUND FLOOR)

SITE AREA
Total Site Area: 344.6 m²

BUILDING
Height: 3 Storeys (15m)
Area: 305.7 m²

GFA
Basement: 337.6 m²
Ground: 283.2 m²
Second: 280 m²
Third: 280 m²
Roof: 56 m²
Total: 1236.8 m²

PARKING
Required 0
Provided 0

LANDSCAPE AREA
Provided 31.34 m²

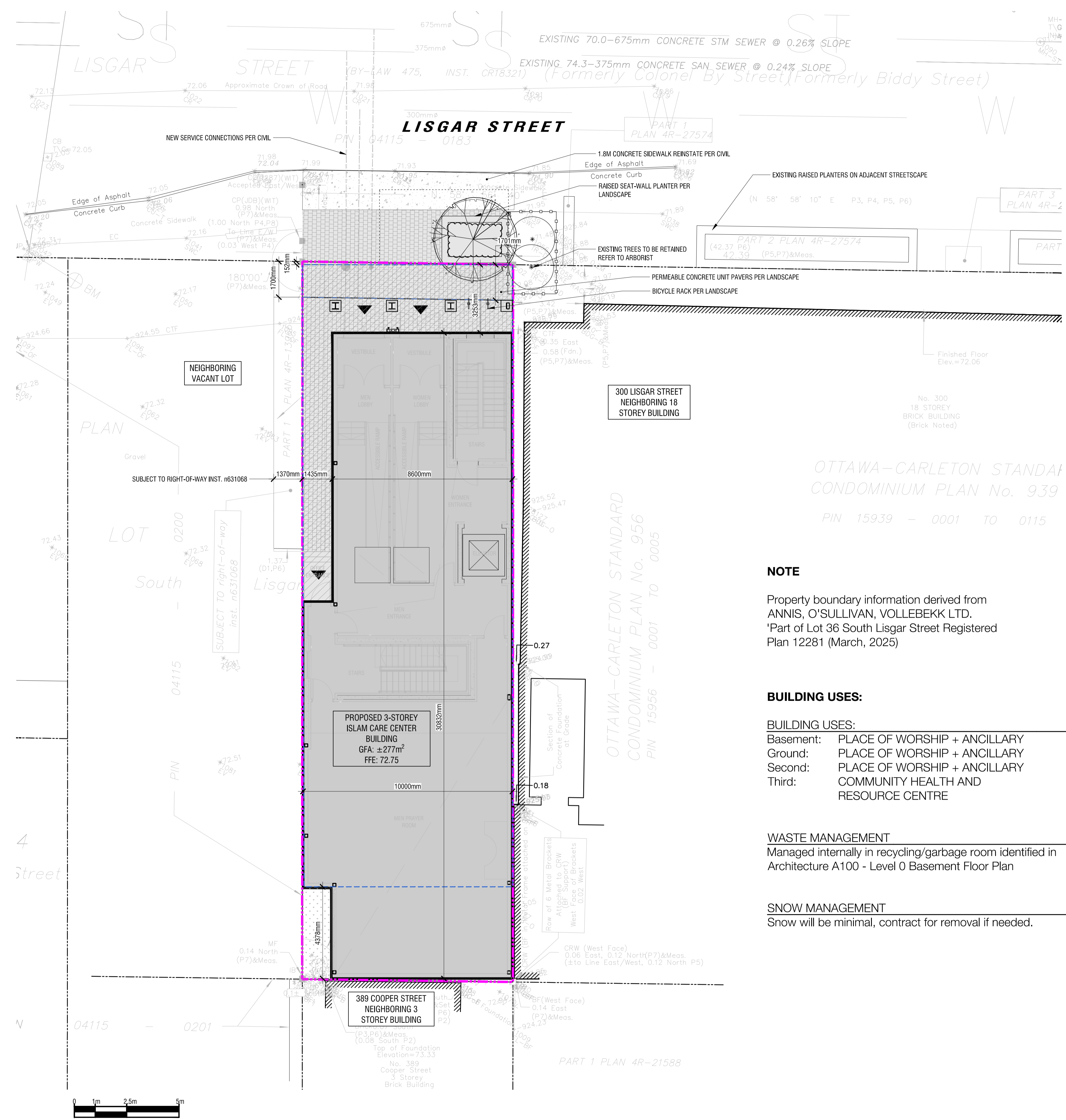

NOTE

Property boundary information derived from ANNIS, O'SULLIVAN, VOLLEBEKK LTD.
*Part of Lot 36 South Lisgar Street Registered Plan 12281 (March, 2025)

BUILDING USES:

BUILDING USES:
Basement: PLACE OF WORSHIP + ANCILLARY
Ground: PLACE OF WORSHIP + ANCILLARY
Second: PLACE OF WORSHIP + ANCILLARY
Third: COMMUNITY HEALTH AND RESOURCE CENTRE

WASTE MANAGEMENT

Managed internally in recycling/garbage room identified in Architecture A100 - Level 0 Basement Floor Plan

SNOW MANAGEMENT

Snow will be minimal, contract for removal if needed.

1 SITE PLAN
SP1 1:100

NOT FOR CONSTRUCTION