

ARCH D 24' x 36'

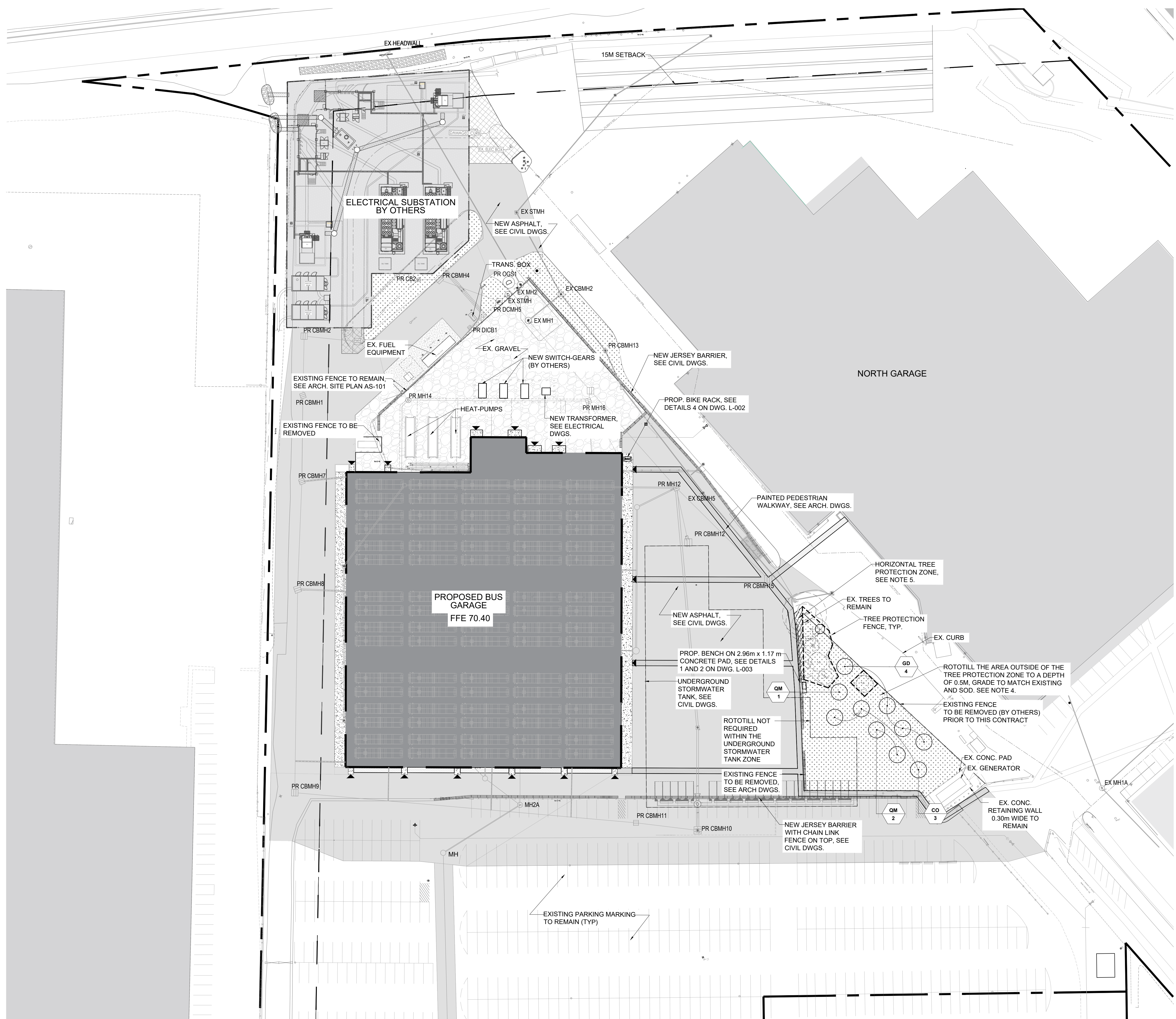

**LEGEND**

- PROPERTY LINE
- EXISTING CHAIN LINK FENCE
- TREE PROTECTION FENCE. SEE DETAIL 1 ON DWG. L-002
- TPZ HORIZONTAL TREE PROTECTION ZONE. NOTE 5.
- NEW JERSEY BARRIER. SEE CIVIL DWGS.
- BUILDING ENTRANCE
- EX. TREES
- TREE PROTECTION ZONE (TPZ)
- PROPOSED TREE. SEE DETAIL 3 ON DWG. L-002 FOR PLANTING DETAIL
- PROPOSED CONCRETE APRON AND APPROACH SLAB (REFER TO DWG. AS-101.)
- PROPOSED SOD
- PLANT KEY. SEE DWG. L-002 FOR PLANT LIST

- NOTES:**
- REFER TO TREE INVENTORY REPORT PROVIDED BY CITY OF OTTAWA INFRASTRUCTURE SERVICES DEPARTMENT DATED AUG. 25, 2025.
  - LIMIT DISTURBANCE TO EXISTING GROUND FOR TREE PLANTING. ACCESS THE PLANTING AREAS FROM NEARBY PAVED AREAS TO THE EXTENT WHERE POSSIBLE.
  - METHODS OF EXCAVATION WITHIN THE TPZ HORIZONTAL TREE PROTECTION ZONE SHALL INCLUDE THOSE WHICH CAUSE THE LEAST HARM TO THE TREE, SUCH AS MANUAL OR HYDRAULIC EXCAVATION.  
  
IN TREE PROTECTION ZONE (TPZ), HAND CULTIVATE TO DECOMPACT TO A DEPTH OF 150MM. AMEND TOPSOIL AS REQUIRED AND SOD.
  - AMEND THE EXISTING TOPSOIL AS PER THE SOIL TESTING REPORT TO SUPPORT GROWTH OF TREES AND SOD.
  - FOR ANY TREES RECOMMENDED FOR PRESERVATION (WITH TPZS INTERSECTING NEW OR PROPOSED ACTIVITY AREAS), THERE SHALL BE NO STORAGE OR MOVEMENT OF EQUIPMENT, OR HOARDING OF MATERIALS WITHIN THE TPZ. IF WORKS MUST BE COMPLETED WITHIN THE TPZ HORIZONTAL TREE PROTECTION OF 10 TO 15 CM (4" TO 6") OF MULCH MUST BE SPREAD OVER THE AREA WHICH IS TO BE WORKED UPON. ADDITIONALLY, SHEETS OF 0.75" (3/4") THICK PLYWOOD (MIN.) OR STEEL PLATING SHALL BE APPLIED UPON THE MULCH IN ORDER TO HELP DISTRIBUTE THE WEIGHT OF THE HEAVY EQUIPMENT TO AVOID SOIL COMPACTION. AFTER CONSTRUCTION, THESE MEASURES SHALL BE REMOVED TO ALLOW PROPER AERATION AND WATER INFILTRATION TO THE SOIL. THIS SHALL INCLUDE REMOVING THE BULK OF MULCH SO THAT ONLY 2" TO 4" REMAIN.
  - RESTORE ALL TOPSOIL AND THE DISTURBED SOFT AREAS WITH TOPSOIL AND SOD.
  - REMOVE TREE PROTECTION FENCING AFTER THE COMPLETION OF THE WORKS IS APPROVED BY CITY OF OTTAWA FORESTRY.
  - A CERTIFIED ARBORIST SHALL BE ON-SITE WHEN WORK THAT COULD IMPACT TREES IS REQUIRED WITHIN THE TPZ OF BY-LAW TREES IDENTIFIED FOR PRESERVATION.

**Ottawa**  
INFRASTRUCTURE SERVICES  
DESIGN AND CONSTRUCTION

SERVICES D'INFRASTRUCTURE  
DIRECTION DE CONCEPTION ET DE CONSTRUCTION

FOR / POUR  
Client - Department  
**Infrastructure and Water Services Department**  
Design & Construction

**CONSULTANT**  
**AECOM**

**PRIME:**  
AECOM Canada Architects Ltd.  
50 Sportsworld Crossing Road, Suite 200  
Kitchener, Ontario, N2P 0A4

**grc architects**

**SUBCONSULTANT:**  
GRC ARCHITECTS INC.  
47 Clarence Street, Suite 401  
Ottawa, Ontario, K1N 9K1

**NOTE:**  
IT IS THE RESPONSIBILITY OF THE CONTRACTORS TO INFORM THEMSELVES OF THE EXACT LOCATION OF, AND ASSUME ALL LIABILITY FOR DAMAGE TO ALL UTILITIES, SERVICES AND STRUCTURES WHETHER ABOVE GROUND OR BELOW GRADE BEFORE COMMENCING THE WORK. SUCH INFORMATION IS NOT NECESSARILY SHOWN ON THE DRAWING, AND WHERE SHOWN, THE ACCURACY CANNOT BE GUARANTEED.  
Avec la seule exception des renseignements spécifiquement décrits pour ce projet, aucune élévation indiquée ou assumée n'est à être utilisée comme référence d'élévation pour aucun but.

|        |                         |              |           |
|--------|-------------------------|--------------|-----------|
| 1      | ISSUED FOR TENDER       | 2025-12-15   | JB        |
| NUMBER | MILESTONE/FAIT SAILLANT | DATE (Y/M/D) | INITIALES |
|        |                         | (MM/JJ)      |           |

DESIGNED BY / CONÇU PAR  
Checked / Vérifié  
APPROVED BY / APPRUVÉ PAR  
SS

SCALE: ÉCHELLE  
1 : 500

DRAWING TITLE  
**A1.1**

SHEET NUMBER

THIS DRAWING IS THE PROPERTY OF THE CITY OF OTTAWA AND ALL COPYRIGHT IS RESERVED. DIMENSIONS ON DRAWINGS ARE FOR ESTIMATING PURPOSES ONLY. IT IS THE RESPONSIBILITY OF EACH CONTRACTOR AND SUB-CONTRACTOR OR CONSULTANT TO CHECK AND VERIFY ALL DIMENSIONS AND CONDITIONS ON SITE. NOTIFY OWNER OF ANY ERRORS OR OMISSIONS PRIOR TO COMMENCING THE WORK. DO NOT SCALE THE DRAWINGS.

CE Dessin constitue la propriété de la Ville d'Ottawa et tout droit d'auteur est réservé. Les dimensions utilisées ne sont à des fins d'estimation seulement. Il incombe à chaque entrepreneur, sous-contractant ou consultant de vérifier toutes les dimensions et les conditions sur le chantier. Veuillez informer le propriétaire de toute erreur ou omission avant d'entamer les travaux. Ne dessinez pas les plans à l'échelle.

ARCHITECT / ARCHITECTE

CONSULTANT / EXPERT-CONSEIL

*G. Wildman*

**GERALDINE WILDMAN**  
MANAGER, DEVELOPMENT REVIEW SOUTH  
PLANNING, DEVELOPMENT AND BUILDING SERVICES  
DEPARTMENT, CITY OF OTTAWA

**APPROVED**  
By wildmange at 9:36 pm, Jun 04, 2026

PROJECT / LOCATION / PROJET / ENDROIT  
**OTC ZEB-New Garage**

Enter address here.

OTTAWA, ONTARIO

DRAWING / DESSIN  
**TREE PRESERVATION AND LANDSCAPE PLAN**

BUSINESS ENTITY / NUMÉRO DE L'ENTITÉ  
BUILDING NUMBER / NUMÉRO DU BÂTIMENT

SHEET NO. / FEUILLE No.  
**OMF1**

CITY PROJECT NO. / NOUMÉRO DE PROJET  
**60716350**

CONS. PROJECT NO. / NUMÉRO DE PROJET

**L001**

| PROPOSED PLANT LIST    |          |                                      |                      |              |
|------------------------|----------|--------------------------------------|----------------------|--------------|
| KEY                    | QUANTITY | BOTANICAL NAME                       | COMMON NAME          | SIZE         |
| <b>DECIDUOUS TREES</b> |          |                                      |                      |              |
| CO                     | 3        | <i>Celtis occidentalis</i>           | Common Hackberry     | 50 mm CAL BB |
| GD                     | 4        | <i>Gymnocladus dioica 'Espresso'</i> | Kentucky Coffee Tree | 50mm CAL BB  |
| QM                     | 3        | <i>Quercus macrocarpa</i>            | Bur Oak              | 50 mm CAL BB |

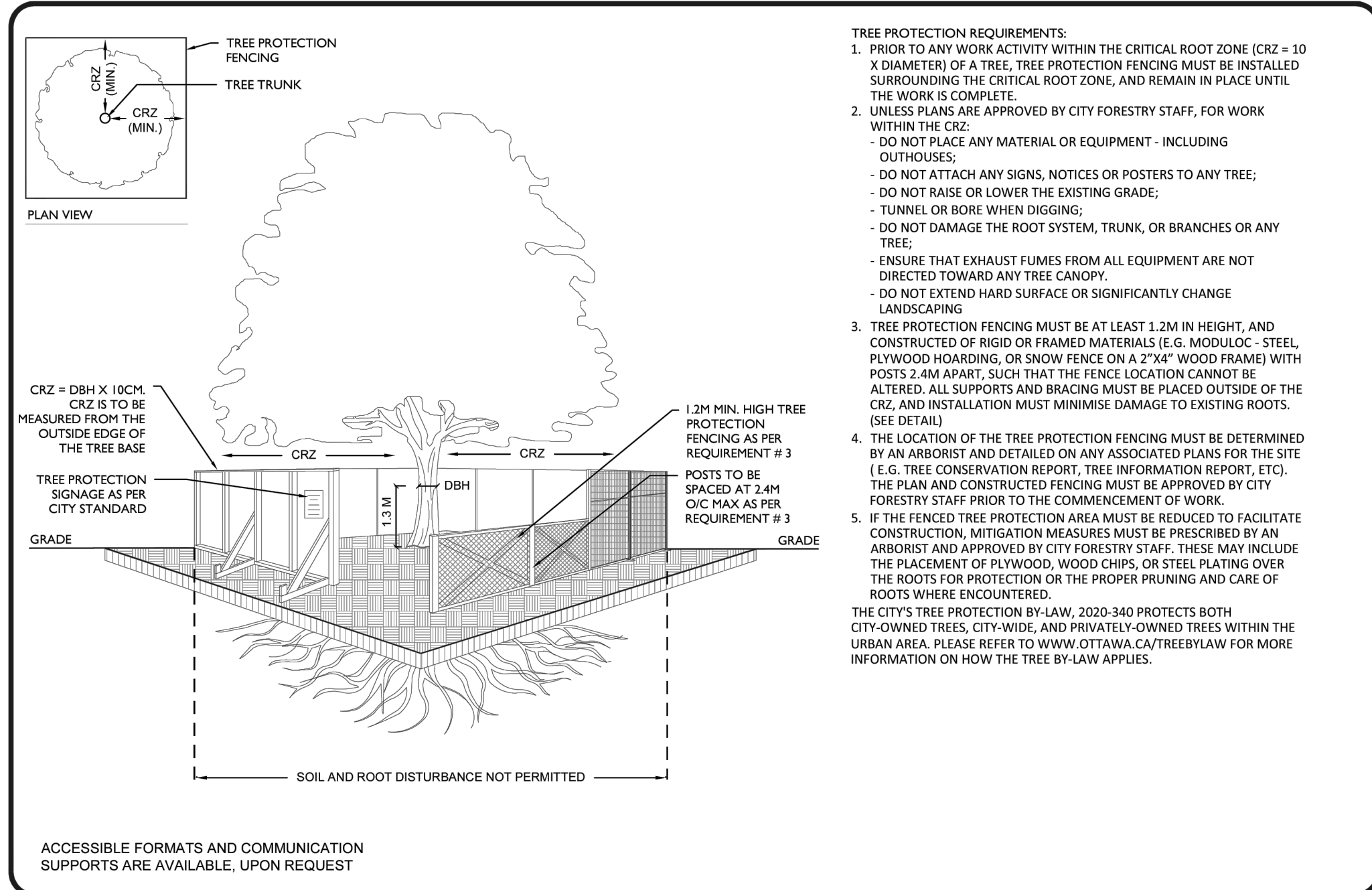

- TREE PROTECTION REQUIREMENTS:**
- PRIOR TO ANY WORK ACTIVITY WITHIN THE CRITICAL ROOT ZONE (CRZ = 10 X DIAMETER) OF A TREE, TREE PROTECTION FENCING MUST BE INSTALLED SURROUNDING THE CRITICAL ROOT ZONE, AND REMAIN IN PLACE UNTIL THE WORK IS COMPLETE.
  - UNLESS PLANS ARE APPROVED BY CITY FORESTRY STAFF, FOR WORK WITHIN THE CRZ:
    - DO NOT PLACE ANY MATERIAL OR EQUIPMENT - INCLUDING OUTHOUSES;
    - DO NOT ATTACH ANY SIGNS, NOTICES OR POSTERS TO ANY TREE;
    - DO NOT RAISE OR LOWER THE EXISTING GRADE;
    - TUNNEL OR BORE WHEN DIGGING;
    - DO NOT DAMAGE THE ROOT SYSTEM, TRUNK, OR BRANCHES OR ANY TREE;
    - ENSURE THAT EXHAUST FUMES FROM ALL EQUIPMENT ARE NOT DIRECTED TOWARD ANY TREE CANOPY;
    - DO NOT EXTEND HARD SURFACE OR SIGNIFICANTLY CHANGE LANDSCAPING.
  - TREE PROTECTION FENCING MUST BE AT LEAST 1.2M IN HEIGHT, AND CONSTRUCTED OF RIGID OR FRAMED MATERIALS (E.G. MODULOC - STEEL, PLYWOOD HOARDING, OR SNOW FENCE ON A 2"X4" WOOD FRAME) WITH POSTS 2.4M APART, SUCH THAT THE FENCE LOCATION CANNOT BE ALTERED. ALL SUPPORTS AND BRACING MUST BE PLACED OUTSIDE OF THE CRZ, AND INSTALLATION MUST MINIMIZE DAMAGE TO EXISTING ROOTS. (SEE DETAIL)
  - THE LOCATION OF THE TREE PROTECTION FENCING MUST BE DETERMINED BY AN ARBORIST AND DETAILED ON ANY ASSOCIATED PLANS FOR THE SITE (E.G. TREE CONSERVATION REPORT, TREE INFORMATION REPORT, ETC.). THE PLAN AND CONSTRUCTED FENCING MUST BE APPROVED BY CITY FORESTRY STAFF PRIOR TO THE COMMENCEMENT OF WORK.
  - IF THE FENCED TREE PROTECTION AREA MUST BE REDUCED TO FACILITATE CONSTRUCTION, MITIGATION MEASURES MUST BE PRESCRIBED BY AN ARBORIST AND APPROVED BY CITY FORESTRY STAFF. THESE MAY INCLUDE THE PLACEMENT OF PLYWOOD, WOOD CHIPS, OR STEEL PLATING OVER THE ROOTS FOR PROTECTION OR THE PROPER PRUNING AND CARE OF ROOTS WHERE ENCOUNTERED.
- THE CITY'S TREE PROTECTION BY-LAW, 2020-340 PROTECTS BOTH CITY-OWNED TREES, CITY-WIDE, AND PRIVATELY-OWNED TREES WITHIN THE URBAN AREA. PLEASE REFER TO WWW.OTTAWA.CA/TREEBYLAW FOR MORE INFORMATION ON HOW THE TREE BY-LAW APPLIES.

|  |  |                     |
|--|--|---------------------|
|  | <b>TREE PROTECTION SPECIFICATION</b><br><small>TO BE IMPLEMENTED FOR RETAINED TREES, BOTH ON SITE AND ON ADJACENT SITES, PRIOR TO ANY TREE REMOVAL OR SITE WORKS AND MAINTAINED FOR THE DURATION OF WORK ACTIVITIES ON SITE.</small> | SCALE: NTS          |
|  |  | DATE: MARCH 2021    |
|  |  | DRAWING NO.: 1 of 1 |

### 1 | TREE PRESERVATION FENCE

L-002 SCALE: N.T.S.

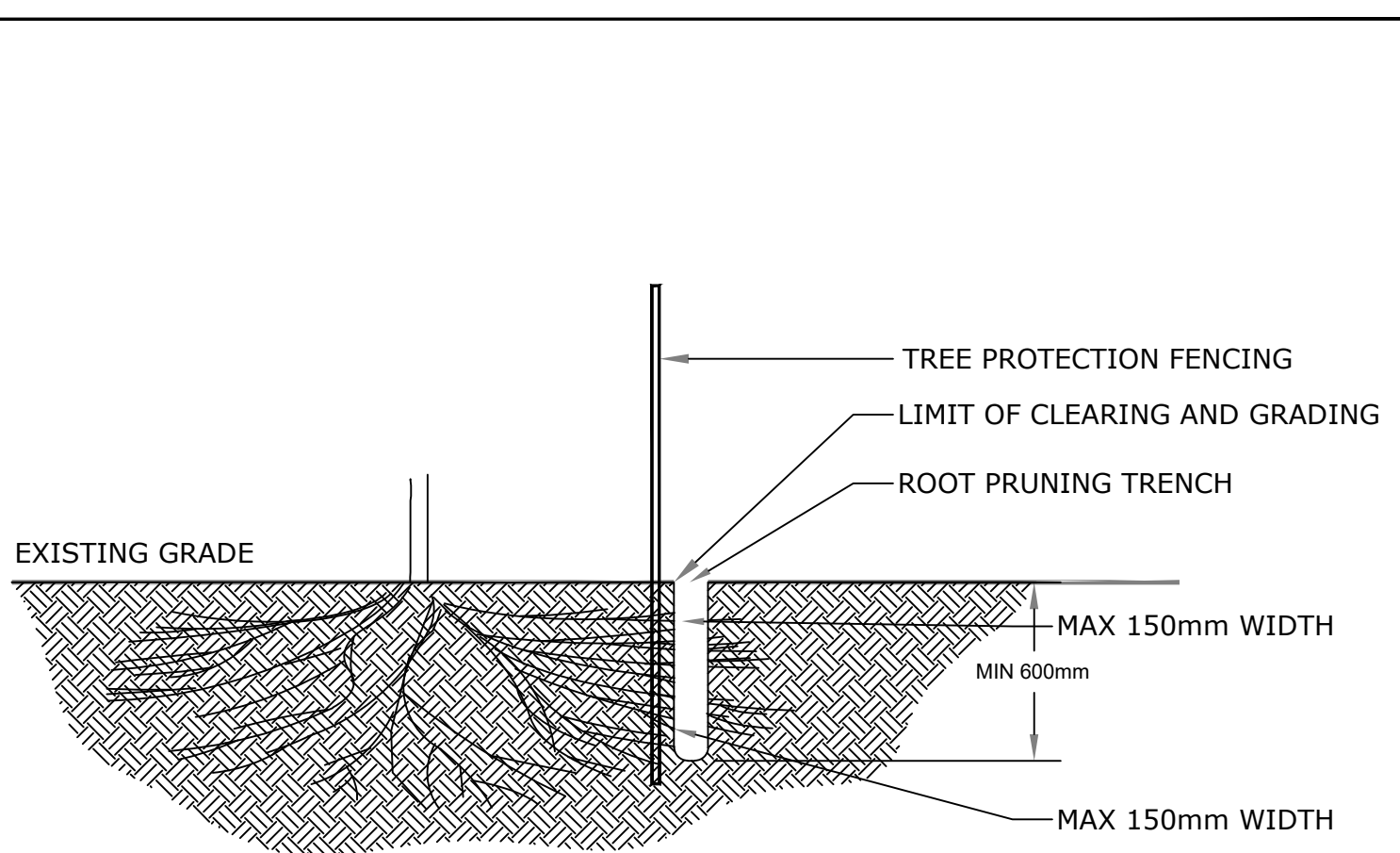

- NOTES:**
- ALL MEASUREMENTS ARE IN MILLIMETRES UNLESS OTHERWISE NOTED
  - PROPER ROOT PRUNING TECHNIQUE REQUIRED WHEN TREE ROOTS ARE ENCOUNTERED DURING EXCAVATION OR PRIOR TO TRANSPLANTING EXISTING TREES
  - EXCAVATIONS WITHIN DRIPLINE SHOULD BE BY DIRECTIONAL MICRO-TUNNELING AND BORING. OUTSIDE THE DRIPLINE, ROOTS SHOULD BE CUT CLEANLY (AS PER ABOVE DRAWING) WITH PRUNING SHEARS OR A SAW WIPED WITH ALCOHOL BEFORE EACH CUT
  - AFTER ROOTS ARE CLEANLY CUT (AND TRANSPLANTING, IF APPLICABLE), THE AREA AROUND THE ROOTS SHOULD BE BACKFILLED WITH SUITABLE MATERIAL (TO BE APPROVED BY LANDSCAPE ARCHITECT) TO PREVENT DESICCATION
  - WHERE APPROPRIATE, THE TREES SHALL UNDERGO AN OVERALL PRUNING TO RESTORE TREE APPEARANCE AND / OR RESTORE THE BALANCE BETWEEN TOP GROWTH AND ROOTS. DO NOT PRUNE LEADERS

|  |                            |                |
|--|----------------------------|----------------|
|  | TITLE: ROOT PRUNING DETAIL | DATE: MAY 2020 |
|  |                            | REV: MAY 2020  |
|  |                            | DWG No: F0     |

### 2 | ROOT PRUNING

L-002 SCALE: N.T.S.

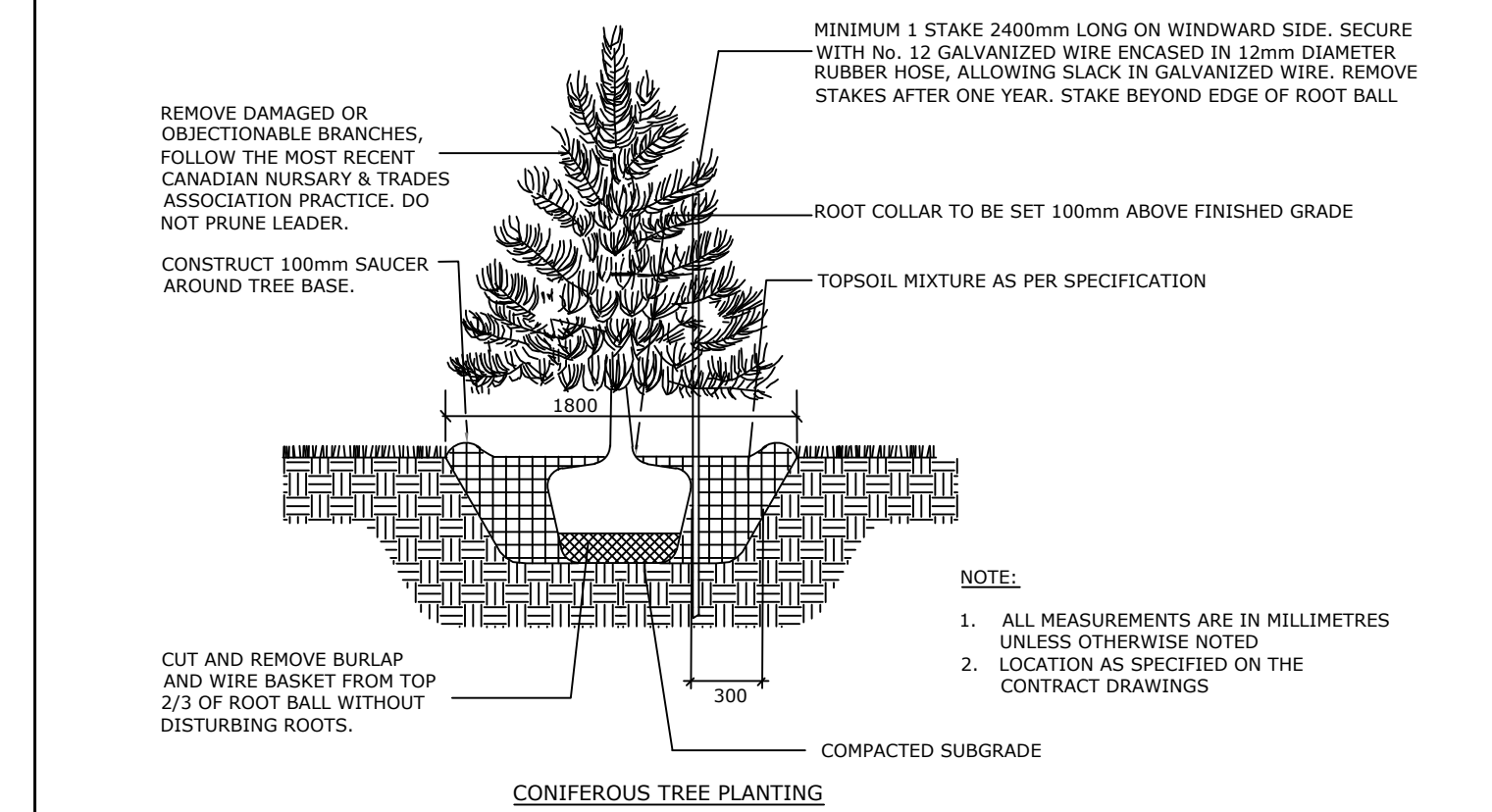
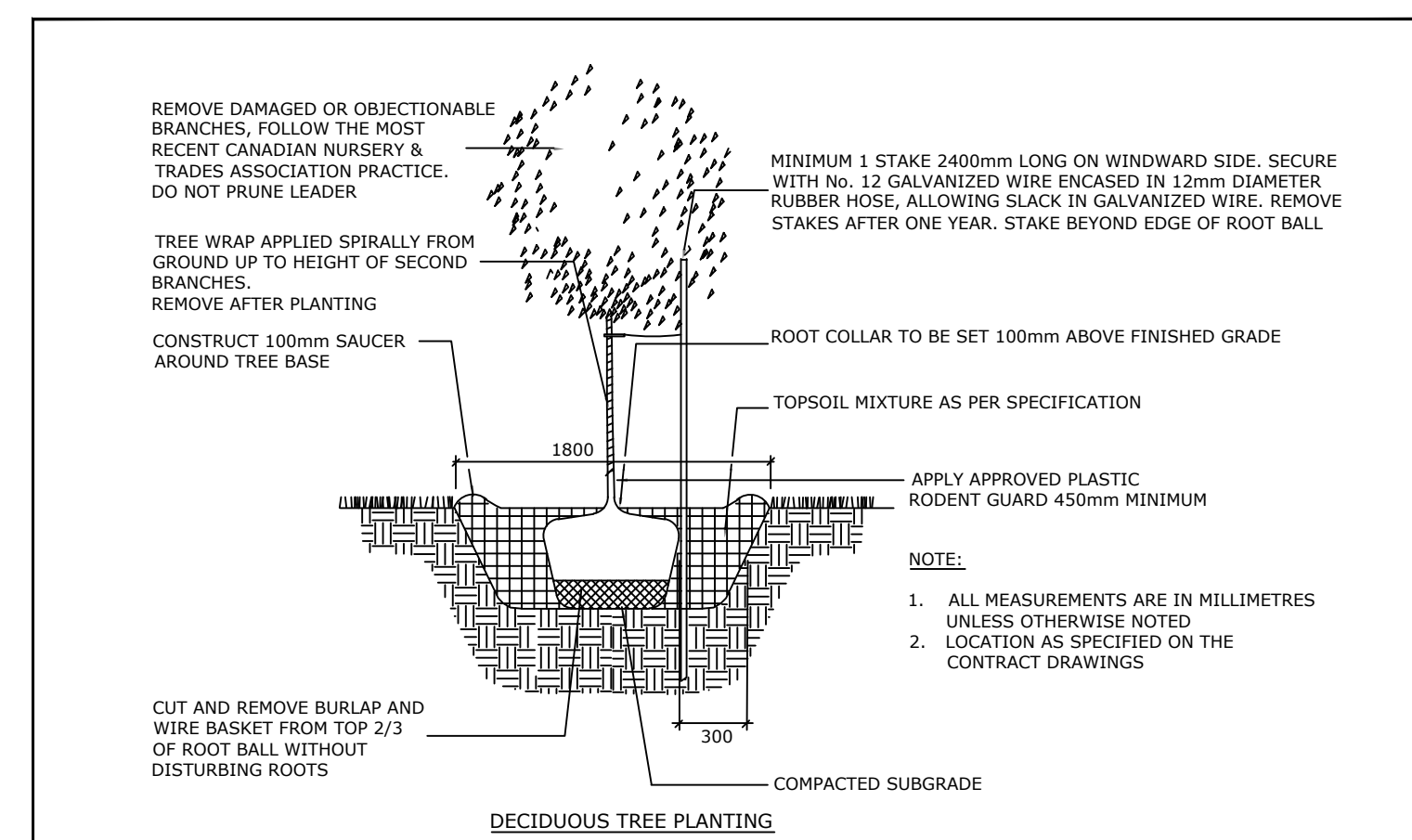

|  |  |                |
|--|--|----------------|
|  | TITLE: PLANTING TRENCH WELL DRAINED SOILS (LOTS) | DATE: MAY 2001 |
|  |  | REV: JAN 2017  |
|  |  | DWG No: L2     |

### 3 | TREE PLANTING

L-002 SCALE: N.T.S.

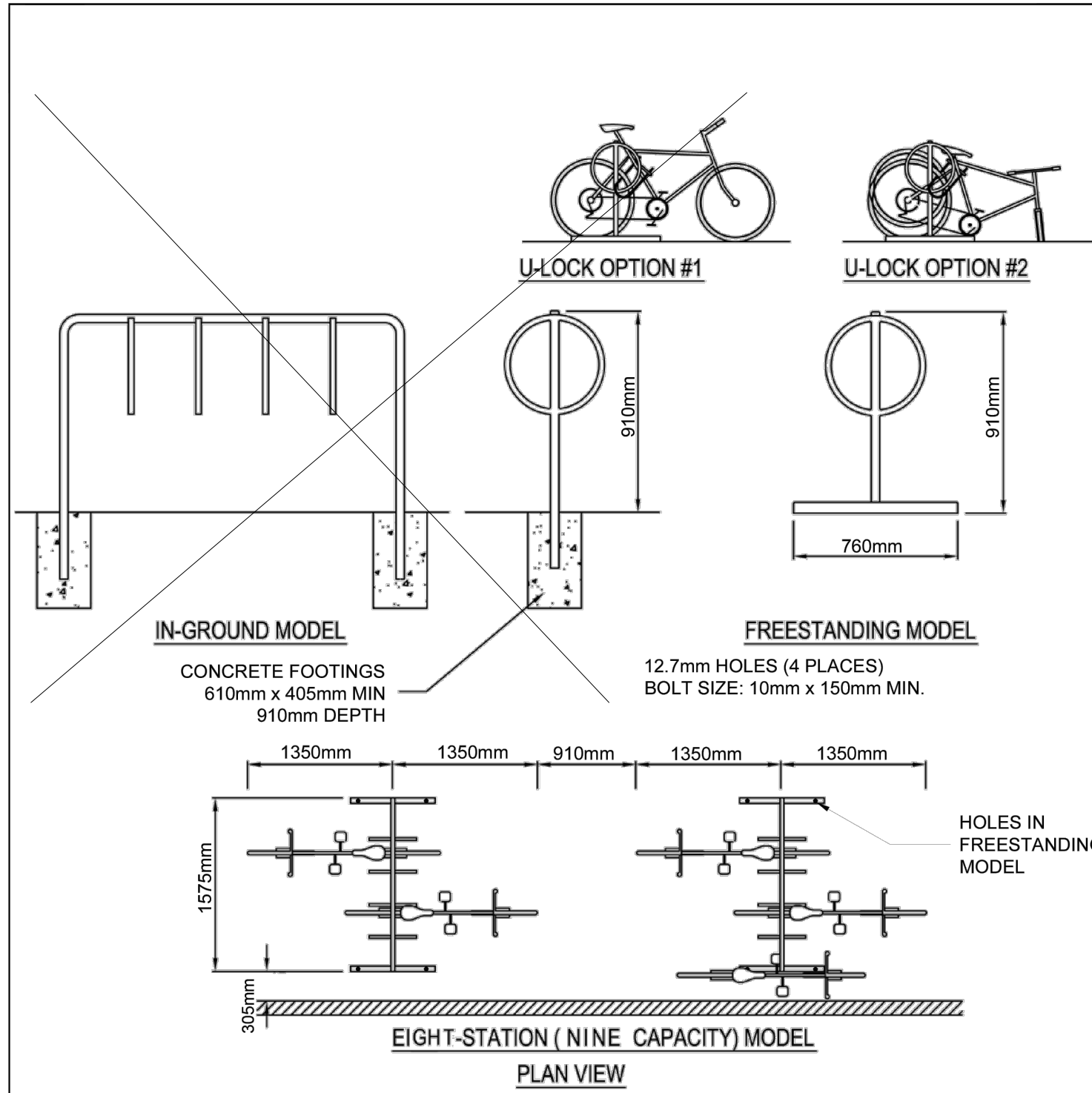

- NOTES:**
- INSTALLATION TO BE COMPLETED IN ACCORDANCE WITH MANUFACTURER'S SPECIFICATIONS
  - SINGLE-RING AND 2-RING HANGER OPTIONS ALSO AVAILABLE
  - BIKE RACK FREE STANDING BOLTED TO THE SLAB. INSTALLATION TO BE COMPLETED IN ACCORDANCE WITH MANUFACTURE'S SPECIFICATIONS.

|  |                              |                |
|--|------------------------------|----------------|
|  | TITLE: RING HANGER BIKE RACK | DATE: FEB 2013 |
|  |                              | REV: MAR 2024  |
|  |                              | DWG No: SF6    |

### 4 | BIKE RACK (provided by OC Transpo)

L-002 SCALE: N.T.S.

**GERALDINE WILDMAN**  
 MANAGER, DEVELOPMENT REVIEW SOUTH  
 PLANNING, DEVELOPMENT AND BUILDING SERVICES  
 DEPARTMENT, CITY OF OTTAWA

**APPROVED**  
 By wildmange at 9:36 pm, Jun 04, 2026



SERVICES D'INFRASTRUCTURE  
 DIRECTION DE CONCEPTION ET DE CONSTRUCTION

FOR / POUR  
 Client - Department  
**Infrastructure and Water Services Department**  
 Design & Construction



**PRIME:**  
 AECOM Canada Architects Ltd.  
 50 Spadina Crossing Road, Suite 200  
 Kitchener, Ontario, N2P 0A4



**SUBCONSULTANT:**  
 GRC ARCHITECTS INC.  
 47 Clarence Street, Suite 401  
 Ottawa, Ontario, K1N 1K1

NOTE: IT IS THE RESPONSIBILITY OF THE CONTRACTORS TO INFORM THEMSELVES OF THE EXACT LOCATION OF, AND ASSUME ALL LIABILITY FOR DAMAGE TO ALL UTILITIES, SERVICES AND STRUCTURES WHETHER ABOVE GROUND OR BELOW GRADE BEFORE COMMENCING THE WORK. SUCH INFORMATION IS NOT NECESSARILY SHOWN ON THE DRAWING, AND WHERE SHOWN, THE ACCURACY CANNOT BE GUARANTEED. WITH THE SOLE EXCEPTION OF THE BENCHMARKS SPECIFICALLY DESCRIBED FOR THIS PROJECT, NO ELEVATION INDICATED OR ASSUMED HEREON IS TO BE USED AS A REFERENCE ELEVATION FOR ANY PURPOSE.

|        |                         |              |          |
|--------|-------------------------|--------------|----------|
| 1      | ISSUED FOR TENDER       | 2025-12-15   | JB       |
| NUMBER | MILESTONE/FAIT SAILLANT | DATE (Y/M/D) | INITIALS |

|                         |                          |                 |
|-------------------------|--------------------------|-----------------|
| DESIGNED BY / CONÇU PAR | CHECKED BY / VÉRIFIÉ PAR | SCALE: ESQUELLE |
| SS                      | SS                       | N.T.S.          |

1 | DRAWING TITLE  
 SCALE: N.T.S.  
 SHEET NUMBER

THIS DRAWING IS THE PROPERTY OF THE CITY OF OTTAWA AND ALL COPYRIGHT IS RESERVED. DIMENSIONS ON DRAWINGS ARE FOR ESTIMATING PURPOSES ONLY. IT IS THE RESPONSIBILITY OF EACH CONTRACTOR AND SUB-CONTRACTOR OR CONSULTANT TO CHECK AND VERIFY ALL DIMENSIONS AND CONDITIONS ON SITE. NOTIFY OWNER OF ANY ERRORS OR OMISSIONS PRIOR TO COMMENCING THE WORK. DO NOT SCALE THE DRAWINGS.

CE Dessin constitue la propriété de la Ville d'Ottawa et tout droit d'auteur est réservé. Les dimensions utilisées ne sont à des fins d'estimation seulement. Il incombe à chaque entrepreneur, sous-contractant ou consultant de vérifier toutes les dimensions et les conditions sur le chantier. Veuillez informer le propriétaire de toute erreur ou omission avant d'entamer les travaux. Ne dessinez pas les plans à l'échelle.

ARCHITECT / ARCHITECTE  
  
 CONSULTANT / EXPERT-CONSEIL

PROJECT / LOCATION / PROJET / ENDROIT  
**OTC ZEB-New Garage**  
 Enter address here,  
 OTTAWA, ONTARIO

DRAWING / DESSIN  
**TREE PRESERVATION AND LANDSCAPE DETAILS**

|                                      |                         |
|--------------------------------------|-------------------------|
| BUSINESS ENTITY / NUMÉRO DE L'ENTITÉ | SHEET NO. / FEUILLE No. |
| OMF1                                 | L002                    |
| CITY PROJECT NO. / NUMÉRO DE PROJET  |                         |
| 60716350                             |                         |

File Number D07-12-25-0095  
 Plan Number 19357

\*Toute reproduction ou divulgation de ce document, intégrale ou partielle, sans le consentement de Plastiques Cascades Re-Plast est interdite.

**NOTE GÉNÉRALE:**  
ARRONDIR LES ARRÊTÉS VIVES

|  |   |   |   |                             |                     |                          |
|--|---|---|---|-----------------------------|---------------------|--------------------------|
| <b>Cascades</b><br>Plastiques Cascades Re-Plast<br>1300 14 <sup>e</sup> Quai des Stations<br>102 du Bois-Corbière (Est)<br>Canada, J0C 1A0<br>1-888-312-2440 | <b>Division</b><br>4115<br>x.x<br>x.x<br>x.x<br>x.x | <b>Projet</b><br>2019-01<br>2019-01<br>2019-01<br>2019-01 | <b>Client</b><br>CITY OF OTTAWA<br>Description:<br>BANC AVEC DOSSIER #194110-CO-3AC | <b>Site</b><br>2019-01-2019 | <b>Scale</b><br>1:1 | <b>Notes</b><br>183.8 lb |
|--|---|---|---|-----------------------------|---------------------|--------------------------|

1 | BENCH (provided by OC Transpo)  
L-003 SCALE: N.T.S.

**PLAN VIEW**

**SECTION 'A'**

**SECTION 'B'**

**NOTES:**

1. ALL MEASUREMENTS ARE IN MILLIMETRES UNLESS OTHERWISE NOTED
2. ADJACENT TO EXISTING SIDEWALK
3. PLACE ASPHALT IMPREGNATED STRIP BETWEEN EXISTING SIDEWALK AND INSTALLED PRECAST CONCRETE PAD
4. CSA 30MPa CONCRETE (PRECAST SLAB)
5. INSTALL PRECAST CONCRETE SLAB LEVEL WITH ADJACENT BF ROUTE

**OTAWA** TITLE: ACCESSIBLE CONCRETE PAD FOR BENCHES DATE: APR 2013  
SCALE: N.T.S. DWS No: PF-02

2 | CONCRETE PAD FOR BENCH  
L-003 SCALE: N.T.S.

*G. Wildman*

**GERALDINE WILDMAN**  
MANAGER, DEVELOPMENT REVIEW SOUTH  
PLANNING, DEVELOPMENT AND BUILDING SERVICES  
DEPARTMENT, CITY OF OTTAWA

**APPROVED**  
By wildmange at 9:36 pm, Jun 04, 2026

**NOTE:**  
IT IS THE RESPONSIBILITY OF THE CONTRACTORS TO INFORM THEMSELVES OF THE EXACT LOCATION OF, AND ASSUME ALL LIABILITY FOR DAMAGE TO ALL UTILITIES, SERVICES AND STRUCTURES WHETHER ABOVE GROUND OR BELOW GRADE BEFORE COMMENCING THE WORK. SUCH INFORMATION IS NOT NECESSARILY SHOWN ON THE DRAWING, AND WHERE SHOWN, THE ACCURACY CANNOT BE GUARANTEED. WITH THE SOLE EXCEPTION OF THE BENCHMARKS SPECIFICALLY DESCRIBED FOR THIS PROJECT, NO ELEVATION INDICATED OR ASSUMED HEREON IS TO BE USED AS A REFERENCE ELEVATION FOR ANY PURPOSE.

|        |                         |              |          |
|--------|-------------------------|--------------|----------|
| 1      | ISSUED FOR TENDER       | 2025-12-15   | JB       |
| NUMBER | MILESTONE/FAIT SAILLANT | DATE (Y/M/D) | INITIALS |

DESIGNED BY / CONÇU PAR: [ ] CHECKER: [ ]

DRAWN BY / DÉSSINÉ PAR: [ ] SCALE: ECHELLE: [ ]

1 | DRAWING TITLE  
A1.1 SCALE: [ ] SHEET NUMBER: [ ]

THIS DRAWING IS THE PROPERTY OF THE CITY OF OTTAWA AND ALL COPYRIGHT IS RESERVED. DIMENSIONS ON DRAWINGS ARE FOR ESTIMATING PURPOSES ONLY. IT IS THE RESPONSIBILITY OF EACH CONTRACTOR AND SUB-CONTRACTOR OR CONSULTANT TO CHECK AND VERIFY ALL DIMENSIONS AND CONDITIONS ON SITE. NOTIFY OWNER OF ANY ERRORS OR OMISSIONS PRIOR TO COMMENCING THE WORK. DO NOT SCALE THE DRAWINGS.

CE DESSIN CONSTITUE LA PROPRIÉTÉ DE LA VILLE D'OTTAWA ET TOUT DROIT D'AUTEUR EST RÉSERVÉ. LES DIMENSIONS UTILISÉES LE SONT À DES FINS D'ESTIMATION SEULEMENT. IL INCOMBE À CHAQUE ENTREPRENEUR, SOUS-CONTRACTANT OU CONSULTANT DE VÉRIFIER TOUTES LES DIMENSIONS ET LES CONDITIONS SUR LE CHANTIER. VEUILLEZ INFORMER LE PROPRIÉTAIRE DE TOUTE ERREUR OU OMISSION AVANT D'ENTAMER LES TRAVAUX. NE DRESSÉZ PAS LES PLANS À L'ÉCHELLE.

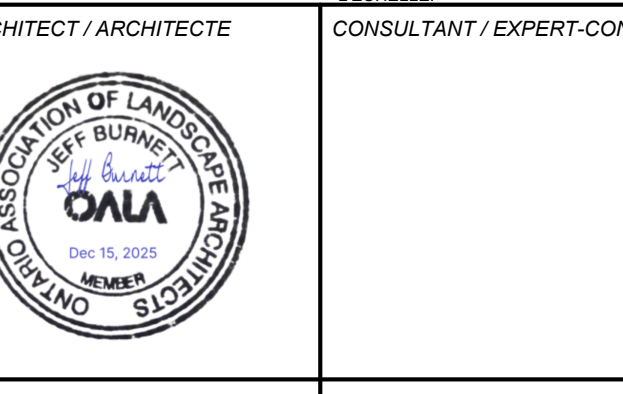

ARCHITECT / ARCHITECTE: [ ] CONSULTANT / EXPERT-CONSEIL: [ ]

PROJECT / LOCATION / PROJET / ENDROIT  
**OTC ZEB-New Garage**  
Enter address here,  
OTTAWA, ONTARIO

DRAWING / DESSIN  
**LANDSCAPE DETAILS**