



Chick-fil-A

Chick-fil-A
5200 Buffington Road
Atlanta, Georgia 30349-2998

exp Services Inc.
T: +1.905.793.9800 | F: +1.905.793.0641
1595 Clark Boulevard
Brampton, ON L6T 4V1
Canada

www.exp.com



• BUILDINGS • EARTH & ENVIRONMENT • ENERGY •
• INDUSTRIAL • INFRASTRUCTURE • SUSTAINABILITY

CHICK-FIL-A COLLEGE SQUARE

1984 Baseline Road
Ottawa, ON

FSR#30088

BUILDING TYPE / SIZE: IP02 SE
RELEASE:

REVISION SCHEDULE		
NO.	DATE	DESCRIPTION
A	2025-09-16	FOR SPA
B	2025-11-07	FOR SPA
C	2026-05-15	FOR SPA

CONSULTANT PROJECT # BSM0023002042-WO
PROJECT STATUS SPA
DATE SEPTEMBER 2025
DRAWN BY T.M.

Information contained on this drawing and in all digital files produced for above named project may not be reproduced in any manner without express written or verbal consent from authorized project representatives.

SHEET
CONSTRUCTION
MANAGEMENT PLAN

SHEET NUMBER

CMP1

FILE NUMBER 007-12-25-0159
PLAN NUMBER 19453

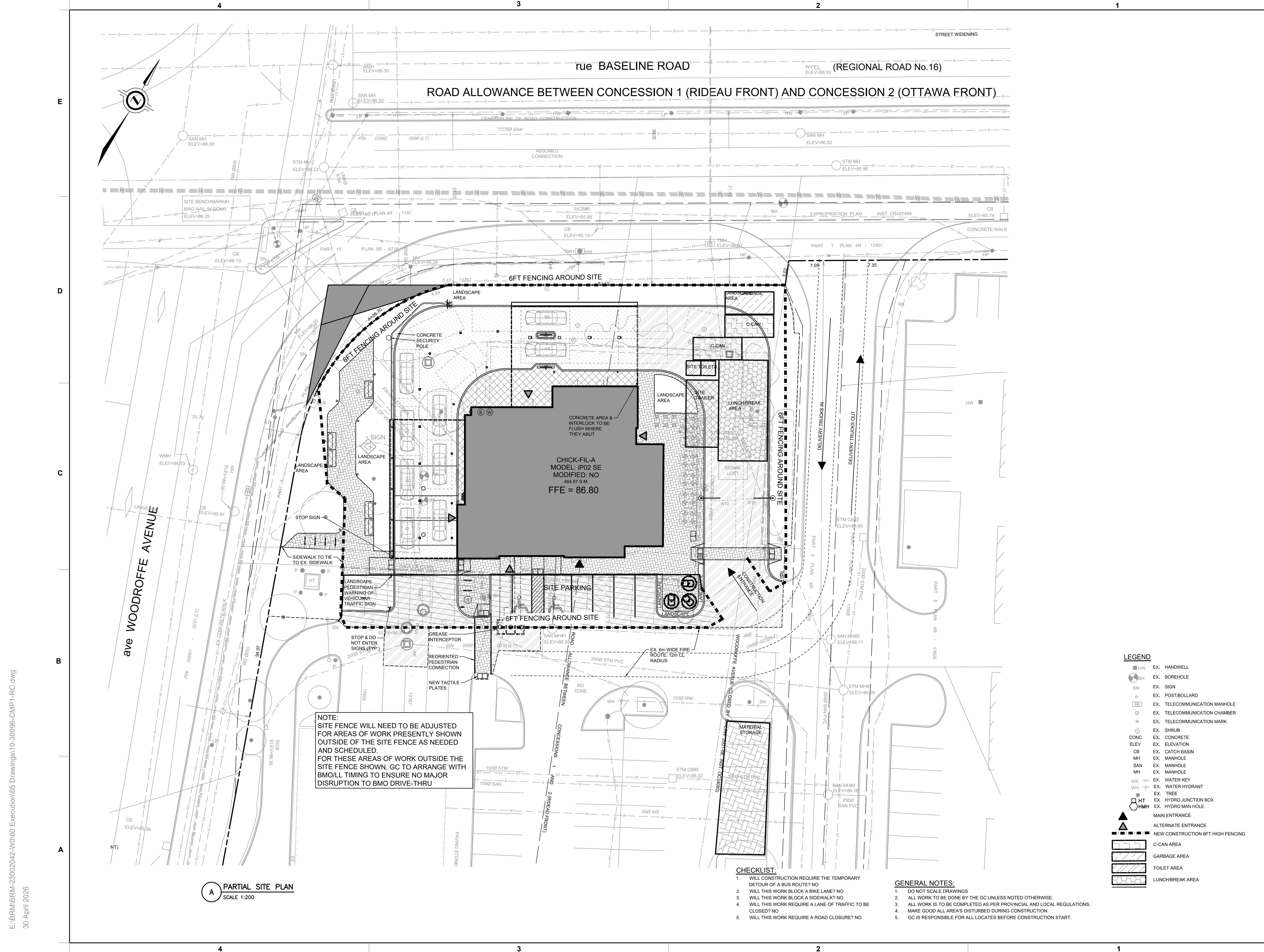

A PARTIAL SITE PLAN
SCALE 1:200

NOTE:
SITE FENCE WILL NEED TO BE ADJUSTED FOR AREAS OF WORK PRESENTLY SHOWN OUTSIDE OF THE SITE FENCE AS NEEDED AND SCHEDULED.
FOR THESE AREAS OF WORK OUTSIDE THE SITE FENCE SHOWN, GC TO ARRANGE WITH BMO/LL TIMING TO ENSURE NO MAJOR DISRUPTION TO BMO DRIVE-THRU

- CHECKLIST:**
1. WILL CONSTRUCTION REQUIRE THE TEMPORARY DETOUR OF A BUS ROUTE? NO
 2. WILL THIS WORK BLOCK A BIKE LANE? NO
 3. WILL THIS WORK BLOCK A SIDEWALK? NO
 4. WILL THIS WORK REQUIRE A LANE OF TRAFFIC TO BE CLOSED? NO
 5. WILL THIS WORK REQUIRE A ROAD CLOSURE? NO

- GENERAL NOTES:**
1. DO NOT SCALE DRAWINGS
 2. ALL WORK IS TO BE DONE BY THE GC UNLESS NOTED OTHERWISE.
 3. ALL WORK IS TO BE COMPLETED AS PER PROVINCIAL AND LOCAL REGULATIONS.
 4. MAKE GOOD ALL AREA'S DISTURBED DURING CONSTRUCTION.
 5. GC IS RESPONSIBLE FOR ALL LOCATES BEFORE CONSTRUCTION START.

LEGEND

	EX. HANDWELL
	EX. BOREHOLE
	EX. SIGN
	EX. POST/BOLLARD
	EX. TELECOMMUNICATION MANHOLE
	EX. TELECOMMUNICATION CHAMBER
	EX. TELECOMMUNICATION MARK
	EX. SHRUB
	EX. CONCRETE
	EX. ELEVATION
	EX. CATCH BASIN
	EX. MANHOLE
	EX. MANHOLE
	EX. HYDRO JUNCTION BOX
	EX. HYDRO MAN HOLE
	MAIN ENTRANCE
	ALTERNATE ENTRANCE
	NEW CONSTRUCTION 6FT HIGH FENCING
	C-CAN AREA
	GARBAGE AREA
	TOILET AREA
	LUNCH/BREAK AREA

E:\BIRM\BIRM-23002042-WO\60 Execution\65 Drawings\10-30096-CMP1-FC.dwg
30 April 2026