

Copyright Reserved

The Contractor shall verify and be responsible for all dimensions. DO NOT scale the drawing - any errors or omissions shall be reported to Stantec without delay.
The Copyrights to all designs and drawings are the property of Stantec. Reproduction or use for any purpose other than that authorized by Stantec is forbidden.

Legend

- PROPOSED WATERMAIN
- PROPOSED VALVE AND VALVE BOX
- PROPOSED VALVE CHAMBER
- PROPOSED W3 CHAMBER
- PROPOSED REDUCER
- PROPOSED FIRE HYDRANT
- PROPOSED SANITARY SEWER
- PROPOSED STORM SEWER
- PROPOSED CATCHBASIN MANHOLE
- PROPOSED CATCHBASIN
- PROPOSED CB 1 AND SUBDRAIN
- EXISTING WATERMAIN
- EXISTING VALVE AND VALVE BOX
- EXISTING VALVE CHAMBER
- EXISTING REDUCER
- EXISTING FIRE HYDRANT
- EXISTING COMBINED SEWER
- EXISTING STORM SEWER
- EXISTING CATCHBASIN MANHOLE
- EXISTING CATCHBASIN
- PROPOSED DEPRESSED CURB LOCATIONS
- PROPOSED BARRIER CURB
- THERMAL INSULATION ON STORM SEWER WHERE COVER IS LESS THAN 2.0m AND ON SANITARY SEWER WHERE COVER IS LESS THAN 2.5m AS PER S35.
- WATER METER
- REMOTE WATER METER
- PROPOSED 2hr RATED FIRE WALL LOCATION
- BACK TO BACK TERRACE HOME SERVICES
- 200mm STORM SERVICE PVC SDR 26 @ 1% MIN
- 150mm SANITARY SERVICE PVC SDR 26 @ 1% MIN
- 19mm PEX TUBING WATER SERVICE C/W CURB STOP AND SERVICE POST
- BACK TO BACK TERRACE HOME SERVICE ELEVATIONS

Notes

- 3 REVISED SITE PLAN AND CITY COMMENTS
 - 2 WATER ENTRY BUILDING C
 - 1 REVISED SITE PLAN
 - 0 ISSUED FOR SPA
- Revision
- | | | | | |
|------------|------|-------|------|----------|
| File Name: | MJS | DT | MJS | 25.09.20 |
| | Dwn. | Chkd. | Dgn. | YFMMDD |

Permit-Seal

Client/Project	MATTAMY HOMES LTD. 50 HINES ROAD, SUITE 100 OTTAWA, ON, K2K 2M5
	NORTHWOODS SUBDIVISION PHASE 6, BLOCK 454 OTTAWA, ON, CANADA
Title	SITE SERVICING PLAN
Project No.	160402120
Drawing No.	SSP-1
Scale	0 2.5 7.5 12.5m 1:250
Sheet	3 of 7
Revision	3

KEY PLAN
N.I.S.

200mm WATERMAIN TABLE A

STATION	FINISHED GRADE	TOP W/M	ITEM
0+00	81.1	78.700	200mmØ CAP AND THRUST BLOCK
0+01.5	81.08	78.680	W3 CHAMBER AND VALVE
0+017.5	81.05	78.65±	300mm X 200mm CROSS
0+025.5	81.00	78.600	200mm VALVE AND BOX
0+040	81.10	78.700	TOP OF PIPE
0+043.0	81.00	78.600	22 1/4° HORIZONTAL BEND
0+060	81.26	78.860	TOP OF PIPE
0+069.28	81.40	79.000	200mm x 200mm TEE
0+075.28	81.40	79.000	200mm VALVE AND BOX
0+080	81.33	78.930	TOP OF PIPE
0+100	81.31	78.910	TOP OF PIPE
0+101.36	81.31	78.910	22 1/4° HORIZONTAL BEND
0+103.18	81.29	78.890	45° HORIZONTAL BEND
0+113.92	81.28	78.880	FIRE HYDRANT
0+120	81.41	79.010	TOP OF PIPE
0+127.54	81.25	78.850	22 1/4° HORIZONTAL BEND
0+140	81.42	79.020	45° HORIZONTAL BEND
0+142.33	81.43	79.030	45° HORIZONTAL BEND
0+154.52	81.41	79.010	200mm VALVE AND BOX
0+160	81.40	79.000	TOP OF PIPE
0+178.68	81.46	79.060	45° HORIZONTAL BEND
0+183.64	81.48	79.080	FIRE HYDRANT
0+188.32	81.44	79.040	45° HORIZONTAL BEND
0+197.06	81.35	78.950	200mm x 200mm TEE
0+212.37	81.27	78.870	200mm VALVE AND BOX
0+219.4	81.50	79.100	200mm x 200mm TEE

200mm WATERMAIN TABLE B

STATION	FINISHED GRADE	TOP W/M	ITEM
0+000	81.35	78.950	200mm x 200mm TEE
0+006	81.52	79.120	200mm VALVE AND BOX
0+017.20	81.90	79.500	200mm x 150mm TEE
0+020	81.85	79.450	TOP OF PIPE
0+030	81.63	79.230	TOP OF PIPE
0+034.9	81.49	79.090	W3 CHAMBER AND VALVE
0+040.7	81.32	78.920	5° LONG BEND
0+043.7	81.21	78.810	11 1/4° HORIZONTAL BEND
0+045.4	81.26	78.91±	300mm x 200mm TEE

SEWER AND WATERMAIN CROSSING TABLE

CROSSING	STM INV	STM OBV	SAN INV	SAN OBV	WTR TOP	WTR BIM
▲	77.08(76.98)	77.68(77.78)	76.38	76.68		
▲	77.09(76.99)	77.69(77.79)	76.84	77.11	78.70	78.40
▲	76.76(76.64)	77.66(77.78)	77.81	78.06		
▲	77.67	77.97	77.09	77.34	78.59	78.39
▲	79.57	79.77	77.18	77.43	78.60	78.40
▲	78.35	78.55	77.29	77.54	78.85	79.05
▲	77.89(77.80)	78.42(78.52)	78.67	78.92		
▲	77.90(77.81)	78.43(78.52)	78.65	78.90	79.29	79.09
▲	79.12	79.50	78.73	78.98	78.23	78.03
▲	79.19	79.57	79.84	79.99		
▲	78.61	78.41	78.63	78.83	78.97	78.77
▲	78.04(77.94)	78.49(78.57)			78.88	78.68
▲	74.78	77.08	76.84	77.74	78.92	78.72
▲	77.05	77.95	77.94	78.24	78.84	78.64

* BRACKETS DENOTE ADJUSTED VALUE WITH CONCRETE PIPE THICKNESS

Catchbasin ID	Tributary Area ID	ICD Type	ICD	2yr Head (m)	100yr Head (m)	2yr Flow (L/s)	100yr Flow (L/s)
CB 100A	L100A	152mm Orifice	0.23	1.46	18.3	53.9	
CB 100B	L100B	152mm Orifice	0.61	1.56	4.5	7.1	
CB 100C	L100A, L100B, L100C	127mm Orifice	0.6	1.55	22.5	36.6	
CB 104C	L104	140mm Orifice	2.02	2.45	54.5	60.2	
CB 105A	L105A	85mm Orifice	0.61	1.53	10.4	16.7	
CB 106A	L106	152mm Orifice	0.66	1.77	21.6	48.1	

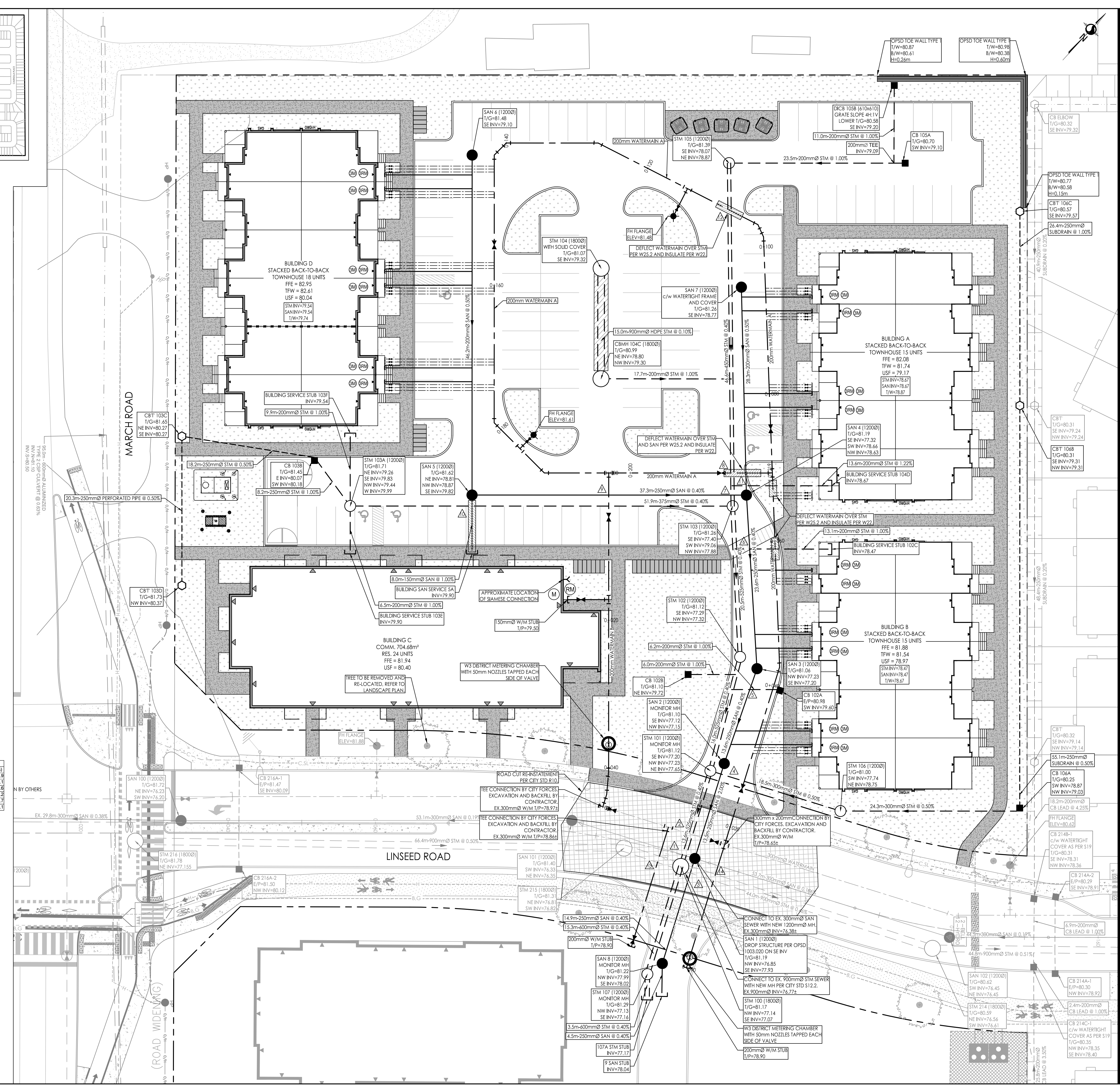
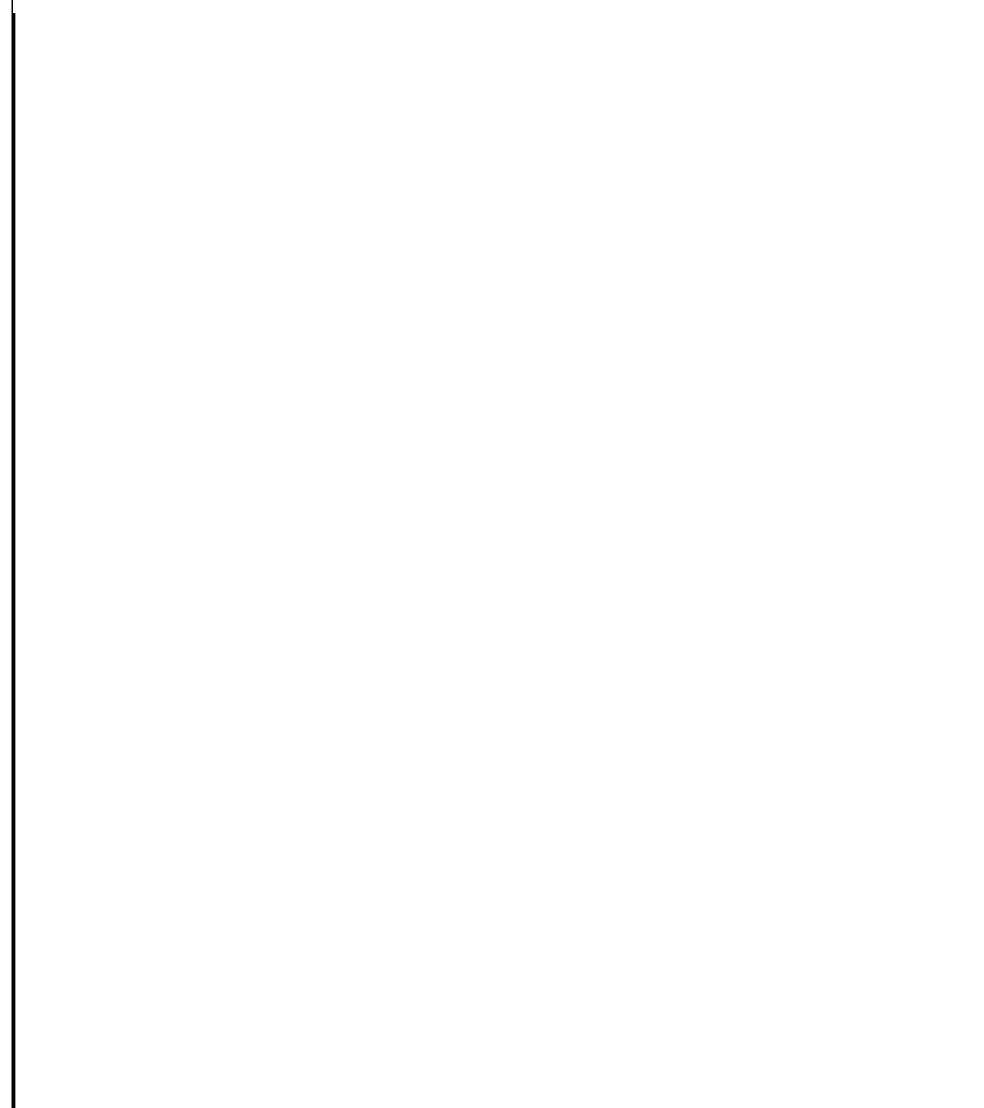

Client/Project

MATTAMY HOMES LTD.
50 HINES ROAD, SUITE 100
OTTAWA, ON, K2K 2M5

NORTHWOODS SUBDIVISION
PHASE 6, BLOCK 454
OTTAWA, ON, CANADA

Title

SITE SERVICING PLAN

Project No. 160402120

Drawing No. SSP-1

Scale 0 2.5 7.5 12.5m
1:250

Sheet 3 of 7

Revision 3

PLN # 19393