

Copyright Reserved

The Contractor shall verify and be responsible for all dimensions. DO NOT scale the drawing - any errors or omissions shall be reported to Stantec without delay.  
The Copyrights to all designs and drawings are the property of Stantec. Reproduction or use for any purpose other than that authorized by Stantec is forbidden.

Legend

- R100A**  
0.31 | 50  
SANITARY DRAINAGE AREA ID#  
POPULATION COUNT  
SANITARY DRAINAGE AREA ha.
- G100A**  
0.11 | INFL  
SANITARY DRAINAGE AREA ID#  
INFILTRATION RATE OF 0.33 L/s/ha APPLIED  
SANITARY DRAINAGE AREA ha.
- SANITARY DRAINAGE AREA**  
SANITARY DRAINAGE AREA
- PROPOSED SANITARY MH AND SEWER**  
PROPOSED SANITARY MH AND SEWER
- EXISTING SANITARY MH AND SEWER**  
EXISTING SANITARY MH AND SEWER
- THERMAL INSULATION ON SANITARY SEWER WHERE COVER IS LESS THAN 2.5m AS PER S35.**  
THERMAL INSULATION ON SANITARY SEWER WHERE COVER IS LESS THAN 2.5m AS PER S35.

Notes

3	REVISED SITE PLAN AND CITY COMMENTS	KV	KS	26.05.20
2	WATER ENTRY BUILDING C	KV	KS	26.03.19
1	REVISED SITE PLAN	KV	KS	26.03.17
0	ISSUED FOR SPA	MJS	KS	25.11.07
Revision		By	Appd.	YY.MM.DD
File Name: 160402120.dwg		MJS	DT	MJS
		Dwn.	Chkd.	Dgn.
				YY.MM.DD

Permit-Seal

Client/Project

MATTAMY HOMES LTD.  
50 HINES ROAD, SUITE 100  
OTTAWA, ON. K2K 2M5

NORTHWOODS SUBDIVISION  
PHASE 6, BLOCK 454  
OTTAWA, ON, CANADA

Title

SANITARY DRAINAGE PLAN

Project No.	Scale	0	2.5	7.5	12.5m
160402120	1:250				
Drawing No.	Sheet	Revision			

SA-1 7 of 7 3  
PLAN # 19393

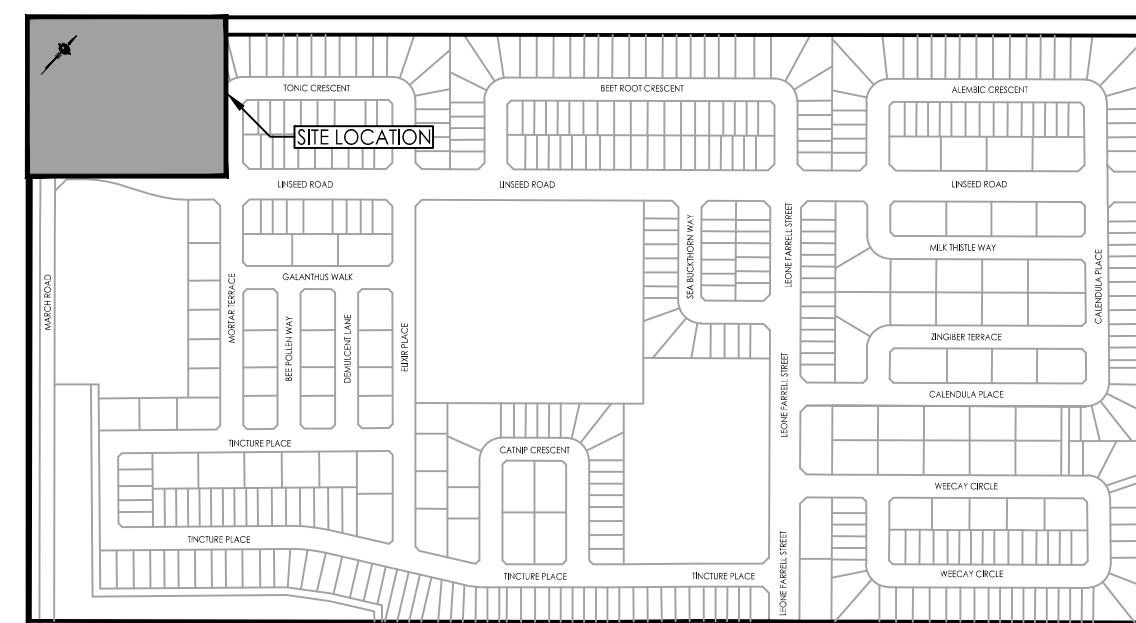

KEY PLAN  
N.T.S.

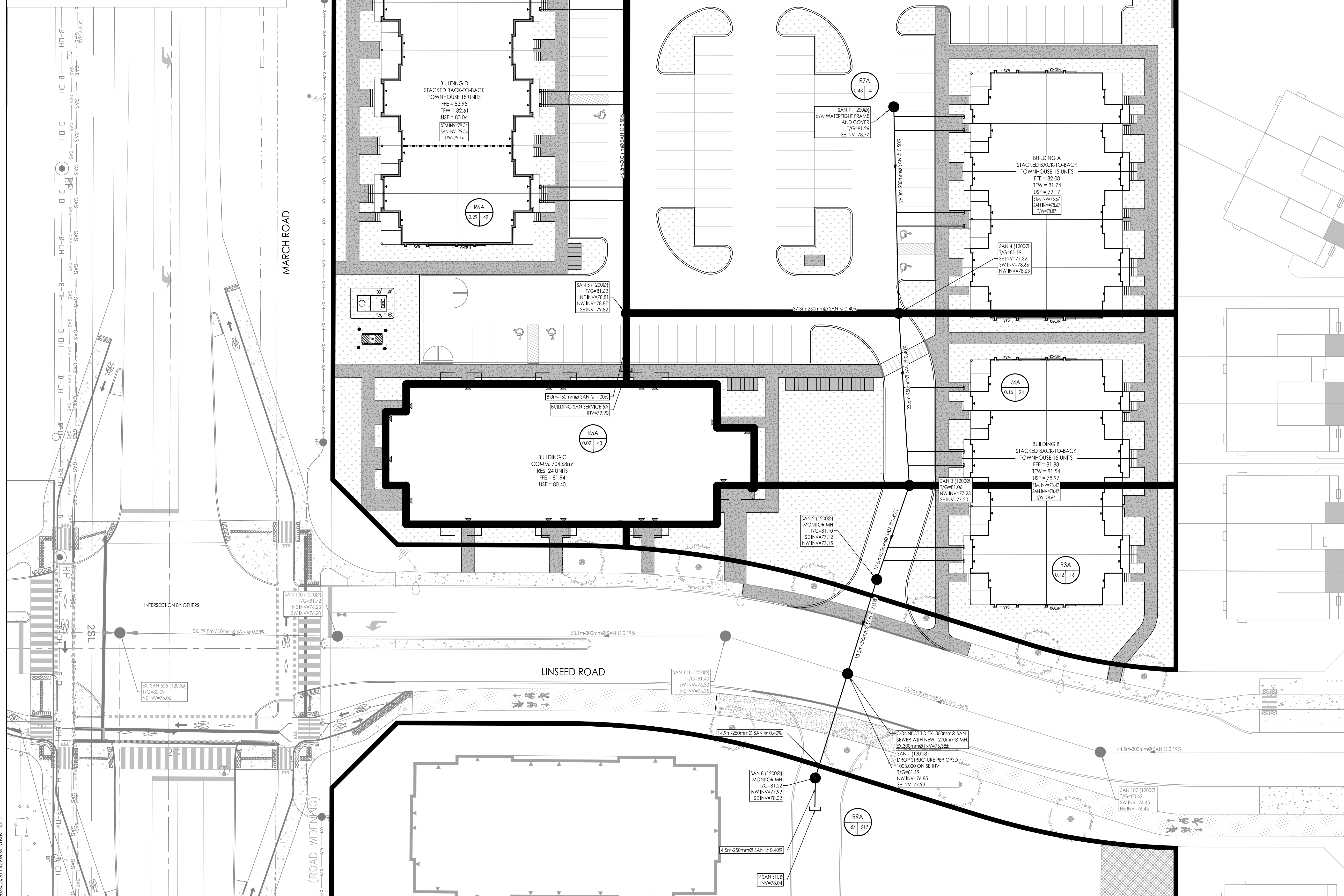

ORIGINAL SHEET - ARCH D