

2 TREE PROTECTION BARRIER DETAIL  
L-001 1:200

**TREE PROTECTION REQUIREMENTS:**

- FROM TO ANY WORK ACTIVITY WITHIN THE CRITICAL ROOT ZONE (CRZ) 10 X DIAMETER OF A TREE, TREE PROTECTION FENCING MUST BE INSTALLED SURROUNDING THE CRITICAL ROOT ZONE AND REMAIN IN PLACE UNTIL THE WORK IS COMPLETE.
- UNLESS PLACES ARE APPROVED BY CITY FORESTRY STAFF, FOR WORK WITHIN THE CRZ: DO NOT PLACE ANY MATERIAL OR EQUIPMENT - INCLUDING SOFTWHEELS - DO NOT ATTACH ANY SIGNS, NOTICES OR POSTERS TO ANY TREE; DO NOT MAKE LOWER THE EXISTING GRADE; DO NOT TUNNEL OR BORE WHEN DIGGING; DO NOT DAMAGE THE ROOT SYSTEM, TRUNK OR BRANCHES OR ANY TREE; BRIDGE TRUNK BRANCHES FROM ALL COMPONENTS ARE NOT DIRECTED TOWARD ANY TREE CANOPY; DO NOT STRENGTHEN HARD SURFACE OR SIGNIFICANTLY CHANGE LANDSCAPING.
- TREE PROTECTION FENCING MUST BE AT LEAST 1.2M IN HEIGHT, AND CONSTRUCTED OF RIGID OR FRAMED MATERIALS (E.G. MODULOC, STEEL, FIBREWOOD HOUSING, OR SHOU TRICE) ON A 2" X 4" WOOD FRAME WITH POSTS 2.4M APART, SUCH THAT THE FENCE LOCATION CANNOT BE ALTERED. ALL SUPPORTS AND BRACKING MUST BE PLACED OUTSIDE OF THE CRZ, AND INSTALLATION MUST MINIMIZE DAMAGE TO EXISTING ROOTS. SEE DETAIL.
- THE LOCATION OF THE TREE PROTECTION FENCING MUST BE DETERMINED BY AN ARBORIST AND DETAILED ON ANY ASSOCIATED PLAN FOR THE SITE. THE PLAN AND CONSTRUCTED FENCING MUST BE APPROVED BY CITY FORESTRY STAFF PRIOR TO THE COMMENCEMENT OF WORK.
- IF THE FENCED TREE PROTECTION AREA MUST BE REDUCED TO FACILITATE CONSTRUCTION, PROTECTION MEASURES MUST BE PRESCRIBED BY AN ARBORIST AND APPROVED BY CITY FORESTRY STAFF. THESE MAY INCLUDE THE PLACEMENT OF FIBREWOOD, WOOD CHIPS, OR STEEL PLATING OVER THE ROOTS FOR PROTECTION OR THE PROPER PRUNING AND CARE OF ROOTS WHERE ENCOUNTERED.

THE CITY'S TREE PROTECTION BY-LAW, 2020-140 PROTECTS BOTH CITY-OWNED TREES, CITY-MAINTAINED AND PRIVATELY OWNED TREES WITHIN THE URBAN AREA. PLEASE REFER TO [WWW.CITYOFOTTAWA.CA/TREELAW](http://WWW.CITYOFOTTAWA.CA/TREELAW) FOR MORE INFORMATION ON HOW THE TREE BY-LAW APPLIES.



**TREE PROTECTION SPECIFICATION**  
TO BE IMPLEMENTED FOR REMAINING TREES, WITH ON-SITE AND ON-ADJACENT SITE, PRIOR TO ANY TREE REMOVAL OR SITE WORKS AND MAINTAINED FOR THE DURATION OF WORK ACTIVITIES ON-SITE.

SCALE:	NTS
DATE:	MARCH 2021
DRAWING NO.:	1 of 1

1 TREE REMOVALS AND PROTECTION PLAN  
L-001 1:200

NOTE: THIS DRAWING IS INTENDED TO BE READ ALONGSIDE ARBORIST REPORT. REFER TO ARBORIST REPORT FOR DETAILED TREE INVENTORY DATA.

**LEGEND**

60000 t-r-d/c 0.1	SURVEYED TREE ID NUMBER d - DECIDUOUS c - CONIFEROUS DECIMAL NUMBER INDICATES TREE DIAMETER
	SURVEYED DECIDUOUS TREE
	SURVEYED CONIFEROUS TREE
	TREE MARKED FOR REMOVAL
	TREE PROTECTION BARRIER
	PROPOSED DECIDUOUS TREE
	PROPOSED CONIFEROUS TREE

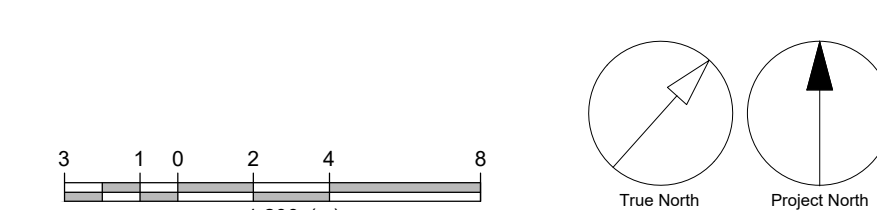

**COPYRIGHT**  
This drawing has been prepared solely for the intended use, thus any reproduction or distribution for any purpose other than authorized by Arcadis is forbidden. Written dimensions shall have precedence over scaled dimensions. Contractors shall verify and be responsible for all dimensions and conditions on the job, and Arcadis shall be informed of any variations from the dimensions and conditions shown on the drawing. Shop drawings shall be submitted to Arcadis for general conformance before proceeding with fabrication.

Arcadis Architects (Canada) Inc.

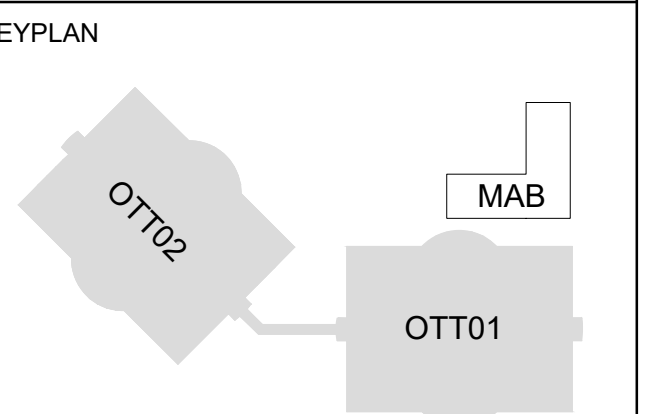

**ISSUES**

NO.	DESCRIPTION	DATE
1	ISSUED FOR SPC #1	2025-12-12
2	ISSUED FOR SPC #2	2025-05-08

- CONSULTANTS**
- ARUP**  
47 Clarence Street, Suite 202,  
Ottawa, ON, K1N 5P9
  - TEECOM**  
1000 10th Street, Suite 100,  
San Francisco, CA 94103  
949.207.2000  
www.teecom.com
  - SENEZ CO**  
FIRE SCIENCE & ENGINEERING  
93 Skyway Avenue, Suite 102  
Toronto, ON, M9W 6N6
  - TOTAL OPENING CONSULTANTS**  
895 Don Mills Rd., Suite 900,  
Toronto, ON M3C 1W3
  - CBRE**  
340 Albert Street, Suite 1900  
Ottawa, ON, K1R 7Y6
  - Matrix**  
6131 Pith Street  
Richmond, ON, K0A 2Z0

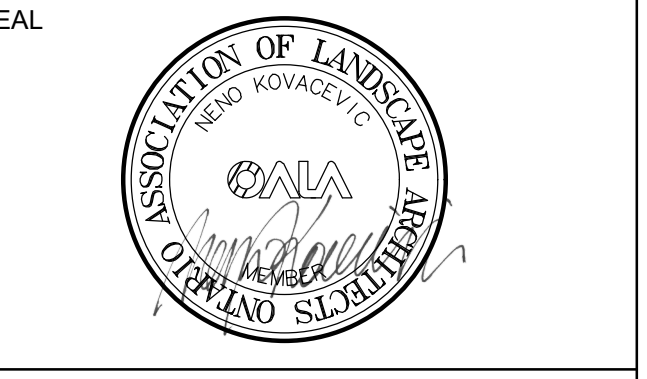

**SPC PACKAGE**  
NOT FOR CONSTRUCTION

**PRIME CONSULTANT**

**ARCADIS**  
333 Preston Street - Suite 500  
Ottawa ON K1S 5N4 Canada  
tel 513 225 1311  
www.arcadis.com

**PROJECT**

CISCO OTTAWA CAMPUS  
MAB  
2000 Innovation Drive,  
Kanata, ON K2K 3E8

PROJECT NO.:	APPLICATION NO.:
MAB-30298433	PC2025-0127
DRAWN BY:	CHECKED BY:
ARCADIS	BJ
PROJECT MGR.:	APPROVED BY:
BJ	NK

**SHEET TITLE**

TREE PROTECTION AND REMOVALS PLAN

SHEET NUMBER	ISSUE
L-001	2

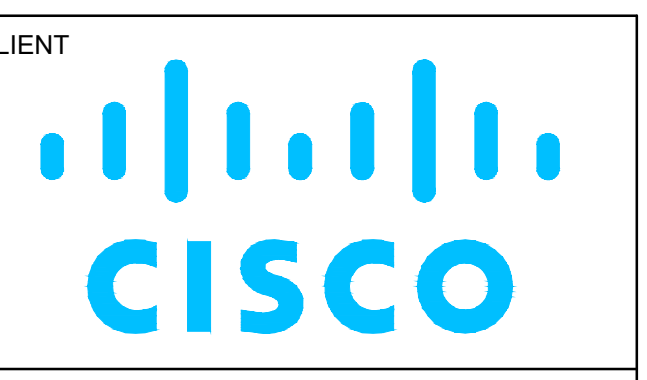
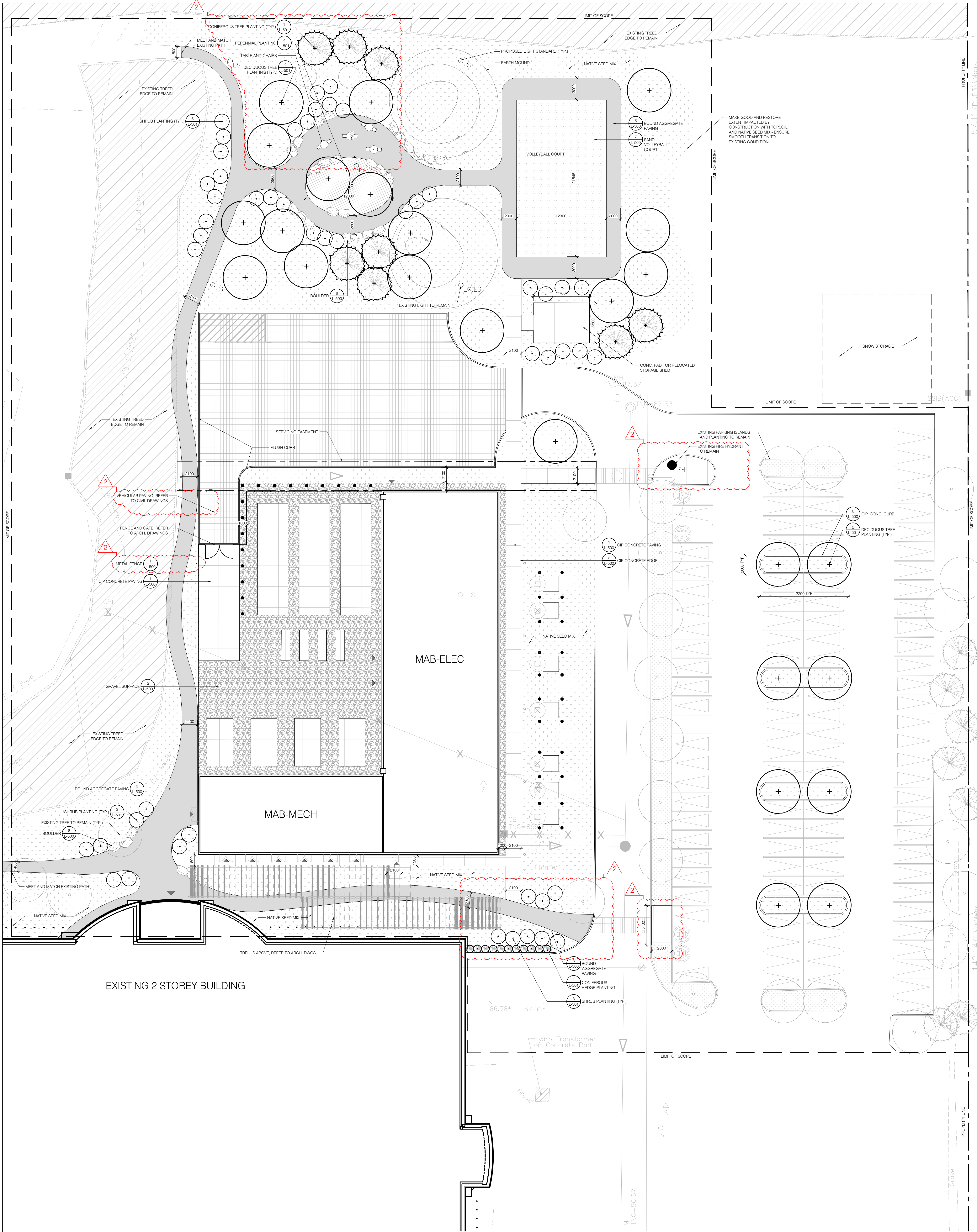

**COPYRIGHT**  
 This drawing has been prepared solely for the intended use, and no reproduction or distribution for any purpose other than authorized by Arcadis is forbidden. Written dimensions shall have precedence over scaled dimensions. Contractors shall verify and be responsible for all dimensions and conditions on the job, and Arcadis shall be informed of any variations from the dimensions and conditions shown on the drawing. Shop drawings shall be submitted to Arcadis for general conformance before proceeding with fabrication.  
**Arcadis Architects (Canada) Inc.**

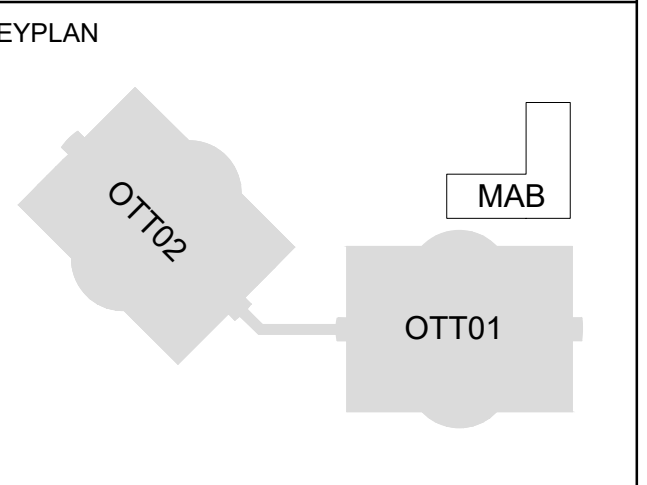

**ISSUES**

No.	DESCRIPTION	DATE
1	ISSUED FOR SPC #1	2025-12-12
2	ISSUED FOR SPC #2	2026-05-08

- CONSULTANTS**
- ARUP**  
47 Clarence Street, Suite 202, Ottawa, ON, K1N 5P9
  - TEECOM**  
60 Collins Street, Suite 200, San Francisco, CA 94102, USA
  - SENEZ CO**  
FIRE SCIENCE & ENGINEERING  
93 Skyway Avenue, Suite 102, Toronto, ON, M9W 6N6
  - TOTAL OPENING CONSULTANTS**  
895 Don Mills Rd., Suite 900, Toronto, ON M3C 1W3
  - CBRE**  
340 Albert Street, Suite 1900, Ottawa, ON, K1R 7Y6
  - Matrix**  
6131 Perth Street, Richmond, BC, V6X 2Z0



**SPC PACKAGE**  
 NOT FOR CONSTRUCTION

**PRIME CONSULTANT**

**ARCADIS**  
 333 Preston Street - Suite 500  
 Ottawa, ON K1S 5N4 Canada  
 tel 613 225 1311  
 www.arcadis.com

**PROJECT**

**CISCO OTTAWA CAMPUS MAB**  
 2000 Innovation Drive,  
 Kanata, ON K2K 3E8

PROJECT NO: MAB.30298433	APPLICATION NO: PC2025-0127
DRAWN BY: ARCADIS	CHECKED BY: BJ
PROJECT MGR: BJ	APPROVED BY: NK

**SHEET TITLE**

**LANDSCAPE LAYOUT AND MATERIALS PLAN**

**SHEET NUMBER** L-100 **ISSUE** 2

- LEGEND**
- EXISTING TREES TO REMAIN
  - PROPOSED DECIDUOUS TREE
  - PROPOSED CONIFEROUS TREE
  - PROPOSED SPECIMEN SHRUB
  - NATIVE SEED MIX
  - PERENNIAL PLANTING
  - EXISTING SOD TO REMAIN
  - BOUND AGGREGATE PAVING
  - C.I.P. CONCRETE PAVING
  - GRAVEL
  - LOOSE SAND
  - TABLE AND CHAIRS
  - PROPOSED LIGHT STANDARD
  - EXISTING LIGHT STANDARD
  - ARMOURSTONE BOULDERS

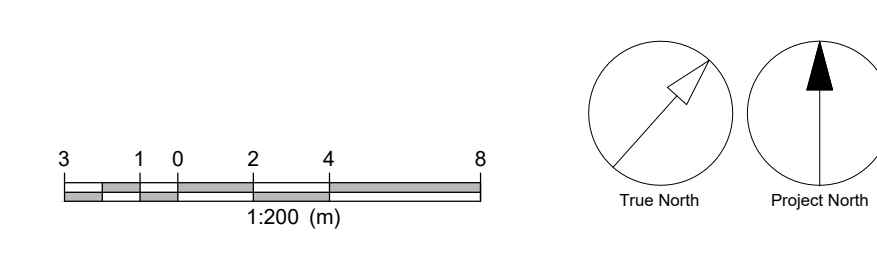

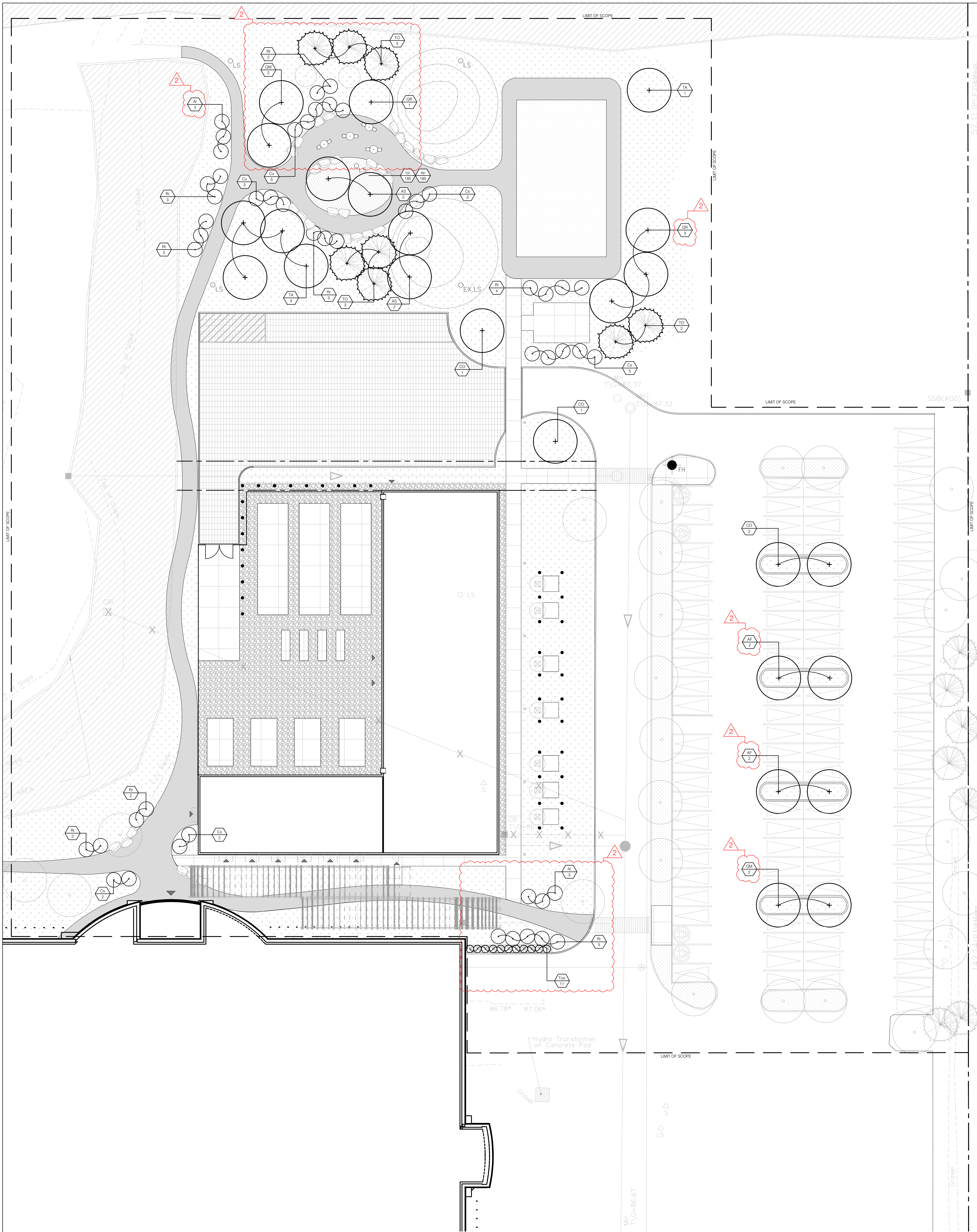

**NATIVE PERENNIAL WILDFLOWER BLEND**

8105 - NATIVE PERENNIAL WILDFLOWER BLEND BY OSC SEEDS OR APPROVED EQUAL

- 12% BLACK EYED SUSAN (RUDECKIA HIRTA)
- 5% BLANKET FLOWER (GAILLARDIA ARISTATA)
- 20% BLUE FLAX (LINUM PERENNE)
- 3% BUTTERFLY WEED (ASCLEPIAS TUBEROSA)
- 1% CANADA GOLDENROD (SOLIDAGO CANADENSIS)
- 5% EVENING PRIMROSE (OENOTHERA BIENNIS)
- 10% LANCE LEAF COREOPSIS (COREOPSIS LANCEOLATA)
- 5% OX EYE SUNFLOWER (HELIANTHUS HELIANTHOIDES)
- 15% PARTIDGE PEA (CHASMANTHUM LATIFOLIUM)
- 1% PRAIRIE BLAZING STAR (LIATRIS PSYCNOSTACHYA)
- 7% PURPLE CONEFLOWER (ECHINACEA PURPUREA)
- 5% SHASA DASY (CHRYSANTHEMUM MAXIMUM LUECANTHEMUM)
- 2% TALL WHITE BEARTOOTH (PENSTEMON DIGITALIS)
- 3% WILD BERGAMOT (MONARDA FISTULOSA)
- 5% WILD LUPINS (LUPINE PERENNIS)

SOW AT 25KG/HA (23 LBS/ACRE) OR 500G/180 SQ.M. FOR SMALLER AREAS

TOTAL AREA SHOWN = 3647 m<sup>2</sup>

**PLANT LIST**

KEY	QTY	BOTANICAL NAME	COMMON NAME	SPACING	SPECIFICATION/ NOTES	NATIVE	DROUGHT TOLERANT
<b>Deciduous Trees</b>							
AF	4	<i>Acer x Freemanii</i>	Freeman Maple	As per plan	70mm WB	X	
AS	4	<i>Acer saccharum</i>	Sugar Maple	As per plan	70mm WB	X	
CO	4	<i>Celtis occidentalis</i>	Common Hackberry	As per plan	70mm WB	X	
TA	5	<i>Tilia americana</i>	Basswood	As per plan	70mm WB	X	
QM	4	<i>Quercus Macrocarpa</i>	Burr Oak	As per plan	70mm WB	X	
QR	4	<i>Quercus Rubra</i>	Red Oak	As per plan	70mm WB	X	
<b>Coniferous Trees</b>							
TO	8	<i>Thuja occidentalis</i>	Eastern White Cedar	As per plan	70mm WB	X	X
<b>Specimen Shrubs</b>							
Al	6	<i>Amelanchier Laevis</i>	Serviceberry	As per plan	80cm 5 gal	X	
Cs	20	<i>Cornus sericea</i>	Red Osier Dogwood	As per plan	80cm 5 gal	X	
Rr	15	<i>Rosa rugosa</i>	Rugosa rose	1000mm O.C	80cm 5 gal	X	X
Rt	9	<i>Rhus typhina 'Tiger Eyes'</i>	Tiger Eye Cutleaf Sumac	As per plan	80cm 5 gal	X	X
Toe	11	<i>Thuja occidentalis 'Emerald'</i>	Emerald Cedar	1000mm O.C	80cm 5 gal		
<b>Perennials</b>							
cp	185	<i>Carex pensylvanica</i>	Pennsylvania Sedge	450mm O.C	3 gal	X	X
ep	185	<i>Echinacea purpurea</i>	Purple Coneflower	450mm O.C	3 gal	X	X

**SOIL VOLUME MATRIX (REFER TO SOIL VOLUME PLAN)**

PLANTING ZONES	VOLUME CALCULATION AT 1.5m SOIL DEPTH	TREE QUANTITY	OTTAWA TARGET SOIL VOLUME (m <sup>3</sup> )	DESIGN SOIL VOLUME (m <sup>3</sup> )	ADEQUACY PERCENTAGE
A	274m <sup>2</sup> x 1.5m = 411m <sup>3</sup>	8	144	411	288%
B	385m <sup>2</sup> x 1.5m = 577.5m <sup>3</sup>	9	162	577	356%
C	72m <sup>2</sup> x 1.5m = 108m <sup>3</sup>	2	36	108	300%
D	30m <sup>2</sup> x 1.5m = 45m <sup>3</sup>	1	30	45	150%
E	182m <sup>2</sup> x 1.5m = 273m <sup>3</sup>	5	90	273	303%
F	30m <sup>2</sup> x 1.5m = 45m <sup>3</sup>	1	30	45	150%
G	30m <sup>2</sup> x 1.5m = 45m <sup>3</sup>	1	30	45	150%
H	25m <sup>2</sup> x 1.5m = 37.5m <sup>3</sup>	2	36	37.5	104%
I	25m <sup>2</sup> x 1.5m = 37.5m <sup>3</sup>	2	36	37.5	104%
J	25m <sup>2</sup> x 1.5m = 37.5m <sup>3</sup>	2	36	37.5	104%
K	25m <sup>2</sup> x 1.5m = 37.5m <sup>3</sup>	2	36	37.5	104%

- TREE PLANTING IN SENSITIVE CLAY**
- The landscape plans have been developed in accordance with the geotechnical report: Geotechnical Investigation, Proposed MAB Building, Cisco Campus, Ottawa, Ontario. Prepared by WSP Canada Inc., March 2, 2025.
  - The following City of Ottawa clay soils guideline applies: Guidelines for Tree Planting in Sensitive Marine Clay Soils (2017).
  - The soil volumes provided are sufficient for a reasonable chance of tree survival. All new trees meet the minimum soil volume requirements of the following, based on a depth of 1.5m below finished grade:
    - Where one tree is planted: minimum of 30m<sup>3</sup> of soil provided.
    - Where multiple trees share a continuous soil volume: minimum of 18m<sup>3</sup> of soil provided per tree.

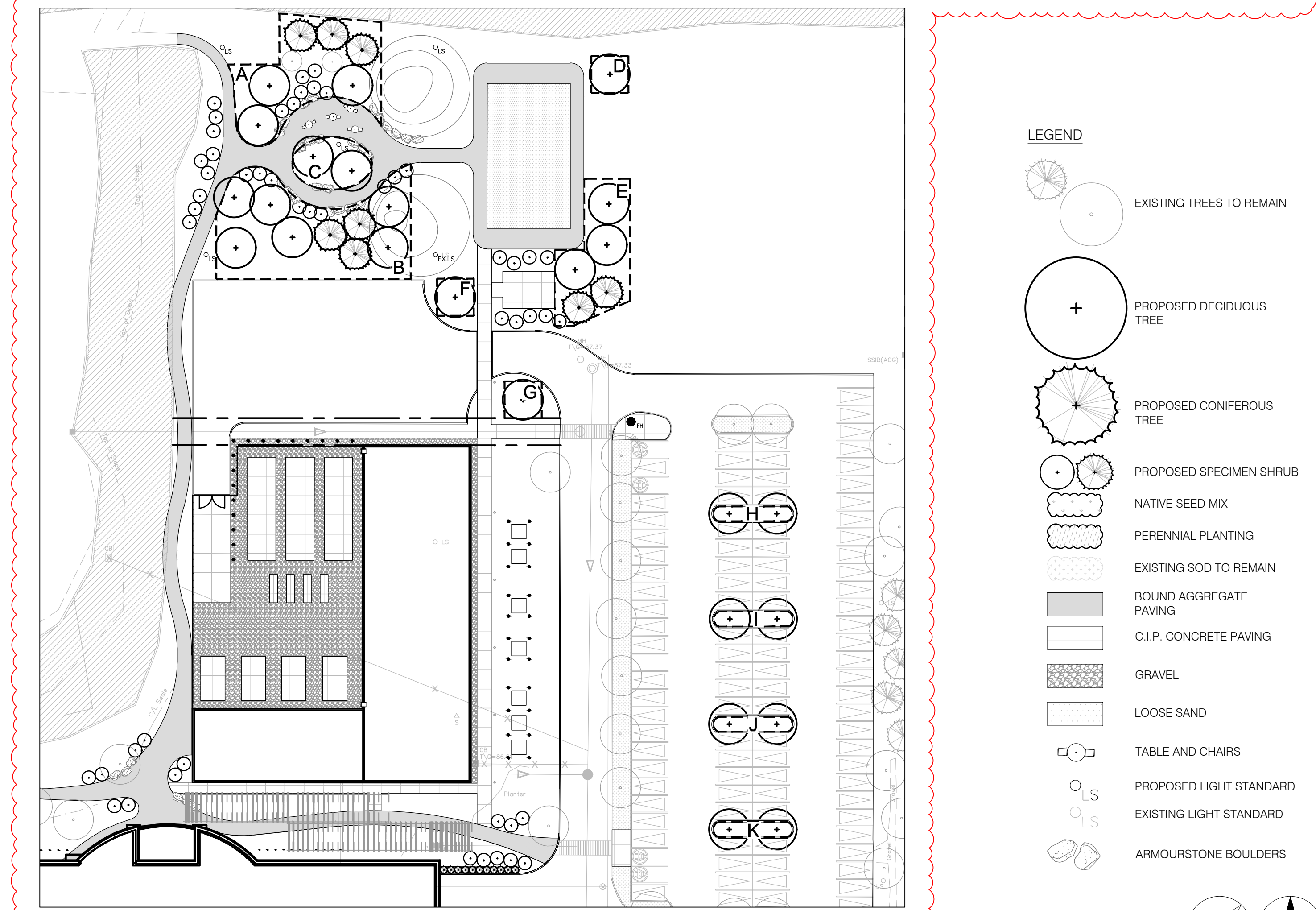

1 PLANTING PLAN  
L-200 1:200

2 SOIL VOLUME PLAN  
L-200 1:500

**CLIENT**  
  
 COPYRIGHT  
 This drawing has been prepared solely for the intended use, thus any reproduction or distribution for any purpose other than authorized by Arcadis is forbidden. Written dimensions shall have precedence over scaled dimensions. Contractors shall verify and be responsible for all dimensions and conditions on the job, and Arcadis shall be informed of any variations from the dimensions and conditions shown on the drawing. Shop drawings shall be submitted to Arcadis for general conformance before proceeding with fabrication.  
 Arcadis Architects (Canada) Inc.

**KEYPLAN**

**ISSUES**

No.	DESCRIPTION	DATE
1	ISSUED FOR SPC #1	2025-12-12
2	ISSUED FOR SPC #2	2025-05-08

**CONSULTANTS**

**ARUP**  
 47 Clarence Street, Suite 202,  
 Ottawa, ON, K1N 5P9

**TEECOM**  
 910 St. Laurent,  
 Ottawa, ON, K1M 5R7

**SENEZCO**  
 FIRE SCIENCE & ENGINEERING  
 93 Skyway Avenue, Suite 102  
 Toronto, ON, M9W 6N6

**TOTAL OPENING CONSULTANTS**  
 695 Don Mills Rd., Suite 900,  
 Toronto, ON M3C 1W3

**CBRE**  
 340 Albert Street, Suite 1900  
 Ottawa, ON, K1R 7Y6

**Matrix**  
 6131 Park Street  
 Richmond, ON, K0A 2Z0

**SEAL**

**SPC PACKAGE NOT FOR CONSTRUCTION**

**PRIME CONSULTANT**  
  
 333 Preston Street - Suite 500  
 Ottawa, ON K1S 5N4 Canada  
 tel: 613 225 1311  
 www.arcadis.com

**PROJECT**  
 CISCO OTTAWA CAMPUS  
 MAB  
 2000 Innovation Drive,  
 Kanata, ON K2K 3E8

**PROJECT NO:** MAB.30298433  
**APPLICATION NO:** PC2025-0127

**DRAWN BY:** ARCADIS  
**CHECKED BY:** BJ

**PROJECT MGR:** BJ  
**APPROVED BY:** NK

**SHEET TITLE**  
 PLANTING PLAN

**SHEET NUMBER** L-200 **ISSUE** 2

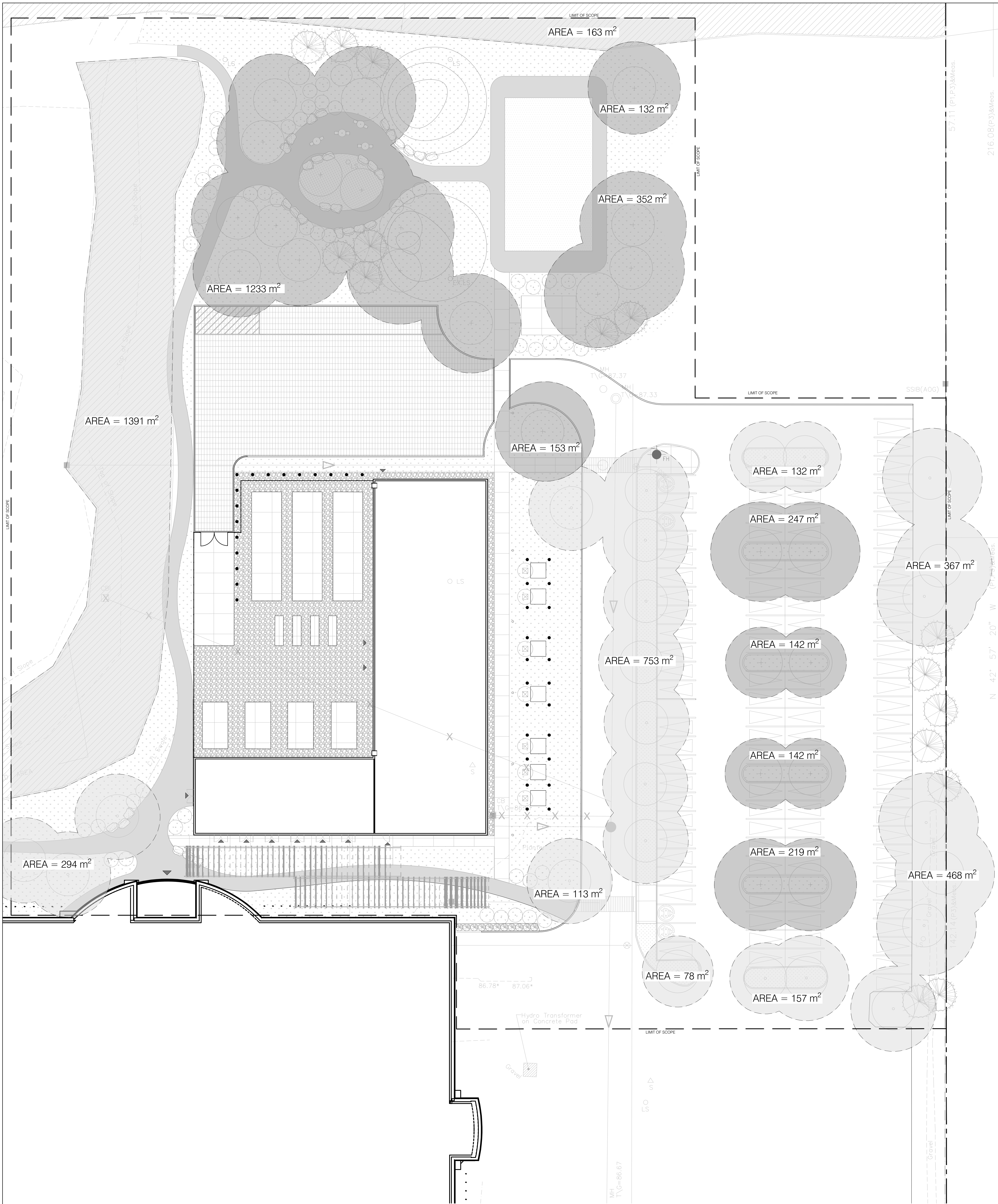

**40-YEAR CANOPY PROJECTION:**  
 PROPOSED CANOPY COVER AT MATURITY = 2,620 m<sup>2</sup>  
 EXISTING CANOPY COVER (PROJECTED AT MATURITY) = 3,916 m<sup>2</sup>  
 TOTAL PROJECTED CANOPY AREA = 6,536 m<sup>2</sup>  
 TOTAL SCOPE AREA = 15,776 m<sup>2</sup>  
 PROJECTED CANOPY COVER = 41.4%

- 40-YEAR CANOPY CALCULATION METHODOLOGY:**
- TREE SPECIES DIAMETER AT MATURITY WAS SOURCED FROM NVKNURSERIES.COM
  - CIRCLES WERE PLACED AROUND EACH CANOPY TREE WITH CORRESPONDING DIAMETER
  - CANOPY AREA WAS DETERMINED BY A POLYLINE DRAWN AROUND THE PERIMETER OF EACH TREE, OR GROUPINGS OF TREES WITH OVERLAPPING CANOPIES.
  - THE ADDED AREA OF ALL POLYLINES WAS USED TO CALCULATE SITE COVERAGE PERCENTAGE.
  - FOR THE PURPOSE OF THIS CALCULATION, THE TOTAL SITE AREA USED IS DENOTED BY THE 'LIMIT OF SCOPE' LINE.

- LEGEND**
- EXISTING TREES TO REMAIN
  - PROPOSED DECIDUOUS TREE
  - PROPOSED CONIFEROUS TREE
  - PROPOSED SPECIMEN SHRUB
  - NATIVE SEED MIX
  - PERENNIAL PLANTING
  - EXISTING SOD TO REMAIN
  - SOUND AGGREGATE PAVING
  - C.I.P. CONCRETE PAVING
  - GRAVEL
  - LOOSE SAND
  - TABLE AND CHAIRS
  - PROPOSED LIGHT STANDARD
  - EXISTING LIGHT STANDARD
  - ARMOURSTONE BOULDERS
  - EXISTING CANOPY 40-YEAR PROJECTION
  - PROPOSED CANOPY 40-YEAR PROJECTION



**COPYRIGHT**  
 This drawing has been prepared solely for the intended use, and any reproduction or distribution for any purpose other than authorized by Arcadis is forbidden. Written dimensions shall have precedence over scaled dimensions. Contractors shall verify and be responsible for all dimensions and conditions on the job, and Arcadis shall be informed of any variations from the dimensions and conditions shown on the drawing. Shop drawings shall be submitted to Arcadis for general conformance before proceeding with fabrication.  
 Arcadis Architects (Canada) Inc.

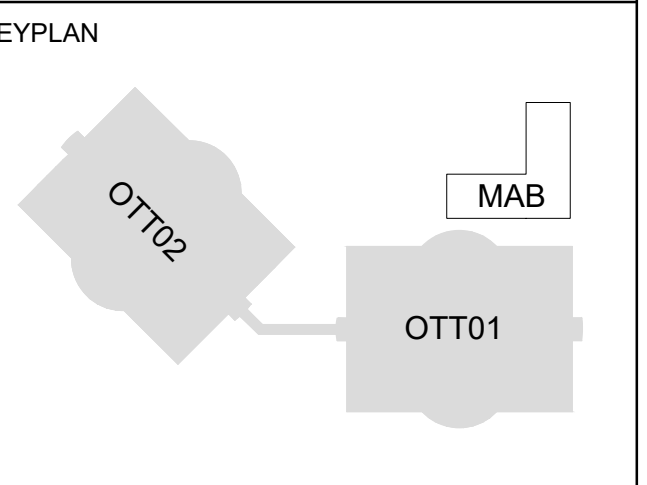

**ISSUES**

No.	DESCRIPTION	DATE
1	ISSUED FOR SPC #1	2025-12-12
2	ISSUED FOR SPC #2	2025-05-08

**CONSULTANTS**

**ARUP**  
 47 Clarence Street, Suite 202,  
 Ottawa, ON, K1N 5P9

**TEECOM**  
 40 Collins Street  
 San Francisco, CA  
 94101  
 415.774.2800  
 www.teecom.com

**SENEZ CO**  
 FIRE SCIENCE & ENGINEERING  
 93 Skyway Avenue, Suite 102  
 Toronto, ON, M9W 6N6

**TOTAL OPENING CONSULTANTS**  
 895 Don Mills Rd., Suite 900,  
 Toronto, ON M3C 1W3

**CBRE**  
 340 Albert Street, Suite 1900  
 Ottawa, ON, K1R 7Y6

**Matrix**  
 8131 Perth Street  
 Richmond, ON, K0A 2Z0

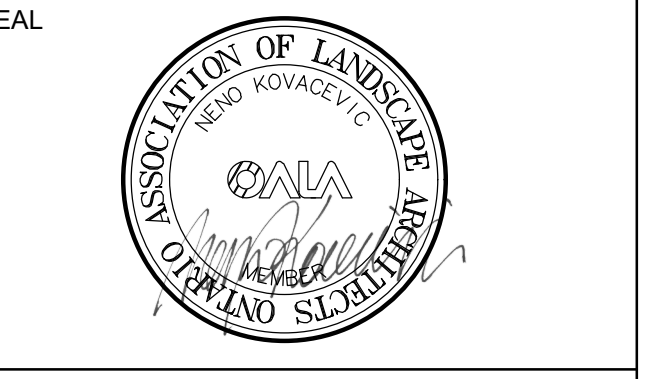

**SPC PACKAGE**  
 NOT FOR CONSTRUCTION

**PRIME CONSULTANT**

**ARCADIS**  
 333 Preston Street - Suite 500  
 Ottawa ON K1S 5N4 Canada  
 tel 613 225 1311  
 www.arcadis.com

**PROJECT**  
 CISCO OTTAWA CAMPUS  
 MAB  
 2000 Innovation Drive,  
 Kanata, ON K2K 3E8

**PROJECT NO:** MAB-30298433  
**APPLICATION NO:** PC2025-0127

**DRAWN BY:** ARCADIS  
**CHECKED BY:** BJ

**PROJECT MGR:** BJ  
**APPROVED BY:** NK

**SHEET TITLE**  
 40-YEAR CANOPY PROJECTION

**SHEET NUMBER** L-201 **ISSUE** 2

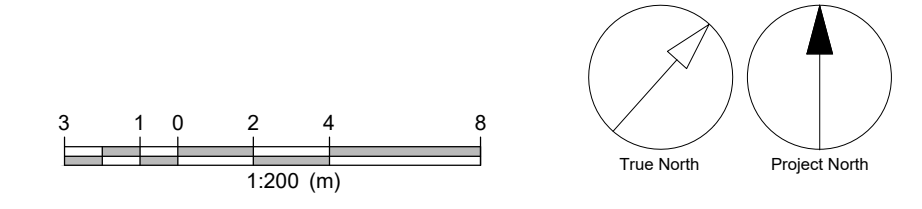

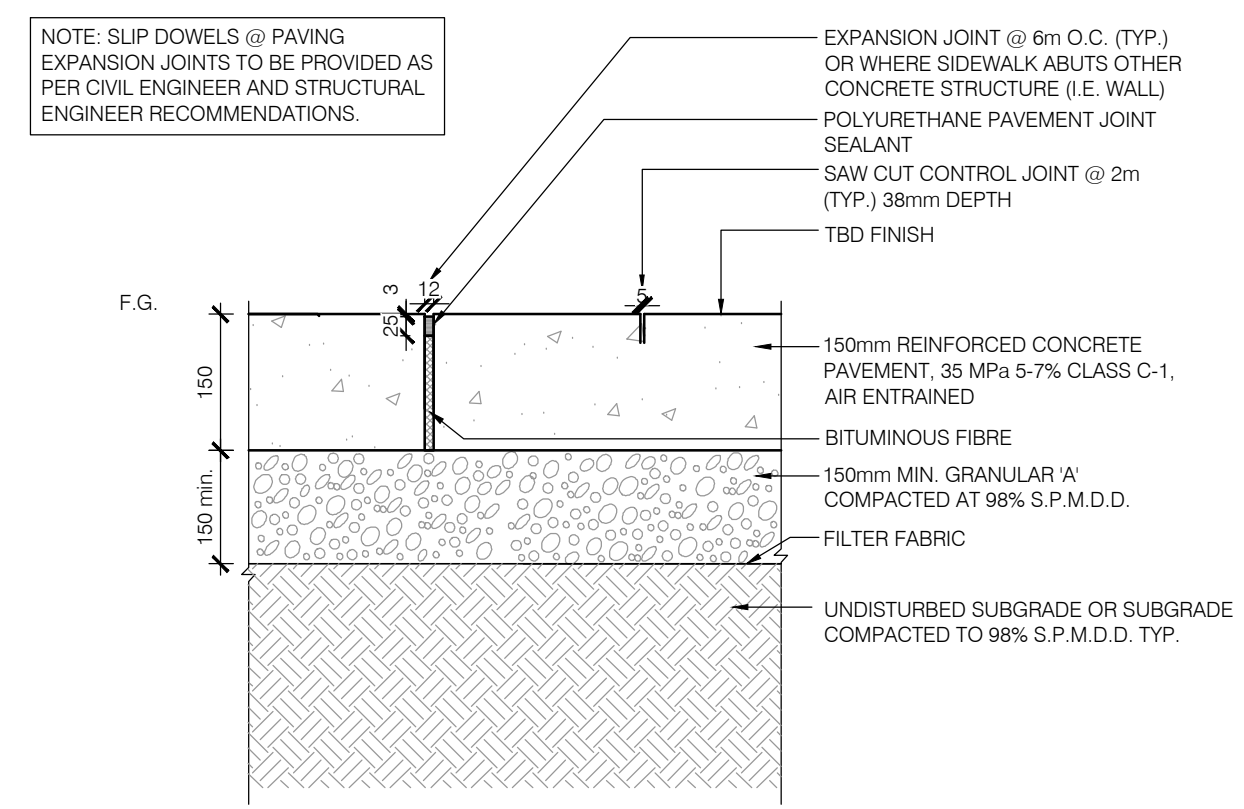

1 C.I.P. CONCRETE PAVING  
L-500 1:10

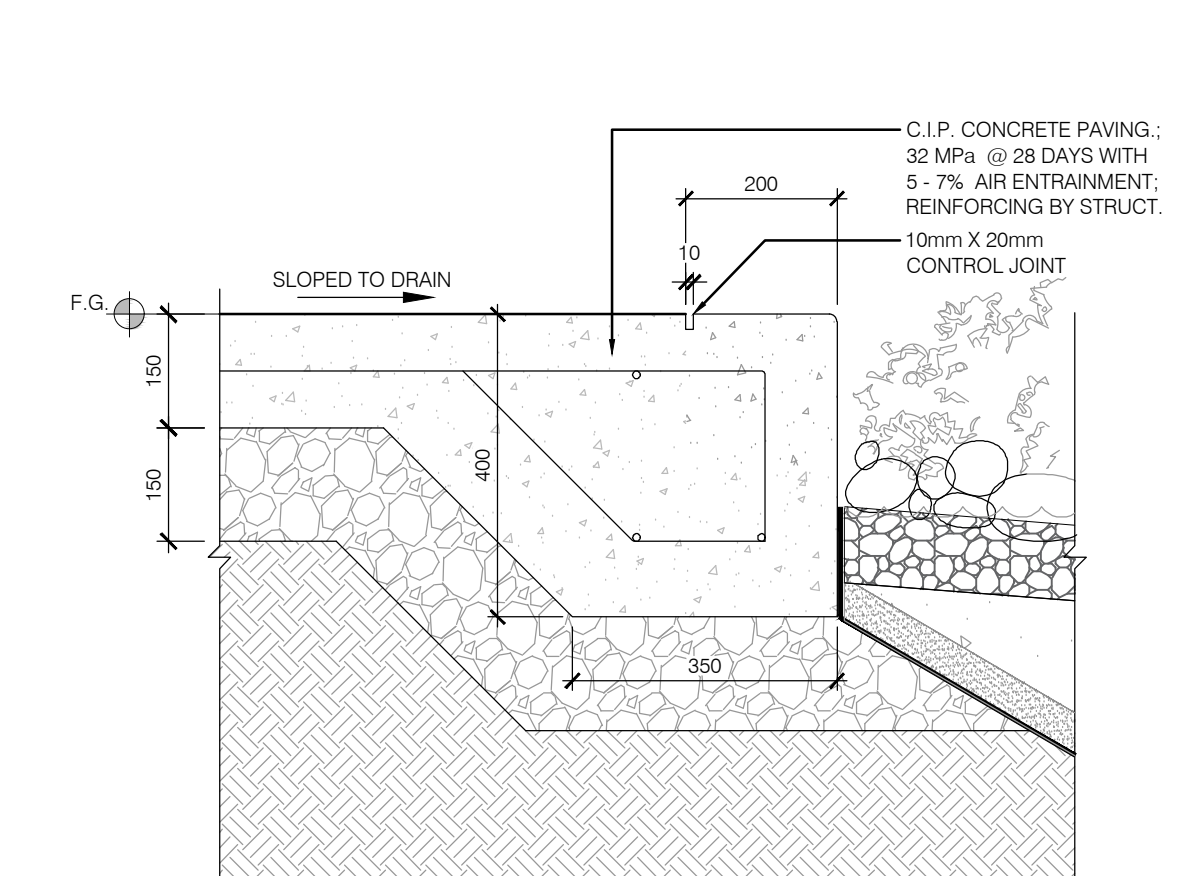

2 C.I.P. CONCRETE EDGE  
L-500 1:10

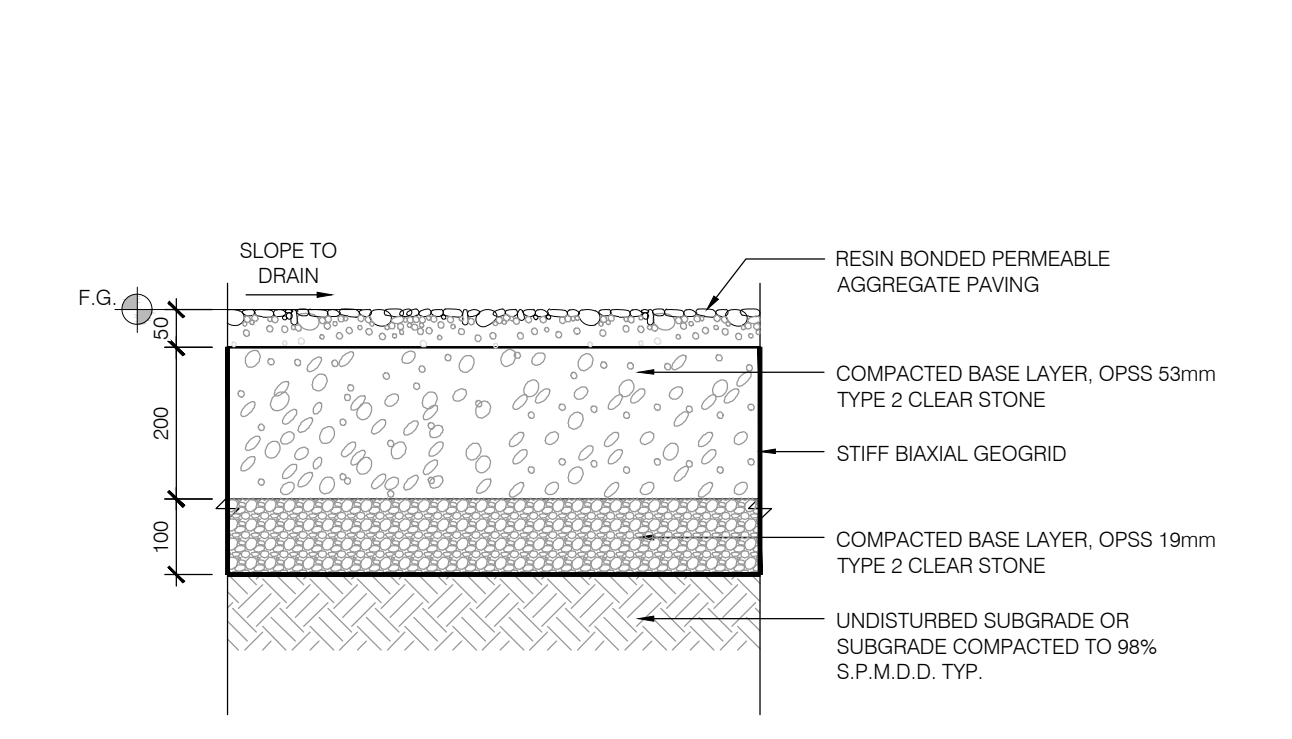

3 BOUND AGGREGATE PAVING  
L-500 1:10

4 LEFT BLANK INTENTIONALLY  
L-500

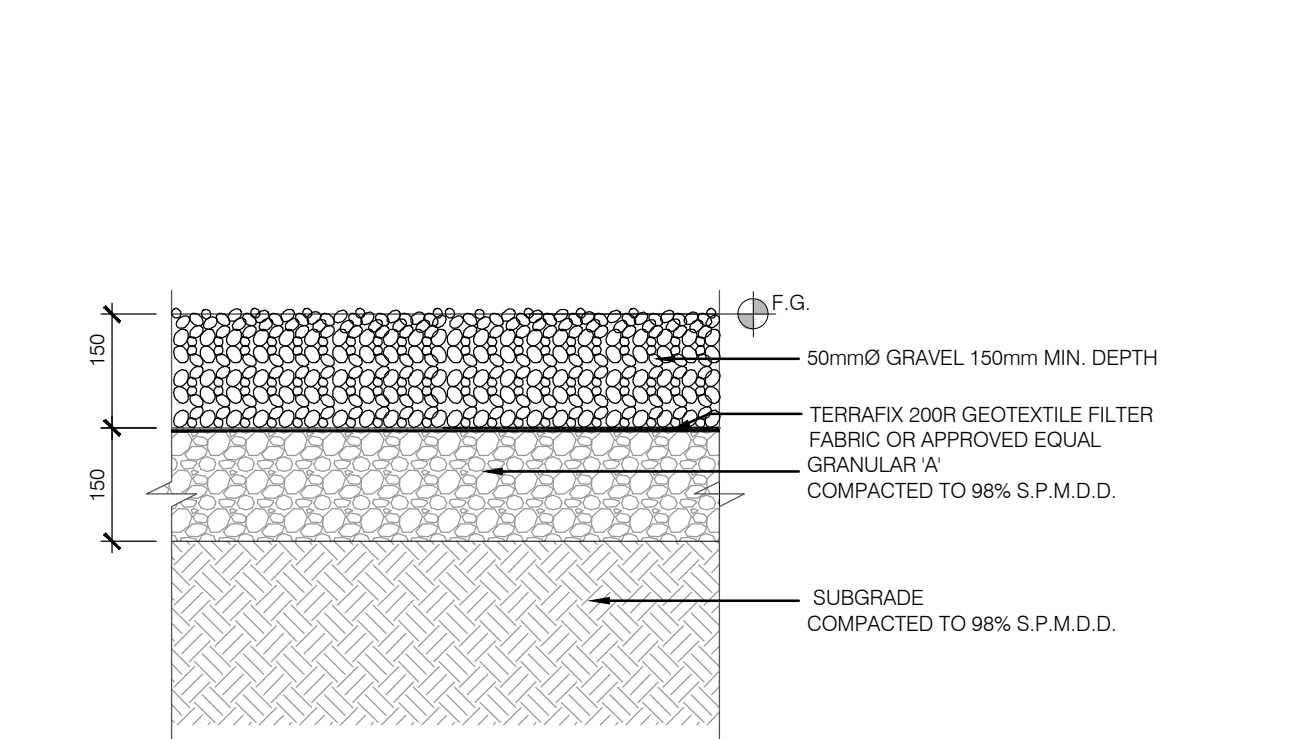

5 GRAVEL SURFACE  
L-500 1:10

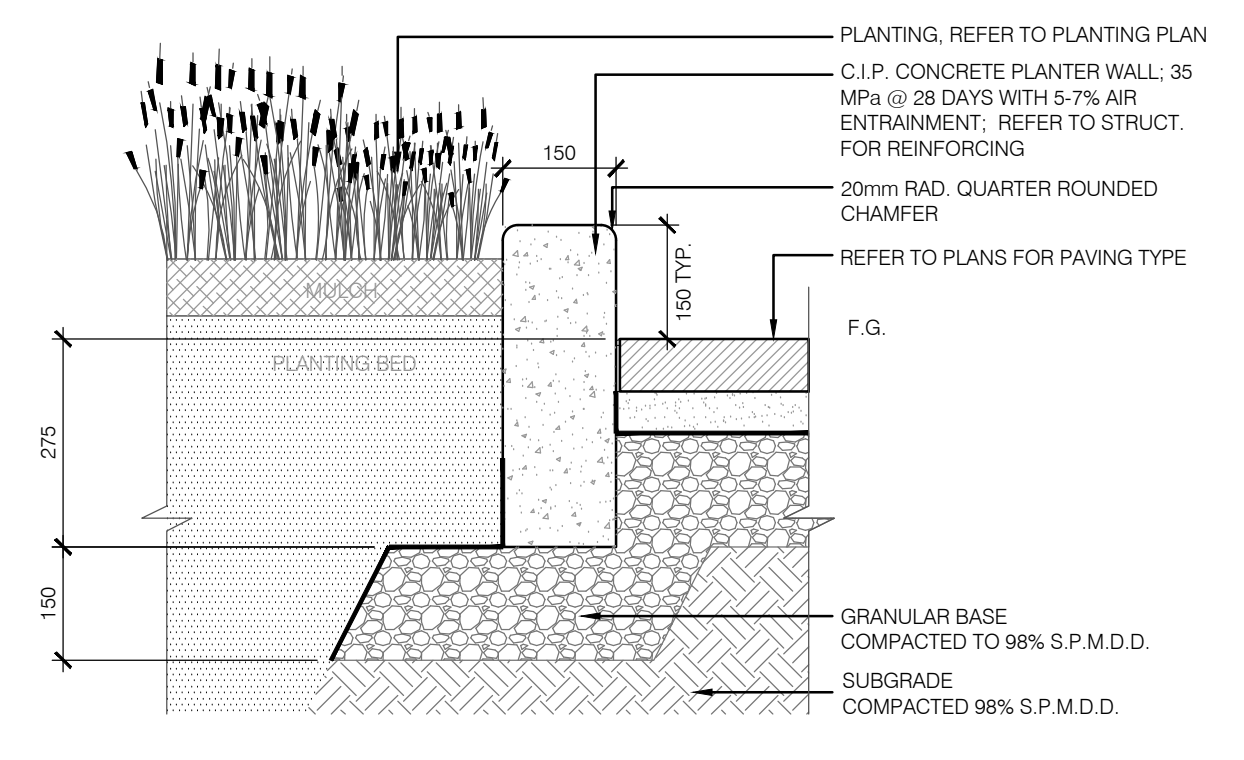

6 C.I.P. CONCRETE CURB AT PLANTERS  
L-500 1:10

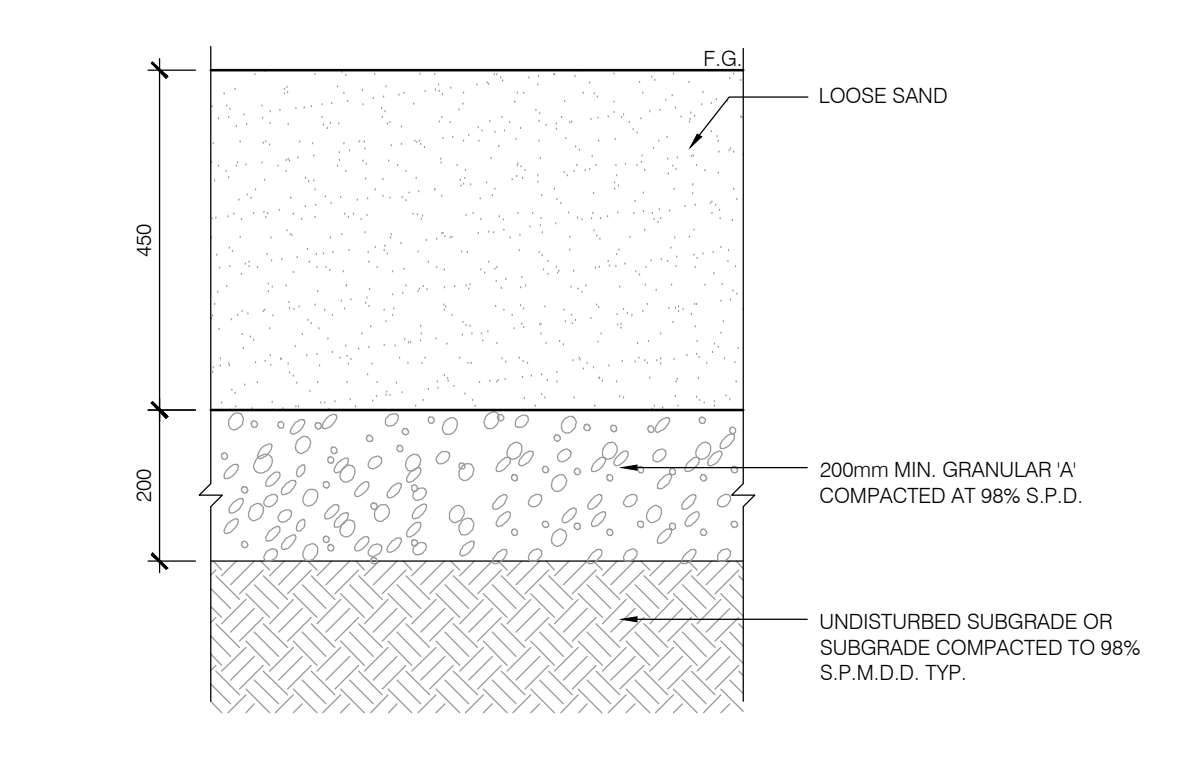

7 SAND VOLLEYBALL COURT  
L-500 1:10

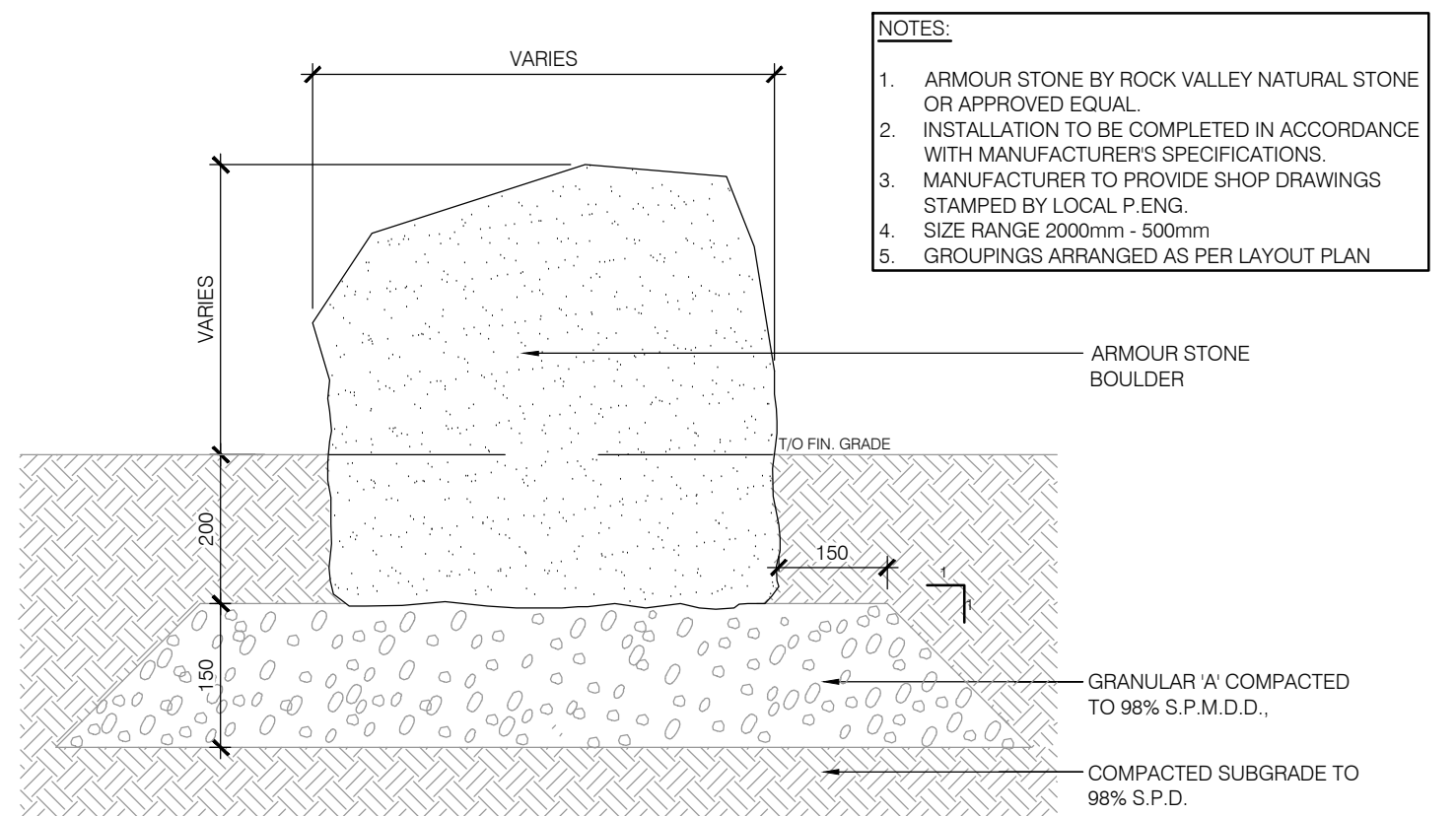

8 BOULDER (ARMOURSTONE)  
L-500 1:20

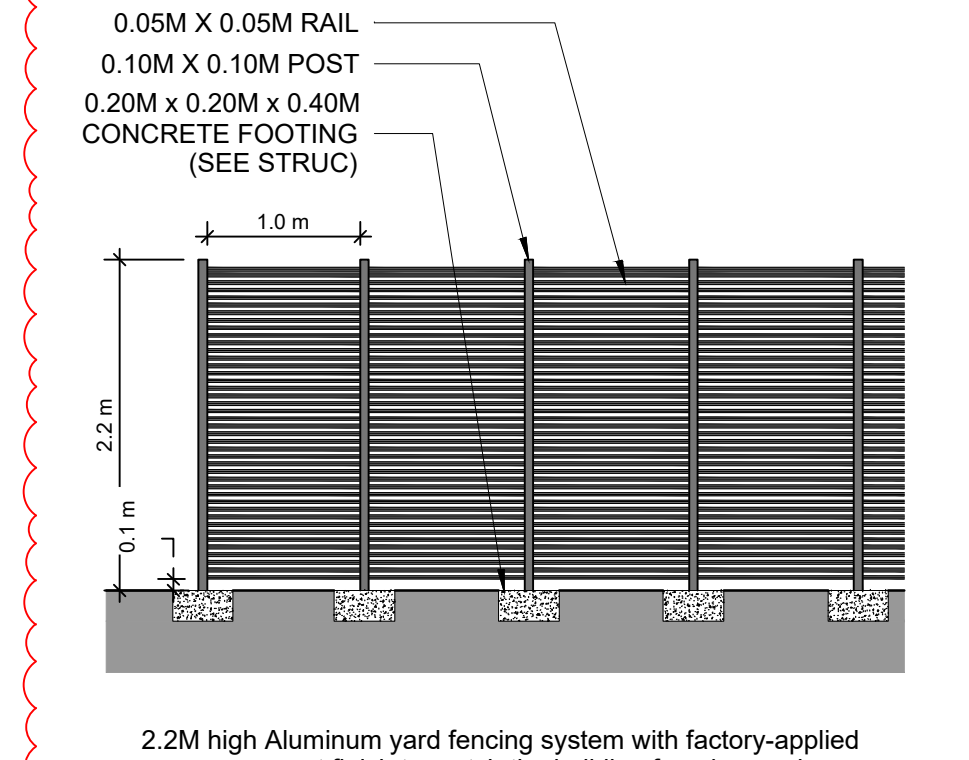

9 METAL FENCE  
L-500 1:50



CLIENT

**CISCO**

COPYRIGHT  
This drawing has been prepared solely for the intended use, thus any reproduction or distribution for any purpose other than authorized by Arcadis is forbidden. Written dimensions shall have precedence over scaled dimensions. Contractors shall verify and be responsible for all dimensions and conditions on the job, and Arcadis shall be informed of any variations from the dimensions and conditions shown on the drawing. Shop drawings shall be submitted to Arcadis for general conformance before proceeding with fabrication.

Arcadis Architects (Canada) Inc.

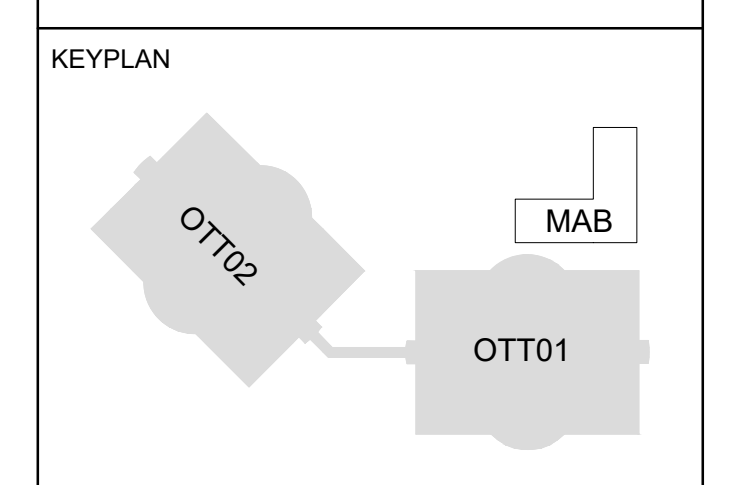

ISSUES

No.	DESCRIPTION	DATE
1	ISSUED FOR SPC #1	2025-12-12
2	ISSUED FOR SPC #2	2026-05-08

CONSULTANTS

**ARUP**  
47 Clarence Street, Suite 202,  
Ottawa, ON, K1N 5P9

**TEECOM**  
36 California Street  
Suite 100  
San Francisco, CA  
94111  
2018-07-2020  
www.teecom.com

**SENEZ CO**  
FIRE SCIENCE & ENGINEERING  
93 Skyway Avenue, Suite 102  
Toronto, ON, M9W 6R6

**TOTAL OPENING CONSULTANTS**  
895 Don Mills Rd. Suite 900,  
Toronto, ON M3C 1W3

**CBRE**  
340 Albert Street, Suite 1900  
Ottawa, ON, K1R 7Y6

**Matrix**  
6131 Perth Street  
Richmond, ON, K9A 2Z0



SPC PACKAGE  
NOT FOR CONSTRUCTION

PRIME CONSULTANT

**ARCADIS**  
333 Preston Street - Suite 500  
Ottawa ON K1S 5N4 Canada  
tel 613 225 1311  
www.arcadis.com

PROJECT  
CISCO OTTAWA CAMPUS  
MAB  
2000 Innovation Drive,  
Kanata, ON K2K 3E8

PROJECT NO: MAB-30298433	APPLICATION NO: PC2025-0127
DRAWN BY: ARCADIS PROJECT MGR: BJ	CHECKED BY: BJ APPROVED BY: NK

SHEET TITLE  
LANDSCAPE  
DETAILS

SHEET NUMBER  
L-500

ISSUE  
2

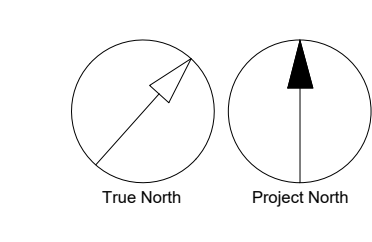

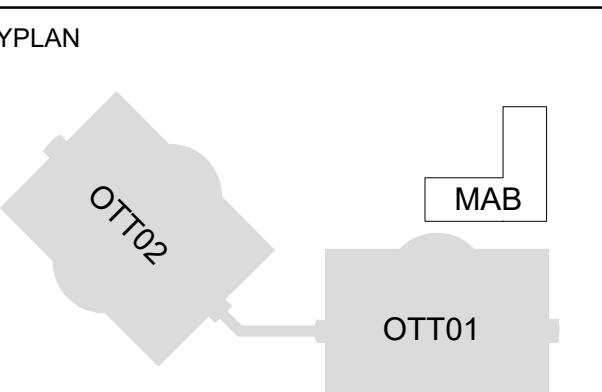

ISSUES

No.	DESCRIPTION	DATE
1	ISSUED FOR SPC #1	2025-12-12
2	ISSUED FOR SPC #2	2026-05-08

CONSULTANTS

**ARUP**  
47 Clarence Street, Suite 202,  
Ottawa, ON, K1N 5P9

**TEECOM**  
30 Colborne Street  
Ottawa, Ontario, CA  
K1P 1K1  
(613) 577-2888  
www.teecom.com

**SENEZCO**  
FIRE SCIENCE & ENGINEERING  
93 Skyway Avenue, Suite 102  
Toronto, ON, M9W 6R6

**TOTAL OPENING CONSULTANTS**  
895 Don Mills Rd. Suite 900,  
Toronto, ON M3C 1W3

**CBRE**  
340 Albert Street, Suite 1900  
Ottawa, ON, K1R 7Y6

**Matrix**  
6131 Perth Street  
Richmond, ON, N6A 2Z0



SPC PACKAGE  
NOT FOR CONSTRUCTION

PRIME CONSULTANT

**ARCADIS**  
333 Preston Street - Suite 500  
Ottawa ON K1S 5N4 Canada  
tel 613 225 1311  
www.arcadis.com

PROJECT  
**CISCO OTTAWA CAMPUS  
MAB**  
2000 Innovation Drive,  
Kanata, ON K2K 3E8

PROJECT NO: MAB-30298433	APPLICATION NO: PC2025-0127
DRAWN BY: ARCADIS BJ	CHECKED BY: BJ
PROJECT MGR: BJ	APPROVED BY: NK

SHEET TITLE  
**PLANTING  
DETAILS**

SHEET NUMBER <b>L-501</b>	ISSUE <b>2</b>
------------------------------	-------------------

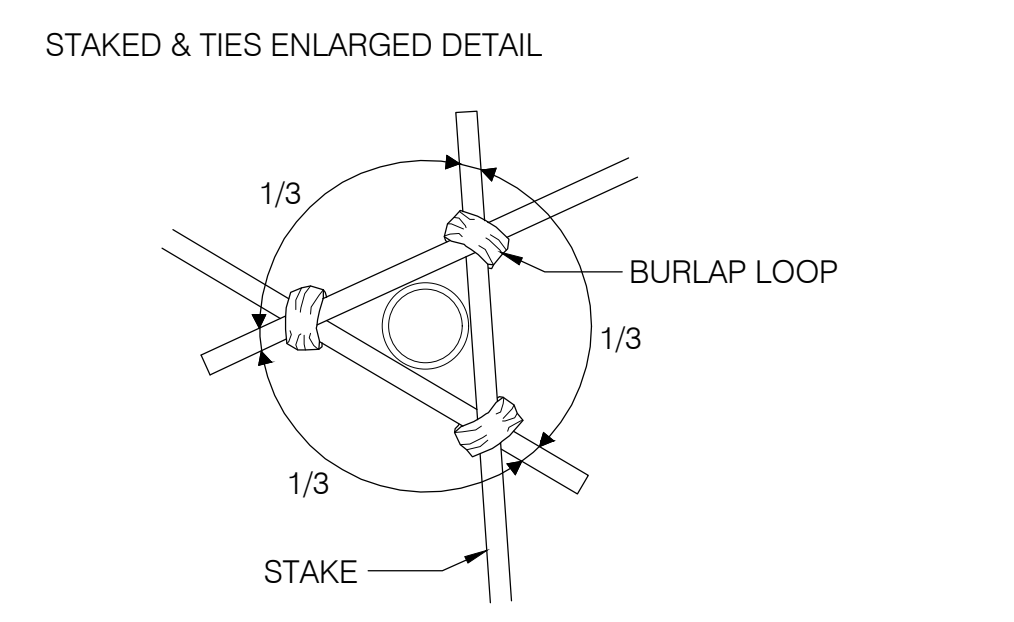

- STAKES & TIES:
- STAKE BEFORE PLANTING USE ONE ROUNDED WOODEN STAKE, MINIMUM 2m LONG, 75mm AVERAGE DRIVEN 300mm INTO SUBSOIL PRIOR TO PLANTING
  - TIE USING BIODEGRADABLE MATERIAL SUCH AS FOLDED BURLAP, STAPLED TO STAKE WITH FENCE STAPLES OR ROOFING NAILS
  - APPLY RODENT PROTECTION WHERE REQUIRED. (TREES UNDER 45mm CALIPER)

- NOTES:
- OBTAIN WRITTEN CONFIRMATION OF UTILITY LOCATES PRIOR TO COMMENCEMENT OF DIGGING
  - DIG ALL HOLES BY HAND WHEN CLOSER THAN 1.0M TO UNDERGROUND POWER, TELEPHONE AND GAS ALIGNMENTS
  - USE ROOT DEFLECTOR ON THE UTILITY SIDE OF REQUIRED
  - ENSURE BASE OF TREE PIT IS STABLE IN ORDER TO MAINTAIN THE DESIRED TREE LEVEL AND GRADE
  - TREES TO BE SPRAYED WITH APPROVED ANTI-DESICCANT PRIOR TO TRANSPLANTING UNLESS PLANTED WITHIN 48 HOURS OF DIGGING (IF PLANTED IN FULL LEAF)
  - SET TREE 50mm HIGHER THAN SURROUNDING GRADE TO ALLOW FOR SETTLEMENT
  - SCARIFY COMPACTED SUBGRADE TO 500MM DEEP IN AREA 5 X ROOTBALL DIAMETER
  - DIG PIT 300MM WIDER THAN ROOTBALL PERIMETER
  - MULCH WITH SHREDDED BARK OR COMPOSTED HARDWOOD CHIPS
  - TRUNK PROTECTION MECHANICAL INJURY: USE PLASTIC TREE COLLAR ANIMAL INJURY: USE SPIRAL TREE GUARDS OR SCREEN COLLARS SUNSCALD INJURY: PAINT TRUNK WITH WHITE LATEX OR WHITE-WASH, OR WRAP WITH BURLAP, 'KRAFT WRAP' INSTALLED FROM THE GROUND UP TO ABOVE LOWEST BRANCHES LAWN MOWER INJURY: USE SPLIT CORRUGATED BRAIN COLLARS
  - REMOVE TREE STAKES AND TREE WRAP AFTER ONE SEASON

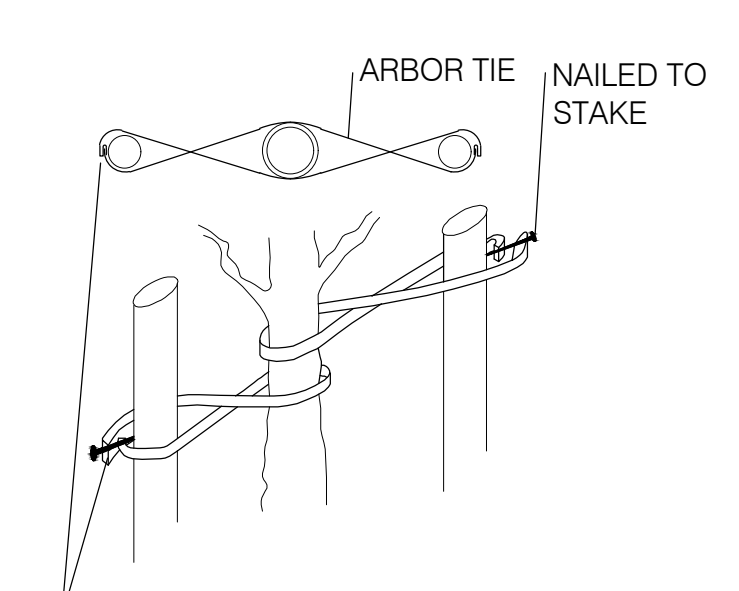

FOLD ENDS OF ARBOR TIE BACK, SECURE TO STAKE WITH 1" GALVANIZED ROOFING NAIL OR USE A KNOT.

- NOTES:
- OBTAIN WRITTEN CONFIRMATION OF UTILITY LOCATES PRIOR TO COMMENCEMENT OF DIGGING
  - DIG ALL HOLES BY HAND WHEN CLOSER THAN 1.0M TO UNDERGROUND POWER, TELEPHONE AND GAS ALIGNMENTS
  - USE ROOT DEFLECTOR ON THE UTILITY SIDE OF REQUIRED
  - ENSURE BASE OF TREE PIT IS STABLE IN ORDER TO MAINTAIN THE DESIRED TREE LEVEL AND GRADE
  - TREES TO BE SPRAYED WITH APPROVED ANTI-DESICCANT PRIOR TO TRANSPLANTING UNLESS PLANTED WITHIN 48 HOURS OF DIGGING (IF PLANTED IN FULL LEAF)
  - SET TREE 50mm HIGHER THAN SURROUNDING GRADE TO ALLOW FOR SETTLEMENT
  - SCARIFY COMPACTED SUBGRADE TO 500MM DEEP IN AREA 5 X ROOTBALL DIAMETER
  - DIG PIT 300MM WIDER THAN ROOTBALL PERIMETER
  - MULCH WITH SHREDDED BARK OR COMPOSTED HARDWOOD CHIPS
  - TRUNK PROTECTION MECHANICAL INJURY: USE PLASTIC TREE COLLAR ANIMAL INJURY: USE SPIRAL TREE GUARDS OR SCREEN COLLARS SUNSCALD INJURY: PAINT TRUNK WITH WHITE LATEX OR WHITE-WASH, OR WRAP WITH BURLAP, 'KRAFT WRAP' INSTALLED FROM THE GROUND UP TO ABOVE LOWEST BRANCHES LAWN MOWER INJURY: USE SPLIT CORRUGATED BRAIN COLLARS
  - REMOVE TREE STAKES AND TREE WRAP AFTER ONE SEASON

NOTES:

- OBTAIN WRITTEN CONFIRMATION OF UTILITY LOCATES PRIOR TO COMMENCEMENT OF DIGGING
- PREPARATION: EXCAVATE SHRUB BED TO SIZE OUTLINED ON DRAWINGS. MAINTAIN MINIMUM 450mm DEPTH.
- SET SHRUB 50mm HIGHER THAN SURROUNDING GRADE TO ALLOW FOR SETTLEMENT
- ALL ROOT BALLS REMOVED FROM POTS TO BE SCARIFIED PRIOR TO SETTING IN GROUND
- PRUNING TO SUIT SPECIES
- TRIM BRANCHES AND TWIGS TO RETAIN NATURAL FORM OF SHRUB, DO NOT PRUNE LEADERS
- SPACING AS DIRECTED

- FERTILIZER:
- APPLY APPROVED WATER SOLUBLE FERTILIZER AT A RATE OF 9kg PER 100 m<sup>2</sup>
  - ENSURE FERTILIZER IS CONTAINED WITHIN SAUCER AND EVENLY RAKED INTO PLANTING SOIL MIXTURE.

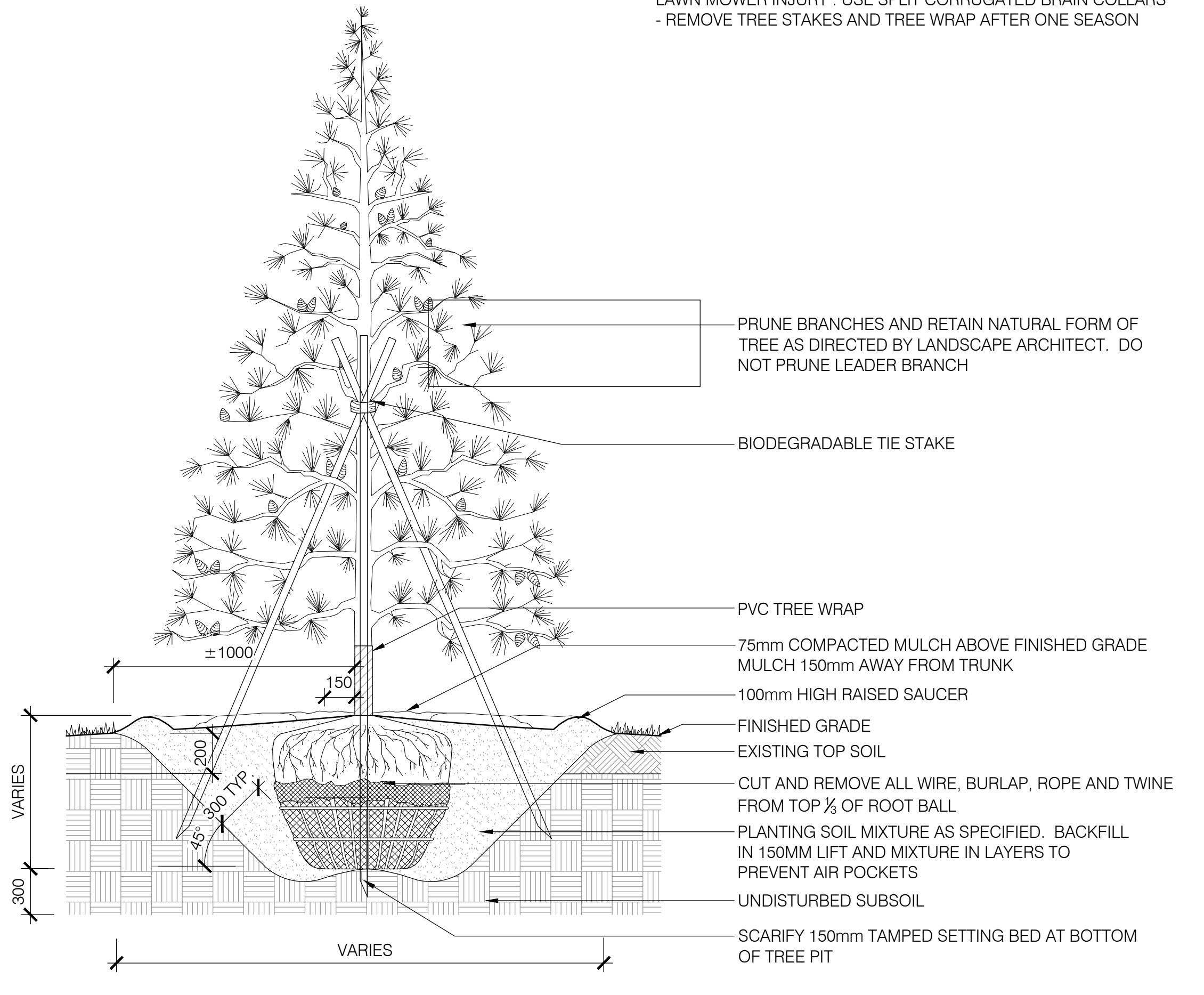

1 CONIFEROUS TREE PLANTING  
L-501 / 1:20

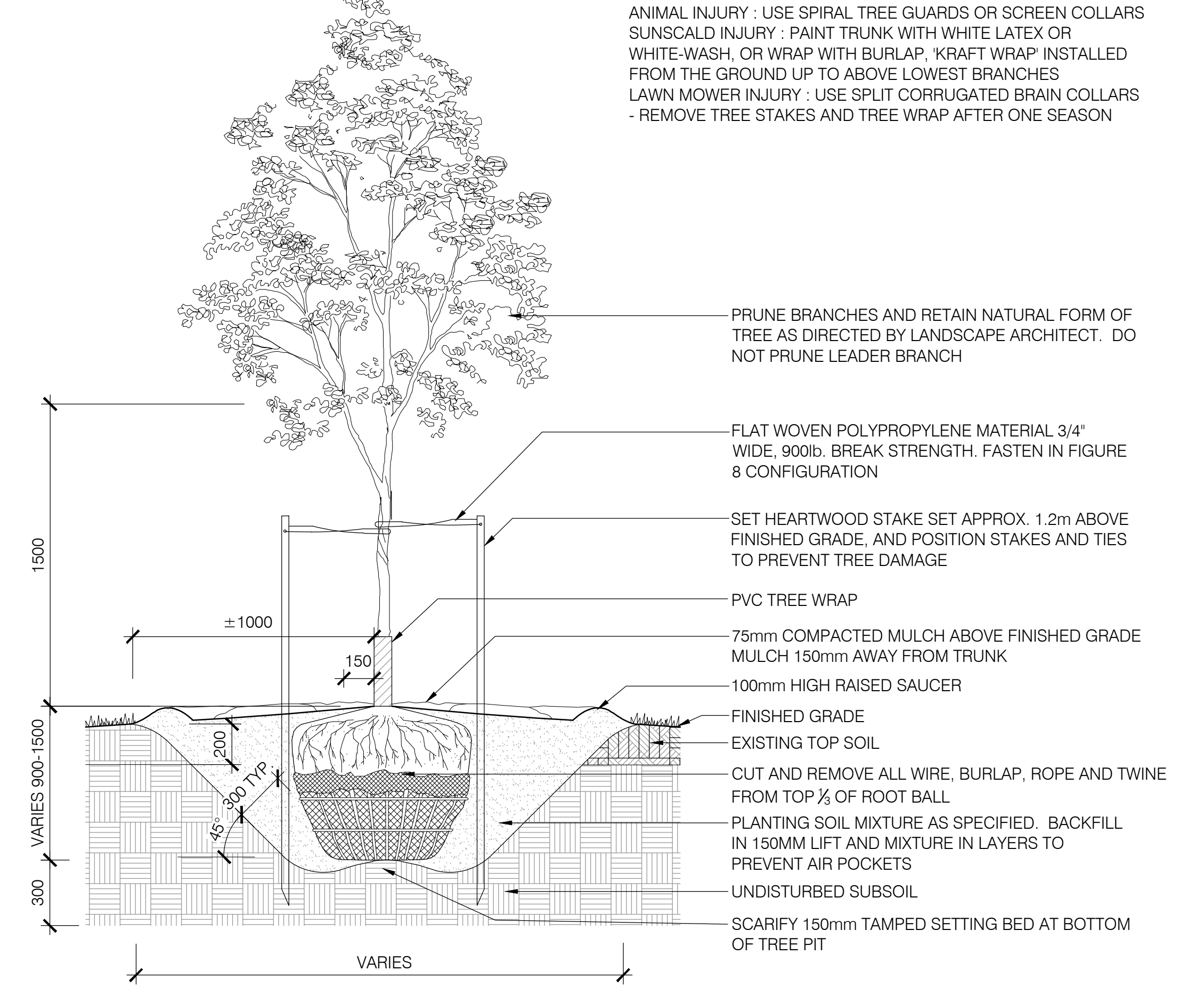

2 DECIDUOUS TREE PLANTING  
L-501 / 1:20

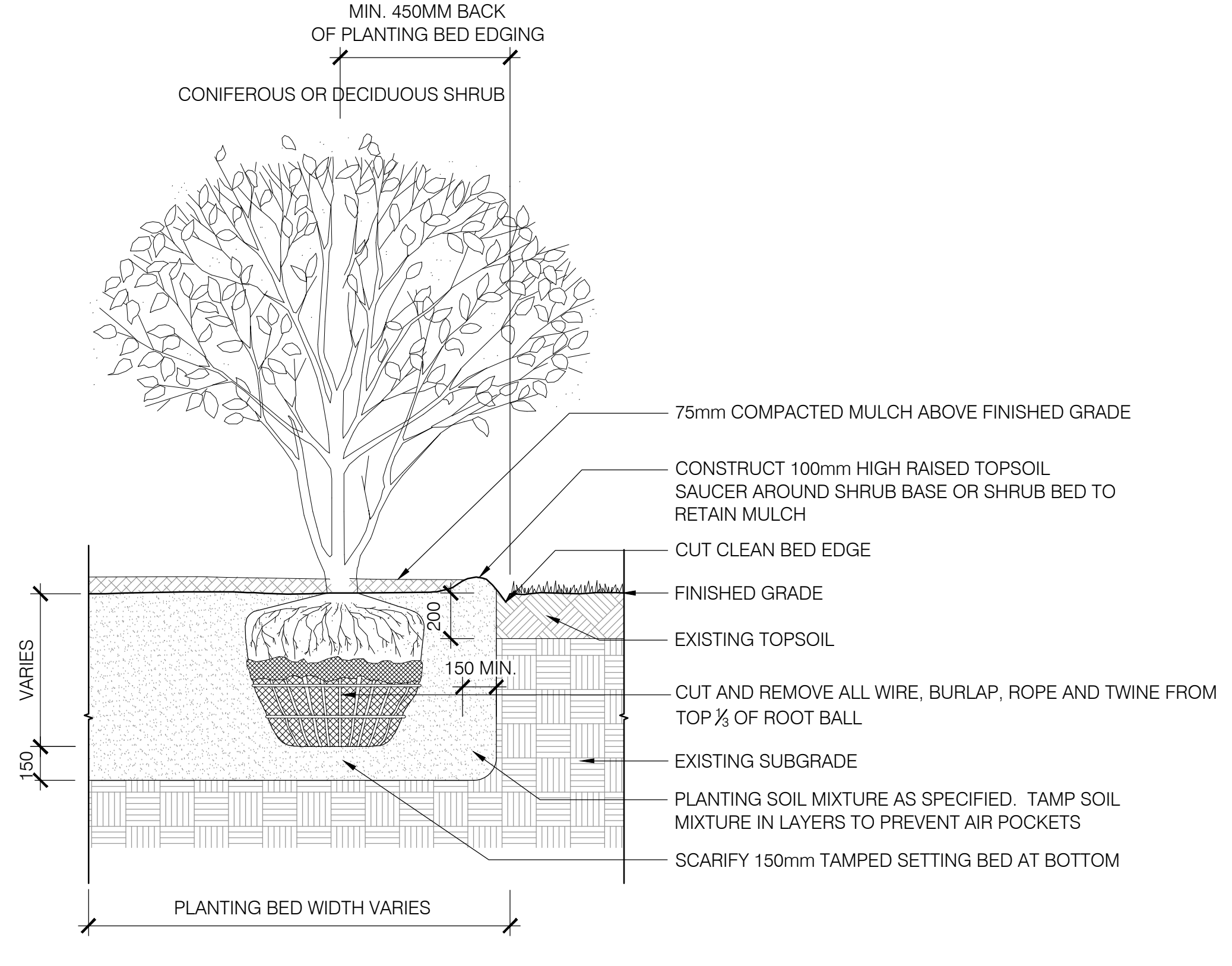

3 SHRUB PLANTING  
L-501 / 1:20

NOTES:

- PREPARATION: EXCAVATE PLANTING BED TO SIZE OUTLINED ON DRAWINGS. MAINTAIN MINIMUM 350mm DEPTH
- PLANTING BED TO BE RAISED A MINIMUM OF 150mm ABOVE THE FINISHED GRADE OF SOD AND/OR SURROUNDING AREA
- SET PERENNIAL 50mm HIGHER THAN SURROUNDING GRADE TO ALLOW FOR SETTLEMENT
- PLANTING IN GROUPS SHALL BE SET IN EQUAL ON CENTRE SPACING
- SPACING PER PLANT LIST DIRECTIONS, IN STAGGERED ROWS
- FERTILIZER:
  - APPLY APPROVED WATER SOLUBLE FERTILIZER AT A RATE OF 9kg PER 100 m<sup>2</sup>
  - ENSURE FERTILIZER IS CONTAINED WITHIN SAUCER AND EVENLY RAKED INTO PLANTING SOIL MIXTURE.
- BARE ROOT (B.R. IN PLANT LIST):
  - SET ALL PLANT MATERIAL SLIGHTLY HIGHER THAN ADJACENT GRADE. SET BARE ROOT PLANT MATERIAL SO THAT ROOTS LIE IN NATURAL STATE. GENTLY BACKFILL WITH SOIL MIXTURE, WORKING SOIL BETWEEN ROOTS. LIGHTLY TAMP SOIL TO ELIMINATE AIR POCKETS AND REDUCE SETTLEMENT. WATER PLANTING BED THOROUGHLY, IMMEDIATELY AFTER PLANTING.

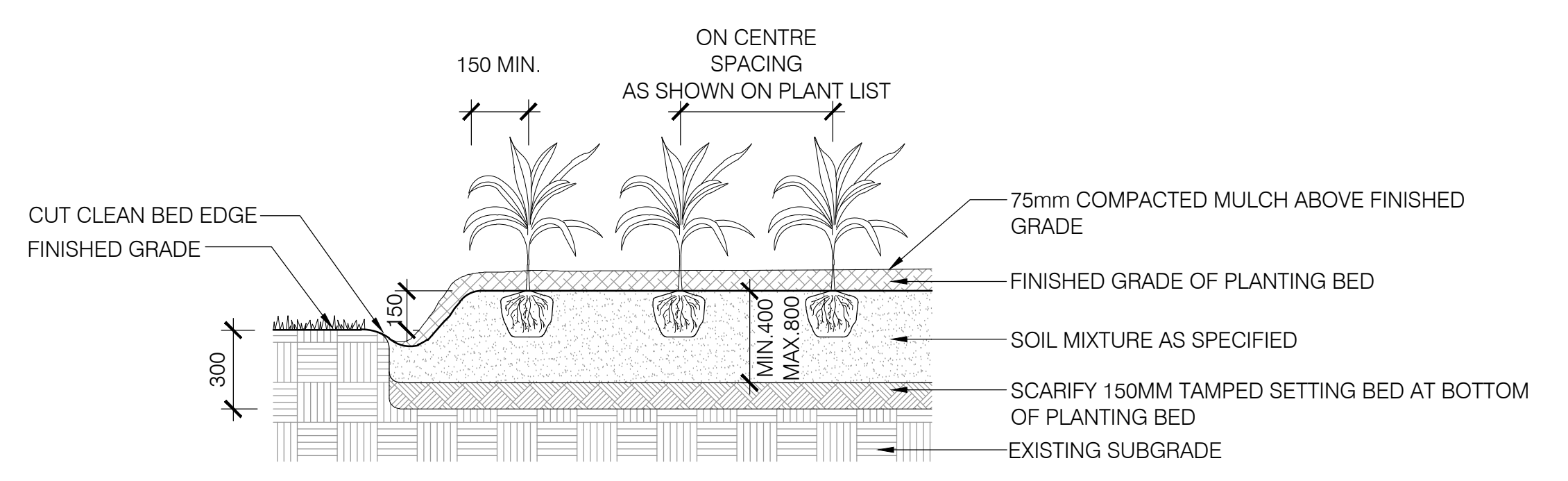

4 PERENNIAL PLANTING  
L-501 / 1:20

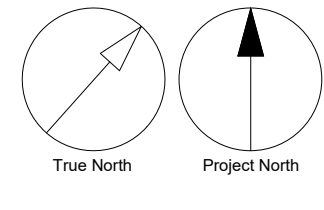

Scale: 1:20