

**LEGEND**

- WATERCOURSE DITCH
- NATURAL RUNOFF CORRIDOR
- DIVERSION DITCH
- PROPOSED FENCE
- PROPERTY LIMIT
- STORMWATER PUMP PIPE, HOPE DR17, 150mm
- VEGETATION SWALE
- MAIN PIPE FIRE PROTECTION 200mm HOPE DR11 PE4710
- PIPE CONNECTION 150mm HOPE DR11 PE4710
- HYDRANT
- HYDRANTS BOLLARDS
- BATTERY CORNERS BOLLARDS
- POST INDICATOR VALVE
- 60m RADIUS PROTECTION
- FLOW DIRECTION PROPOSED GRADE
- PROPOSED CULVERT
- TREE LINE
- CULTIVATED AREA
- ACCESS ROAD
- PROPOSED INSULATING STONE SURFACE AREA
- PROPOSED GRAVEL SURFACE AREA
- PROPOSED GRADE EL.: 90.62
- EXISTING GRADE ELEVATION 91.0
- BATTERY/MVT GROUP
- AUXILIARY TRANSFORMER
- WET POND
- EXISTING POLE
- MONUMENT
- LANDSCAPING
- PROPOSED REGISTERED FIRE ROUTE

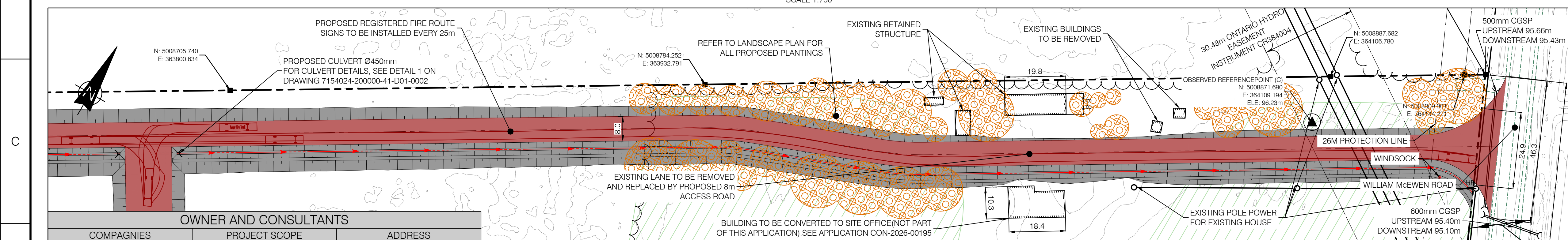

**OWNER AND CONSULTANTS**

COMPANIES	PROJECT SCOPE	ADDRESS
TRAIL ROAD BESS INC	OWNER / DEVELOPPER	4186 WILLIAM MCEWEN DRIVE, RICHMOND, ON K0A 2E0
BBA	CIVIL ENGINEERING	20 CARLSON COURT, SUITE 100, TORONTO, ON M9W 7K6
STANTEC	PLANNING, LANDSCAPE PLANS	1331 CLYDE AVE. #300, OTTAWA, ON K2C 3G4
HATCH	GEOTECHNICAL, HYDROGEOLOGY	2800 SPEAKMAN DR, MISSISSAUGA, ON L5K 2R7
TULLOCH GEOMATICS INC.	SURVEYOR	900 MORRISON DR, SUITE 208, OTTAWA, ON K2H 8K7

**REVISIONS**

REV	DESCRIPTION	PREPARED BY	CHECKED BY	DATE
AL	FOR PERMITTING	B. THOMAS	V. BRUNELLE P. Eng.	2026-03-30
AK	FOR PERMITTING	B. THOMAS	V. BRUNELLE P. Eng.	2026-01-21
AJ	FOR PERMITTING	B. THOMAS	V. BRUNELLE P. Eng.	2025-12-04
AI	FOR PERMITTING	B. THOMAS	V. BRUNELLE P. Eng.	2025-10-28
AH	FOR COMMENTS	B. THOMAS	V. BRUNELLE P. Eng.	2025-10-22
AG	FOR PERMITTING	B. THOMAS	V. BRUNELLE P. Eng.	2025-09-24
AF	FOR COMMENTS	B. THOMAS	V. BRUNELLE P. Eng.	2025-09-15
AE	FOR PERMITTING	B. THOMAS	V. BRUNELLE P. Eng.	2025-09-02
AD	FOR PERMITTING	B. THOMAS	V. BRUNELLE P. Eng.	2025-08-27
AC	FOR PERMITTING	B. THOMAS	V. BRUNELLE P. Eng.	2025-07-24
AB	FOR PERMITTING	B. THOMAS	V. BRUNELLE P. Eng.	2025-05-13
AA	FOR COMMENTS	B. THOMAS	V. BRUNELLE P. Eng.	2025-05-02

**REFERENCE DRAWINGS**

DRAWING No.	DESCRIPTION
25286.00	TRAIL ROAD INITIAL NOISE CONROL OPTIONS AERCOUSTICS
241437	TOPOGRAPHIC PLAN OF SURVEY
SURFACE LIDAR	LIDAR DTM OTTAWA-GATINEAU 2019-20 PACKAGE M
7154024300000-47-D20-0001-02	TRAIL BESS - 150 MW - 230 kV - 34.5 kV SUBSTATION

- NOTES:**
- COORDINATES SYSTEM IS: HORIZONTAL DATUM: MTM\_NAD83 (CSRS)\_ZONE 9 VERTICAL DATUM: CGVD28
  - THIS SITE PLAN HAS BEEN BASED ON THE SURVEY TOPOGRAPHY SKETCH PREPARED BY TULLOCH GEOMATICS INC. DATED MARCH 12, 2025
  - THE VEHICLE USED TO PERFORM THE SIMULATION IS PUMPER FIRE TRUCK OVERALL LENGTH= 12.192m OVERALL WIDTH= 2.489m COUNTER-STEERING DELAY= 5sec MAXIMUM WHEEL ANGLE 45.00°
  - LOT ADDRESS: 4186 WILLIAM MCEWEN DR, OTTAWA
  - REFER TO LANDSCAPE PLAN FOR ALL PROPOSED PLANTINGS
  - THE FIRE PROTECTION TANK SHALL BE FILLED VIA A TRUCK, AND SHALL HAVE A LEVEL GAUGE VISIBLE TO MAINTENANCE STAFF CONDUCTING SITE ROUNDS.
  - THE REFERENCE COORDINATES COMES FROM THE TULLOCH SURVEY 241437 DONE ON 10th JANUARY 2025

**FOR PERMITTING**  
NOT TO BE USED FOR CONSTRUCTION

**BBA**

**Evolugen**  
by Brookfield Renewable

CLIENT:

**PROJECT: TRAIL ROAD BESS**

**TITLE: CIVIL BESS SITE PLAN**

DESIGNED BY: B. THOMAS	DRAFTED BY: A. MENDES
PREPARED BY: B. THOMAS	CHECKED BY: V. BRUNELLE P. Eng. P.E.O No. 100617887
SCALE: 1:750	DATE: 2025-04-24
DRAWING No.: 7154024-200000-41-D20-0002	SHEET: 01 SIZE: A1 REV: AL