

INSTALL A MINIMUM OF 8 SCUPPERS EACH A MINIMUM 310mm WIDE. BOTTOM OF SCUPPERS AND PARAPET SHALL BE 150mm ABOVE ROOF DRAINS. REFER TO ARCHITECTURAL FOR EXACT LOCATIONS AND DETAILS. ROOF SHALL BE DESIGNED TO CARRY THE LOAD OF WATER HAVING A 50mm DEPTH AT SCUPPERS (i.e. 200mm DEPTH AT ROOF DRAINS). REFER TO STRUCTURAL.

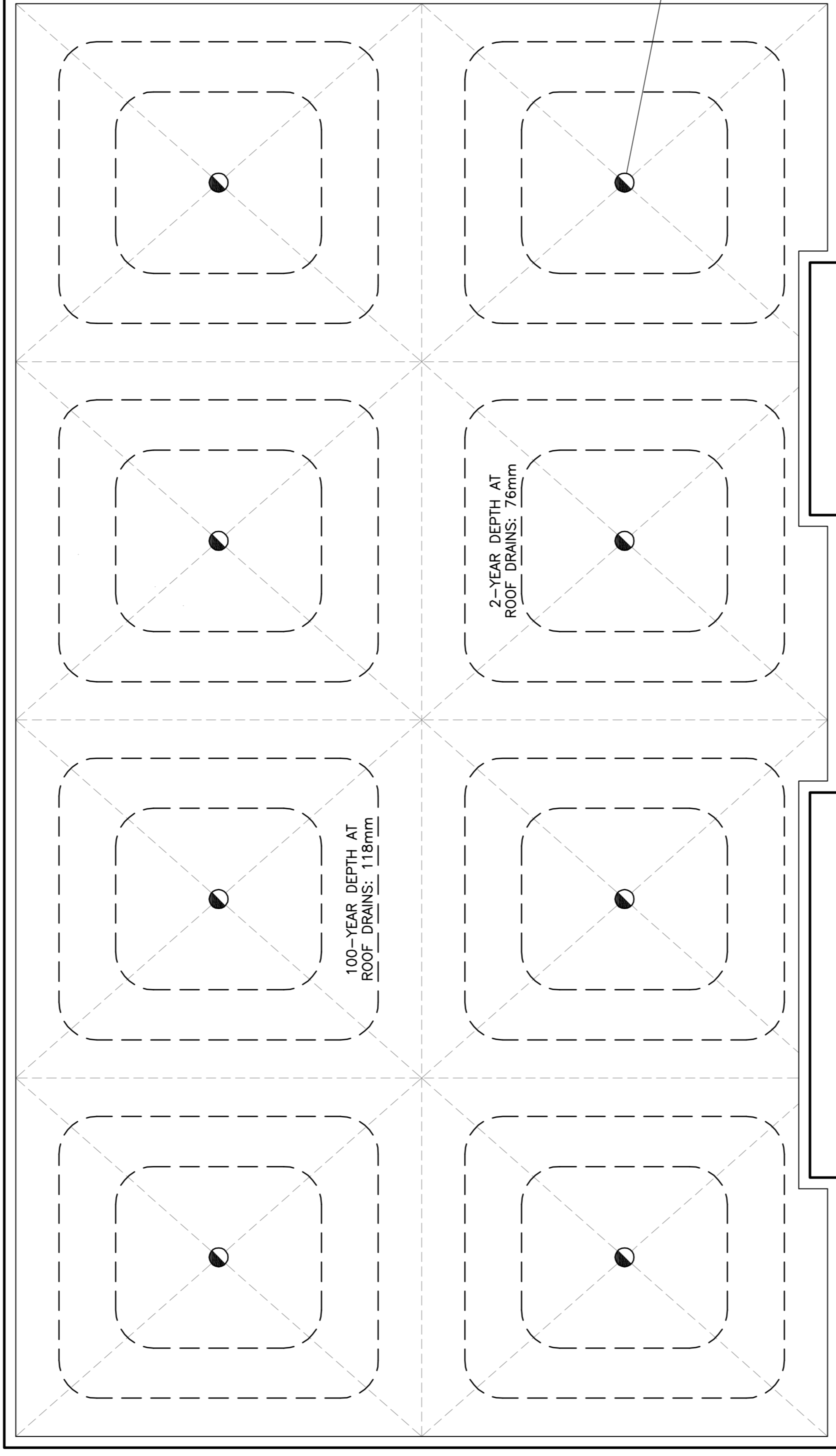

A. McCreight
ANDREW MCCREIGHT
 MANAGER, DEVELOPMENT REVIEW CENTRAL
 PLANNING, DEVELOPMENT & BUILDING SERVICES
 DEVELOPMENT DEPARTMENT, CITY OF OTTAWA

APPROVED
 By Andrew McCreight at 12:04 pm, Feb 24, 2026



No.	DATE	REVISION
2	FEB 19-25	ISSUED FOR APPROVAL
1	JAN 15-25	ISSUED FOR COORDINATION

D. B. GRAY ENGINEERING INC.
 Structural Management - Consulting & Forensic - Storm & Sanitary Services - Fireworks
 700 Long Point Circle
 Ottawa, Ontario d.gray@dbgrayengineering.com 613-425-8044

Project
PROPOSED 4-STORY APARTMENT BUILDING
83-91 SWEETLAND AVENUE
 OTTAWA, ONTARIO

Drawing Title
ROOF DRAINAGE PLAN

Engineer's Seal

 Drawn: D.B.G.
 H. Scale: 1:100
 V. Scale:
 Date: DEC 12-24
 Job No.: 24123
 Drawing No.:
C-5
 of **8**
 NOT VALID UNLESS SIGNED & DATED

REFER TO NOTES & DETAILS
 ON DRAWING C-6