

LEGEND

DRAINAGE AREA

AREA (sq.m)

XXX

X

0.XX

RUNOFF COEFFICIENT

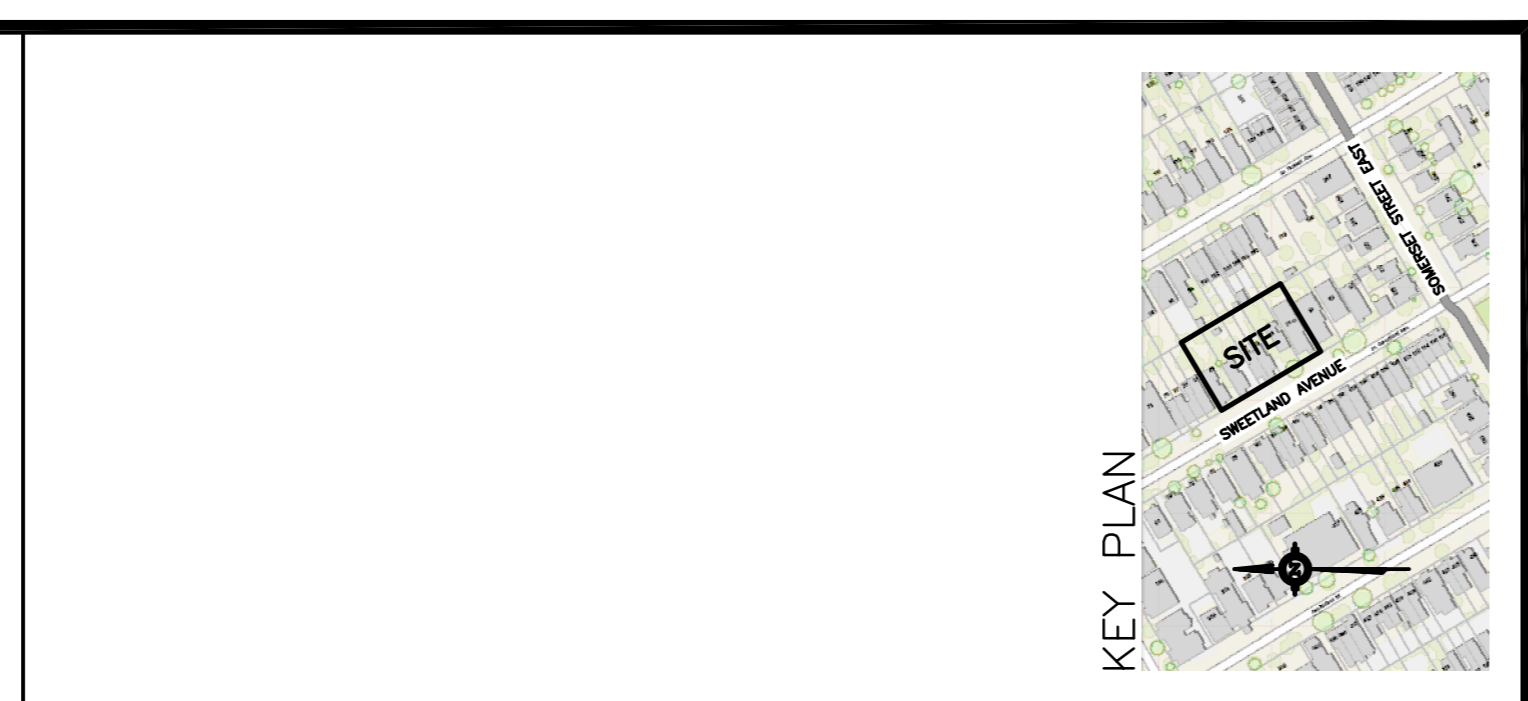

No.	DATE	REVISION
4	JAN 21-26	RE-ISSUED FOR APPROVAL
3	JUL 31-25	RE-ISSUED FOR APPROVAL
2	FEB 19-25	ISSUED FOR APPROVAL
1	JAN 15-25	ISSUED FOR COORDINATION

D. B. GRAY ENGINEERING INC.
 Professional Engineers - Consulting & Planning - Storm & Sanitary Services - Transportation
 700 Long Point Circle
 Ottawa, Ontario d.gray@dbgrayengineering.com
 613-425-8044

Project
PROPOSED 4-STORY APARTMENT BUILDING
83-91 SWEETLAND AVENUE
 OTTAWA, ONTARIO

Drawing Title
POST-DEVELOPMENT DRAINAGE PLAN

Engineer's Seal

 Drawn: D.B.G. 1:100
 H. Scale: 1:100
 V. Scale: DEC 12-24
 Date: DEC 12-24
 Job No.: 24123
 Drawing No.: **C-8** of **8**
 NOT VALID UNLESS SIGNED & DATED

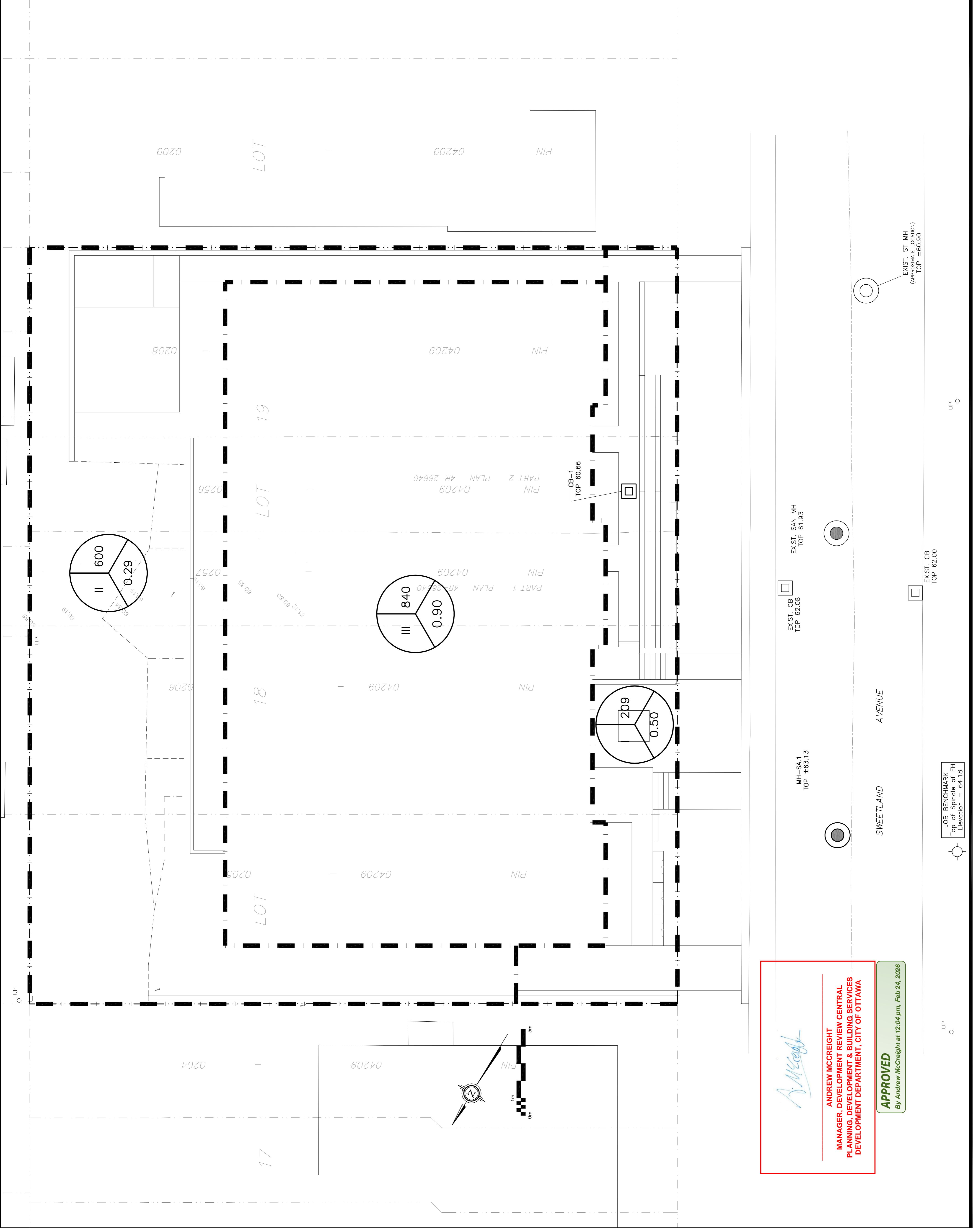

A. McCreight
ANDREW MCCREIGHT
 MANAGER, DEVELOPMENT REVIEW CENTRAL
 PLANNING, DEVELOPMENT & BUILDING SERVICES
 DEVELOPMENT DEPARTMENT, CITY OF OTTAWA

APPROVED
 By Andrew McCreight at 12:04 pm, Feb 24, 2026

JOB BENCHMARK
 Top of Spindle of FH
 Elevation = 64.16

UP

EXIST. CB
 TOP 62.00

MH-SA.1
 TOP ±63.13

EXIST. SAN MH
 TOP 61.93

EXIST. ST MH
 (APPROXIMATE LOCATION)
 TOP ±60.90