

**Legend**

- L101A** AREA ID
- 1.00 0.85 RUNOFF COEFFICIENT
- STORM DRAINAGE AREA NO.
- STORM DRAINAGE BOUNDARY
- EXT-1** AREA ID
- 1.00 0.50 EXTERNAL RUNOFF COEFFICIENT
- EXTERNAL STORM DRAINAGE AREA NO.
- EXTERNAL STORM DRAINAGE BOUNDARY
- DIRECTION OF EMERGENCY OVERLAND FLOW
- PROPOSED STORM MH AND SEWER
- PROPOSED CATCHBASIN MANHOLE
- PROPOSED CATCHBASIN
- PROPOSED C&T AND SUBCRAN
- EXISTING STORM MH AND SEWER
- EXISTING CATCHBASIN
- EXISTING STORM MH AND SEWER
- THERMAL INSULATION ON STORM SEWER WHERE COVER IS LESS THAN 2.0M AS PER E33.
- MAXIMUM STATIC FLOODING UNITS
- PROPOSED HEAVY DUTY ASPHALT
- PROPOSED GRAVEL PARKING
- ENGINEERED RETAINING WALL TO BE DESIGNED BY STRUCTURAL / GEOTECHNICAL ENGINEER.
- CHAIN LINK FENCE PER ARCHITECTURAL PLANS

**Notes**

1. REVISED PER CITY COMMENTS
2. ISSUED FOR REVIEW

Rev	By	App'd	Date
1	M.S.	P.M.	26.04.09
2	M.S.	P.M.	25.08.02

File Name	M.S.	D.T.	M.S.	25.07.03
16402138.DWG				

Permit-Seal



Client/Project  
W. O. Stinson & Son Ltd.  
Albion Road Property  
VEHICLE YARD SERVICE BUILDING  
301 SOMME STREET  
OTTAWA, ON, CANADA

Title  
STORM DRAINAGE PLAN

Project No. 16402138 Scale 1:500 0 5 10 25m  
Drawing No. SD-1 Sheet 6 of 9 Revision 1

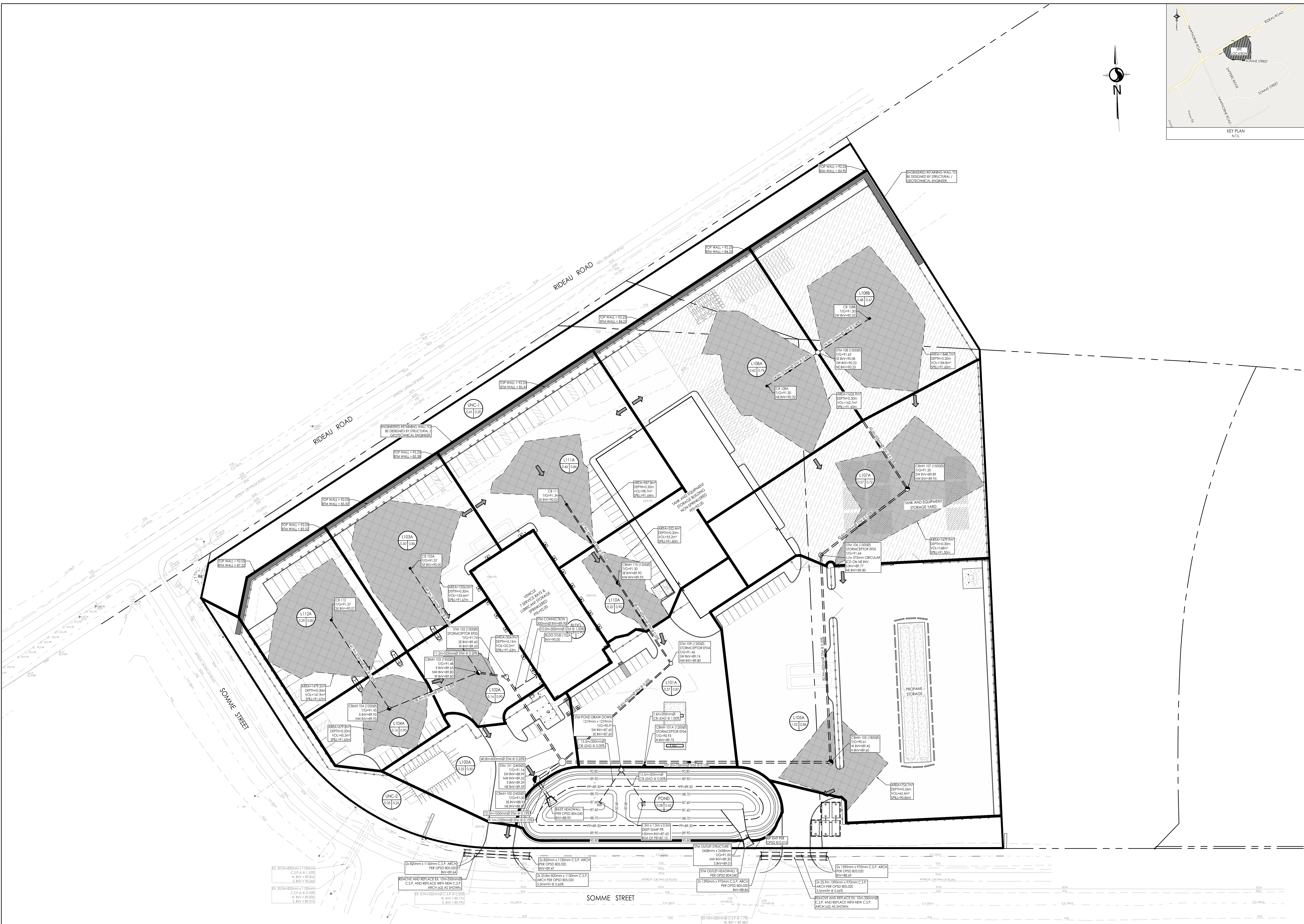

W:\0402138\16402138.DWG (ARCH) 18.08.09  
 16402138.DWG (ARCH) 18.08.09