

No.	Issued For:	Date:
1	For SPA	Nov 03-2025
2	Revisions for SPA	Jan 12-2026
3	Revisions for SPA	Jan 14-2026
4	Revisions for SPA	Jan 22-2026
5	Revisions for SPA	Apr 07-2026

It is the responsibility of the appropriate Contractor to verify all dimensions on site and report all errors and/or omissions to the Architect.

All Contractors must comply with pertinent codes & by-laws.

Do not scale drawings. This drawing may not be used for construction until signed. Architect's copyright reserved.

Metric Scale Drawing: All measurements are in millimeters (mm) unless otherwise noted.

Symbol Legend:

INVERNESS HOMES

Developer:
Inverness Homes
Corp. ON, 613 831-9111
invernesshomes.ca

Planning:
Brigitte Alchawa, MCIP, RPP
Keeper Co.
130 Kings Creek Road, Ashton, ON
bridgette@keeperco.ca

Civil Engineering:
Brandon Mackenzie, P. Eng.
RCI Land Development
2936 Baseline Road, Ottawa, ON
www.rci.com

Landscape Design:
Rudy Levstek, Landscape Architect
Levstek Consultants
5871 Hugh Crescent, Ottawa, ON
rlevstek@iarocquelevstek.com

Surveyor:
John H. Cutri OLS, President
Fairhall Moffatt & Woodland Limited
Ontario Land Surveyors
100-600 Terry Fox Drive, Kanata, ON
(613) 591-2580 / john@fmw.ca

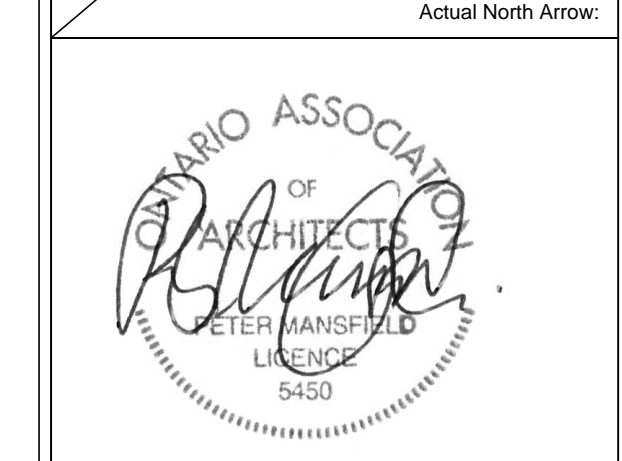
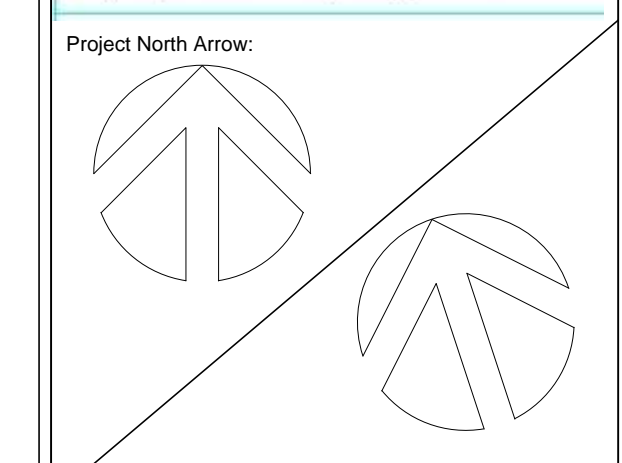

Architect:

Peter Mansfield, Architect
B. Tech., M. Arch., O.A.A.
122 Bridge Street, Almonte, ON
613-256-5213

Project Title:	Proposed Apartment Building 391 Hiversum Lane, Carp, ON
Drawing List:	Third Floor Plan
Job No.:	2404
Scale:	As Noted
Date:	Nov 03-2025
Drawn By:	PM
Reviewed By:	PM

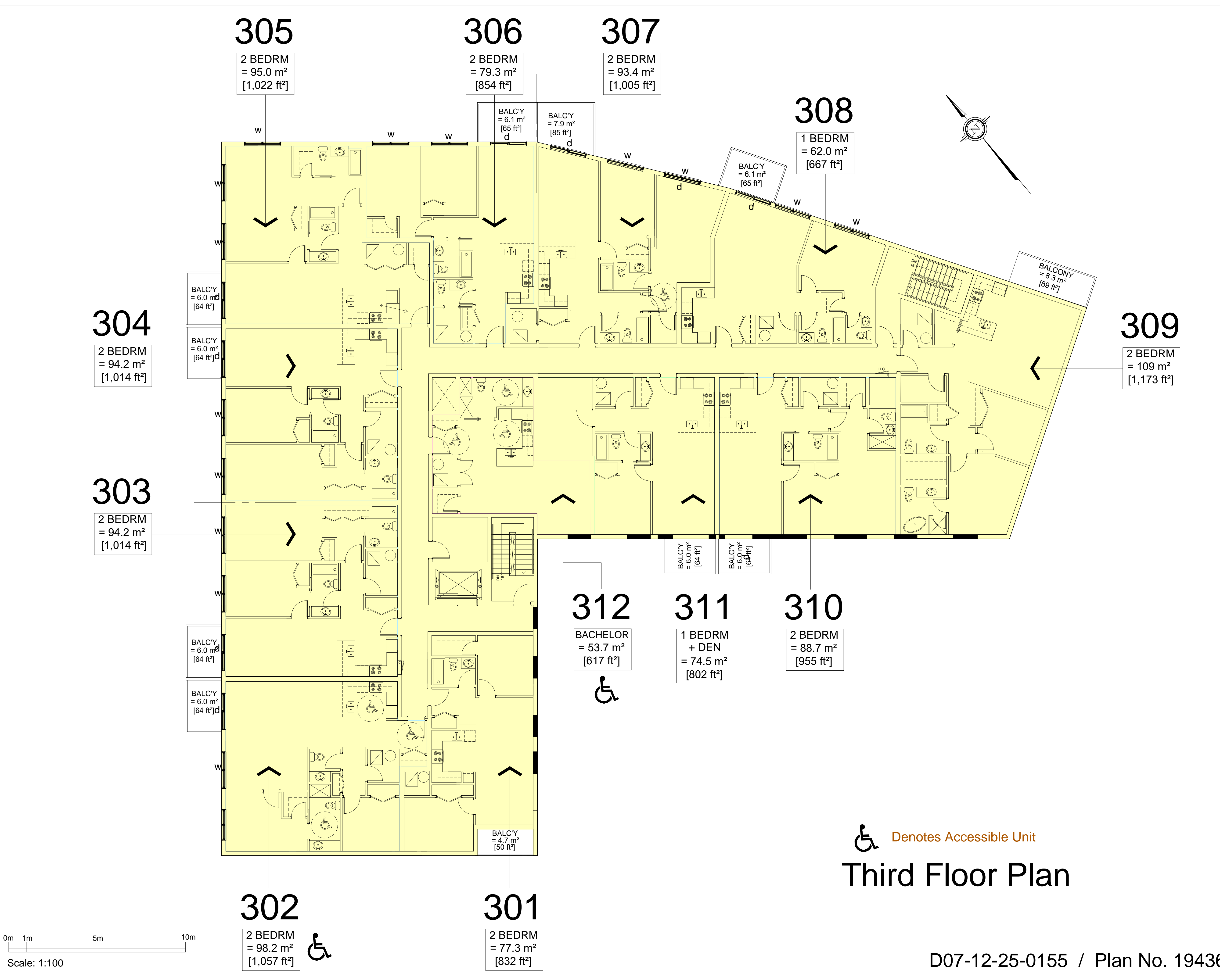

A3

D07-12-25-0155 / Plan No. 19436