

- LEGEND**
- PROPERTY BOUNDARY
  - LIMIT OF HAZARD LANDS
  - 15.0m TOP OF SLOPE SETBACK
  - TURTLE HABITAT SETBACK (AS PER EIS)
  - EXISTING CATCH BASIN
  - EXISTING STORM SEWER & MANHOLE
  - CATCH BASIN
  - STORM SEWER & MANHOLE
  - ▽ BUILDING ENTRANCE
  - SWALE
  - STORM DRAINAGE AREA BOUNDARY

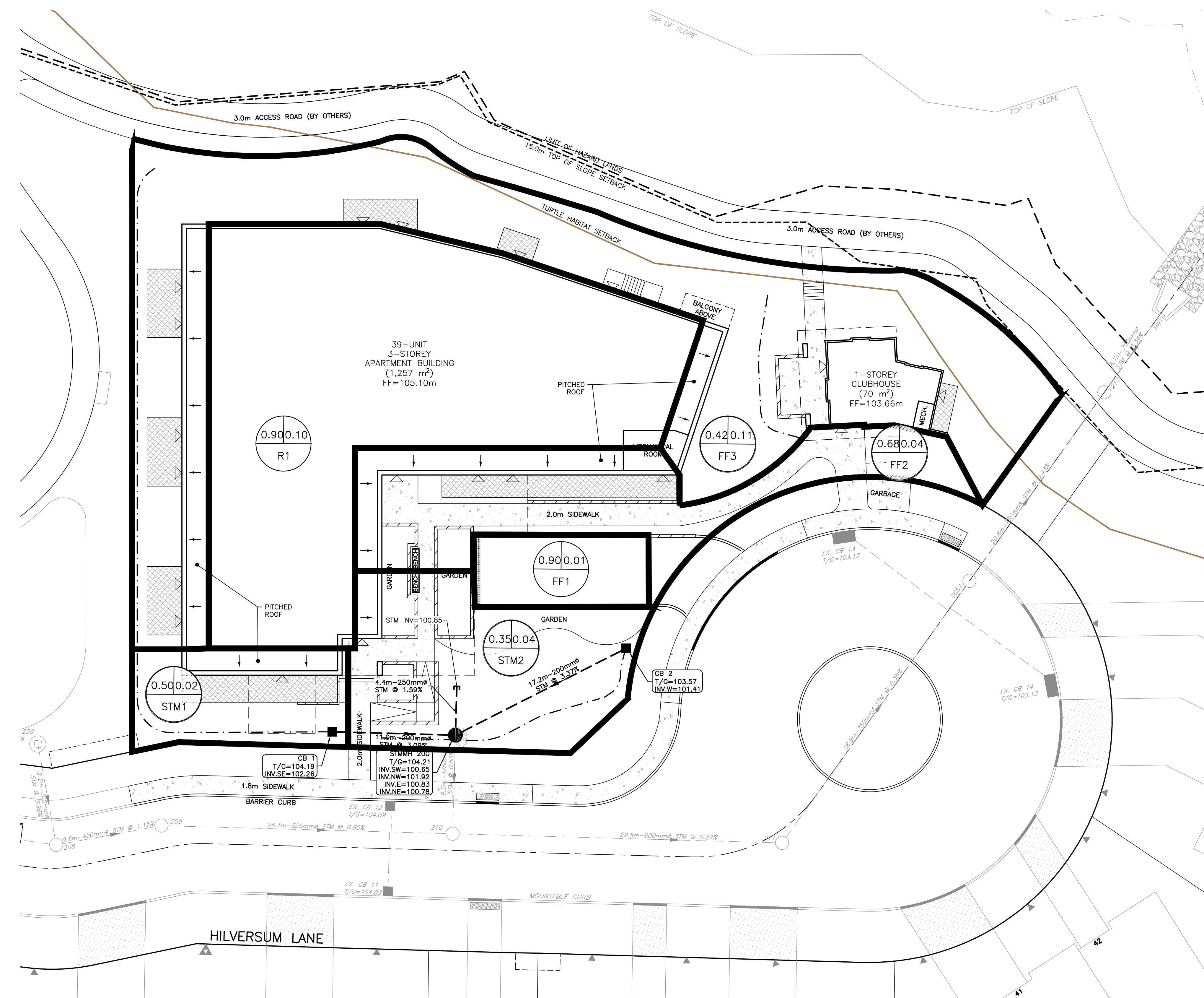
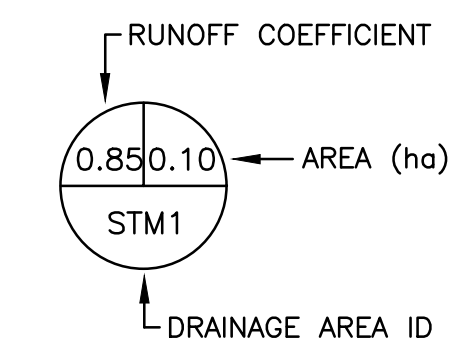

**NOT FOR CONSTRUCTION**

**NOTES**

THE POSITION OF ALL POLE LINES, CONDUITS, WATERMANS, SEWERS AND OTHER UNDERGROUND AND OVERGROUND UTILITIES AND STRUCTURES IS NOT NECESSARILY SHOWN ON THE CONTRACT DRAWINGS, AND WHERE SHOWN, THE ACCURACY OF THE POSITION OF SUCH UTILITIES AND STRUCTURES IS NOT GUARANTEED. BEFORE STARTING WORK, DETERMINE THE EXACT LOCATION OF ALL SUCH UTILITIES AND STRUCTURES AND ASSUME ALL LIABILITY FOR DAMAGE TO THEM.

GEODETIC SURVEY DERIVED FROM COSINE STATION 0011968U054. LOCATION DESCRIPTION: OLD HIGHWAY 17 BRIDGE OVER CARP RIVER ON CARP-STITTSVILLE ROAD, 0.2 KM SOUTH OF C.N.R. CROSSING IN VILLAGE OF CARP. TABLET IN TOP OF WEST WALL, 30 CM FROM NORTH END, 24 CM FROM WEST EDGE. VERTICAL CONTROL DATA, DATUM: CGVD28:78, FIRST ORDER, ELEVATION: 93.861. COORDINATE SYSTEM: MTM ZONE 9; NAD 83 DATUM (CAN83-9)

NO.	REVISION DESCRIPTION	DATE	BY
3	REVISED PER CITY/MVCA COMMENTS	08/04/26	BLM
2	REVISED PER CITY COMMENTS	12/02/26	BLM
1	ISSUED FOR REVIEW	21/11/25	BLM

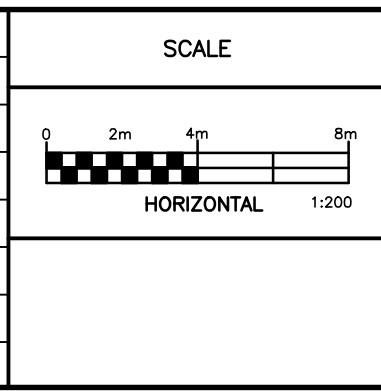

**Robinson Land Development**

2936 Baseline Road, Suite 200, Ottawa, ON K2H 1B3  
(613) 592-6060 rcli.com

DESIGN	BLM
CHECKED	SG
DRAWN	BLM
CHECKED	SG
APPROVED	BLM

**INVERNESS HOMES**  
 38 AURIGA DRIVE, SUITE 200  
 OTTAWA, ON K2E 8A6

391 HILVERSUM LANE  
 CARP, ON

**STORM DRAINAGE AREA PLAN**

PROJECT No.	25094
SURVEY	ROBINSON CONSULTANTS
DATED	APRIL 2026
DWG. No.	25094-STM1

FILE No. D07-12-25-0155 PLAN No. 19486